



PART NO. 23-008-0091

# INSTALLATION INSTRUCTIONS

## SAND FLOW KIT (FOR TOPDRESSER 2300)

1. Remove support rods, hopper back, hopper brace, gate and gate rods from the topdresser.
2. Drill (2) 17/32" diameter holes 1-1/2" above existing holes.
3. Trim 1-1/2" off bottom of hopper back.
4. Replace hopper back, new support and new hopper brace using existing hardware.
5. Remove adjustment lugs and hardware from the old gate and reinstall on the new gate.
6. Drill out the pop rivets to remove the gate seal from the old gate.
7. Pop rivet the gate seal and new slides to the new gate.
8. Install new gate on the topdresser.
9. Replace old gate rods with new gate rods using existing hardware.

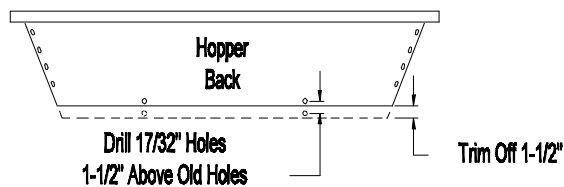

Part No.	Description	Qty.
23-004-1021	Gate Rod	2
23-004-0991	Gate	1
23-005-1101	Support Rod	2
23-004-1031	Hopper Brace	1
23-004-1041	Slide	2

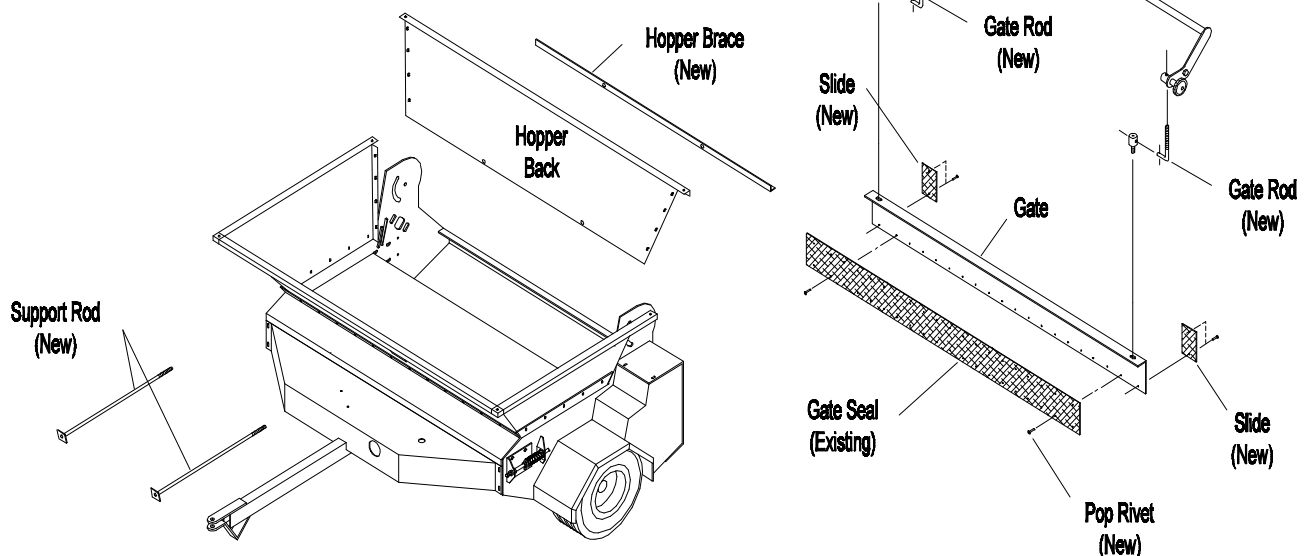

Figure 1