



Fuel Tank Installation

Gear and Fixed Deck Mid-Size Mowers

Model No.: See Below

Operator's Manual
Addendum

Models:

30250—210000001 and Up
 30252—210000001 and Up
 30253—210000001 and Up
 30254—210000001 and Up
 30255—210000001 and Up
 30257—210000001 and Up
 30258—210000001 and Up
 30259—210000001 and Up
 30260—210000001 and Up
 30172TE—210000001 and Up
 30250TE—210000001 and Up
 30164—200000001 and Up
 30184—200000001 and Up
 30193—200000001 and Up
 30194—200000001 and Up
 30196—200000001 and Up
 30197—200000001 and Up

Keep this information with your operator manual.

For models 30164, 30184, 30193, 30194, 30196 and 30197 refer to your operator manual to install shift lever. Disregard any information in this addendum about installing the control panel for these models.

Installing Fuel Tank

1. Remove the bolts and nuts holding the control panel to the rear frame. Discard these nuts and bolts.
2. Slide the control panel over the shift lever and under the bottom of the rear frame (Fig. 1).

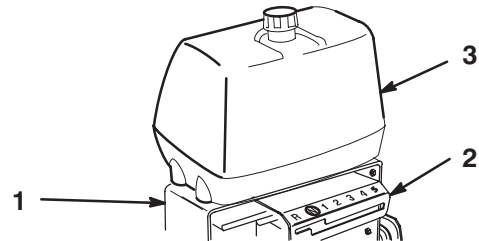

m-5221

Figure 1

1. Rear frame
 2. Control panel
 3. Fuel tank
3. Align fuel tank with the top of the rear frame (Fig. 1).
 4. Place the transmission in neutral.
 5. Align the control panel, side to side, so there is 1/16 in. (2 mm) space between panel and lever.
 6. Secure the right side control panel and fuel tank to the rear frame (Fig. 2) with 2 bolts (5/16 x 7/8 in.), lock washers (5/16 in.) and washers (5/16 in.) (Fig. 2).
 7. Secure the left side control panel and fuel tank to the rear frame (Fig. 2) with 2 studs, washers (5/16 in.), springs and locknuts (5/16 in.) (Fig. 2).
- Note:** Tighten left side until it is completely tight and then unscrew locknut one full turn. This will allow the spring to work.

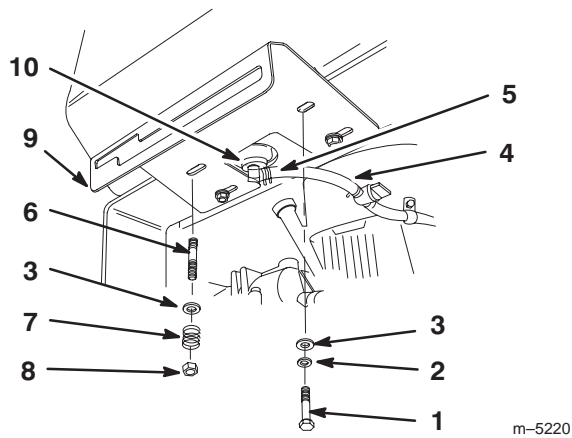

Figure 2

- | | |
|---------------------------|--------------------------|
| 1. Bolt, 5/16 x 7/8 in. | 6. Stud |
| 2. Lock washers, 5/16 in. | 7. Spring |
| 3. Washer, 5/16 in. | 8. Locknut |
| 4. Fuel line | 9. Control panel |
| 5. Hose clamp | 10. Fuel tank connection |

8. Slide the hose clamp onto the fuel line (Fig. 2).
9. Push the fuel line onto the fuel tank connection and secure it with a hose clamp (Fig. 2).
10. Shift lever to second gear and check alignment of lever in slot of control panel. Clearance between top of lever and the top of the slot should be about equal to the clearance between bottom of the lever and the bottom of the slot.
11. If clearance is not correct, remove lever and bend it slightly to adjust.

Note: Do not bend lever while attached to transmission shaft or damage may occur.

PROTOTYPE