



Cooling Package Kit

2024 Directional Drill

Model No. 144-2555

Form No. 3447-863 Rev A

Installation Instructions

Installing the Kit

Note: Retain all hardware.

1. Park the machine on a level surface, shut off the engine, turn the battery disconnect switch to the OFF position, and remove the key.
2. Drain the coolant from the system; refer to the *Operator's Manual*.
3. Remove the front and rear hoods.
4. Remove the side guide plates and the hood hinge plate.

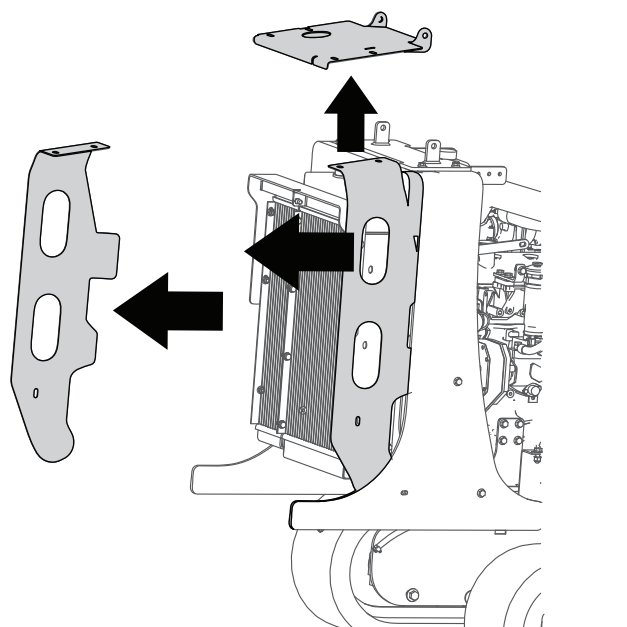

Figure 1

5. Disconnect the coolant reservoir hose and remove the coolant reservoir and bracket.

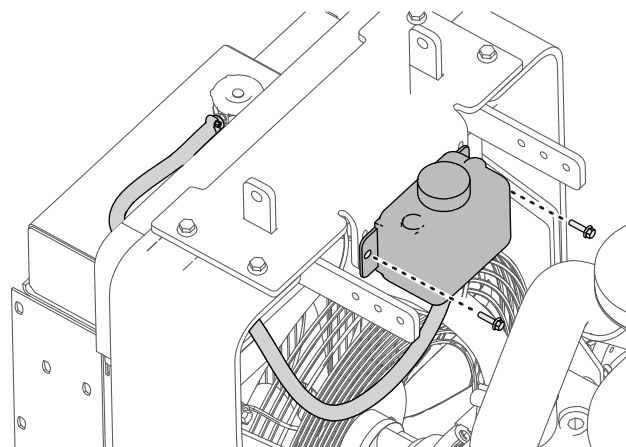

Figure 2

6. Remove the rear hood shock mount.

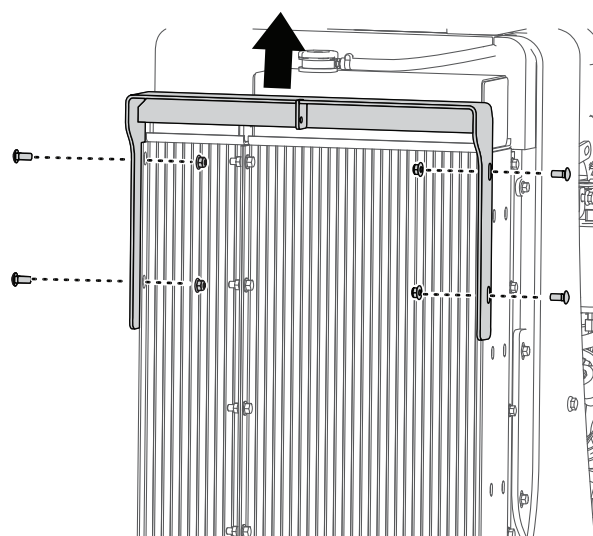

Figure 3



7. Remove the support shroud.

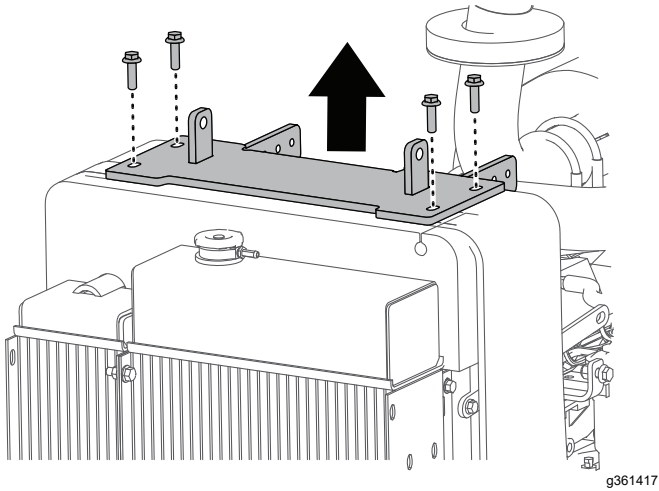

Figure 4

8. Using 2 people, remove the side plates.

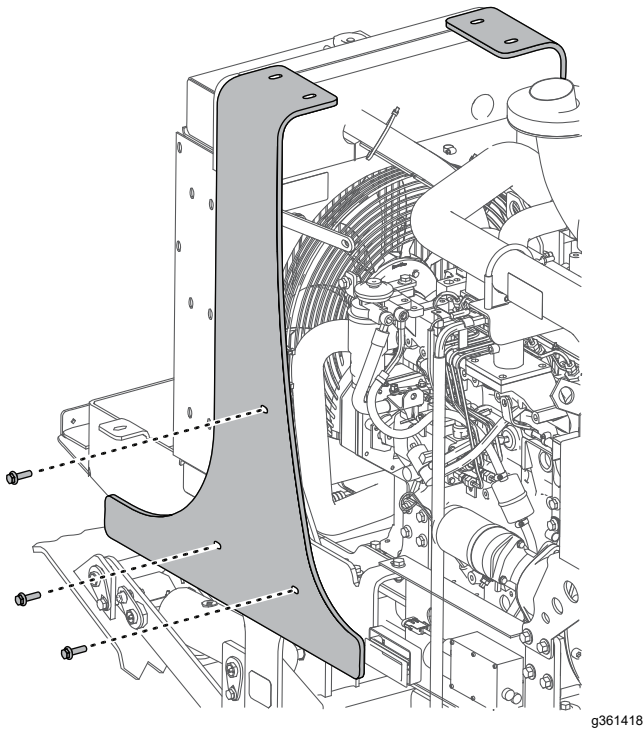

Figure 5

9. Loosen the bolts on both of the cooling shroud straps.

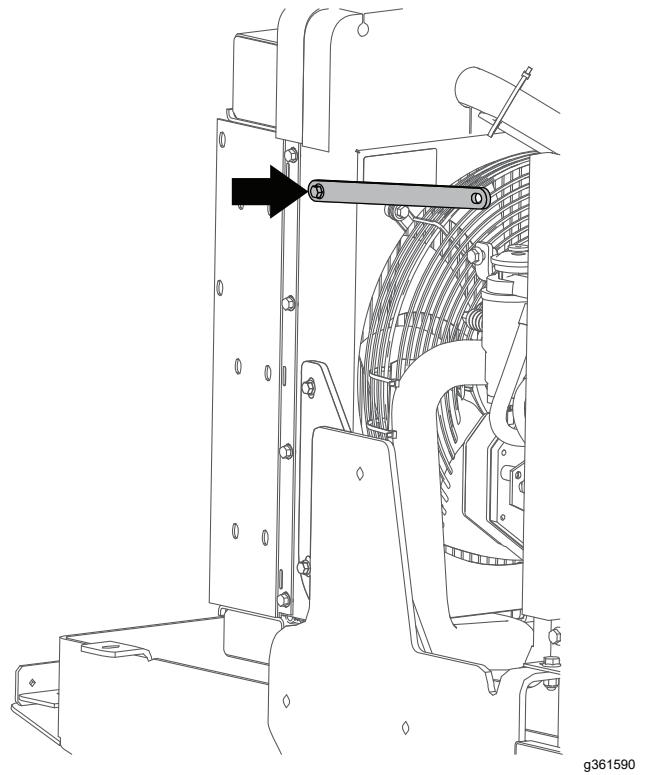

Figure 6

10. Remove the foam pieces.

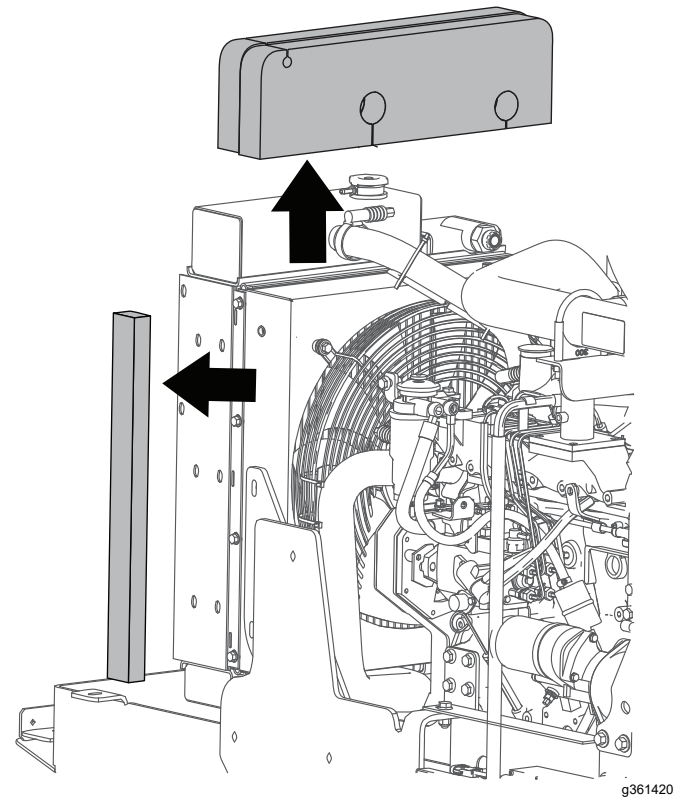

Figure 7

11. Disconnect and plug the hydraulic hoses.
12. Disconnect the radiator hoses.
13. Remove and disconnect the cooling assembly.

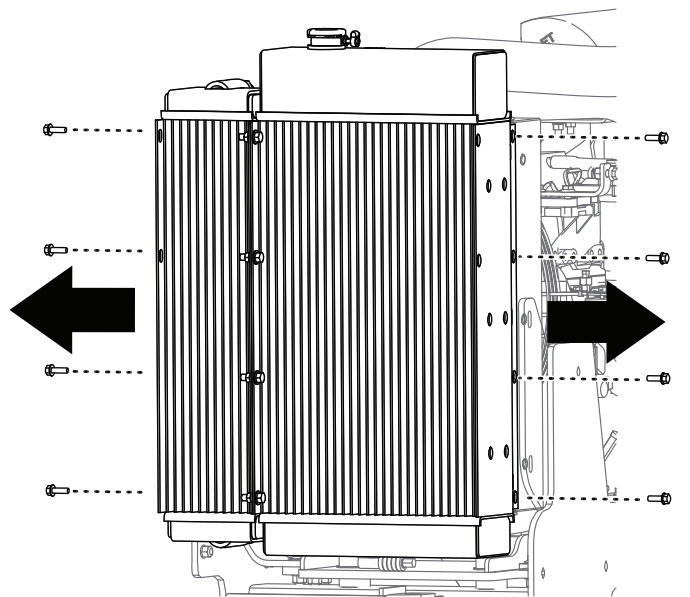

Figure 8

g361423

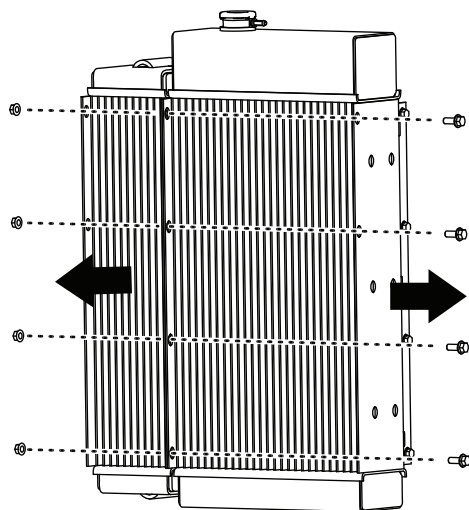

Figure 9

g361424

14. Using the hardware from the previous assembly, connect the 2 new coolers on both sides.

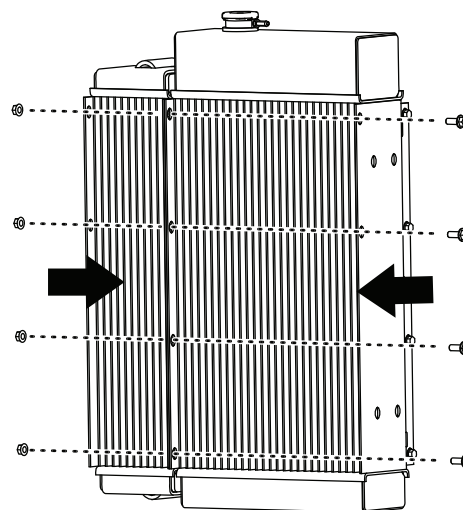

Figure 10

g361425

15. Place the cooler assembly in place, slide the shims in between the cooler assembly and cooler shroud and secure with the previously removed hardware.

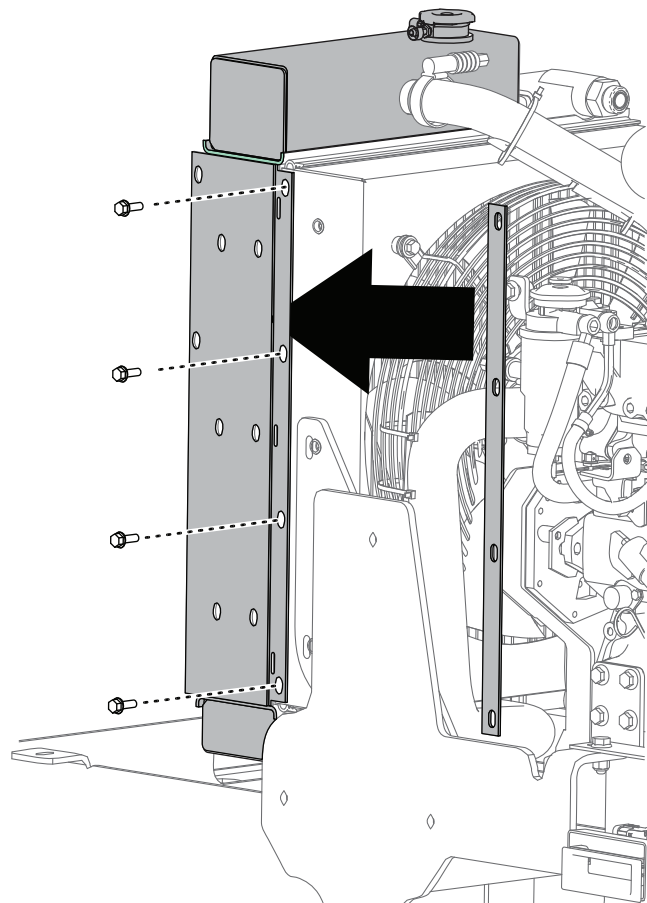

Figure 11

g361426

16. Install the components in reverse order.

17. Torque all the fasteners to the following specifications:
- 3/8 inch bolts to 37 to 45 N·m (27 to 33 ft-lb)
 - 5/16 inch bolts to 1978 to 2542 N·cm (175 to 225 in-lb)
 - M6 bolt to 972 to 1198 N·cm (86 to 106 in-lb)
 - M8 bolt to 23 to 29 N·m (17 to 21 ft-lb)
 - M10 bolt to 47 to 57 N·m (34 to 42 ft-lb)