



## Needle Tine Head

### for ProCore Aerator

Model No. 09720

## Parts Catalog

### Ordering Replacement Parts

To order replacement parts, please supply: the part number, the quantity, and the description of each part desired.

### Understanding Reference Numbers

Each identified part in an illustration has a reference number. The reference number for a part also appears in the parts list, along with other information about the part.

This catalog uses two special reference number formats, one to indicate parts in a service assembly and another to indicate the quantity of a given part in an illustration.

### Service Assembly Reference Numbers

Parts in service assemblies have reference numbers in the form **a:b**. The **a** represents the reference number of the entire service assembly and the **b** represents a sequential number unique to each part within the service assembly.

For example, a wheel assembly might be identified by reference number **6**, the tire by **6:1**, the valve by **6:2**, and the wheel by **6:3**. When you order the assembly identified by reference number **6**, you receive all parts identified by reference numbers **6:1**, **6:2**, and **6:3**. However, you may also order any part individually.

Reference numbers of this type appear in illustrations and in part lists.

### Reference Numbers Indicating Quantity

In an illustration, if a reference number indicates more than one part, the reference number has the form **nX y**. The **n** represents the quantity of the part, the **X** is the multiplication symbol, and the **y** represents the reference number.

For example, in an illustration, the reference number **2X 37** means that two of the parts identified by reference number **37** are indicated.

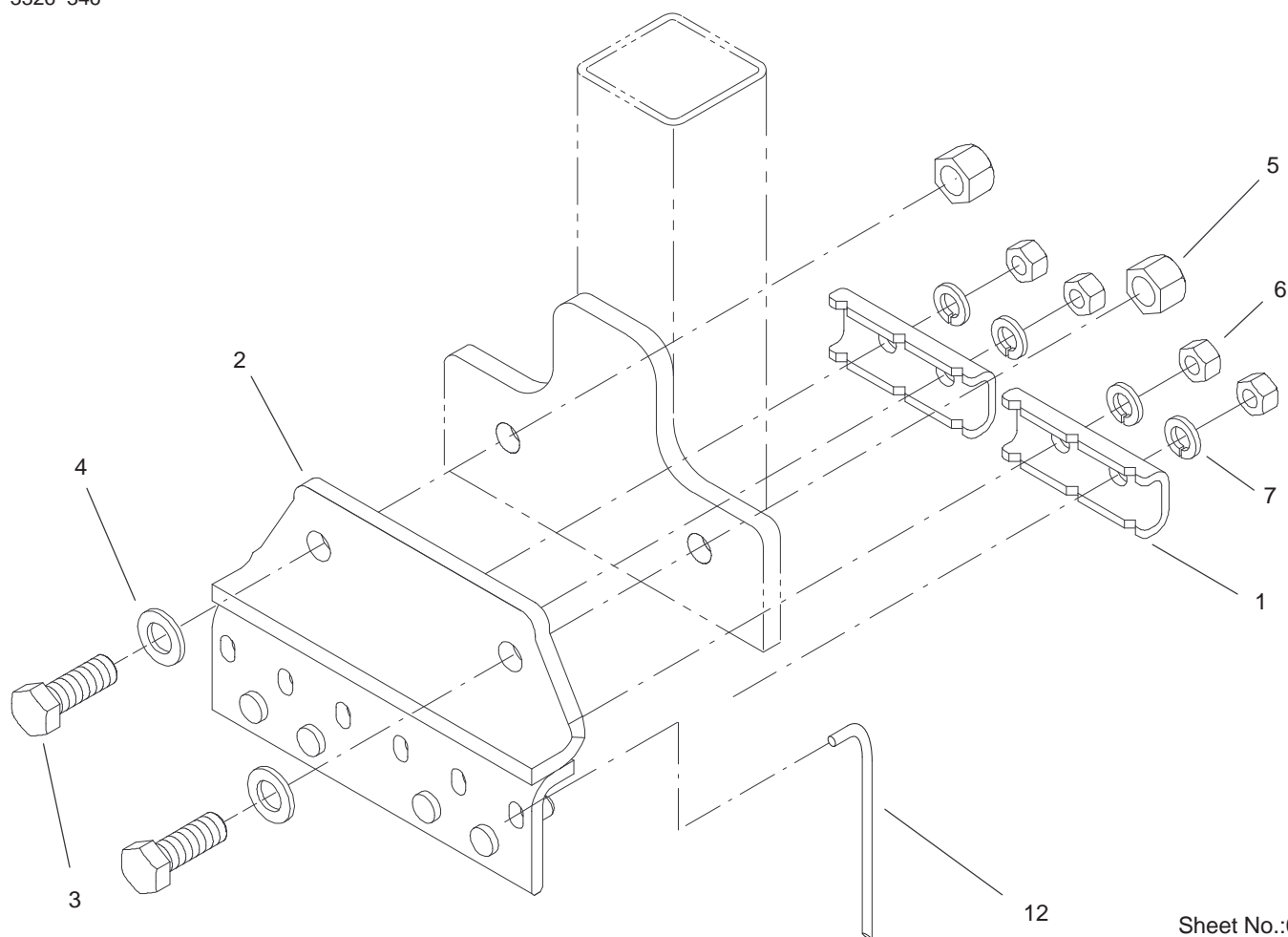

Sheet No.:0

## Needle Tine Head Assembly

Ref. No.	Part No.	Qty.	Description
1	104-0972	2	Clamp-Tine
2	104-0976	1	Needle Tine Head ASM
3	33118-045	2	Screw-HH
4	33098-00	2	Washer-Flat
5	33028-00	2	Nut-Lock NI
6	104-9914	4	Nut-Hex
7	3253-7	4	Washer-Lock
▶12	100-3620	6	Tine-5mm Needle
▶12	100-3621	6	Tine-8mm Needle

Ref. No.	Part No.	Qty.	Description

► Service parts only – Not supplied with kit