



Trailing Shield Kit

Model No. 145-5821

Form No. 3449-741 Rev A

Installation Instructions

Installation

Important: You will need a torque wrench to install the trailing shield and wheels properly. If you do not have a torque wrench or are uncomfortable performing this procedure, contact an Authorized Service Dealer. Visit Toro.com/locator to find an Authorized Service Dealer.

1

Preparing the Machine

No Parts Required

Procedure

1. Move the machine to a level surface.
2. Shut off the machine.
3. Wait for all moving parts to stop.
4. Remove the electric-start button (if equipped).

2

Removing the Rear Wheels

No Parts Required

Procedure

1. Remove the bolts that secure the rear wheel to the machine ([Figure 1](#)).

Set aside the bolts for later installation.

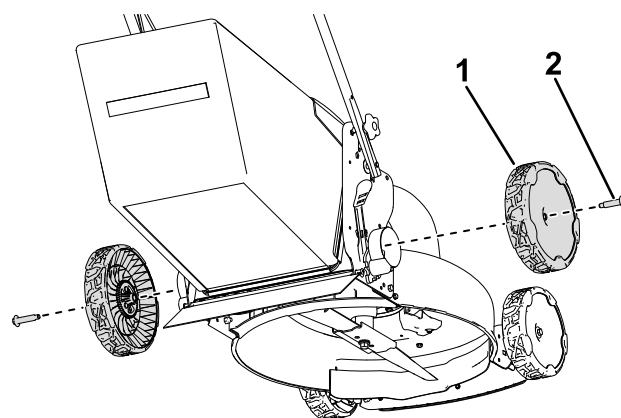

g369899

Figure 1

- | | |
|----------|---------|
| 1. Wheel | 2. Bolt |
|----------|---------|

2. Remove the rear wheels from the machine ([Figure 1](#)).

Set aside the wheels for later installation.



3

Removing the Existing Trailing Shield

No Parts Required

Procedure

Remove the existing trailing shield from the side-plate holes; refer to [Figure 2](#).

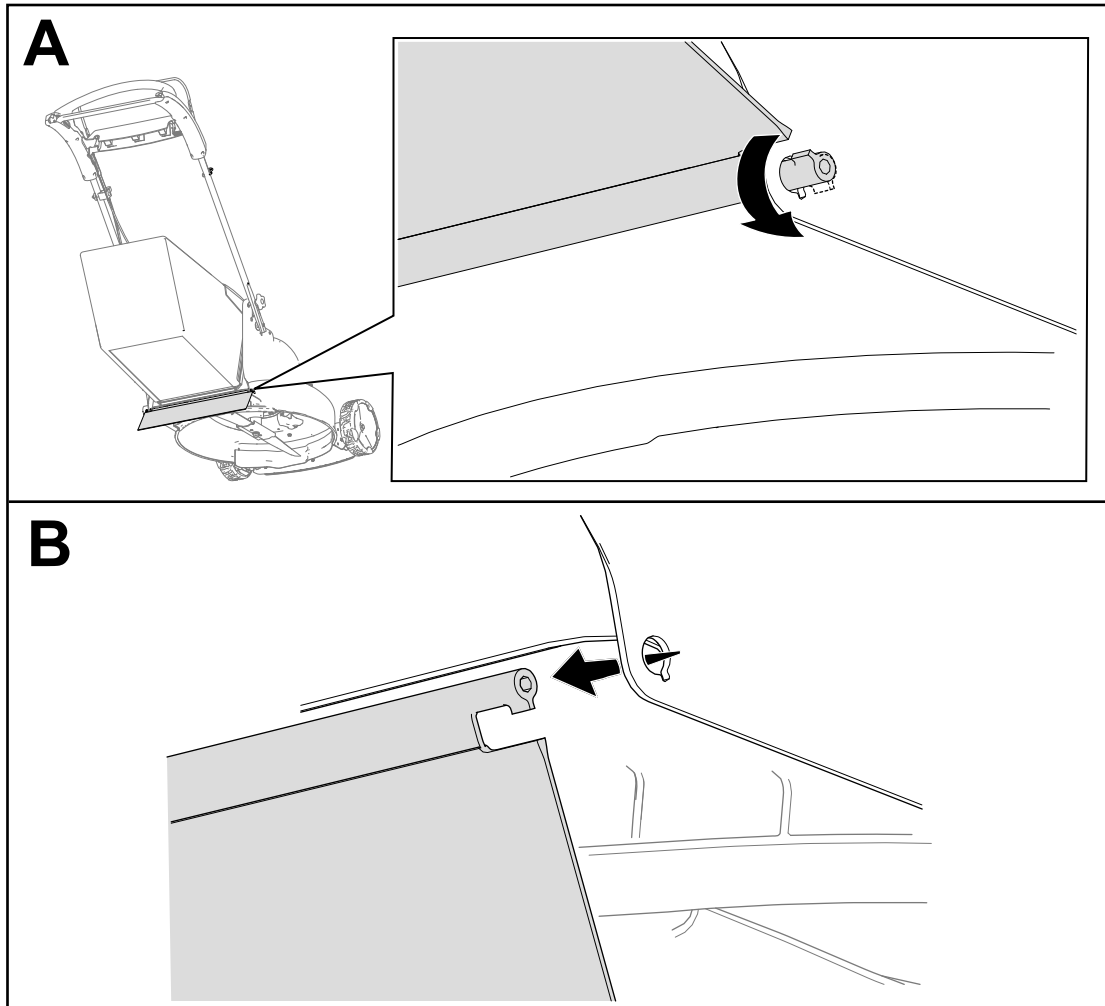

Figure 2
Right side shown.

g370271

4

Installing the Trailing Shield

Parts needed for this procedure:

1	Trailing shield
2	Screw

Procedure

1. Install the trailing shield through the side-plate holes ([Figure 3](#)).

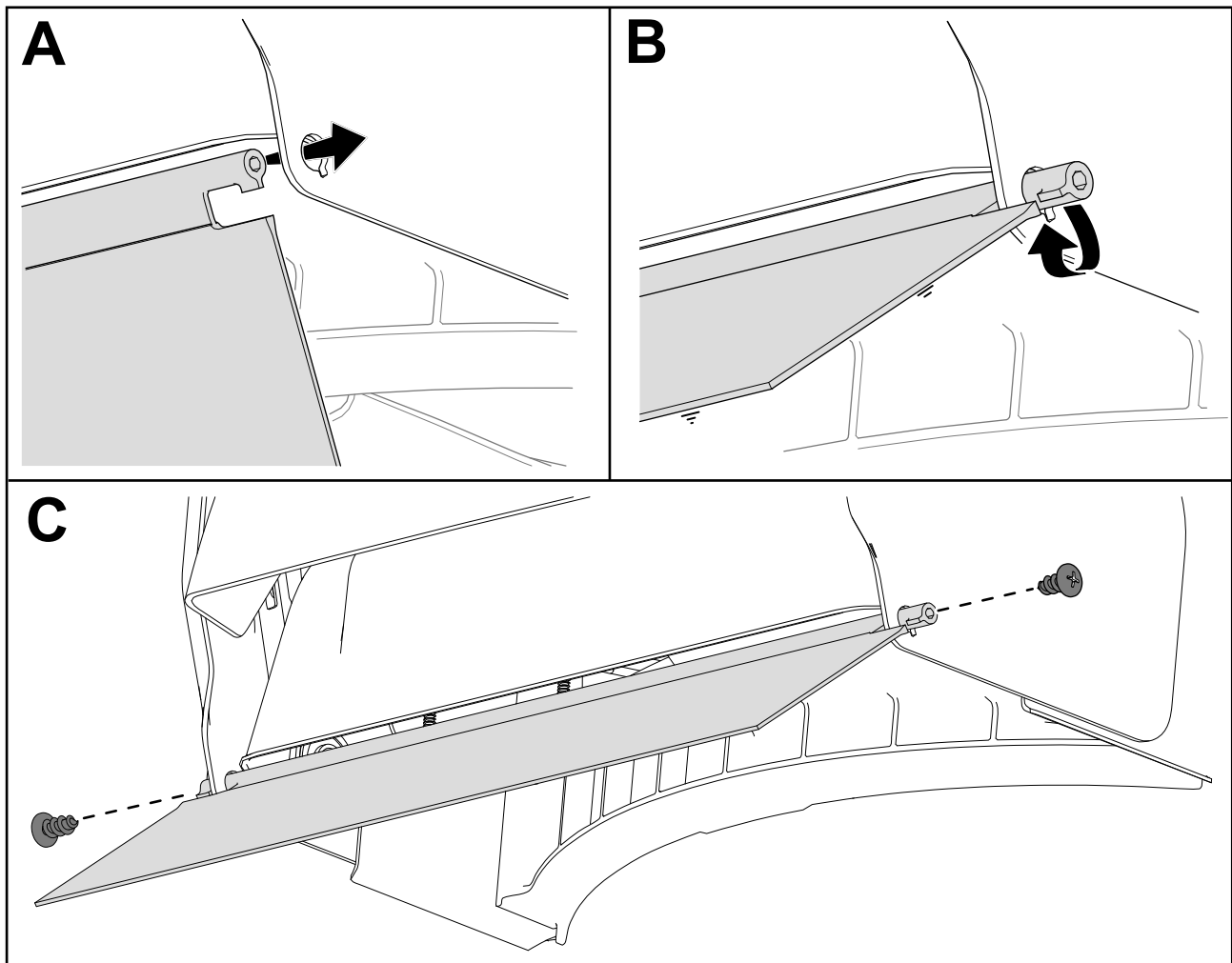

Figure 3

g369877

2. Use the 2 screws to secure the trailing shield to the machine ([Figure 3](#)).
3. Use a torque wrench to torque the screws to 0.9 to 1.1 N·m (8 to 10 in-lb).

5

Installing the Rear Wheels

No Parts Required

Procedure

1. Use the previously removed bolts to secure the wheels to the machine ([Figure 4](#)).

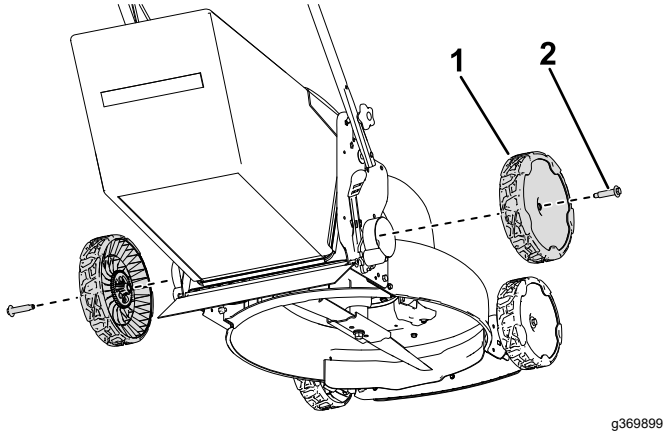

Figure 4

- | | |
|----------|---------|
| 1. Wheel | 2. Bolt |
|----------|---------|

-
2. Use a torque wrench to torque the bolts to 34 to 37 N·m (300 to 330 in-lb).