



Hour Meter Kit

Walk Behind Greensmaster Mowers

Part No. 105-5350

Form No. 3326-476

Installation Instructions

1. On rear of engine, locate single wire w/connector extending from wire harness (Fig. 2). Clip off end of protective sleeve to gain access to connector on harness wire (Fig. 1). Do not damage wire or connector when clipping sleeve.

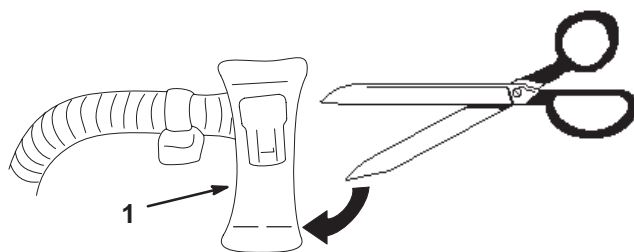

Figure 1

1. Protective sleeve

2. Remove bolt and washer securing engine ground wire to back of engine (Fig. 2).
3. Slide retainer off hour meter.
4. Insert hour meter into mounting bracket and secure with retainer.
5. Mount hour meter bracket and ground wire to rear of engine with (2) bolts and washers.
6. Plug wire connector onto hour meter connector.

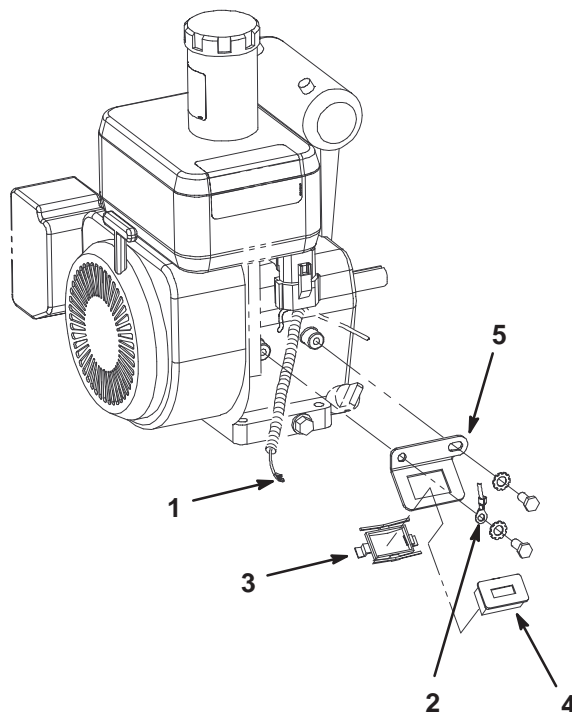

Figure 2

1. Wire w/connector
2. Ground wire
3. Hour meter retainer
4. Hour meter
5. Hour meter mounting bracket