



## Valve Replacement Kit

Reelmaster® 5500 with Serial No. 200000001 to 210000500

Part No. 104-9341

Form No. 3326-665

### Installation Instructions

1. Start the machine. To relieve pressure from the hydraulic system, extend the cylinders by lowering all of the cutting units to the ground.



#### Warning



Hydraulic fluid escaping under pressure can penetrate skin and cause injury.

- Make sure all hydraulic fluid hoses and lines are in good condition and all hydraulic connections and fittings are tight before applying pressure to the hydraulic system.
- Keep your body and hands away from pin hole leaks or nozzles that eject high pressure hydraulic fluid.
- Use cardboard or paper to find hydraulic leaks.
- Safely relieve all pressure in the hydraulic system before performing any work on the hydraulic system.
- Seek immediate medical attention if fluid is injected into skin.

2. Park the machine on a level surface. Engage the parking brake, stop the engine, and remove the ignition key.



#### Caution



If you leave the key in the ignition switch, someone could accidentally start the engine and seriously injure you or other bystanders.

Remove the key from the ignition before you do any maintenance.

3. Raise the seat to expose the hydraulic valve block. Clean the area around the valves so that foreign matter cannot fall into the ports and damage the hydraulic system.
4. Remove the coil retention nut from solenoid valve SV3 (Fig. 1).

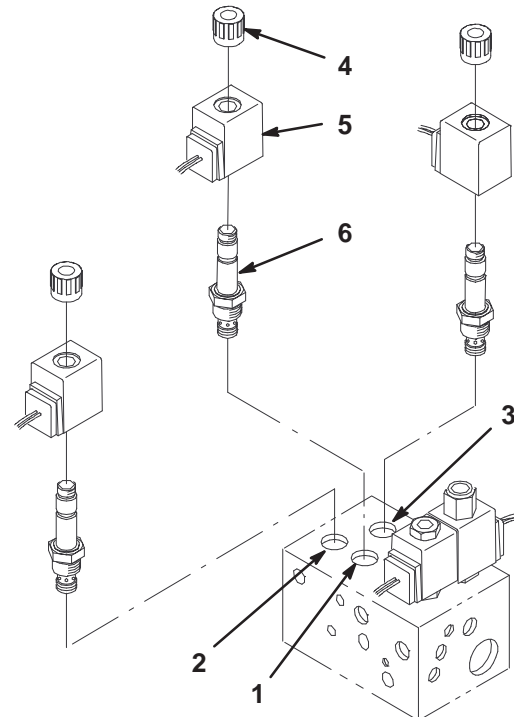

Figure 1

- |                 |               |
|-----------------|---------------|
| 1. SV3 location | 4. Finger nut |
| 2. SV4 location | 5. Coil       |
| 3. SV5 location | 6. Valve      |

5. Slide the coil off of the valve and remove the valve from the valve block (Fig. 1).
6. Install a new valve and torque it to 30–35 ft.-lb. (41–47 N·m).
7. Slide the new coil over the valve.
8. Disconnect the removed coil from the wire harness and connect the new coil to the open terminal on the harness.
9. Install the finger nut to retain the new coil (Fig. 1).
10. Repeat steps 4–9 for each solenoid valve being replaced (Fig. 1).
11. Updating the machine with this kit requires the machine to be updated with the latest software, Part No. 105-8502. The software can be obtained through normal distribution channels, including the Toro Extranet website. For reprogramming instructions, refer to the *Automated Control Electronics* manual, Form No. 98952SL, or your product service manual.