



Draw Bar Hitch Kit

Field Pro 6040

Model No. 08904

Installation Instructions

⚠ WARNING

CALIFORNIA Proposition 65 Warning

Use of this product may cause exposure to chemicals known to the State of California to cause cancer, birth defects, or other reproductive harm.

Installation

Preparing the Machine

1. Park the machine on a level surface.
2. Engage the parking brake.
3. Shut off the engine and remove the key.
4. Wait for all moving parts to stop and machine components to cool.
5. Chock the wheels.

Safety

Safety and Instructional Decals



Safety decals and instructions are easily visible and are located near areas of potential danger. Replace every damaged or missing decal.

⚠ WARNING: Cancer and Reproductive Harm - www.P65Warnings.ca.gov.
For more information, please visit www.ttcocalprop65.com

133-8061

decal133-8061

133-8061



decal147-3735

147-3735

1. Maximum draw bar pull is 181 kg (400 lb).
2. Read the *Operator's Manual*.



Installing the Draw Bar Hitch Kit

1. Align the draw bar hitch with the top and bottom holes on the rear attachment assembly ([Figure 1](#)).

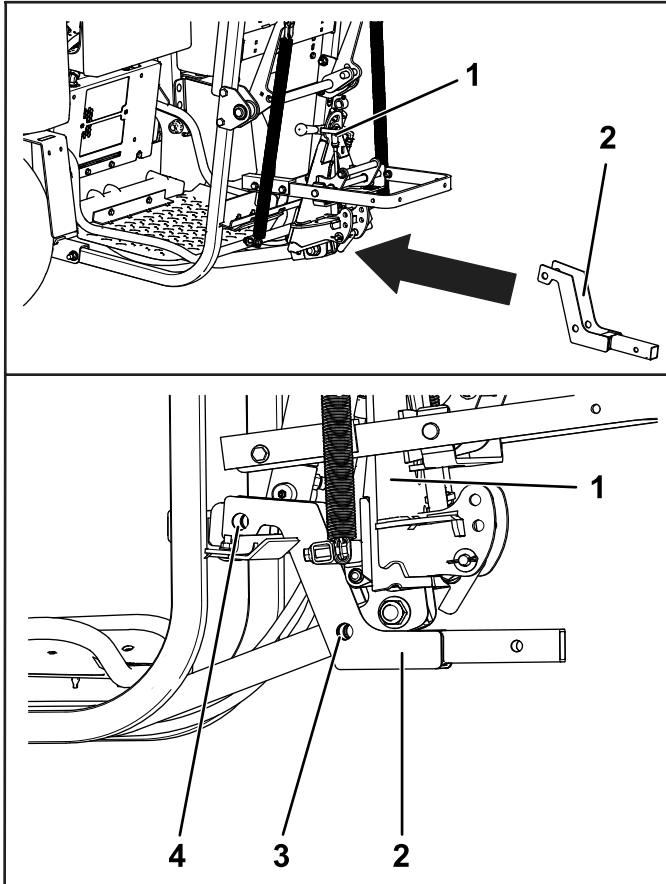

g387011

Figure 1

- | | |
|-----------------------------|----------------|
| 1. Rear attachment assembly | 3. Bottom hole |
| 2. Draw bar hitch | 4. Top hole |

2. Insert 2 hitch pins through the top and bottom holes and secure with 2 hairpin cotters ([Figure 2](#)).

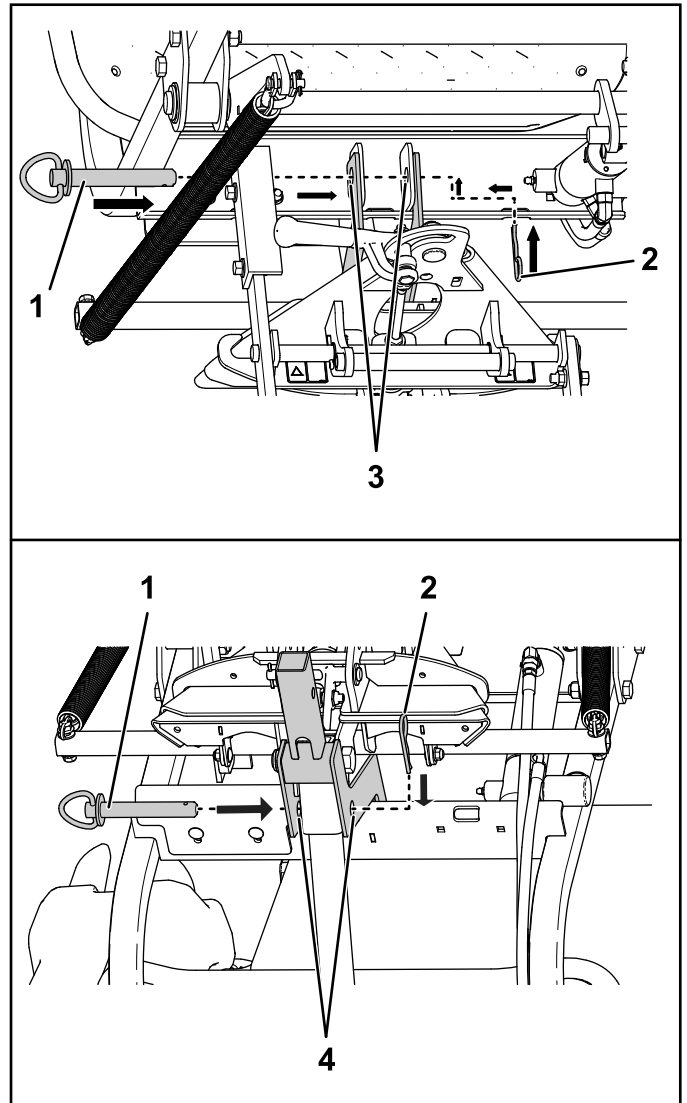

g387012

Figure 2

- | | |
|-------------------|----------------|
| 1. Hitch pin | 3. Top hole |
| 2. Hairpin cotter | 4. Bottom hole |