



### Loose Parts

Use the chart below to verify that all parts have been shipped. Part numbers not shown are available on the dealer extranet.

Dealer Pack			
Part No.	Description	Qty.	Use
—			Install grass bag on bag frame.
—	Warranty Registration Reminder		Fill out the online warranty registration form.

Literature Pack
Manual, Operator's
Manual, Engine Operator's (Non-Exmark Engine)



## Removing the Unit from the Box

Remove the unit from the box.

## Installing the Handle

1. Remove the handle mounting screws from LH and RH sides of the mower (reference Figure 1).

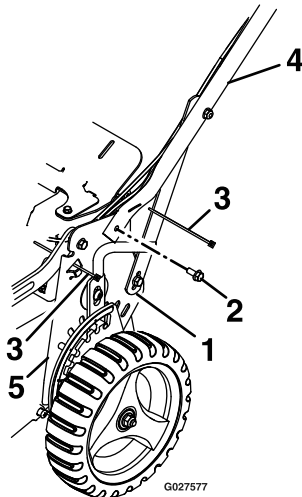

Figure 1

1. Handle bracket
2. Handle mounting screw
3. Wire tie
4. Handle
5. Side bracket

2. Unfold the handle to the operating position.
3. Reinstall the handle mounting screws on both sides to secure the handle to the mower housing (see Figure 1). Tighten all hardware on the handle.
4. Use the wire tie to secure the cables to the lower part of the handle as shown in Figure 1. Tighten all wire ties on the handle.
5. Use wire tie to secure the cables to the side bracket to keep cables from touching the fuel tank as shown in Figure 1
6. Trim the wire ties.

**Note:** The height of the handle can be adjusted for comfortable operation. Stand behind the handle to determine the height. To adjust the handle height, position the hardware into one of the three holes located at the bottom of the handle bracket.

## Service the Engine

**Important:** The mower does not come with oil in the engine.

Filling the crankcase with oil

Initially, fill the crankcase with 30 ounces (0.88 liters) of oil. Exmark 4-Cycle Premium Engine Oil is recommended. Refer to the Engine Owner's Manual for an appropriate API rating and viscosity. **Do Not** overfill.

Oil Capacity	
With Oil Filter	30 ounces (0.88 L)

Before each use, ensure that the oil level is between the Add and Full marks on the dipstick

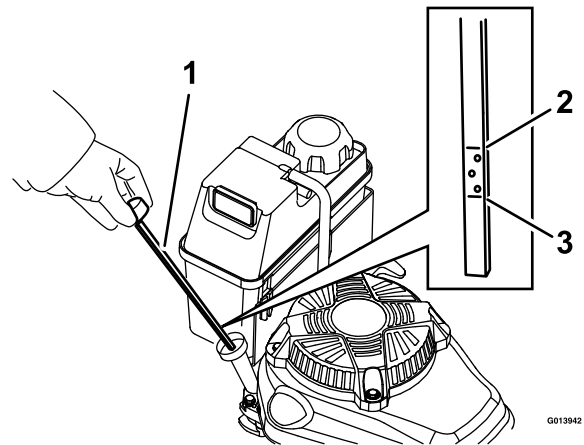

Figure 2

1. Dipstick
2. Full
3. Add

**Important:** Do Not operate the engine with the oil level below the "LOW" (or "ADD") mark on the dipstick, or over the "FULL" mark.

## Check the Cable Adjustments

Follow the procedures in the Operator's manual to ensure the self-propel drive and BBC cables have been adjusted properly.

## Check the Blade Control Lock Lever

Check the operation of the blade control lock lever; see the Operator's manual for adjustment.

## Check the Parking Brake Lever

Check the operation of the parking brake lever; see the Operator's manual for adjustment.

## **Install Grass Bag on Bag Frame**

Slide the frame inside the bag and install the J-strips along all sides of the bag opening onto the frame.

## **Filling Out the Product Registration**

Fill out the online warranty registration form.