



Power Harness Kit

Groundsmaster® 3200 or 3300 Series Traction Unit

Model No. 140-1559

Form No. 3454-889 Rev A

Installation Instructions

Installation

1

Preparing the Machine

No Parts Required

Procedure

1. Park the machine on a level surface.
2. Engage the parking brake.
3. Lower the attachments.
4. Shut off the engine and remove the key.

2

Disconnecting the Battery

No Parts Required

Removing the Battery Cables

⚠ WARNING

Battery terminals or metal tools could short against metal components, causing sparks.

- When removing or installing the battery, do not allow the battery terminals to touch any metal parts of the machine.
- Do not allow metal tools to short between the battery terminals and metal parts of the machine.

⚠ WARNING

Electrical sparks can cause the battery gasses to explode, resulting in personal injury.

Incorrect battery cable routing could damage the machine and cables, causing sparks.

- Always disconnect the negative (black) battery cable before disconnecting the positive (red) cable.
- Always connect the positive (red) battery cable before connecting the negative (black) cable.

1. Remove the negative battery cable from the battery post (Figure 1).

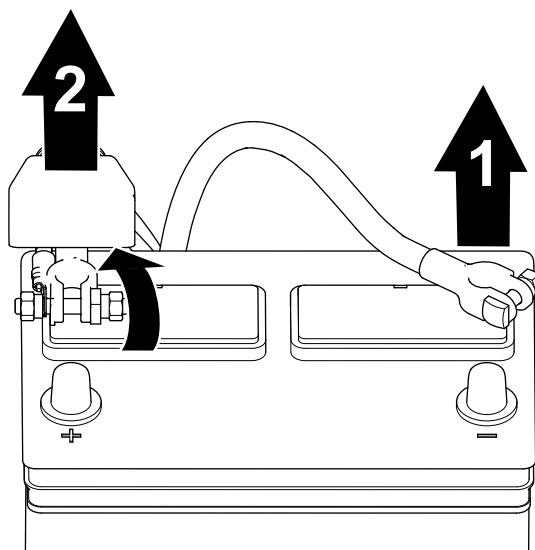

g252591

Figure 1

1. Negative battery cable
 2. Positive battery cable
2. Lift the insulator and remove the positive battery cable from the battery post (Figure 1).



3

Routing the Power Harness

Parts needed for this procedure:

1	Power harness
6	Cable tie
1	Relay
1	Fuse (10 A)

Procedure

Important: Route the wire harness away from any hot, sharp, or moving parts; secure with cable ties as needed.

1. Unlatch and open the hood.

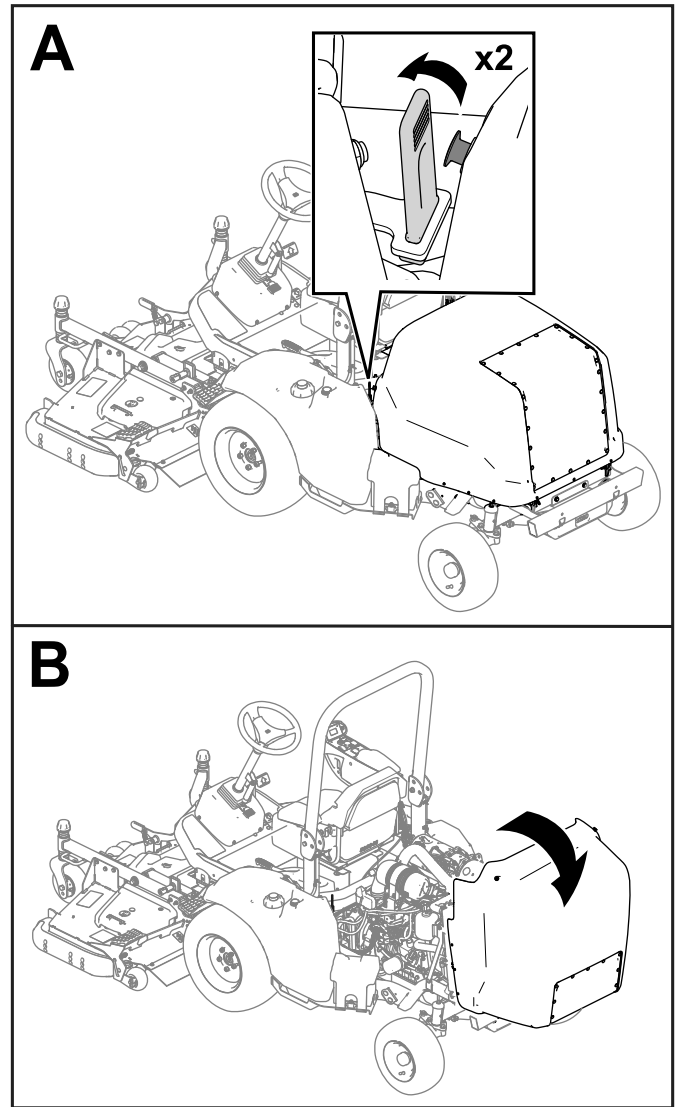
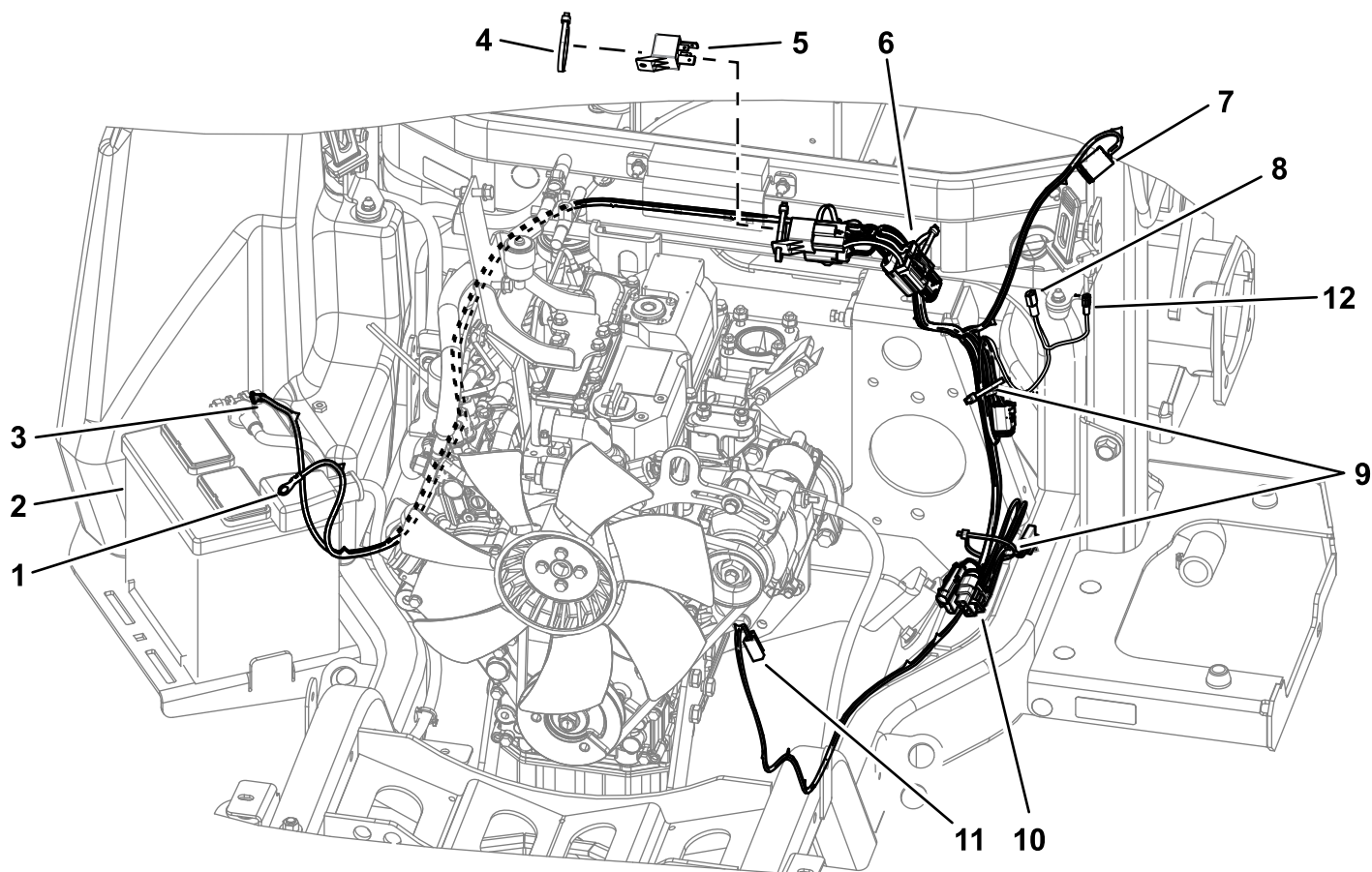

Figure 2

g285428

2. Install the relay into the harness ([Figure 3](#)).
3. Route the 2 ring terminals for the battery around the engine ([Figure 3](#)).



g398735

Figure 3

- | | | | |
|-----------------------------------|--------------|--|--------------------------------------|
| 1. Positive (+) battery connector | 4. Cable tie | 7. Optional control connection | 10. Accessory power connections |
| 2. Battery | 5. Relay | 8. Main harness connection | 11. Optional washer fluid connection |
| 3. Negative (-) battery connector | 6. Fuses | 9. Use cable ties to secure excess wire. | 12. Auxiliary power connector |

-
4. Route the harness to the connector positions shown in [Figure 3](#).
 5. Secure the harness to the machine with the cable ties shown in [Figure 3](#).

6. Rotate the latches and remove the side cover on the armrest ([Figure 4](#)).

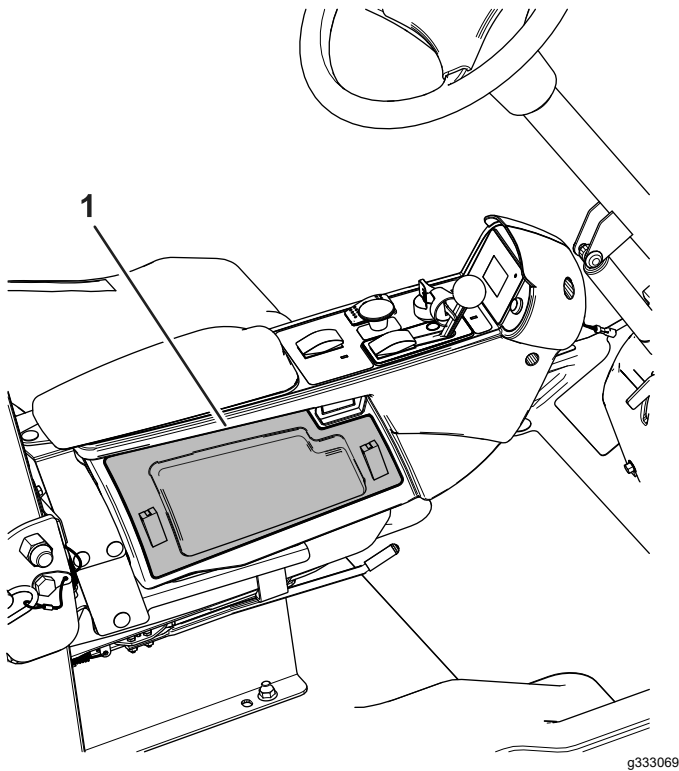

Figure 4

1. Cover

7. Install the 10 A fuse into the fuse block as shown in [Figure 5](#).

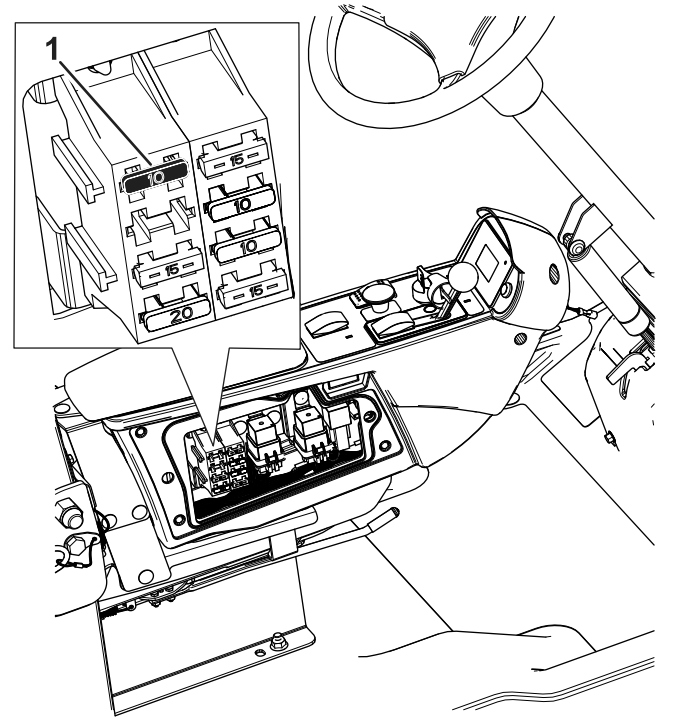

Figure 5

1. Installed 10 A fuse

8. Install the cover and secure it with the latches.

4

Connecting the Battery

No Parts Required

Procedure

⚠ WARNING

Electrical sparks can cause the battery gasses to explode, resulting in personal injury.

Incorrect battery cable routing could damage the machine and cables, causing sparks.

- Always disconnect the negative (black) battery cable before disconnecting the positive (red) cable.
- Always connect the positive (red) battery cable before connecting the negative (black) cable.

1. Connect the positive cable to the battery and tighten the battery-clamp nut ([Figure 6](#)).

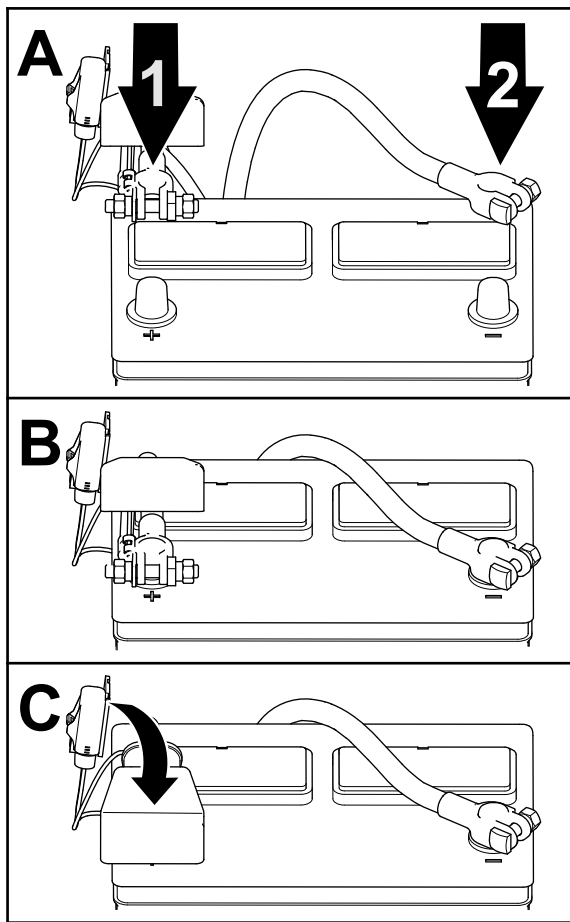

g252786

Figure 6

1. Positive battery cable
 2. Negative battery cable
-
2. Connect the negative cable to the battery and tighten the battery-clamp nut ([Figure 6](#)).
 3. Assemble the insulator over the positive battery terminal ([Figure 6](#)).

Notes:

Notes:



Count on it.