



Interior Mirror Kit

Workman® Utility Vehicle or Outcross® 9060 Series Traction Unit

Model No. 130-5449

Installation Instructions

Installation

Loose Parts

Use the chart below to verify that all parts have been shipped.

Description	Qty.	Use
No parts required	—	Prepare the machine.
Mirror assembly	1	Install the mirror (for GTX models with a canopy—Model 07921 or 07922).
Phillips-head screw (#10 x 5/8 inch)	2	
Mirror assembly	1	Install the mirror (for GTX models with a cab—Model 07142, 2-person canopy—Model 07140, 4-person canopy—Model 07141, or MD/MDE/MDX/HDX models).
Phillips-head screw (#10 x 5/8 inch)	2	
Mirror assembly	1	Install the mirror (for the Outcross 9060 Series traction unit with canopy model 07511AA or 07511BA installed).
Phillips-head screw (#10 x 5/8 inch)	2	
Mirror mount	1	
Flange-head bolt (1/4 x 3/4 inch)	2	
Locknut (1/4 inch)	2	

Preparing the Machine

1. Park the machine on a level surface.
2. Engage the parking brake.
3. Shut off the engine and remove the key.

Installing the Mirror

For GTX Models with Canopy Model 07921 or 07922

1. Apply medium-grade thread-locking compound to the 2 Phillips-head screws (#10 x 5/8 inch).
2. Secure the mirror assembly to the canopy support bracket using the 2 Phillips-head screws (#10 x 5/8 inch) as shown in [Figure 1](#).

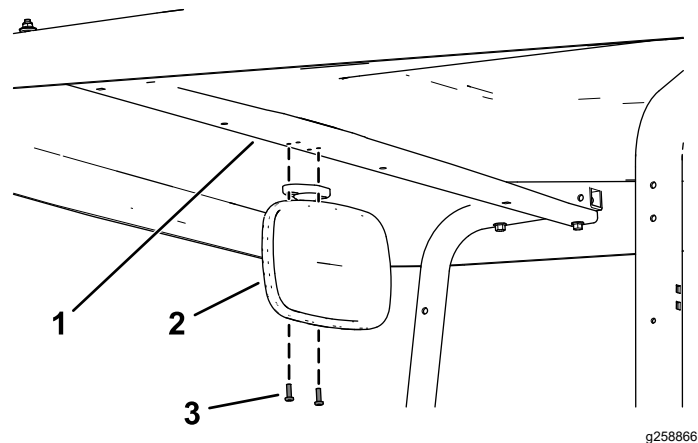

Figure 1

1. Canopy support bracket
2. Mirror assembly
3. Phillips-head screw (#10 x 5/8 inch)



Installing the Mirror

For GTX Models with Cab (Model 07142), 2-Person Canopy (Model 07140), 4-Person Canopy (Model 07141), or MD/MDE/MDX/HDX Models

1. Apply medium-grade thread-locking compound to the 2 Phillips-head screws (#10 x 5/8 inch).

Note: If you have a GTX machine, remove the 2 plastic plugs from the upper cab frame before installing the mirror assembly (Figure 2).

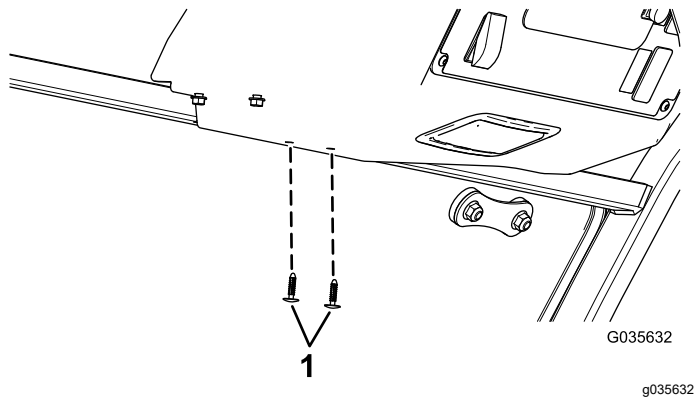

Figure 2
Workman GTX Only

1. Plastic plugs

2. Align the holes in the mount for the mirror with the holes in the upper cab frame (Figure 3 or Figure 4).
3. Assemble the mirror to the cab frame with the 2 Phillips-head screws (#10 x 5/8 inch) as shown in Figure 3 or Figure 4.
4. Torque the screws to 419 to 531 N·cm (37 to 47 in-lb).

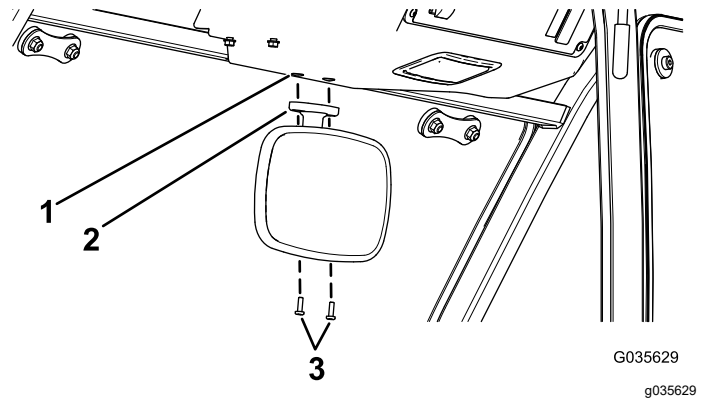

Figure 3
Workman GTX Shown

1. Hole (upper cab frame)
2. Mount (mirror)
3. Phillips-head screws (#10 x 5/8 inch)

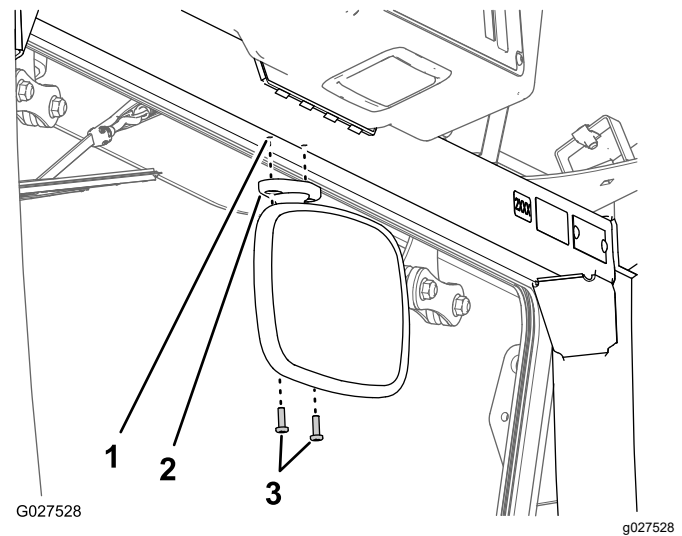

Figure 4
Workman MD/MDE/MDX/HDX Shown

1. Hole (upper cab frame)
2. Mount (mirror)
3. Phillips-head screws (#10 x 5/8 inch)

Installing the Mirror

For the Outcross 9060 Series Traction Unit with Canopy Model 07511AA or 07511BA Installed

1. Apply medium-grade thread-locking compound to the 2 Phillips-head screws (#10 x 5/8 inch).
2. Secure the mirror mount to the canopy using 2 flange-head bolts (1/4 x 3/4 inch) and 2 locknuts (1/4 inch) as shown in [Figure 5](#).

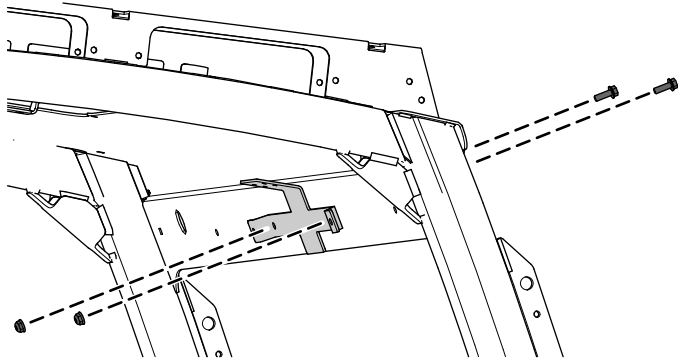

Figure 5

g409103

3. Secure the mirror to the mirror mount using 2 Phillips-head screws (#10 x 5/8 inch) as shown in [Figure 6](#).

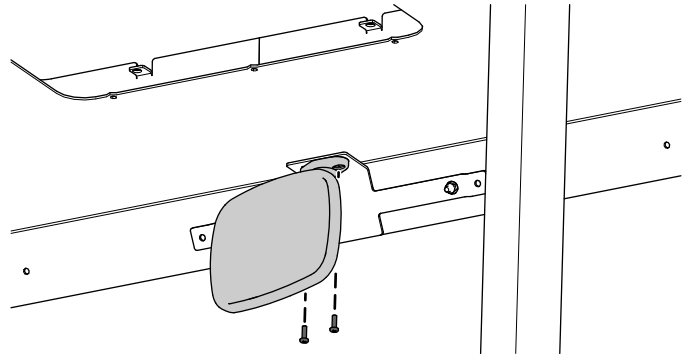

Figure 6

g409102

4. Torque the screws to 419 to 531 N·cm (37 to 47 in-lb).

Operation

Adjusting the Mirror

Important: Adjust the viewing angle of the mirror before you drive the machine.

1. Use 2 hands to rotate the mirror up or down on its ball mount (A of [Figure 7](#) or [Figure 8](#)).

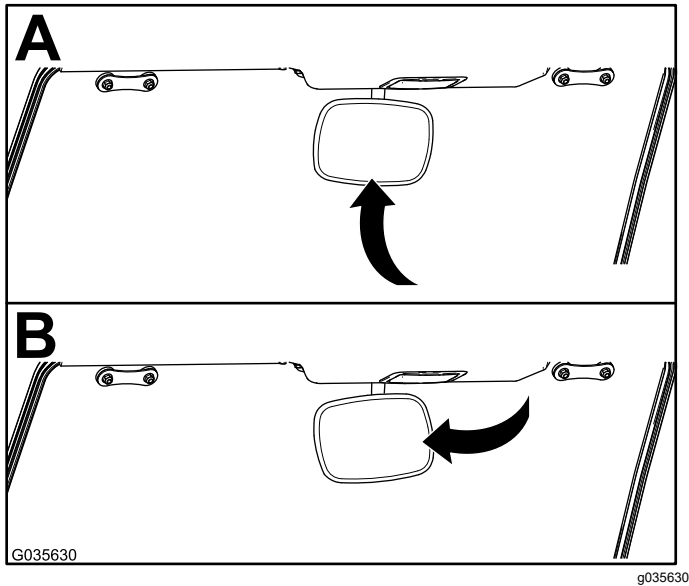

Figure 7

Workman GTX Shown

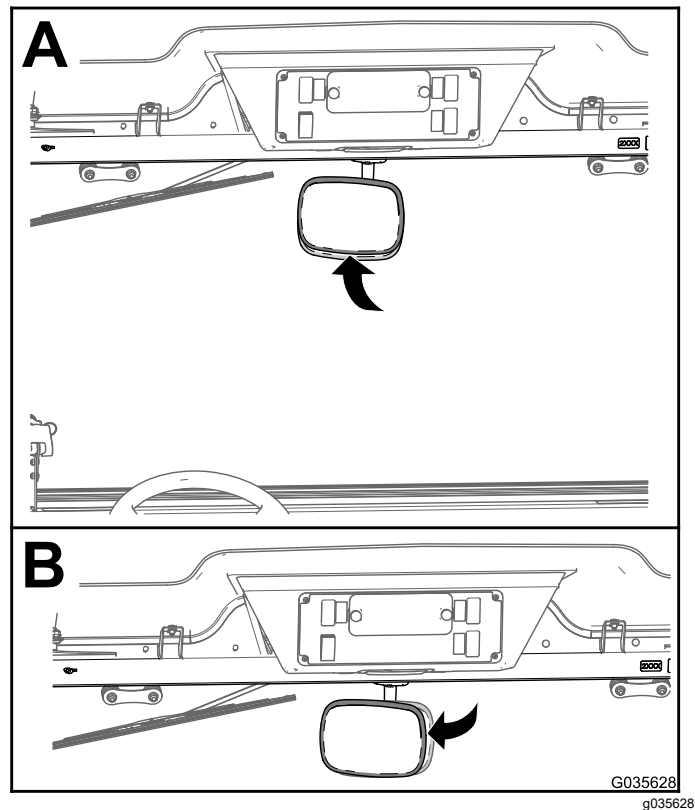

Figure 8

Workman MD/MDE/MDX/HDX Shown

2. Use 2 hands to rotate the mirror left or right on its ball mount (B of [Figure 7](#) or [Figure 8](#)).