



Finish Drag Kit

Nail Drag for Sand Pro® 2040Z Traction Unit

Model No. 08718

Operator's Manual

Introduction

Read this information carefully to learn how to operate and maintain your product properly and to avoid injury and product damage. You are responsible for operating the product properly and safely.

You may contact Toro directly at www.Toro.com for product and accessory information, help finding a dealer, or to register your product.

Whenever you need service, genuine Toro parts, or additional information, contact an Authorized Service Dealer or Toro Customer Service and have the model number of your product ready.

This manual identifies potential hazards and has safety messages identified by the safety alert symbol (Figure 1), which signals a hazard that may cause serious injury or death if you do not follow the recommended precautions.



Figure 1

g000502

1. Safety alert symbol

This manual uses 2 words to highlight information. **Important** calls attention to special mechanical information and **Note** emphasizes general information worthy of special attention.

WARNING

CALIFORNIA Proposition 65 Warning

Use of this product may cause exposure to chemicals known to the State of California to cause cancer, birth defects, or other reproductive harm.

Setup

Loose Parts

Use the chart below to verify that all parts have been shipped.

Description	Qty.	Use
Chain	2	Install the chains.
Chain sleeve	2	
Bolt (3/8 x 1-1/4 inch)	4	
Washer	8	
Locknut	4	
Bolt (3/8 x 1-1/4 inch)	4	Install the drag mat.
Washer	8	
Locknut	4	
Carrier	2	Install the carriers.
Bolt (3/8 x 3/4 inch)	4	
Locknut	4	



Note: If the top plates, the nail plate, and the nails are currently installed on the nail drag, remove them; refer to the nail drag *Operator's Manual*.

Installing the Chains

1. Slide a chain sleeve over each chain ([Figure 2](#)).

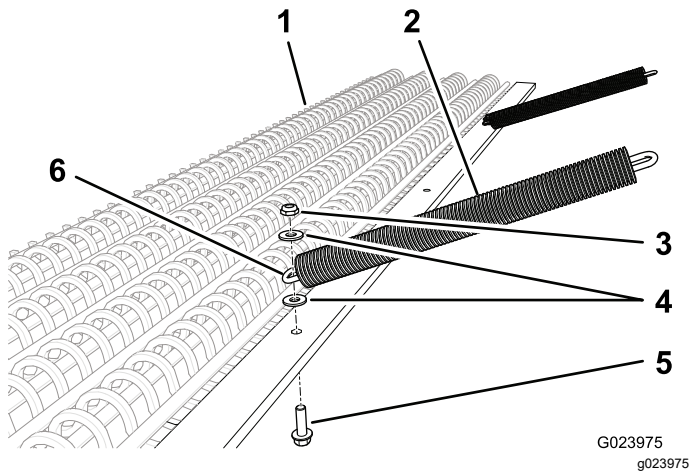

Figure 2

- | | |
|-----------------|----------------------------|
| 1. Drag mat | 4. Washers |
| 2. Chain sleeve | 5. Bolt (3/8 x 1-1/4 inch) |
| 3. Locknut | 6. Chain |

2. Align the end of a chain with 1 of the outer 2 holes in the drag mat.
3. Secure the chain to the drag mat with a bolt (3/8 x 1-1/4 inch), 2 washers, and a locknut, as shown in [Figure 2](#).
4. Repeat steps [2](#) and [3](#) for the other side.

Installing the Drag Mat

1. Align the end of a chain with the hole in the bracket on that same side of the nail drag ([Figure 3](#)).

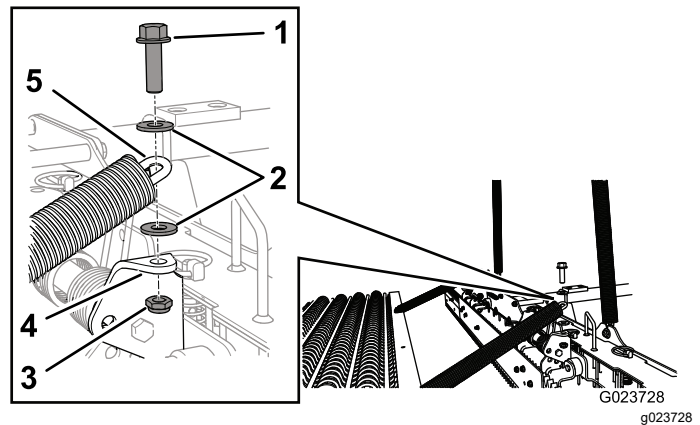

Figure 3

- | | |
|----------------------------|------------|
| 1. Bolt (3/8 x 1-1/4 inch) | 4. Bracket |
| 2. Washers | 5. Chain |
| 3. Locknut | |

2. Secure the chain to the bracket with a bolt (3/8 x 1-1/4 inch), 2 washers, and a locknut, as shown in [Figure 3](#).
3. Repeat steps [1](#) and [2](#) for the other side.

Installing the Carriers

1. If the top plates, the nail plate, and the nails are currently installed on the nail drag, remove them; refer to the nail drag *Operator's Manual*.
2. Align the bolt holes of a carrier with the holes on the front of the bottom plate of the nail drag ([Figure 4](#)).

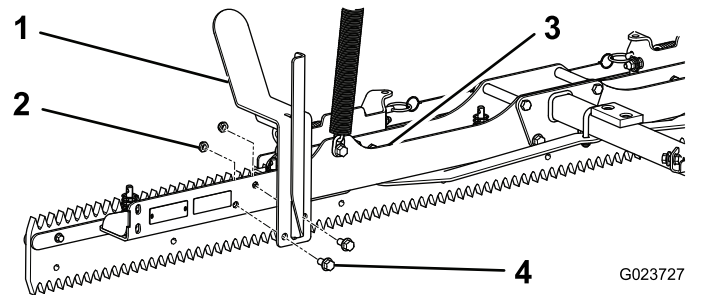

Figure 4

- | | |
|----------------|-----------------------------|
| 1. Carrier | 3. Bottom plate |
| 2. Locknut (2) | 4. Bolt (3/8 x 3/4 inch), 2 |

3. Install 2 bolts (3/8 x 3/4 inch) through the bolt holes of the carrier and the bottom plate, and secure them with 2 locknuts.
4. Repeat steps [2](#) and [3](#) for the other side.

Product Overview

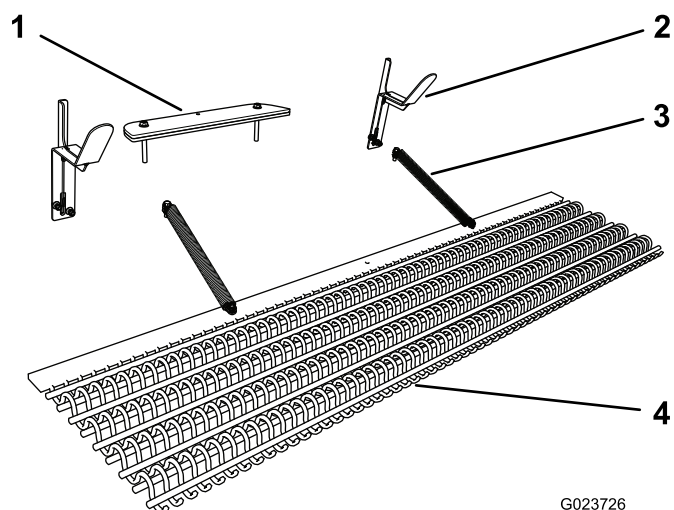

Figure 5

1. Front weights (2 included)
2. Carrier (2)
3. Chain with sleeve (2)
4. Drag mat

Operation

Installing and Removing the Weights

Always ensure that your machine has the appropriate number of weights.

Refer to the following table for how many weights are required on the front of the machine:

Attachment	Number of weights required
Flex tooth rake	4
Nail drag	6
Nail drag with finish drag mat	8

1. Remove the 2 bolts and 2 nuts securing the existing weights on the front of the machine (Figure 6).

Note: If the machine is equipped with the light kit, remove the nut and the bolt securing the front light to the machine. Retain all of the parts; refer to the *Light Kit Installation Instructions*.

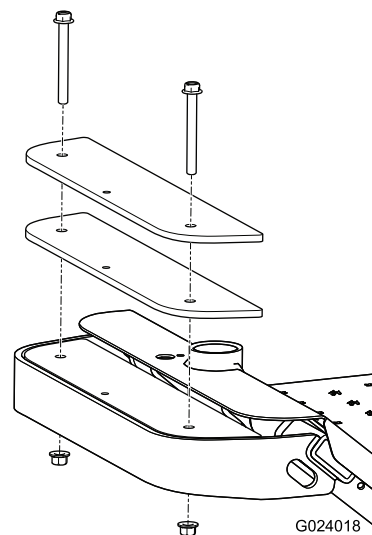

Figure 6

2. Add or remove weights as necessary.
3. Secure the weights with the 2 bolts and the 2 nuts.

The Finish Drag Mat includes 2 longer bolts to accommodate the additional weights that it requires.

Note: If the machine is equipped with the light kit, install the front light by inserting the bolt through the weights and securing it with the nut; refer to the *Light Kit Installation Instructions*.

Stowing the Drag Mat

Whenever you are not using the drag mat, stow it in the carriers.

To stow the drag mat, simply roll it up and place it in the carriers.

Using the Drag Mat

Use caution while operating the machine with the drag mat installed. Keep operating speeds to a minimum acceptable level. For maximum mat life, avoid areas and objects that may snag or interrupt the travel of the mat.

1. With the drag mat stowed in the carriers, drive the machine to an area that requires grooming.
2. Remove the drag mat from the carriers, and place it on the ground.
3. Pull the drag mat over the surface that requires grooming.
4. When you have finished or are ready to groom a different area, stow the drag mat in the carriers.

Cleaning the Drag Mat

Keep the drag mat clean. Excessive soil buildup increases the attachment weight and may affect handling of the machine.

Notes:

Notes:

Declaration of Incorporation

The Toro Company, 8111 Lyndale Ave. South, Bloomington, MN, USA declares that the following unit(s) conform(s) to the directives listed, when installed in accordance with the accompanying instructions onto certain Toro models as indicated on the relevant Declarations of Conformity.

Model No.	Serial No.	Product Description	Invoice Description	General Description	Directive
08718	and Up	Finish Drag Kit	SP2040Z FINISH DRAG MAT KIT	Drag Kit	2006/42/EC

Relevant technical documentation has been compiled as required per Part B of Annex VII of 2006/42/EC.

We will undertake to transmit, in response to requests by national authorities, relevant information on this partly completed machinery. The method of transmission shall be electronic transmittal.

This machinery shall not be put into service until incorporated into approved Toro models as indicated on the associated Declaration of Conformity and in accordance with all instructions, whereby it can be declared in conformity with all relevant Directives.

Certified:



Tom Langworthy
Engineering Director
8111 Lyndale Ave. South
Bloomington, MN 55420, USA
September 23, 2022

Authorized Representative:

Marcel Dutrieux
Manager European Product Integrity
Toro Europe NV
Nijverheidsstraat 5
2260 Oevel
Belgium

UK Declaration of Incorporation

The Toro Company, 8111 Lyndale Ave. South, Bloomington, MN, USA declares that the following unit(s) conform(s) to the directives listed, when installed in accordance with the accompanying instructions onto certain Toro models as indicated on the relevant Declarations of Conformity.

Model No.	Serial No.	Product Description	Invoice Description	General Description	Regulation
08718	and Up	Finish Drag Kit	SP2040Z FINISH DRAG MAT KIT	Drag Kit	S.I. 2008 No. 1597

Relevant technical documentation has been compiled as required per Schedule 10 of S.I. 2008 No. 1597.

We will undertake to transmit, in response to requests by national authorities, relevant information on this partly completed machinery. The method of transmission shall be electronic transmittal.

This machinery shall not be put into service until incorporated into approved Toro models as indicated on the associated Declaration of Conformity and in accordance with all instructions, whereby it can be declared in conformity with all relevant Directives.

This declaration has been issued under the sole responsibility of the manufacturer.
The object of the declaration is in conformity with relevant UK legislation.



Tom Langworthy
Engineering Director
8111 Lyndale Ave. South
Bloomington, MN 55420, USA
September 23, 2022

Authorized Representative:

Marcel Dutrieux
Manager European Product Integrity
Toro U.K. Limited
Spellbrook Lane West
Bishop's Stortford
CM23 4BU
United Kingdom