



Backfill Blade

TRX Trencher

Model No. 22980—Serial No. 316000001 and Up

Model No. 22980—Serial No. 400000000 and Up

Form No. 3458-174 Rev A

Installation Instructions

This product complies with all relevant European directives. For details, please see the Declaration of Incorporation (DOI) at the back of this publication.

Safety

Safety and Instructional Decals



Safety decals and instructions are easily visible to the operator and are located near any area of potential danger. Replace any decal that is damaged or missing.

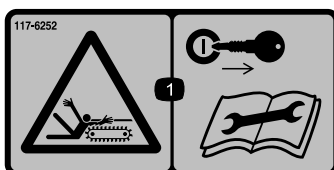

117-6252

decal117-6252

1. Entanglement hazard; trencher—remove the ignition key before installing the blade or performing any maintenance.

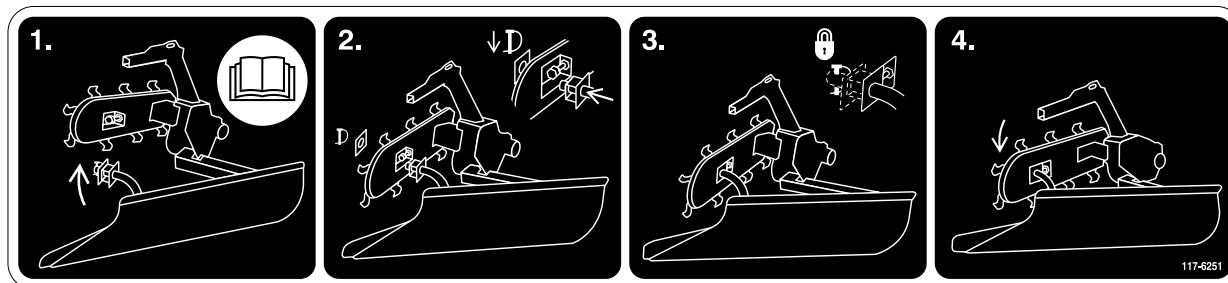

117-6251

decal117-6251

1. Insert the rear mounting bracket into the base of the trencher.
2. Insert the front mounting bracket into the boom.
3. Secure the front mounting bracket with the mounting plate and lynch pin.
4. Lower the boom to lower the blade to the ground.



Installation

Loose Parts

Use the chart below to verify that all parts have been shipped.

Description	Qty.	Use
Blade	1	Install the rear mounting bracket.
Rear mounting bracket	1	
Carriage bolt	6	
Locknut	6	
Front mounting bracket	1	Install the frontmounting bracket.
Carriage bolt	4	
Locknut	4	

Installing the Rear Mounting Bracket

Install the rear mounting bracket onto the blade using 6 carriage bolts and locknuts (Figure 1).

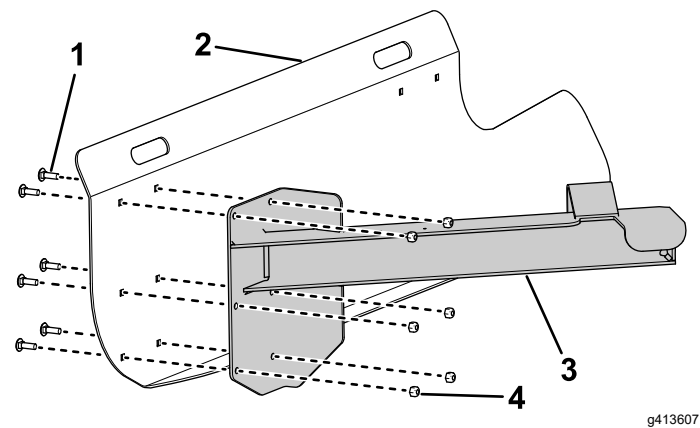

Figure 1

1. Carriage bolt
2. Blade
3. Rear mounting bracket
4. Locknut

Installing the Front Mounting Bracket

Install the front mounting bracket onto the blade using 4 carriage bolts and locknuts (Figure 2).

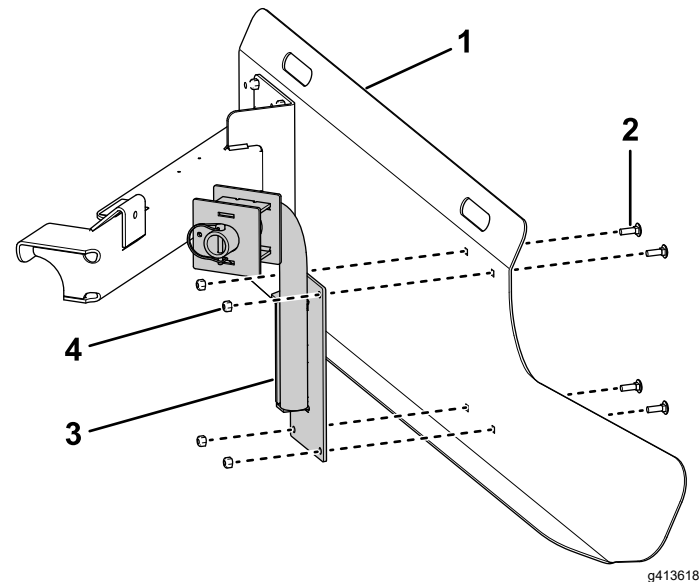

Figure 2

1. Blade
2. Carriage bolt
3. Front mounting bracket
4. Locknut

Operation

Note: Determine the left and right sides of the machine from the normal operating position.

Installing the Blade on the Trencher

⚠ DANGER

If you attempt to install or remove the blade with the trencher motor running, someone could accidentally start the chain, which could severely injure or kill you.

Always shut off the engine and remove the ignition key before attempting to install or remove the blade.

1. Raise the boom, shut off the engine, and remove the ignition key.
2. Slide the rear mounting bracket of the blade into the opening on the trencher to the left of the boom, seating it on the crossbar ([Figure 3](#)).

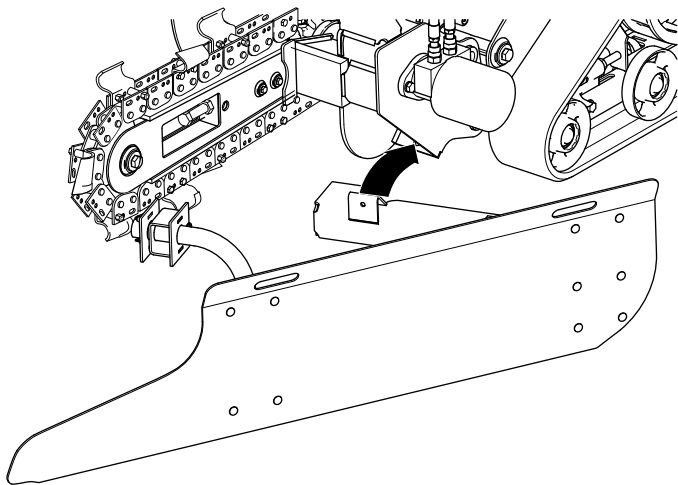

Figure 3

g413898

3. Remove the lynch pin and mounting plate from the front mounting bracket ([Figure 4](#)).

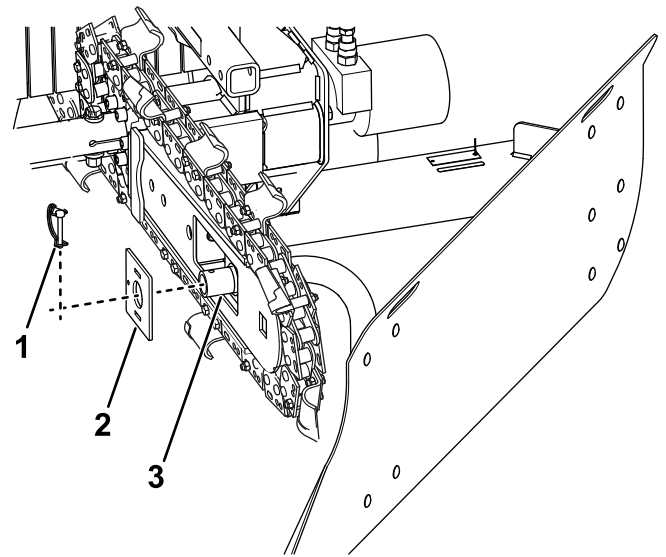

Figure 4

g413897

1. Lynch pin (lanyard not shown)
2. Mounting plate
3. Front mounting bracket

4. Swing the blade to the right, inserting the front mounting bracket into the opening in the boom ([Figure 5](#)).

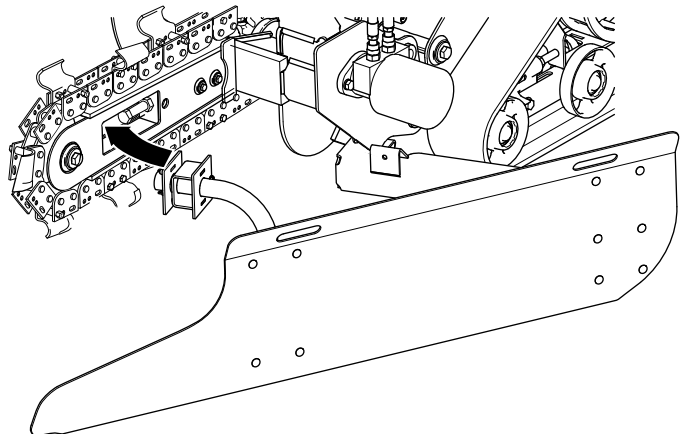

Figure 5

g413900

5. Slide the mounting plate onto the front mounting bracket, securing it with the attached lynch pin ([Figure 4](#)).

Backfilling a Trench

1. Drive the trencher with the blade attached to the end of the trench, orienting the blade just behind the spoils pile so that the left end of the blade overlaps the right side of the trench ([Figure 6](#)).

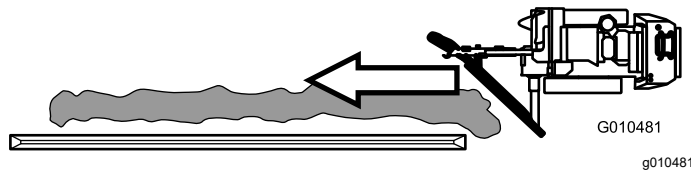

Figure 6

2. Lower the boom until the blade touches the ground, but do not dig the blade down into the ground.

Note: If you are backfilling over sod that you do not want torn up, lower the blade until it is just touching the top of the grass. That way it will push most of the soil into the trench without digging into the sod. You can then rake in the remaining soil after backfilling.

3. Drive the trencher forward, pushing the spoils soil into the trench.

Removing the Blade

⚠ DANGER

If you attempt to install or remove the blade with the trencher motor running, someone could accidentally start the chain, which could severely injure or kill you.

Always shut off the engine and remove the ignition key before attempting to install or remove the blade.

1. Raise the boom to lift the blade off of the ground.
2. Stop the engine and remove the ignition key.
3. Remove the lynch pin and mounting plate from the front mounting bracket ([Figure 4](#)).
4. Pull the front mounting bracket out of the boom and lift the blade off of the trencher.
5. Install the mounting plate and lynch pin back on the front mounting bracket for storage.

Loading the Blade on a Trailer

Remove the blade before loading the trencher on a trailer. Store and secure it separately from the trencher.

Important: If you attempt to load the trencher with the blade attached onto the Toro TRX trailer, you may damage the trailer or the blade. Always remove the blade before loading it on the trailer.

Notes:

Declaration of Incorporation

The Toro Company, 8111 Lyndale Ave. South, Bloomington, MN, USA declares that the following unit(s) conform(s) to the directives listed, when installed in accordance with the accompanying instructions onto certain Toro models as indicated on the relevant Declarations of Conformity.

Model No.	Serial No.	Product Description	Invoice Description	General Description	Directive
22980	316000001 and Up	Backfill Blade, TRX Trencher	BACKFILL BLADE FOR TRX TRENCHERS	Trencher Attachment	2006/42/EC, 2000/14/EC

Relevant technical documentation has been compiled as required per Part B of Annex VII of 2006/42/EC.

We will undertake to transmit, in response to requests by national authorities, relevant information on this partly completed machinery. The method of transmission shall be electronic transmittal.

This machinery shall not be put into service until incorporated into approved Toro models as indicated on the associated Declaration of Conformity and in accordance with all instructions, whereby it can be declared in conformity with all relevant Directives.

Certified:



Chad Moe
Sr. Engineering Manager
8111 Lyndale Ave. South
Bloomington, MN 55420, USA
November 1, 2022

Authorized Representative:

Marcel Dutrieux
Manager European Product Integrity
Toro Europe NV
Nijverheidsstraat 5
2260 Oevel
Belgium

UK Declaration of Incorporation

The Toro Company, 8111 Lyndale Ave. South, Bloomington, MN, USA declares that the following unit(s) conform(s) to the directives listed, when installed in accordance with the accompanying instructions onto certain Toro models as indicated on the relevant Declarations of Conformity.

Model No.	Serial No.	Product Description	Invoice Description	General Description	Regulation
22980	316000001 and Up	Backfill Blade, TRX Trencher	BACKFILL BLADE FOR TRX TRENCHERS	Trencher Attachment	S.I. 2008 No. 1597, S.I. 2001 No. 1701

Relevant technical documentation has been compiled as required per Schedule 10 of S.I. 2008 No. 1597.

We will undertake to transmit, in response to requests by national authorities, relevant information on this partly completed machinery. The method of transmission shall be electronic transmittal.

This machinery shall not be put into service until incorporated into approved Toro models as indicated on the associated Declaration of Conformity and in accordance with all instructions, whereby it can be declared in conformity with all relevant Directives.

This declaration has been issued under the sole responsibility of the manufacturer.
The object of the declaration is in conformity with relevant UK legislation.



Chad Moe
Sr. Engineering Manager
8111 Lyndale Ave. South
Bloomington, MN 55420, USA
November 1, 2022

Authorized Representative:

Marcel Dutrieux
Manager European Product Integrity
Toro U.K. Limited
Spellbrook Lane West
Bishop's Stortford
CM23 4BU
United Kingdom



Toro Compact Utility Equipment Warranty

A One-Year Limited Warranty

Compact Utility Equipment
(CUE) Products

Conditions and Products Covered

The Toro Company and its affiliate, Toro Warranty Company, pursuant to an agreement between them, jointly warrant your Toro Compact Utility Equipment ("Product") to be free from defects in materials or workmanship. The following time periods apply from the date of purchase:

Products	Warranty Period
Pro Sneak Compact Utility Loaders, Trenchers, Stump Grinders, and Attachments Kohler Engines	1 year or 1000 operating hours, whichever occurs first 3 years*
All other Engines	2 years*

Where a warrantable condition exists, we will repair the Product at no cost to you including diagnosis, labor, and parts.

*Some engines used on Toro Products are warranted by the engine manufacturer.

Instructions for Obtaining Warranty Service

If you think that your Toro Product contains a defect in materials or workmanship, follow this procedure:

1. Contact any Authorized Toro Compact Utility Equipment (CUE) Service Dealer to arrange service at their dealership. To locate a dealer convenient to you, access our website at www.Toro.com. You may also call our Toro Customer Care Department toll free at the number below.
2. Bring the product and your proof of purchase (sales receipt) to the Service Dealer.
3. If for any reason you are dissatisfied with the Service Dealer's analysis or with the assistance provided, contact us at:

SWS Customer Care Department
Toro Warranty Company
8111 Lyndale Avenue South
Bloomington, MN 55420-1196
Toll Free: 888-384-9940

Owner Responsibilities

You must maintain your Toro Product by following the maintenance procedures described in the *Operator's Manual*. Such routine maintenance, whether performed by a dealer or by you, is at your expense. Parts scheduled for replacement as required maintenance ("Maintenance Parts"), are warranted for the period of time up to the scheduled replacement time for that part. Failure to perform required maintenance and adjustments can be grounds for disallowing a warranty claim.

Items and Conditions Not Covered

Not all product failures or malfunctions that occur during the warranty period are defects in materials or workmanship. This express warranty does not cover the following:

- Product failures which result from the use of non-Toro replacement parts, or from installation and use of add-on, modified, or unapproved accessories
- Product failures which result from failure to perform required maintenance and/or adjustments
- Product failures which result from operating the Product in an abusive, negligent or reckless manner
- Parts subject to consumption through use unless found to be defective. Examples of parts which are consumed, or used up, during normal product operation include, but are not limited to, belts, wipers, spark plugs, tires, filters, gaskets, wear plates, seals, O-rings, drive chains, clutches.
- Failures caused by outside influence. Items considered to be outside influence include, but are not limited to, weather, storage practices, contamination, use of unapproved coolants, lubricants, additives, or chemicals, etc.
- Normal "wear and tear" items. Normal "wear and tear" includes, but is not limited to, worn painted surfaces, scratched decals, etc.
- Repairs necessary due to failure to follow recommended fuel procedure (consult *Operator's Manual* for more details)
 - Removing contaminants from the fuel system is not covered
 - Use of old fuel (more than one month old) or fuel which contains more than 10% ethanol or more than 15% MTBE
 - Failure to drain the fuel system prior to any period of non-use over one month
- Any component covered by a separate manufacturer's warranty
- Pickup and delivery charges

General Conditions

Repair by an Authorized Toro Compact Utility Equipment (CUE) Service Dealer is your sole remedy under this warranty.

Neither The Toro Company nor Toro Warranty Company is liable for indirect, incidental or consequential damages in connection with the use of the Toro Products covered by this warranty, including any cost or expense of providing substitute equipment or service during reasonable periods of malfunction or non-use pending completion of repairs under this warranty. All implied warranties of merchantability and fitness for use are limited to the duration of this express warranty. Some states do not allow exclusions of incidental or consequential damages, or limitations on how long an implied warranty lasts, so the above exclusions and limitations may not apply to you.

This warranty gives you specific legal rights, and you may also have other rights which vary from state to state.

Except for the engine warranty coverage and the Emissions warranty referenced below, if applicable, there is no other express warranty. The Emissions Control System on your Product may be covered by a separate warranty meeting requirements established by the U.S. Environmental Protection Agency (EPA) or the California Air Resources Board (CARB). The hour limitations set forth above do not apply to the Emissions Control System Warranty. Refer to the California Emission Control Warranty Statement supplied with your Product or contained in the engine manufacturer's documentation for details.

Countries Other than the United States or Canada

Customers who have purchased Toro products outside the United States or Canada should contact their Toro Distributor (Dealer) to obtain guarantee policies for your country, province, or state. If for any reason you are dissatisfied with your Distributor's service or have difficulty obtaining guarantee information, contact the Toro importer. If all other remedies fail, you may contact us at Toro Warranty Company.

Australian Consumer Law: Australian customers will find details relating to the Australian Consumer Law either inside the box or at your local Toro Dealer.