



Groomer Brush

Greensmaster® 1000

Greensmaster® Flex 21

Model No. 105-9640

Model No. 105-9636

Parts Catalog

Ordering Replacement Parts

To order replacement parts, please supply: the part number, the quantity, and the description of each part desired.

Understanding Reference Numbers

Each identified part in an illustration has a reference number. The reference number for a part also appears in the parts list, along with other information about the part.

This catalog uses two special reference number formats, one to indicate parts in a service assembly and another to indicate the quantity of a given part in an illustration.

Service Assembly Reference Numbers

Parts in service assemblies have reference numbers in the form **a:b**. The **a** represents the reference number of the entire service assembly and the **b** represents a sequential number unique to each part within the service assembly.

For example, a wheel assembly might be identified by reference number **6**, the tire by **6:1**, the valve by **6:2**, and the wheel by **6:3**. When you order the assembly identified by reference number **6**, you receive all parts identified by reference numbers **6:1**, **6:2**, and **6:3**. However, you may also order any part individually.

Reference numbers of this type appear in illustrations and in part lists.

Reference Numbers Indicating Quantity

In an illustration, if a reference number indicates more than one part, the reference number has the form **nX y**. The **n** represents the quantity of the part, the **X** is the multiplication symbol, and the **y** represents the reference number.

For example, in an illustration, the reference number **2X 37** means that two of the parts identified by reference number **37** are indicated.

This diagram shows an exploded view of a mechanical assembly. It consists of four main components labeled with numbers 1 through 4:

- Component 1:** A small hexagonal nut.
- Component 2:** A U-shaped bracket or clip.
- Component 3:** A long, flexible, corrugated tube or hose.
- Component 4:** A long, straight rod or shaft with a threaded section at one end.

The diagram illustrates how these components fit together. The rod (4) passes through the nut (1) and the U-bracket (2). The corrugated tube (3) is shown sliding over the rod. A dashed line indicates the assembly path, and a break symbol (two parallel diagonal lines) is used to show that the rod is longer than depicted.

Groomer Brush Assembly (only on: 105–9636)

Ref. No.	Part No.	Qty.	Description

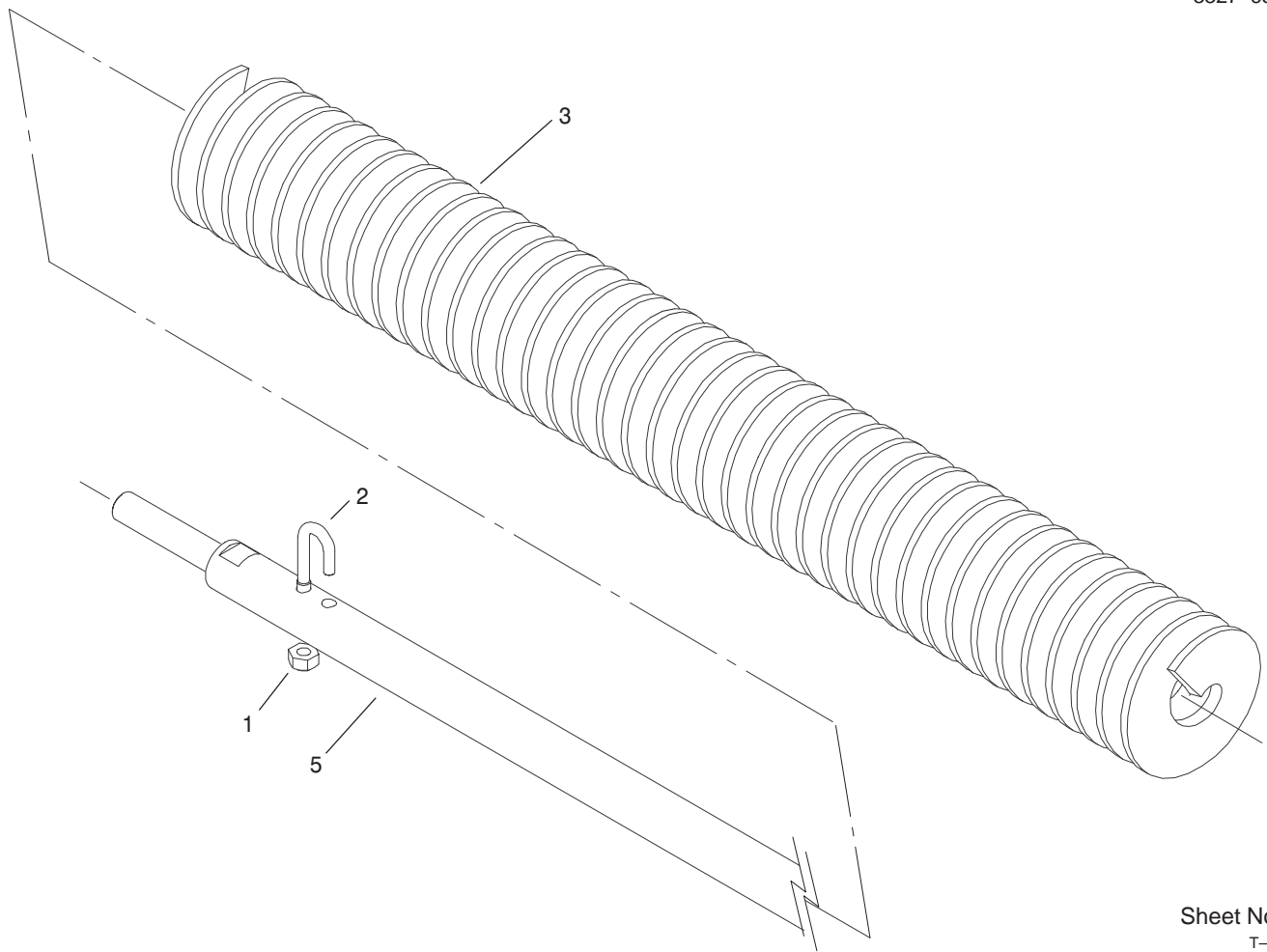

Sheet No.:0
T-3885

Groomer Brush Assembly (only on: 105–9640)

Ref. No.	Part No.	Qty.	Description
1	3296-2	2	Nut-Lock
2	105-9632	2	Bolt-J
3	105-9635	1	Brush
5	105-9639	1	Shaft-Brush, Groomer (Gr1000)

Ref. No.	Part No.	Qty.	Description

