



SH/EH Twin Spinner

MH-400 Material Delivery Unit

Model No. 44944

Installation Instructions

This product complies with all relevant European directives. For details, please see the Declaration of Incorporation (DOI) at the back of this publication.

Safety

Safety and Instructional Decals



Safety decals and instructions are easily visible to the operator and are located near any area of potential danger. Replace any decal that is damaged or missing.

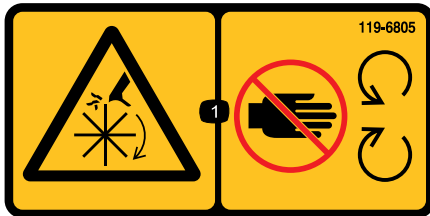

decal119-6805

119-6805

1. Cutting/dismemberment hazard, impeller—stay away from moving parts, keep all guards and shields in place.

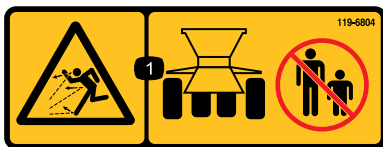

decal119-6804

119-6804

1. Thrown object hazard—keep bystanders away from the machine.

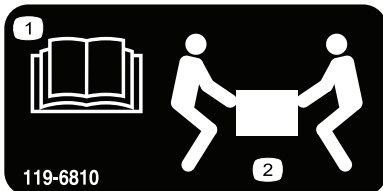

decal119-6810

119-6810

1. Read the *Operator's Manual*.
2. Use two people required to lift.

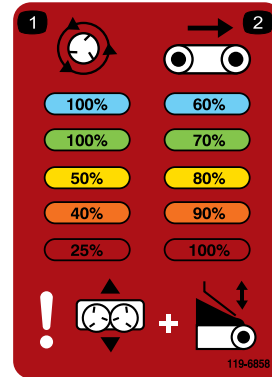

decal119-6858

119-6858

1. Spinner speed percentage
2. Belt speed percentage



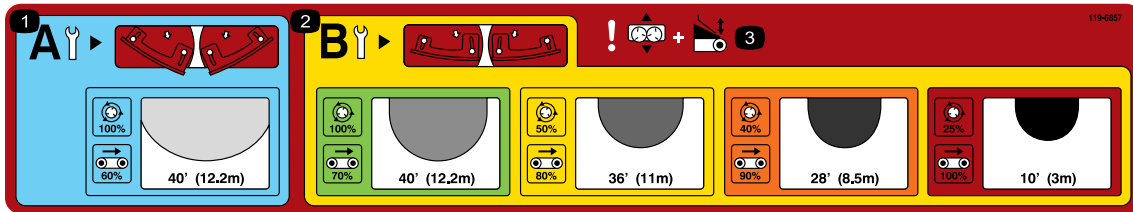

decal119-6857

119-6857

1. Light spread spinner adjustment settings (refer to the Operation section for more information).
2. Heavy spread spinner adjustment settings (refer to the Operation section for more information).
3. Warning—slide adjustment and tailgate adjustment.

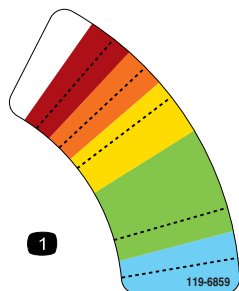

decal119-6859

119-6859

1. Spinner speed adjustment

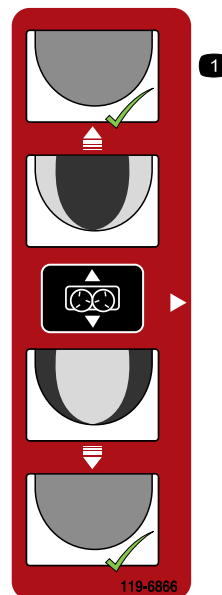

decal119-6866

119-6866

1. Fine tuning spinners



decal119-6865

119-6865

1. Slide adjustment

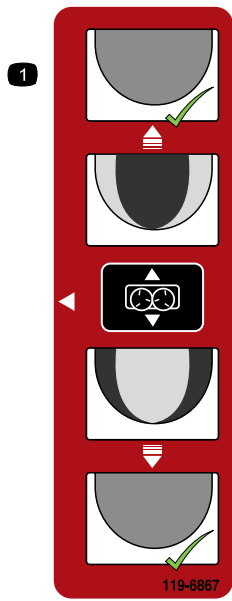

decal119-6867

119-6867

1. Fine tuning spinners



decal119-6868

119-6868

1. Slide adjustment

Installation

Loose Parts

Use the chart below to verify that all parts have been shipped.

Procedure	Description	Qty.	Use
1	Hopper guard	1	Install the hopper guard.
	Bolt (1/4 x 5/8 inch)	5	
	Flange nut (1/4 inch)	5	
2	Twin spinner	1	Install the twin spinner.
	Quick attach mounting clamps (supplied with the MH-400)	2	
3	No parts required	—	Connect the hydraulic hoses.
4	No parts required	—	Set the desired spread pattern.
5	No parts required	—	Operate the twin spinner.
6	Decal (Part No. 119-6858)	1	Affix the decal (EH models only).
7	No parts required	—	Fine-tune the twin spinner.

Media and Additional Parts

Description	Qty.	Use
Operators Manual	1	Use for set up
Parts catalog	1	Use to reference part numbers

1

Installing the Hopper Guard

Parts needed for this procedure:

1	Hopper guard
5	Bolt (1/4 x 5/8 inch)
5	Flange nut (1/4 inch)

Procedure

1. Remove the hopper front guard from its shipping position.
2. Install the hopper guard to the front of the spreader hopper with 5 bolts (1/4 x 5/8 inch) inch bolts and flange nuts ([Figure 1](#)).

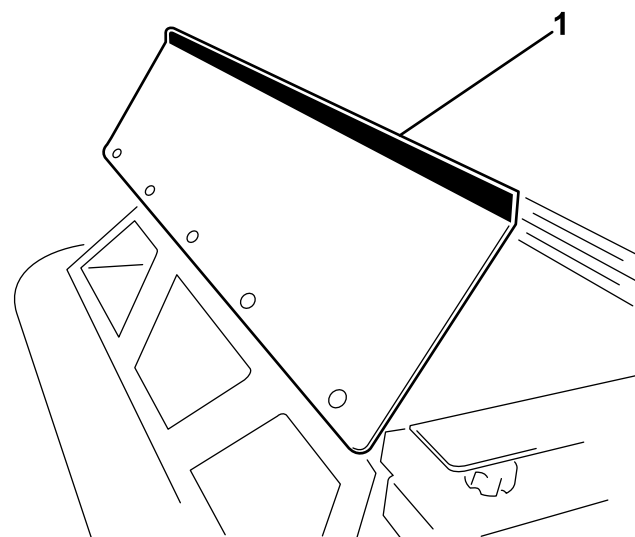

g014078

g014078

Figure 1

1. Hopper front guard

2

Installing the Twin Spinner

Parts needed for this procedure:

1	Twin spinner
2	Quick attach mounting clamps (supplied with the MH-400)

Procedure

The MH-400 comes equipped with a pair of quick attach mounting clamps. Use these clamps to mount the twin spinner to the MH-400.

1. Remove the safety latch clips from the clamp handles (Figure 2).
2. Lift the safety latch, then lift the option attachment clamp handles, and release the lock rings from the lock pins (Figure 2).
3. Slide the rear option attachment clamp assembly out of the quick-attach slots (Figure 2).
4. With assistance, insert the front edge of the twin spinner up and under the rear of the MH-400 into the front clamps on the brackets (Figure 2).

5. While supporting the twin spinner, slide the rear option attachment clamp assembly back into the slots in the brackets, and over the rear edge (Figure 2).
6. Ensure that the twin spinner is centered between the brackets. Then re-install the lock rings over the lock pins and push down on the clamp handles.

Note: If the clamp assembly is too loose and the twin spinner slides within the clamps, turn the lock rings into the clamps a few turns until the twin spinner is secure.

Important: Do not over-tighten the clamps. This may bend the edges of the twin spinner.

7. Reinstall the safety latch clips to the clamp handles (Figure 2).

Important: Ensure that you install the safety latch clips into the clamps. Otherwise, the clamps may open during operation.

⚠ WARNING

The twin spinner is heavy.

Have an assistant help you lift the twin spinner.

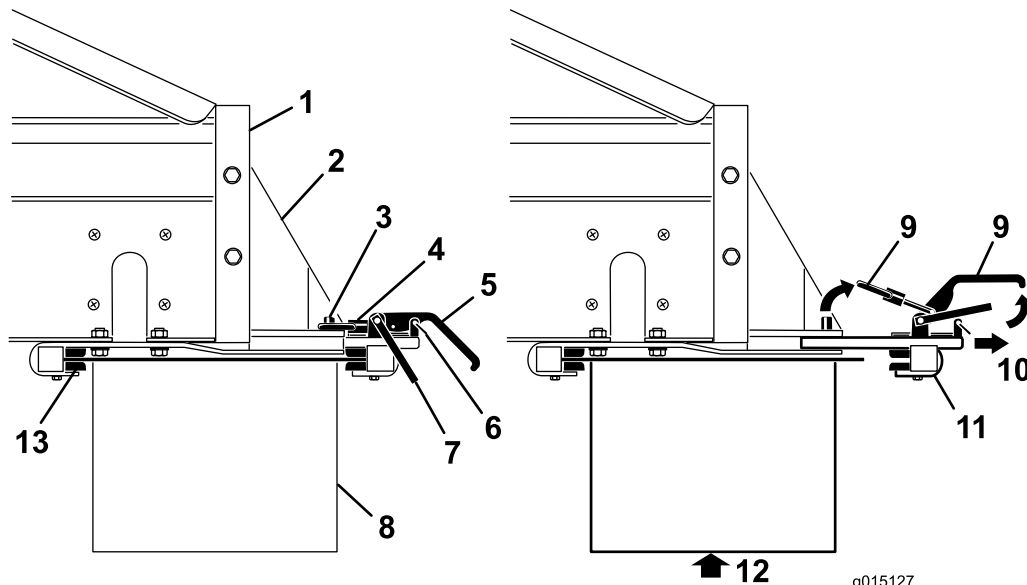

Figure 2

- | | | | |
|------------------------------|----------------------|---|--------------------------|
| 1. Rear of MH-400 | 5. Clamp handle | 9. Lift | 13. Front clamp brackets |
| 2. Option attachment bracket | 6. Safety latch clip | 10. Pull | |
| 3. Lock pin | 7. Safety latch | 11. Rear clamp assembly | |
| 4. Lock ring | 8. Twin spinner | 12. Support the twin spinner before removing the clamps | |

3

Connecting the Hydraulic Hoses

No Parts Required

Procedure

⚠ WARNING

If the twin spinner is on when you connect the hydraulic hoses, the twin spinner will spin and could cause injury to you or bystanders.

Turn off the tow vehicle before making the hydraulic connections.

Connect the hydraulic hoses to the option control valve on the MH-400 as follows ([Figure 3](#)):

- Pull back (or push forward) on the outer sleeve of the female connector and insert the male connector.
- Hold the male connector firmly in place and release the outer sleeve of the female connector.
- Ensure that the connectors are pushed all the way in and are securely locked in place.
- With the tow vehicle hydraulics operating, pull back on the option control lever on the SH models or start the option using the option start button on the wireless controller on the EH models, and ensure that the twin spinner is operating properly.

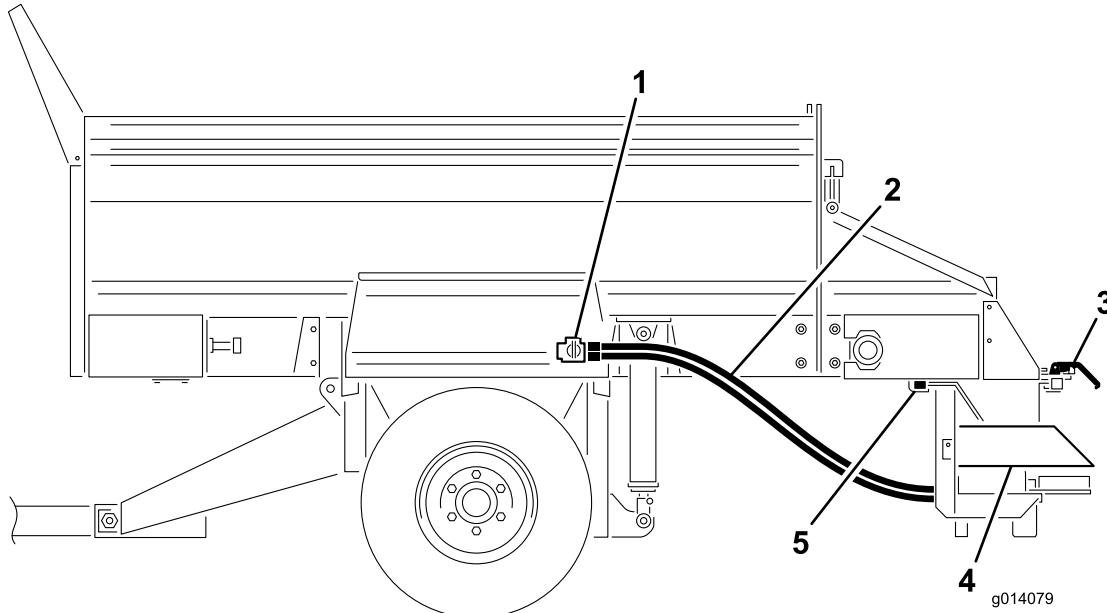

Figure 3

- | | |
|-------------------------|-------------------------|
| 1. Option control valve | 4. Twin Spinner |
| 2. Hydraulic hoses | 5. Front clamp brackets |
| 3. Quick-attach clamps | |

4

Setting the Desired Spread Pattern

No Parts Required

Select the Desired Spread Pattern

- A-Ultra Light Pattern
- B-Light to Heavy Spread Pattern

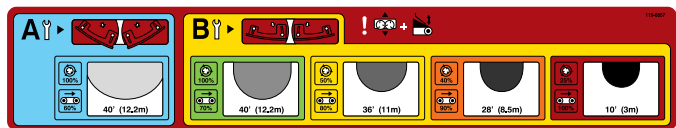

g015028
g015028

Figure 4

Note: The Twin Spinner is shipped from the factory in the “B” position.

Review the blade position and change the blades, if necessary.

Note: For this example, we will select **YELLOW**.

Setting the Drop Zone Position

1. Loosen the handle on each side of the twin spinner (Figure 5).

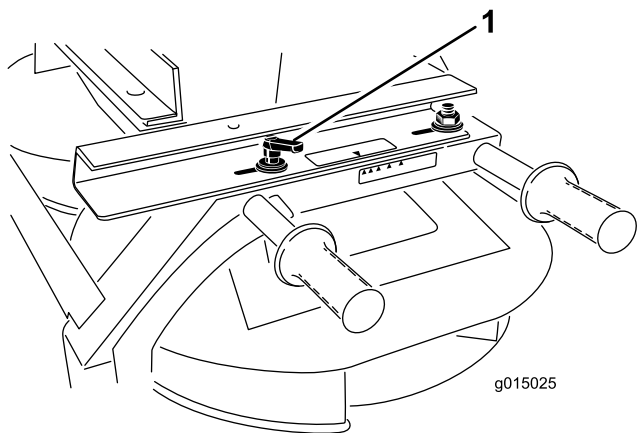

g015025

Figure 5

1. Handle

2. Slide the twin spinner fore and aft until the arrows match the desired color.
3. Tighten the handles.

Note: For this example, we will select **YELLOW**.

Adjusting the Spinner Valve

MH-400 SH models

1. Loosen the knob securing the spinner valve lever (Figure 6).

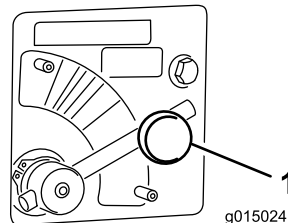

g015024

Figure 6

1. Spinner valve
2. Rotate the spinner valve lever to the desired color (Figure 6).

Note: For this example, we will select **YELLOW**.

MH-400 EH models

Move the spinner valve lever to the **BLUE** section (MAX SPEED) (Figure 6). The lever should be horizontal when turned completely clockwise.

Use the spinner percent listed on the spread pattern decal or the wireless remote decal to determine the value that is inputted into the wireless controller.

Refer to the MH-400 *Operator's Manual* for the operating instructions.

Note: For this example, we will set the option percent to **50 percent** matching the yellow color spread pattern previously selected.

Adjusting the Hopper Gate and Belt Speed

MH-400 SH models

Rotate the crank to adjust the cylinder until the arrow aligns with the center of the **YELLOW** section, which is number 3 (Figure 7).

The adjustment of the spread density will be controlled through the main hopper gate opening or through the tow vehicle.

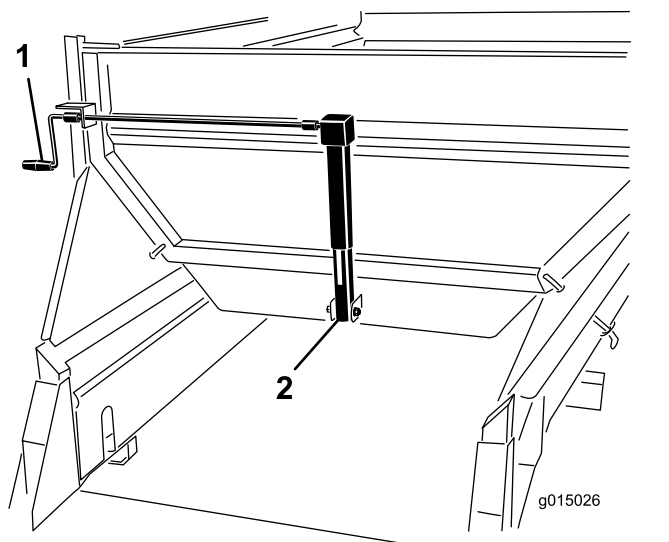

Figure 7

1. Crank
2. Hydraulic cylinder

MH-400 EH models

Note: For this example, we will select the **YELLOW** section.

Using the wireless controller, set the floor belt speed to the corresponding color.

Note: For this example, we will set the option percent to **80 percent** matching the yellow color spread pattern previously selected.

Refer to the MH-400 *Operator's Manual* for the operating instructions.

Adjusting the Main Hopper Height

Using the hydraulic controls on the SH model or the wireless controller on the EH model, adjust the main hopper hydraulic cylinders until the arrow aligns with the GREEN section on the hydraulic cylinder decal (Figure 8).

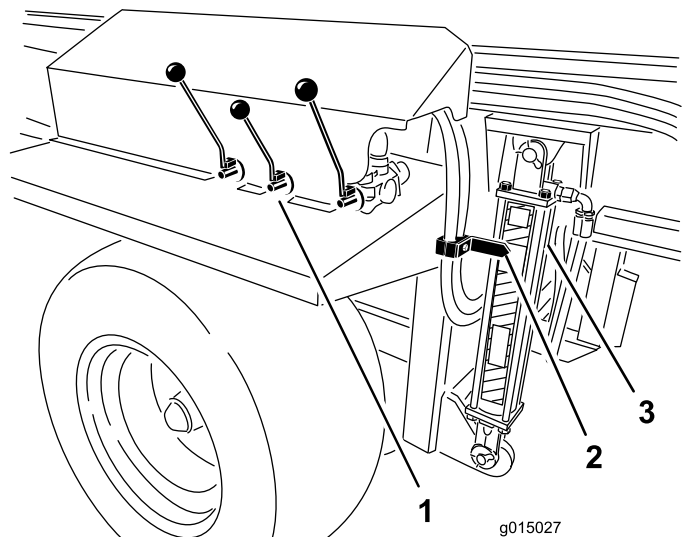

Figure 8

1. Hydraulic controls
2. Arrow
3. Cylinder

Refer to the MH-400 *Operator's Manual* for the operating instructions.

5

Operate the Twin Spinner

No Parts Required

Procedure

Operate the machine to verify that the desired performance is attained. Refer to the MH-400 *Operator's Manual* for the operating instructions.

6

Affixing the Decal to the Wireless Controller (EH models only)

Parts needed for this procedure:

1	Decal (Part No. 119-6858)
---	---------------------------

Procedure

Affix the decal to the battery cover on the back of the wireless controller (Figure 9).

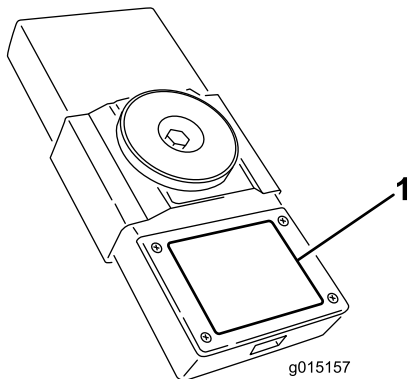

Figure 9

1. Decal

7

Fine-Tuning the Twin Spinner

No Parts Required

Procedure

1. Verify that all the settings are correct.
2. If the spread pattern is not to the desired consistency, loosen the handles and slide the hopper in the desired direction to attain the desired spread pattern.

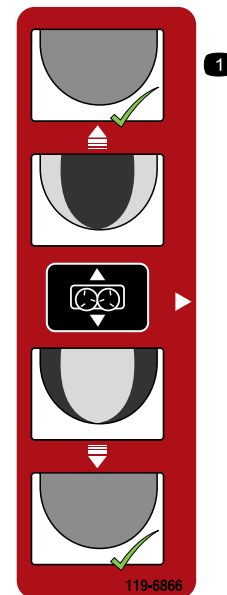

Figure 10

decal119-6866

Declaration of Incorporation

The Toro Company, 8111 Lyndale Ave. South, Bloomington, MN, USA declares that the following unit(s) conform(s) to the directives listed, when installed in accordance with the accompanying instructions onto certain Toro models as indicated on the relevant Declarations of Conformity.

Model No.	Serial No.	Product Description	Invoice Description	General Description	Directive
44944	—	SH/EH Twin Spinner, MH-400 Material Delivery Unit	MH-400 TWIN SPINNER SH/EH	Twin Spinner	2014/30/EU, 2000/14/EC

Relevant technical documentation has been compiled as required per Part B of Annex VII of 2006/42/EC.

We will undertake to transmit, in response to requests by national authorities, relevant information on this partly completed machinery. The method of transmission shall be electronic transmittal.

This machinery shall not be put into service until incorporated into approved Toro models as indicated on the associated Declaration of Conformity and in accordance with all instructions, whereby it can be declared in conformity with all relevant Directives.

Certified:



Tom Langworthy
Engineering Director
8111 Lyndale Ave. South
Bloomington, MN 55420, USA
July 12, 2023

Authorized Representative:

Marcel Dutrieux
Manager European Product Integrity
Toro Europe NV
Nijverheidsstraat 5
2260 Oevel
Belgium

UK Declaration of Incorporation

The Toro Company, 8111 Lyndale Ave. South, Bloomington, MN, USA declares that the following unit(s) conform(s) to the directives listed, when installed in accordance with the accompanying instructions onto certain Toro models as indicated on the relevant Declarations of Conformity.

Model No.	Serial No.	Product Description	Invoice Description	General Description	Regulation
44944	—	SH/EH Twin Spinner, MH-400 Material Delivery Unit	MH-400 TWIN SPINNER SH/EH	Twin Spinner	S.I. 2016 No. 1091, S.I. 2001 No. 1701

Relevant technical documentation has been compiled as required per Schedule 10 of S.I. 2008 No. 1597.

We will undertake to transmit, in response to requests by national authorities, relevant information on this partly completed machinery. The method of transmission shall be electronic transmittal.

This machinery shall not be put into service until incorporated into approved Toro models as indicated on the associated Declaration of Conformity and in accordance with all instructions, whereby it can be declared in conformity with all relevant Directives.

This declaration has been issued under the sole responsibility of the manufacturer.
The object of the declaration is in conformity with relevant UK legislation.



Tom Langworthy
Engineering Director
8111 Lyndale Ave. South
Bloomington, MN 55420, USA
July 12, 2023

Authorized Representative:

Marcel Dutrieux
Manager European Product Integrity
Toro U.K. Limited
Spellbrook Lane West
Bishop's Stortford
CM23 4BU
United Kingdom



Count on it.