



Light Kit Greensmaster® 3150 Part No. 105-8336

Form No. 3327-843

Installation Instructions

Loose Parts

Description	Qty.	Use
Light bar	1	Attaching the lights
Self-tapping screw, 5/16 x 5/8 in.	2	
Light assembly	2	
Wire harness	1	Connecting the wire harness
Fuse	1	
Cable tie, short	5	
Cable tie, long	2	

Attaching the Lights



Caution



If you leave the key in the ignition switch, someone could accidentally start the engine and seriously injure you or other bystanders.

Remove the key from the ignition and disconnect the wire(s) from the spark plug(s) before you do any maintenance. Set the wire(s) aside so that it does not accidentally contact the spark plug(s).

1. Disconnect the negative (-) battery cable from the battery.
2. Enlarge the 2 holes in the front frame tube to 9/32 in. diameter (Fig. 1).
3. Attach the light bar to the front frame tube with 2 self-tapping screws (5/16 x 5/8 in.). The slotted hole should be toward the right side of the machine (Fig. 1).
4. Remove the carriage bolt (5/16 x 1 in.), lock washer, and nut from each light assembly and use them to attach a light to each end of the light bar (Fig. 1).

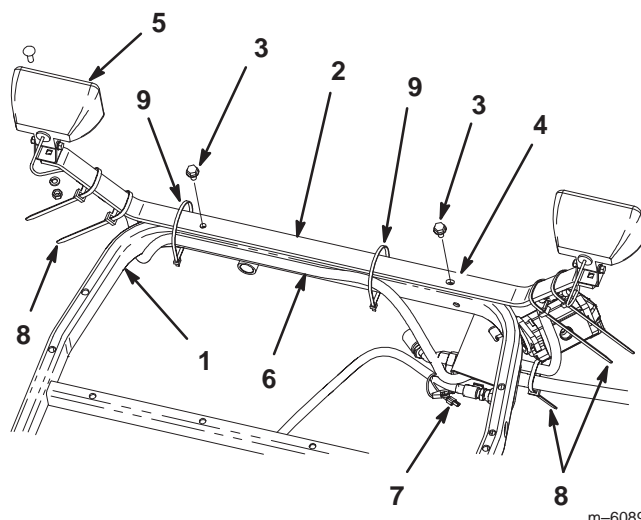

m-6089

Figure 1

- | | |
|--|--------------------|
| 1. Front frame tube | 5. Light assembly |
| 2. Light bar | 6. Light harness |
| 3. Self-tapping screws, 5/16 x 5/8 in. | 7. To main harness |
| 4. Slotted hole | 8. Short cable tie |
| | 9. Long cable tie |

Connecting the Wire Harness

1. Locate the main wire harness connectors under the floor plate, near the traction pedal. Remove the cable tie securing the white and black wires to the main harness.
2. Remove the protective plastic from the small connectors, and plug the light kit harness connectors into the main harness (Fig. 1).
3. Route the short end of the light harness under the floor plate, around the back side of the bulkhead bracket, forward through the middle of the bracket, and over the hose up to the light bar as shown in Figure 1. Plug the harness connector into the right lamp.
4. Loosely secure the harness to the top of the outer reel motor hose and the bottom of the light bar with 3 short cable ties (Fig. 1).
5. Route the long end of the light harness under the floor plate, behind the front frame tube as shown in Figure 1.
6. Loop a long cable tie through the brake cutout hole in the floor plate and around the harness and frame tube. Loosely secure the cable tie.
7. Loop a long cable tie through the left corner opening in the floor plate and around the harness and frame tube. Loosely secure the cable tie.
8. Plug the light harness connector into the left lamp. Loosely secure the harness to the bottom of the light bar with 2 short cable ties (Fig. 1).
9. Adjust the wire harness so that it does not interfere with the reels or brake and pedal linkages. Make sure that the wire harness will not be damaged when the right front cutting unit motor is disconnected and plugged into the storage tube on the front frame.
10. Secure all cable ties and cut off the excess ends.
11. Install a 10 amp fuse into the second slot from the front in the fuse block (Fig. 2).
12. Connect the negative (–) battery cable to the battery.
13. Turn on the lights using the switch on the left control panel (Fig. 2).
14. Aim the lights in the desired direction; then tighten the mounting nuts on the lights.

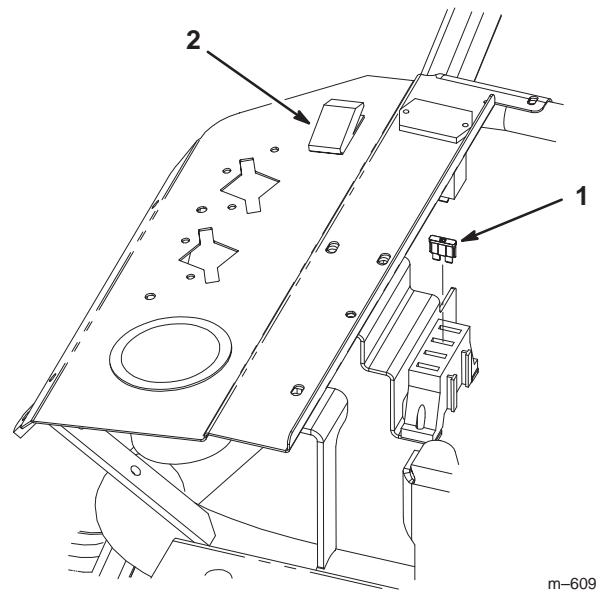

m-6091

Figure 2

1. Fuse

2. Light switch