



Torsion Idler Kit

GrandStand® Mower, With TURBO FORCE® Cutting Unit

Model No. 147-5036

Model No. 147-5037

Model No. 147-5038

Installation Instructions

Installation

Loose Parts

Use the chart below to verify that all parts have been shipped.

Procedure	Description	Qty.	Use
1	No parts required	–	Prepare the machine.
2	No parts required	–	Remove the deck V-belt.
3	No parts required	–	Remove the idler arm.
4	Torsion idler arm Bolt (3/8 x 3-1/4 inches) Flange nut (3/8 inch) Locknut (3/8 inch)	1 1 1 3	Install the torsion idler arm.
5	Deck V-belt	1	Install the deck V-belt.



1

Preparing the Machine

No Parts Required

Procedure

1. Park the machine on a level surface.
2. Disengage the PTO, engage the parking brake, and move the motion-control levers outward to the NEUTRAL-LOCK position.
3. Shut off the engine and remove the key.
4. Remove the negative (-) battery cable from the battery.
5. Using a floor jack or overhead lifting device, raise the machine until the deck is off the ground.
6. Use jack stands or blocks to secure the deck in place.

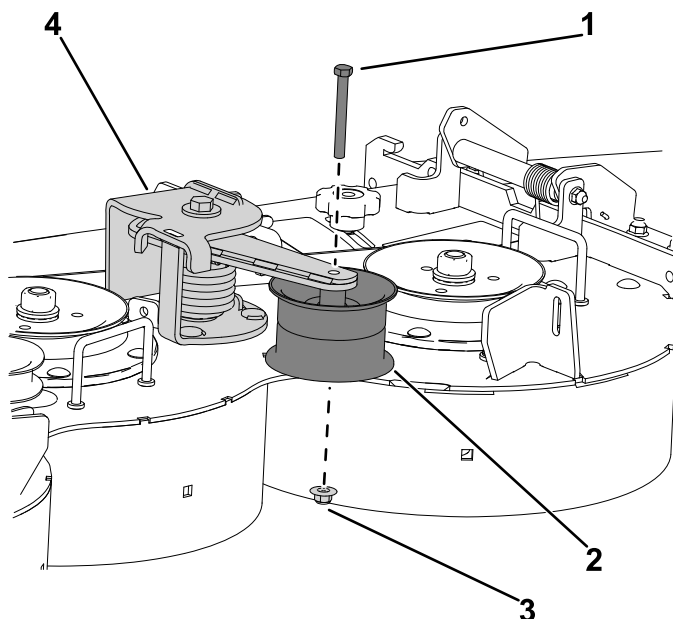

g403761

Figure 1

- | | |
|------------------------------|--------------------------|
| 1. Bolt (3/8 x 3-1/4 inches) | 3. Flange nut (3/8 inch) |
| 2. Idler pulley | 4. Torsion idler arm |

2. From the underside of the deck, remove and discard the 3 flange nuts (3/8 inch) securing the base of the torsion idler arm to the deck.

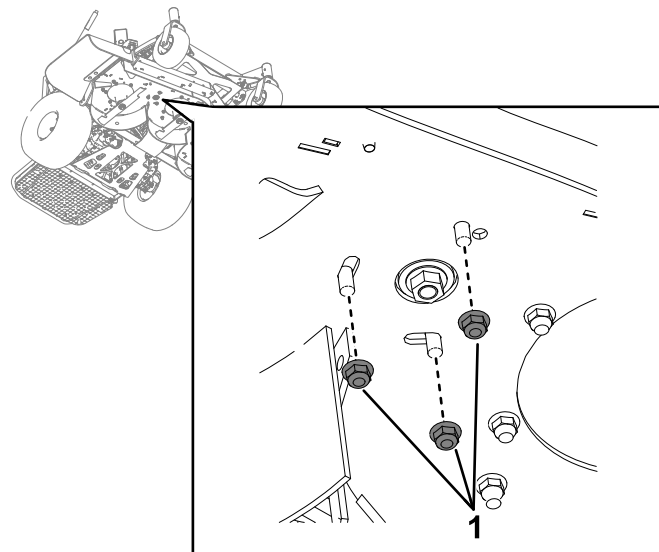

g403762

Figure 2

1. Flange nuts (3/8 inch)

3. Remove and discard the torsion idler arm.

2

Removing the Deck V-Belt

No Parts Required

Procedure

Remove and discard the deck V-belt; refer to the machine *Operator's Manual*.

3

Removing the Idler Arm

No Parts Required

Procedure

1. Remove and discard the bolt (3/8 x 3-1/4 inches) and flange nut (3/8 inch) securing the torsion idler arm to the idler pulley.

4

Installing the Torsion Idler Arm

Parts needed for this procedure:

1	Torsion idler arm
1	Bolt (3/8 x 3-1/4 inches)
1	Flange nut (3/8 inch)
3	Locknut (3/8 inch)

Procedure

1. Place the new torsion idler arm onto the deck.
2. From the underside of the deck, install the 3 new locknuts (3/8 inch) that secure the base of the torsion idler arm to the deck. Torque the nuts to 44 to 54 N·m (32 to 40 ft-lb).

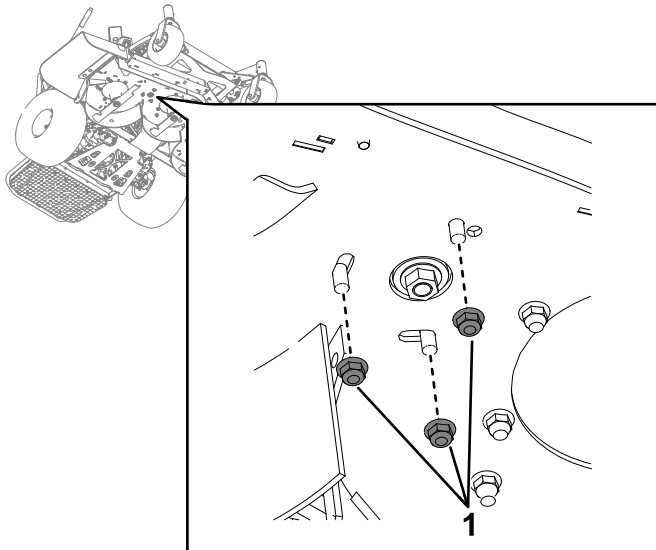

Figure 3

1. Flange nuts (3/8 inch)

3. Install the new bolt (3/8 x 3-1/4 inches) and flange nut (3/8 inch) securing the torsion idler arm to the idler pulley. Torque the nut to 44 to 54 N·m (32 to 40 ft-lb).

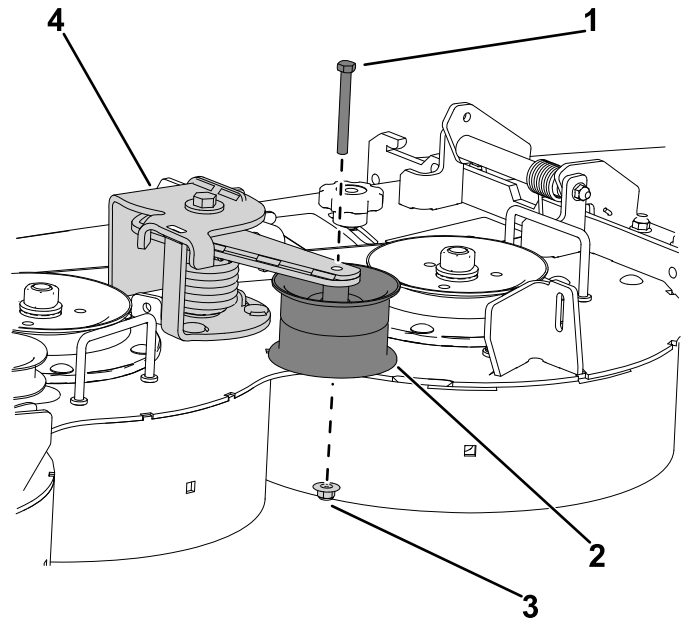

Figure 4

1. Bolt (3/8 x 3-1/4 inches)
2. Idler pulley
3. Flange nut (3/8 inch)
4. Torsion idler arm

5

Installing the Deck V-Belt

Parts needed for this procedure:

1	Deck V-belt
---	-------------

Procedure

Install the new deck V-belt; refer to the machine *Operator's Manual*.



Count on it.