



# Muffler and Spark Arrestor Kit

## 200 Series Z Masters

Part No. 105-1677

Part No. 105-1678

Part No. 105-1679

Part No. 105-3633

Form No. 3327-865

### Installation Instructions

**Important** When finished installing the spark arrester, store this sheet with your *Operator's Manual* for future reference.

## Loose Parts

**Note:** Use the chart below to identify parts for assembly.

Description	Qty.	Use
Muffler	1	Installing the muffler
Gasket	2	
Spark arrester	1	Installing the spark arrester
Clamp	1	

## Installing the Muffler

1. Stop the PTO, set the parking brake, stop the engine, and remove the ignition key.
2. Allow the traction unit to cool completely.
3. Remove the muffler heat shield.
4. Remove the four nuts and lock washers securing the muffler to the studs on the engine.
5. Remove the old muffler and gaskets from the engine, ensuring that you clean all pieces of the gaskets off of the engine exhaust manifold.
6. Slide the new gaskets over the studs on the engine.
7. Install the new muffler on the studs on the engine, securing it tightly using the lock washers and nuts removed in step 4.
8. Install the muffler heat shield.

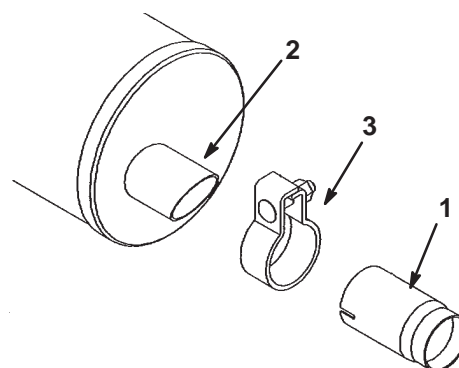

**Figure 1**

1. Spark arrester
2. Muffler exhaust outlet
3. Clamp

2. Slide the clamp over the arrester until it is flush with the slotted end of the arrester so that the clamp covers the slots in the arrester (Fig. 1).
3. Tighten the clamp.

## Installing the Spark Arrester

1. Slide the slotted end of the spark arrester over the exhaust outlet on the muffler as far as possible by hand (Fig. 1).

**Important** Do not use a hammer or other instrument to pound the arrester onto the exhaust outlet. Pounding on the arrester will damage it.

## Maintaining the Spark Arrester

Inspect the spark arrester every 50 hours for damage, such as holes in the screen, and for build-up on the screen. If it is damaged, replace it with a new spark arrester. If it is dirty, remove it and clean the screen with a wire brush and/or soak it in solvent. Install it as indicated in the previous procedure.