



Side-Discharge Chute Kit

Recycler® Lawn Mower

Model No. 147-0520

Installation Instructions

Preparing the Machine

For gas-powered machines: Shut off the machine, remove the electric-start button (if equipped), and wait for all moving parts to stop.

For battery-powered machines: Stop the machine, remove the electric-start button, remove the battery pack from the machine, and wait for all moving parts to stop.

Installing the Side-Discharge Chute

Use the side-discharge chute for cutting very tall grass.

1. Lift up the rear deflector.
2. Attach the side-discharge chute to the rear of the machine using the attachment points.
3. Allow the rear deflector to rest on the chute.

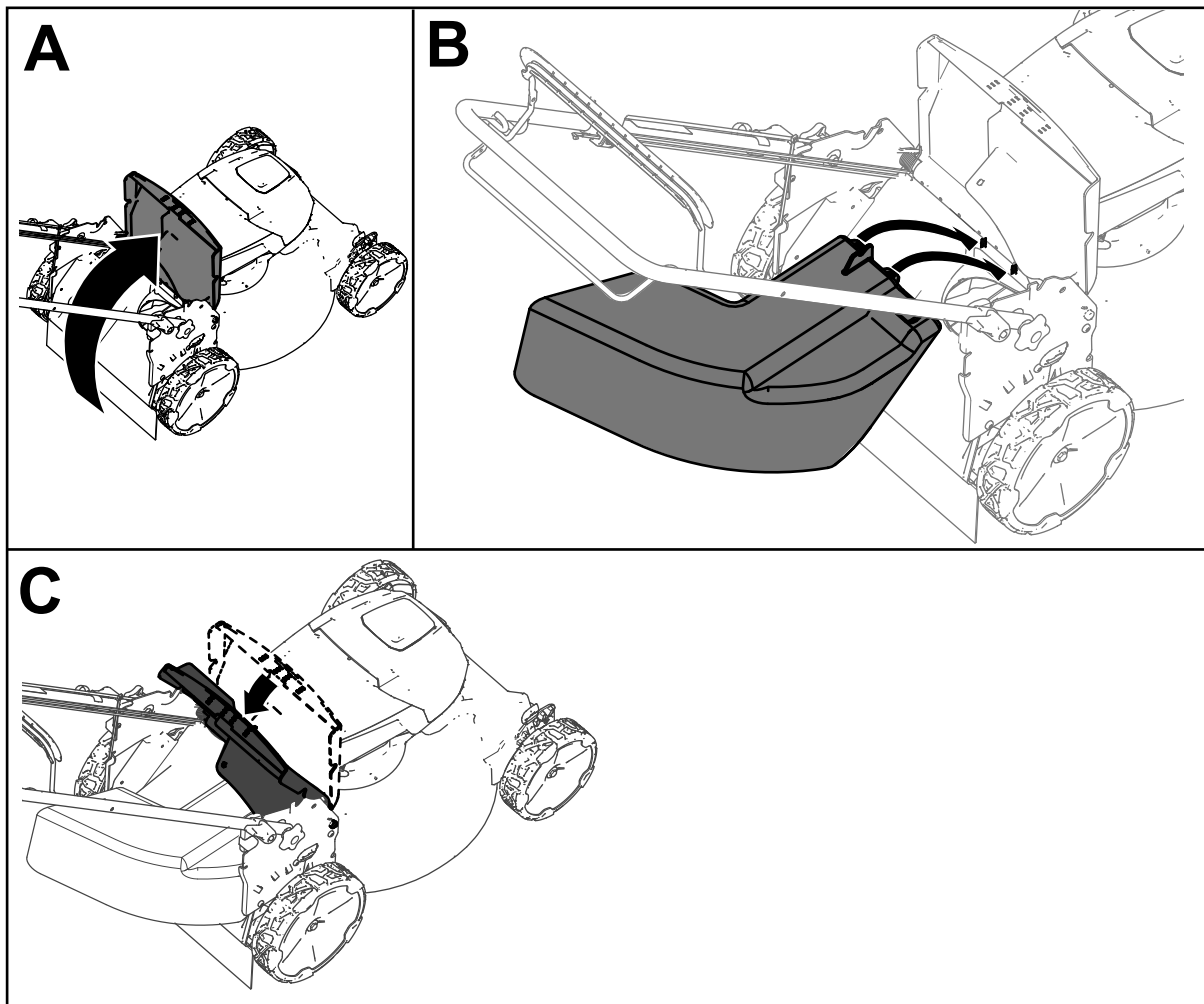

g428357

