



## Weight Kit

Reelmaster® 216-D, 2300-D, 2600-D and 2000-D

Part No. 83-9370

Form No. 3328-131

### Installation Instructions

1. Disconnect negative and positive battery cables from battery.
  2. Remove 2 carriage screws and flange locknuts securing battery hold-down to rear frame and remove hold-down and battery. Discard fasteners.
  3. Remove 3 capscrews, flat washers, and grommets securing fuel tank to rear frame. Set fuel tank aside. Retain flat washers and grommets for reinstallation.
  4. Position weight on rear frame aligning mounting holes with holes in frame. Threaded holes in center of weight should be at the left front and right rear positions.
  5. Use the charts below to determine size of mounting fasteners required to mount weight(s), fuel tank and battery to frame.
  6. Using threaded holes in weight, secure it to frame with 2 flange head screws as shown in Figure 2.
  7. If additional weights are to be mounted, proceed to step 8, otherwise proceed to step 10.
- Note:** When stacking additional weights, make sure all the unthreaded holes are aligned.
8. Turn top weight over and position on first weight so threaded holes align with non threaded holes in center of weights.
  9. Using threaded holes in top weight, secure it to first weight and frame with 2 capscrews and flat washers as shown in Figure 2.

#### Reelmaster 2000-D

Drive Type	Machines Attachments	Weight Part No. and Qty. Required			Weight Hardware		Tank Hardware		Battery Hardware	
		83-9390	94-3698	83-9370	Size	Qty.	Size	Qty.	Size	Qty.
2WD	27" Reels	2	0	1	3/8 x 3"	2	3/8 x 4"	3	5/16 x 4"	2
	27" Reels w/Baskets or 32" Reels	3	2	1	3/8 x 4.5"	2	3/8 x 5.5"	3	5/16 x 5.5" w/washer	2
3WD	27" Reels	1	0	1	3/8 x 2"	2	3/8 x 3"	3	5/16 x 2.75"	2
	27" Reels w/Baskets or 32" Reels	2	2	1	3/8 x 3.5"	2	3/8 x 4.5"	3	5/16 x 4.5" w/washer	2

#### Reelmaster 216-D, 2300-D & 2600-D

Drive Type	Machines Attachments	Weight Part No. and Qty. Required			Weight Hardware		Tank Hardware		Battery Hardware	
		83-9390	94-5974	83-9370	Size	Qty.	Size	Qty.	Size	Qty.
2WD	27" Reels	1	0	1	3/8 x 2"	2	3/8 x 3"	3	5/16 x 2.75"	2
	27" Reels w/Baskets	1	1	1	3/8 x 4.5"	2	3/8 x 5.5"	3	5/16 x 2.75"	2
3WD	32" Reels	1	0	1	3/8 x 2"	2	3/8 x 3"	3	5/16 x 2.75"	2

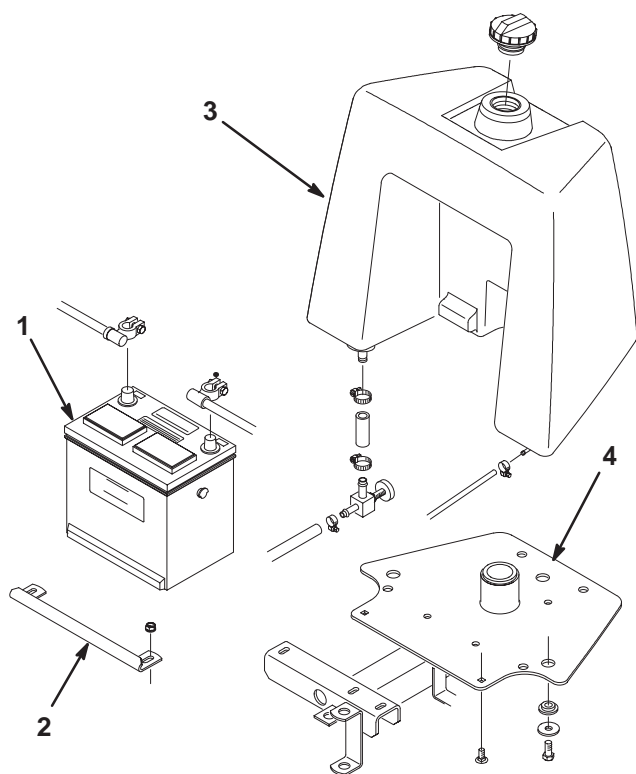

**Figure 1**

- |                      |               |
|----------------------|---------------|
| 1. Battery           | 3. Fuel tank  |
| 2. Battery hold-down | 4. Rear frame |

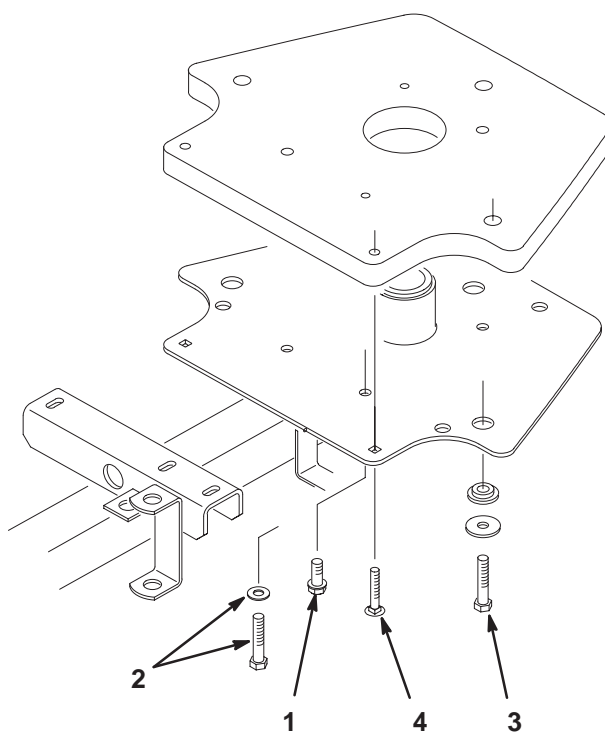

**Figure 2**

- |                             |                                       |
|-----------------------------|---------------------------------------|
| 1. Flange head screw        | 3. Capscrew, flat washer, and grommet |
| 2. Capscrew and flat washer | 4. Carriage screw                     |

**10.** Position fuel tank on weight(s) aligning mounting holes. Secure tank in position with (3) new capscrews (see chart) and flat washers and grommets previously removed.

**11.** Reinstall battery and battery hold-down. Secure hold-down to rear frame with (2) carriage screws.

**12.** Connect battery cables.