



Wide Angle Mirror Kit

Model No. 133-1038

Form No. 3461-931 Rev A

Installation Instructions

Installation

Loose Parts

Use the chart below to verify that all parts have been shipped.

Description	Qty.	Use
No parts required	—	Prepare the machine.
No parts required	—	Remove the canopy support bracket (for GTX models with a canopy—Model 07921 or 07922).
Mirror mount	1	Install the kit (for GTX models with a canopy—Model 07921 or 07922).
Wide-angle mirror	1	
Flange nut (1/4 inch)	2	
Machine bolt (1/4 x 3/4 inch)	2	
Locknut (3/8 inch)	2	
Flange-head bolt (3/8 x 1 inch)	2	
Mirror mount	1	Install the kit (for GTX models with a cab—Model 07142, 2-person canopy—Model 07140, or 4-person canopy—Model 07141).
Wide-angle mirror	1	
Flange nut (3/8 inch)	2	
Flange-head bolt (3/8 x 1 inch)	2	
Locknut (1/4 inch)	2	
Hex-washer head bolt (1/4 x 3/4 inch)	2	
Flange-head bolt (1/4 x 1-1/2 inches)—2-person canopy (Model 07140) or 4-person canopy (Model 07141) only	2	
Mirror mount	1	Install the kit (for Vista Shuttle Vehicles with a canopy installed).
Wide-angle mirror	1	
Locknut (3/8 inch)	2	
Flange-head bolt (3/8 x 1 inch)	2	
Locknut (1/4 inch)	2	
Hex-washer head bolt (1/4 x 3/4 inch)	2	
Black mirror mount	1	Install the kit (for the Outcross 9060 Series traction unit).
Primed mirror mount		
Wide-angle mirror	1	
Locknut (3/8 inch)	2	
Flange-head bolt (3/8 x 1 inch)	2	
Locknut (1/4 inch)	4	
Hex-washer head bolt (1/4 x 3/4 inch)	4	

Preparing the Machine

1. Park the machine on a level surface.
2. Engage the parking brake.
3. Shut off the machine and remove the key.



Removing the Canopy Support Bracket

For GTX Models with Canopy Model 07921 or 07922

Remove the canopy support bracket as shown in [Figure 1](#).

Note: Retain the support bracket and hardware for later installation.

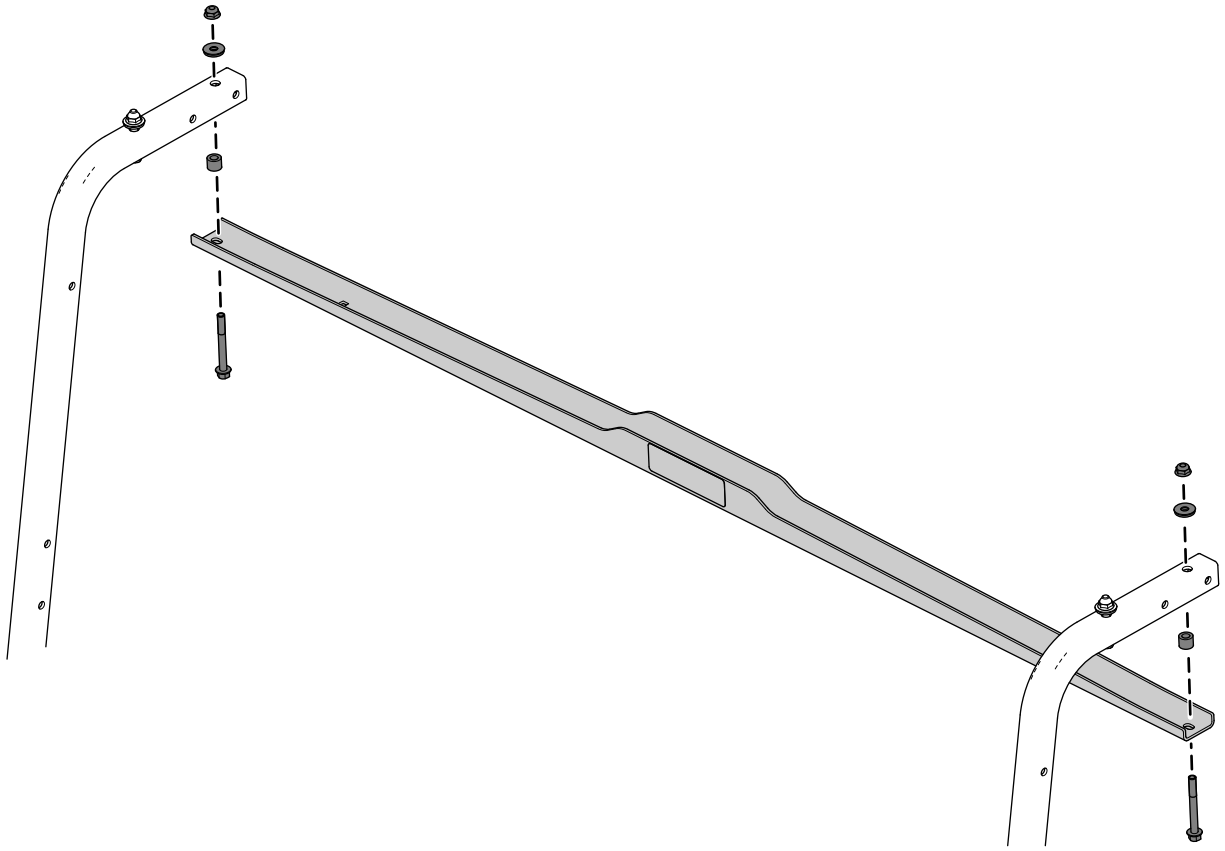

g259012

Figure 1

Installing the Kit

For GTX Models with Canopy Model 07921 or 07922

1. Secure the mirror mount to the canopy support bracket using the 2 machine bolts (1/4 x 3/4 inch) and 2 flange nuts (1/4 inch) as shown in A of [Figure 2](#).
2. Secure the wide-angle mirror to the mirror mount using the 2 flange-head bolts (3/8 x 1 inch) and 2 locknuts (3/8 inch) as shown in B of [Figure 2](#).

Note: You can install the mirror to your desired height and angle using any of the 3 hole locations.

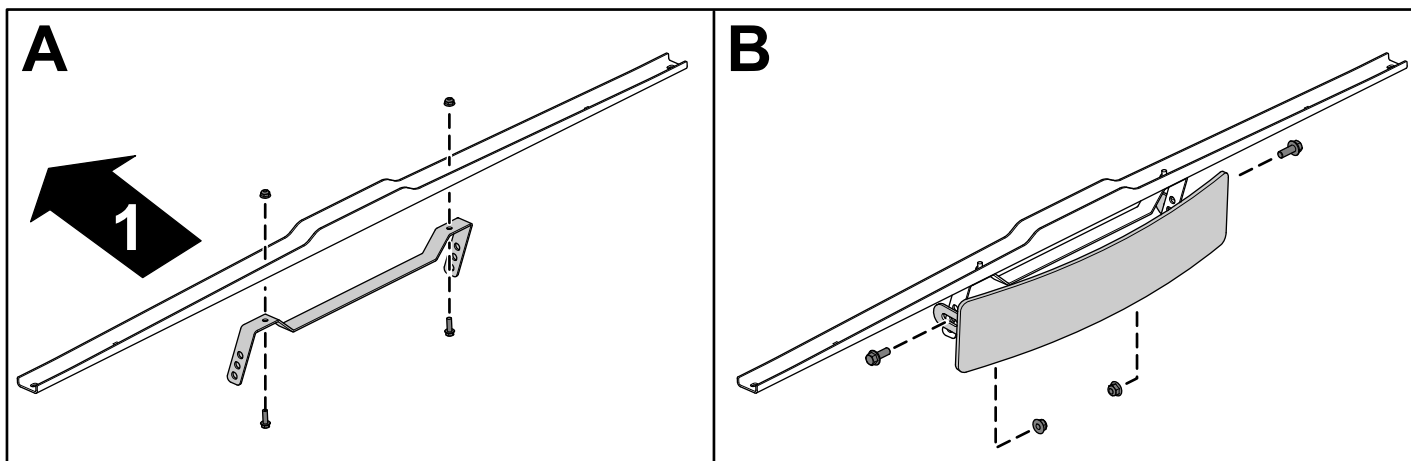

Figure 2

g259014

1. Front of the machine

3. Install the canopy support bracket using the previously removed hardware ([Figure 1](#)).

Installing the Kit

For GTX Models with Cab (Model 07142), 2-Person Canopy (Model 07140), or 4-Person Canopy (Model 07141)

Important: If you are installing the kit on a cab (Model 07142), discard the 2 hex-washer head bolts (1/4 x 3/4 inch) and 2 locknuts (1/4 inch), and use the existing hardware.

Important: If you are installing the kit on a canopy frame with a square cross tube, install the mirror mount using the 2 flange-head bolts (1/4 x 1-1/2 inches).

1. Install the mirror mount using the 2 hex-washer head bolts (1/4 x 3/4 inch) and 2 locknuts (1/4 inch) as shown in A of [Figure 3](#).
2. Install the wide-angle mirror using the 2 flange-head bolts (3/8 x 1 inch) and 2 flange nuts (3/8 inch) as shown in B of [Figure 3](#).

Note: You can install the mirror to your desired height and angle using any of the 3 hole locations.

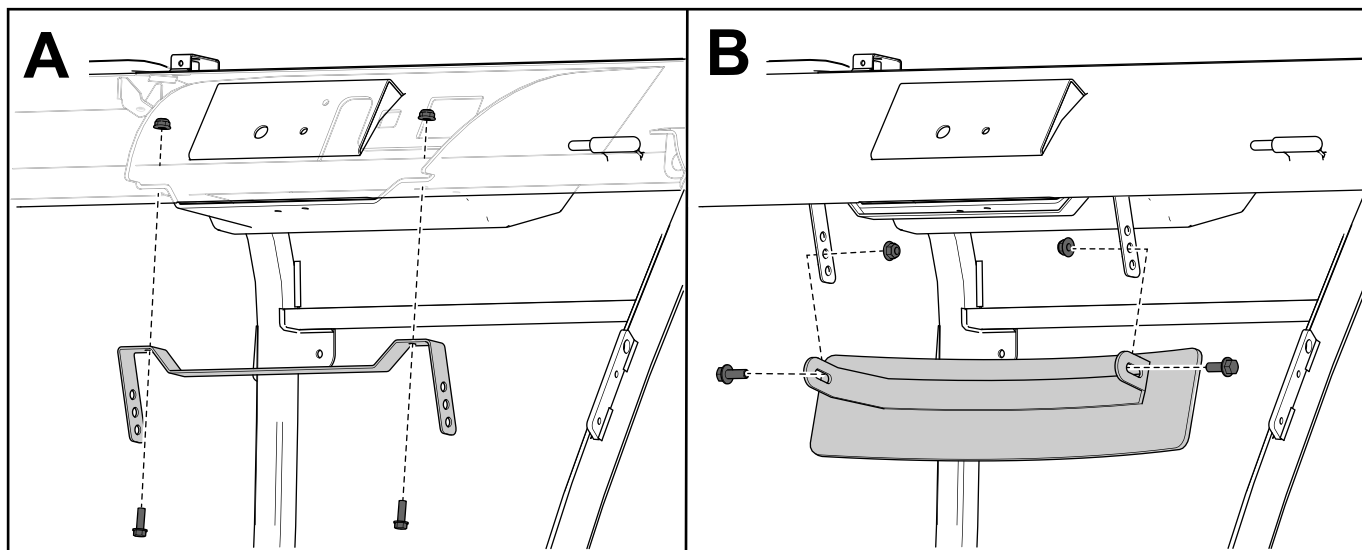

g259485

Figure 3

Installing the Kit

For Vista Shuttle Vehicles with a Canopy Installed

1. Secure the mirror mount to the front support bracket using 2 hex-washer head bolts (1/4 x 3/4 inch) and 2 locknuts (1/4 inch) as shown in [Figure 4](#).

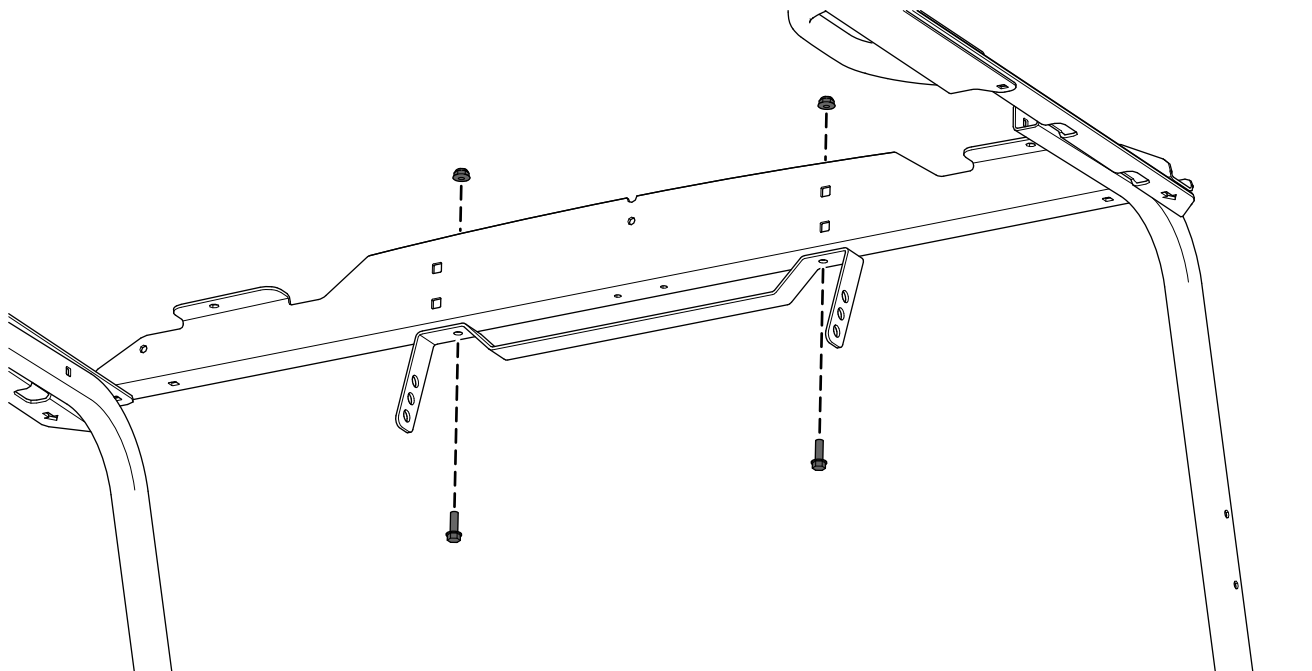

Figure 4

g429287

2. Secure the wide-angle mirror to the mount using 2 flange-head bolts (3/8 x 1 inch) and 2 locknuts (3/8 inch) as shown in [Figure 5](#).

Note: You can install the mirror to your desired height and angle using any of the 3 hole locations.

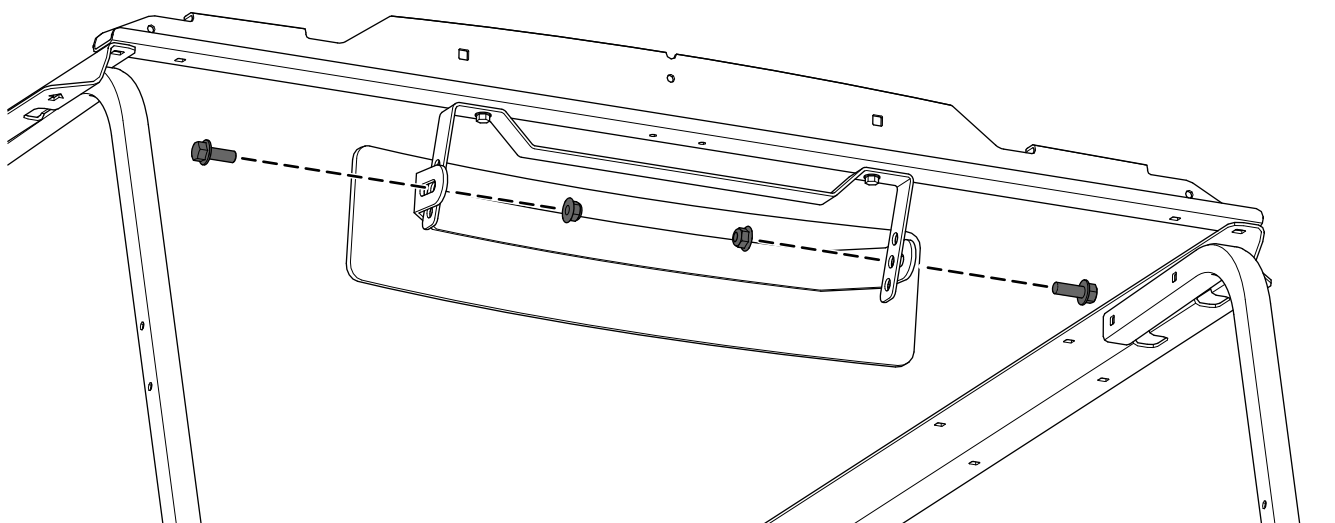

Figure 5

g428695

Installing the Kit

For the Outcross 9060 Series Traction Unit

1. Secure the primed mirror mount to the black mirror mount using 2 hex-washer head bolts (1/4 x 3/4 inch) and 2 locknuts (1/4 inch) as shown in [Figure 6](#).

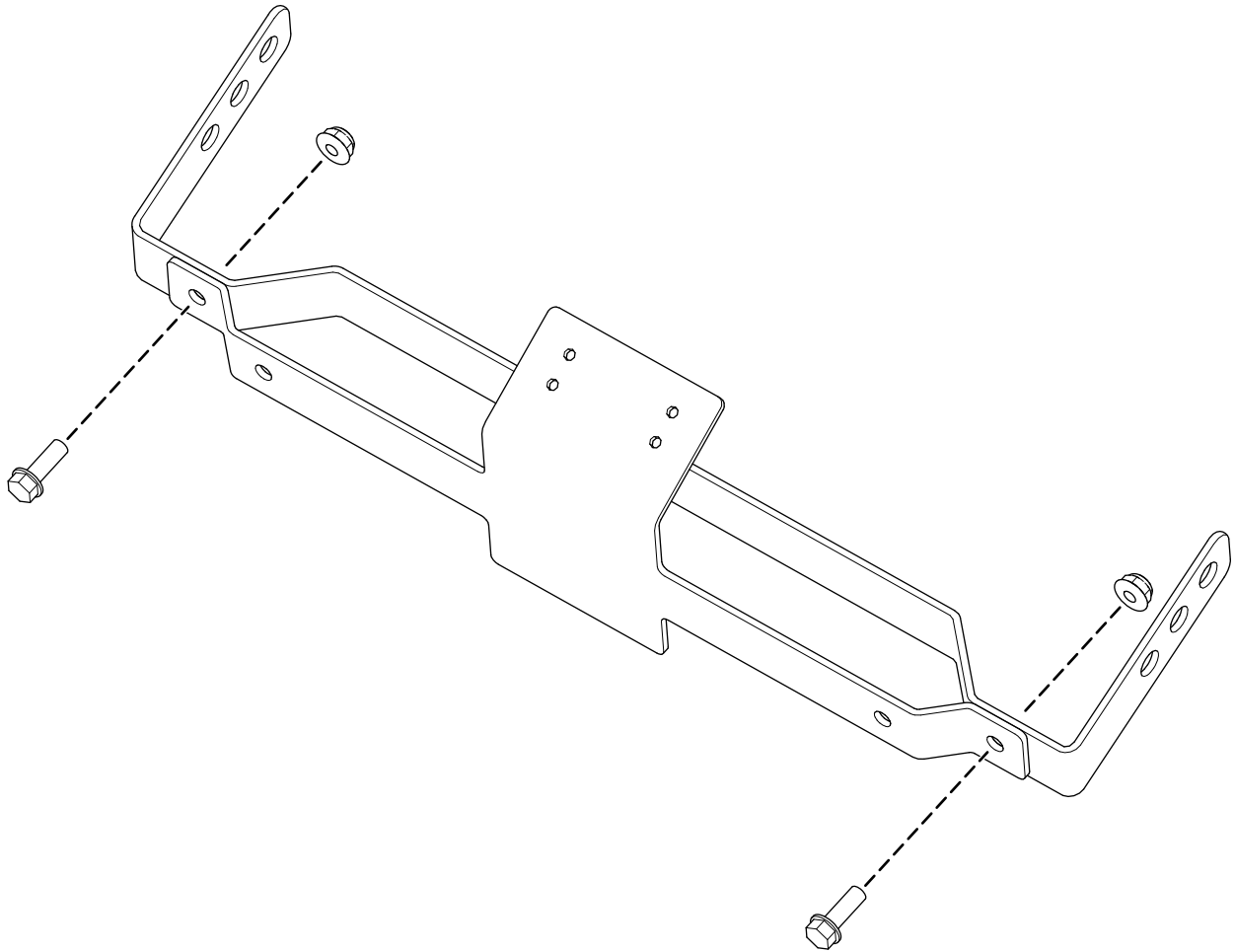

Figure 6

g411319

2. Secure the mirror-mount assembly to the canopy using 2 hex-washer head bolts (1/4 x 3/4 inch) and 2 locknuts (1/4 inch) as shown in [Figure 7](#).

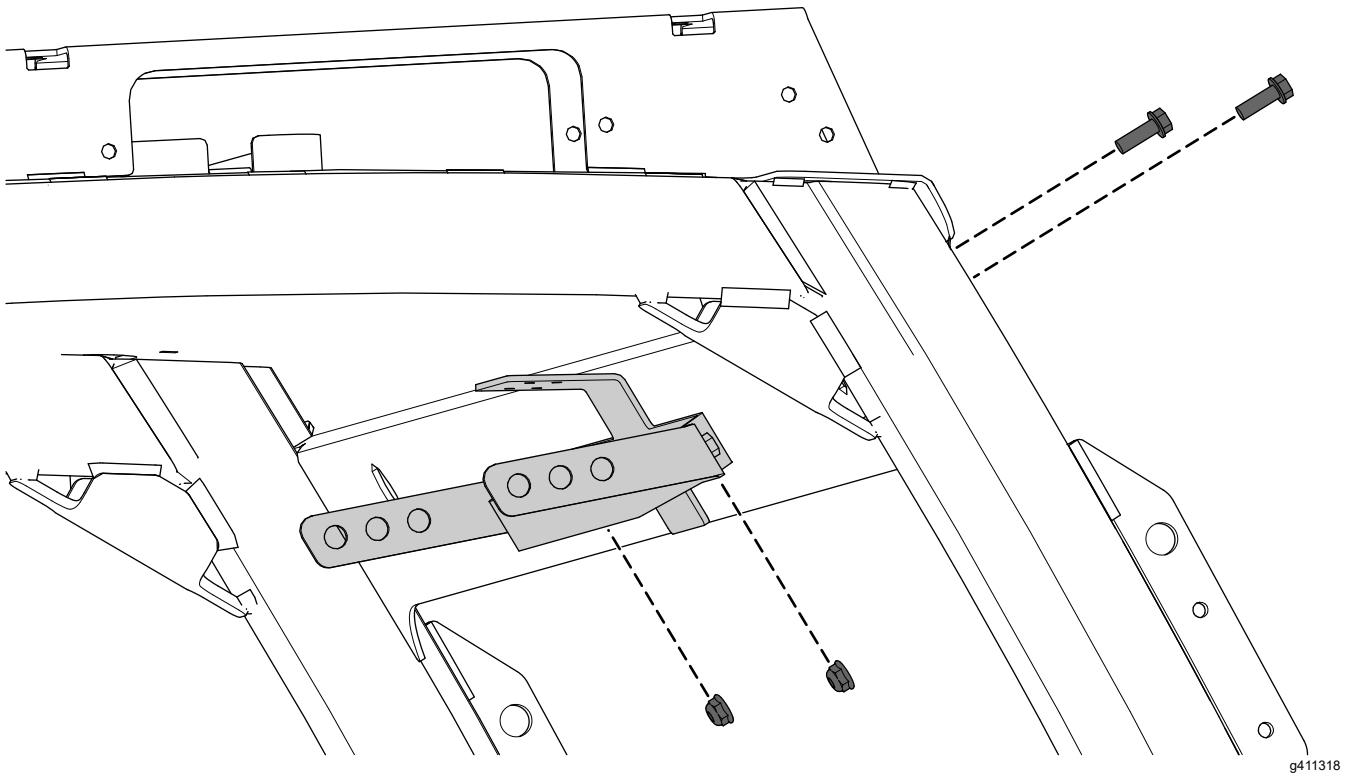

Figure 7

3. Secure the wide-angle mirror to the mirror-mount assembly using 2 flange-head bolts (3/8 x 1 inch) and 2 locknuts (3/8 inch) as shown in [Figure 8](#).

Note: You can install the mirror to your desired height and angle using any of the 3 hole locations.

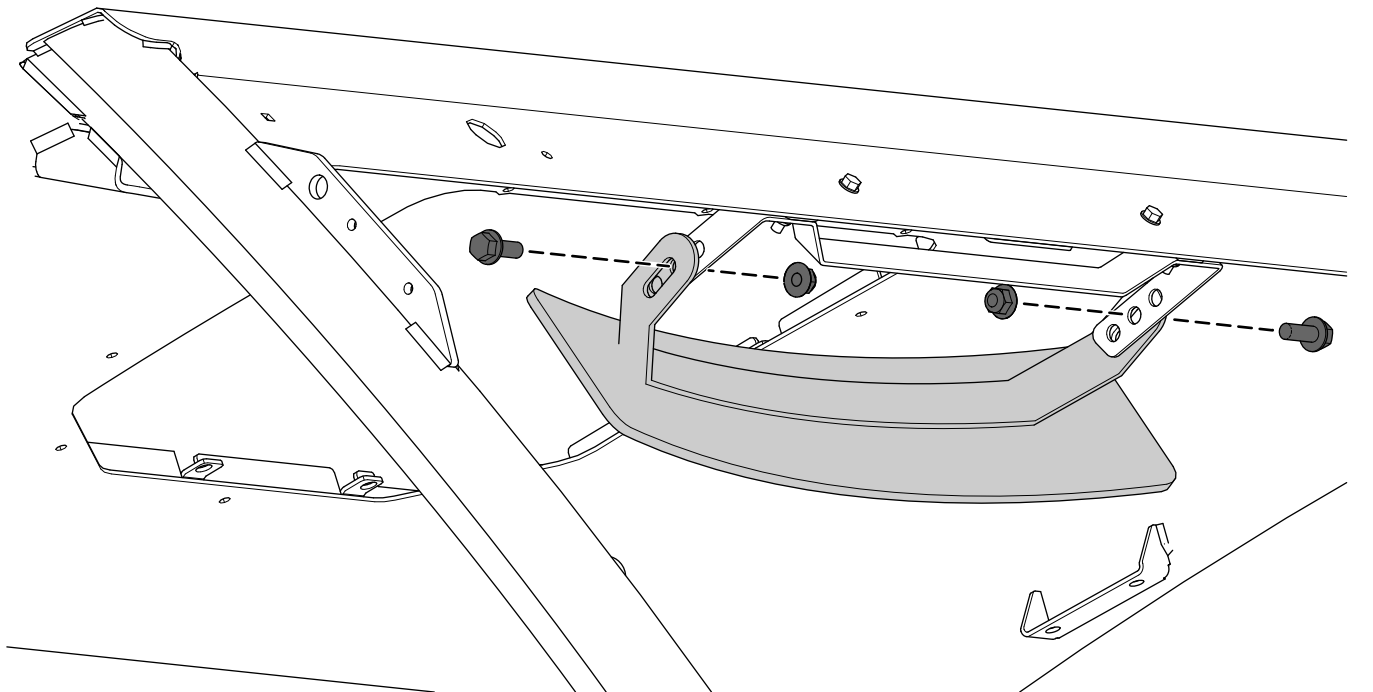

Figure 8



Count on it.