



36" Recycler Kit

Proline Mid-Size Floating Deck Mowers

Part No. 105-3180

Form No. 3328-137

Installation Instructions

Loose Parts

Note: Use the chart below to identify parts for assembly.

DESCRIPTION	QTY.	USE
Baffle	1	Installing the baffle
Bolt, 5/16 x 1 inch	2	
Bolt, 5/16 x 2-3/4 inch	2	
Lock nut, 5/16 inch	4	
Kicker	2	Installing the kickers
Bolt 5/16 x 1 inch	4	
Lock nut, 5/16 inch	4	
Recycler® blade	2	Installing the blades

Preparing the Mower

1. Remove the mower and belt. See the Operator's Manual for instructions.
2. Thoroughly clean the mower. All debris must be removed to ensure kickers and baffle will fit properly against mower.
3. Repair all bent or damaged areas of mower and replace any missing parts.
4. Tip the mower upside down and block up ends to ease installation of recycler components.



Warning



Open holes in the mower exposes you and others to thrown debris. Debris thrown out of holes in the mower can cause injury.

- Never operate mower without hardware mounted in all holes in mower.
- Install hardware in mounting holes when mulching baffle is removed.

Installing the Baffle

Important Make sure the bolt heads are installed on the inside of the cutting chamber.

1. Place the baffle inside the front of the cutting chamber (Fig. 2).
2. Position the baffle so the outside ends are tight against the cutting chamber and there is equal distance between the baffle radius' and spindles (Fig. 3).

Note: Do not drill a hole in the center. See Figures 1 and 2.

3. Using the baffle as a template, drill four holes (11/32 inch dia.) into the cutting chamber (Figures 2 and 3).

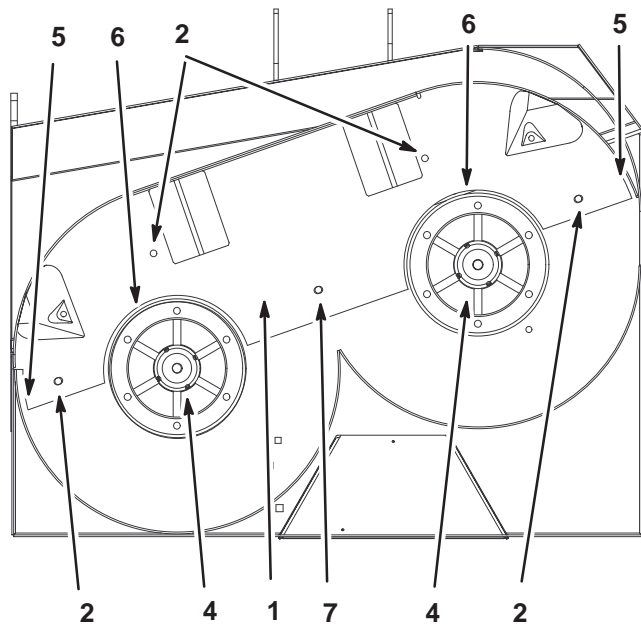

m-6249

Figure 1

1. Baffle
2. Mark and drill holes here (11/32 inch dia.)
3. Center line
4. Spindles
5. Baffle tight to outside edge
6. Equal distance between baffle radius and spindle
7. Do not drill here

4. In the two inside holes, install the baffle with 2 bolts (5/16 x 2-3/4 inch) and 2 lock nuts (5/16 inch) (Fig. 2).
5. For the two outside holes, install the baffle with 2 bolts (5/16 x 1 inch) and 2 lock nuts (5/16 inch) (Fig. 2).

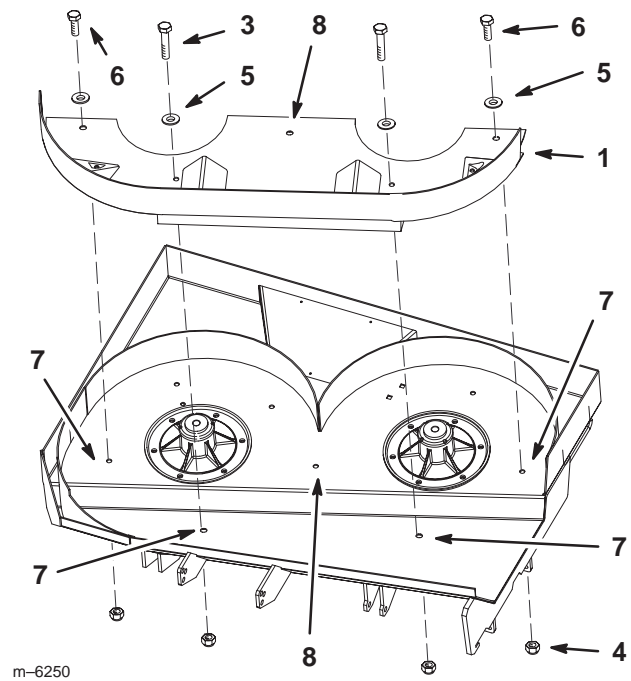

m-6250

Figure 2

1. Baffle
2. Front of mower
3. Bolt, 5/16 x 2-3/4 inch
4. Locknut, 5/16 inch
5. Flat washer, 5/16 inch
6. Bolt, 5/16 x 1 inch
7. Mark and drill holes here (11/32 inch dia.)
8. Do not drill here

Installing the Kickers

Important Make sure the bolt heads are installed on the inside of the cutting chamber.

1. Measure from the spindle center lines, and locate kickers as shown in Figure 3.
2. Holding kickers tight against the cutting chamber, mark and drill a hole for each kicker (11/32 inch dia.) (Fig. 3).

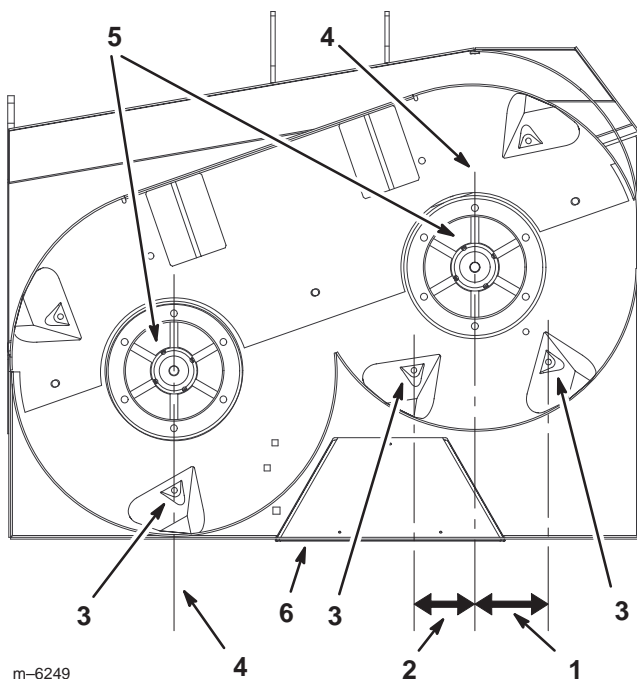

Figure 3

- | | |
|--|------------------|
| 1. 4-1/4 inch (108 mm) | 4. Center line |
| 2. 3-1/2 inch (89 mm) | 5. Spindles |
| 3. Mark and drill holes here (11/32 inch dia.) | 6. Back of mower |

3. Install each kicker with a bolt (5/16 x 1 inch) and a locknut (5/16 inch) (Fig. 4).

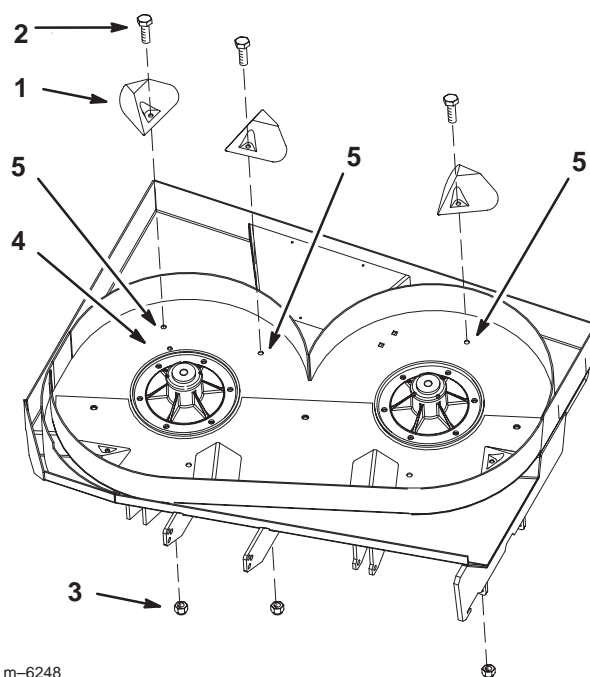

Figure 4

- | | |
|------------------------|-----------------------------|
| 1. Kicker | 4. Back of cutting chamber |
| 2. Bolt, 5/16 x 1 inch | 5. Mark and drill hole here |
| 3. Lock nut, 5/16 | |

Installing the Recycler® Blades

1. Hold the blade end using a rag or thickly-padded glove. Remove the blade bolt, blade stiffener and blade from the spindle shaft (Fig. 5).

2. Install the blade onto the spindle shaft (Fig. 5).

Important The sail part of the blade must be pointing upward, toward the inside of the mower to ensure proper cutting (Fig. 5).

3. Install the washer, lock washer and blade bolt (Fig. 5). Torque the blade bolt to 85–110 ft-lb (115–140 N•m).

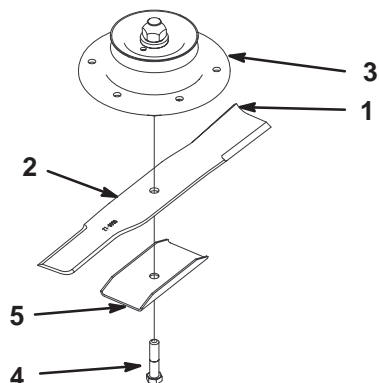

m-5227

Figure 5

- | | |
|-----------------------|--------------------|
| 1. Sail area of blade | 4. Blade Bolt |
| 2. Blade | 5. Blade stiffener |
| 3. Blade spindle | |

4. Install the mower to the carrier frame and install the mower belt.

Removing Baffles for Side Discharge Cutting

Note: Keep the rear 3 kickers attached to the mower.

1. Thoroughly clean the mower.
2. Remove the mower to ease removal of kit.
3. Remove the mounting hardware from the baffle and remove the baffle.
4. Leave the 3 kickers installed in the rear of the cutting chamber.

Note: Save the hardware for use when installing the baffle.



Warning



Open holes in the mower exposes you and others to thrown debris. Debris thrown out of holes in the mower can cause injury.

- Never operate mower without hardware mounted in all holes in mower.
- Install hardware in mounting holes when mulching baffle is removed.

5. Install previously removed standard blades.