



Jack Pad Kit

Groundsmaster® 300 Traction Units

Part No. 100-4385

Form No. 3328-650

Installation Instructions

Note: Some machines may already have the mounting holes for the installation of jack pad. If so, proceed to step 2.

1. Using dimensions shown in figure 1, locate, mark and drill (2) 15/32" dia. holes in right and left frame rails.

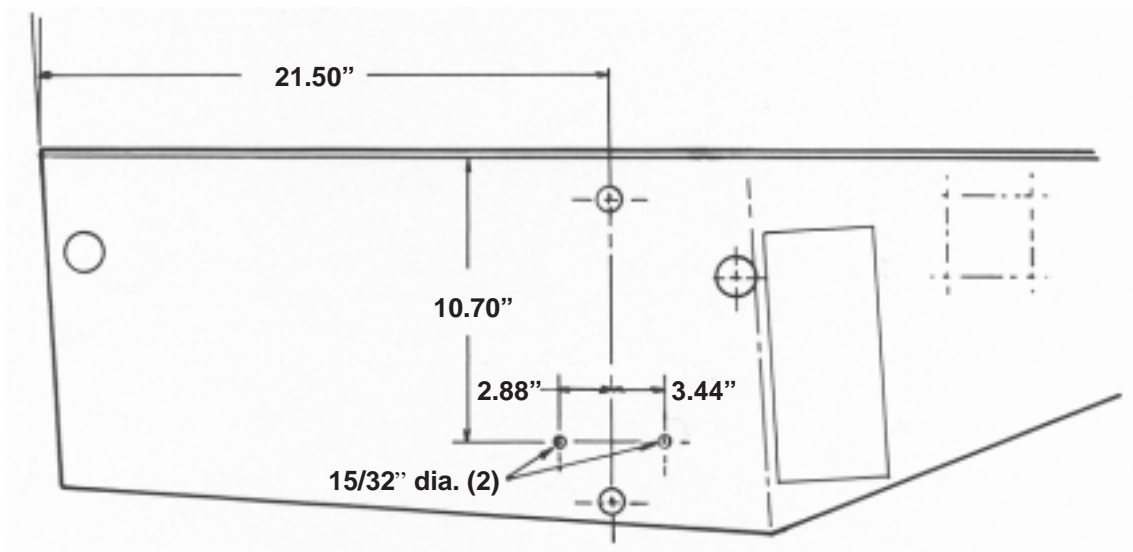

Figure 1

2. On side of machine in which the tire is to be changed, secure jack pad to frame rail with capscrews and wing nuts (Fig. 2).

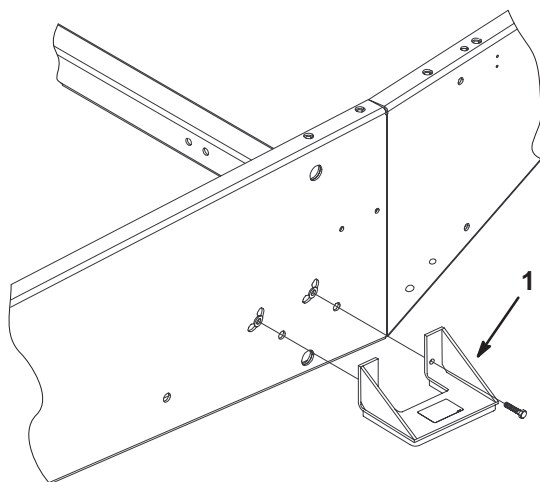

Figure 2

1. Jack pad

3. Remove jack pad from machine and store in a memorable place when done changing tire. Do not store mounted on machine.



Caution



Use only for changing tires. Block front and rear tires. Do not use to work under traction unit. Use jack stands to support traction unit.