



Weight Kit

SnowMaster® 724 QXE, ZXR, or 824 QXE Snowthrower

Model No. 161-5951

Installation Instructions

Installation

Loose Parts

Use the chart below to verify that all parts have been shipped.

Description	Qty.	Use
Weight plate	1	Install the weight kit.
Hex-washer-head screw (1/4 x 1-1/4 inches)	2	



Installing the Weight Kit

1. Park the machine on a level surface.
2. Shut off the engine.
3. Remove the key.
4. Wait for all moving parts to stop.
5. Disconnect the spark-plug wire.
6. Use a proper lifting device to gain access to the bottom of the machine.
7. Remove the 2 screws (1/4 x 3/4 inch) and 2 washers (1/4 inch) securing the lower frame support to the bottom of the machine. Retain the washers.

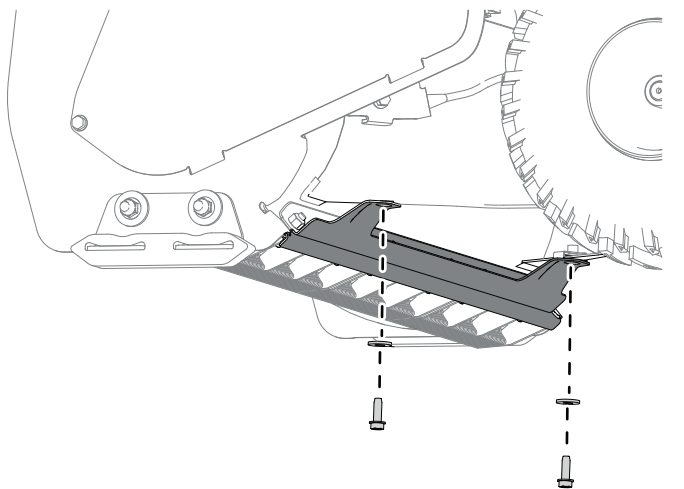

Figure 1

8. Install the weight plate to the lower frame support and secure it with the 2 hex-washer-head screws (1/4 x 1-1/4 inches) and 2 retained washers (1/4 inch).

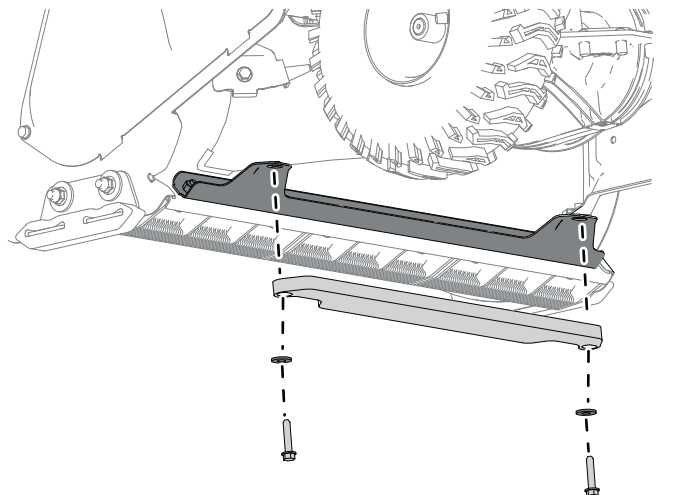

Figure 2

9. Return the machine to an upright position.
10. Connect the spark-plug wire.

Notes:



Count on it.