



# Operator Presence Kit

## Greensmaster® 800/1000/1600

Part No. 105-5363

## Parts Catalog

### Ordering Replacement Parts

To order replacement parts, please supply: the part number, the quantity, and the description of each part desired.

### Understanding Reference Numbers

Each identified part in an illustration has a reference number. The reference number for a part also appears in the parts list, along with other information about the part.

This catalog uses two special reference number formats, one to indicate parts in a service assembly and another to indicate the quantity of a given part in an illustration.

### Service Assembly Reference Numbers

Parts in service assemblies have reference numbers in the form **a:b**. The **a** represents the reference number of the entire service assembly and the **b** represents a sequential number unique to each part within the service assembly.

For example, a wheel assembly might be identified by reference number **6**, the tire by **6:1**, the valve by **6:2**, and the wheel by **6:3**. When you order the assembly identified by reference number **6**, you receive all parts identified by reference numbers **6:1**, **6:2**, and **6:3**. However, you may also order any part individually.

Reference numbers of this type appear in illustrations and in part lists.

### Reference Numbers Indicating Quantity

In an illustration, if a reference number indicates more than one part, the reference number has the form **nX y**. The **n** represents the quantity of the part, the **X** is the multiplication symbol, and the **y** represents the reference number.

For example, in an illustration, the reference number **2X 37** means that two of the parts identified by reference number **37** are indicated.

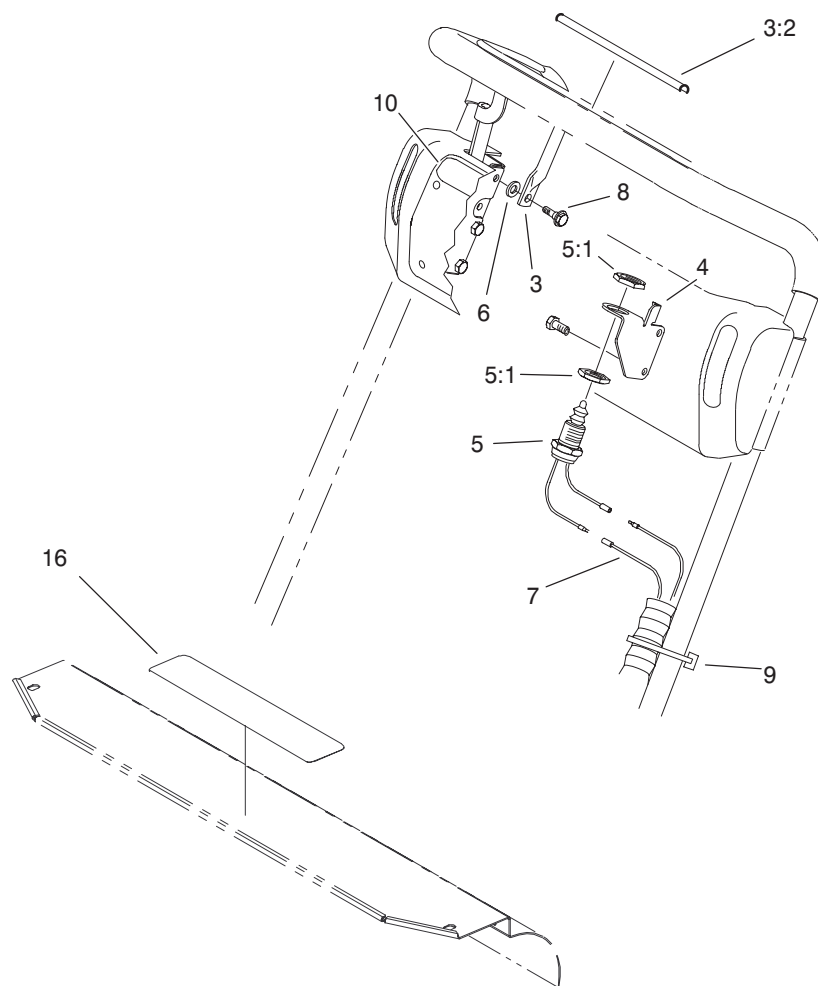

Sheet No.:0  
T-3860

# Operator Presence Kit Assembly

Ref. No.	Part No.	Qty.	Description
3	93-9009	1	Bail ASM
3:2	93-9008	1	Decal-Operation, Bail
4	93-6078-03	1	Bracket-Switch
5	87-5490	1	Switch-Clutch
5:1	3218-20	2	Nut-Jam
6	93-6079	2	Spacer
7	105-5362	1	Harness-Wire, Bail
8	11-9030	2	Screw-Shoulder
9	3290-378	4	Tie-Cable
10	105-5358	1	Decal-Overlay, Console
16	62-5070	1	Decal-Warning

Ref. No.	Part No.	Qty.	Description