

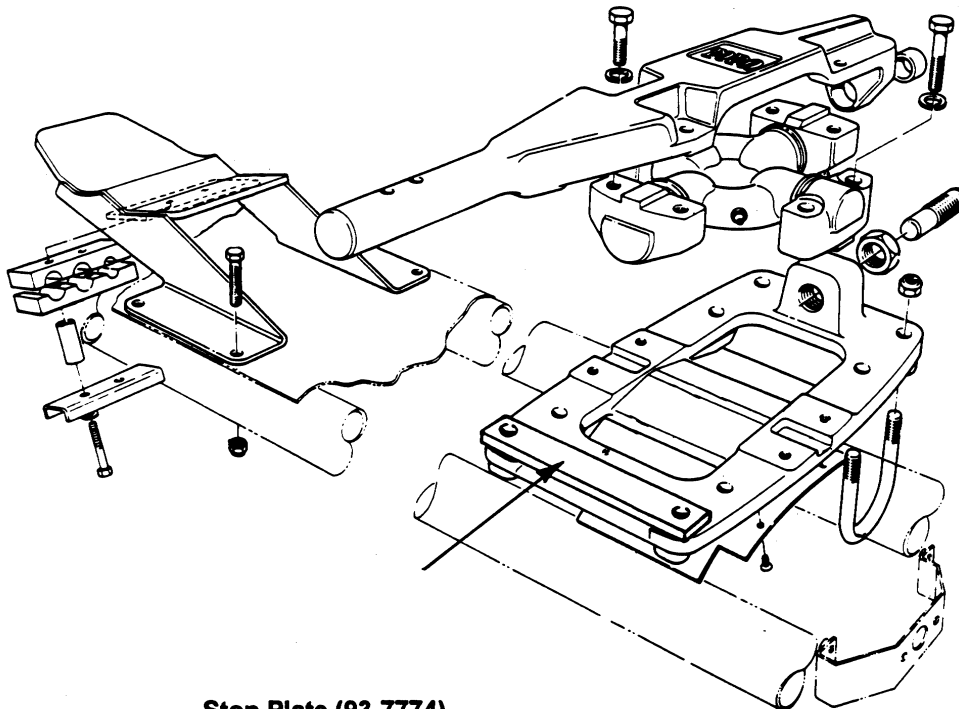

<u>Model/Serial Range:</u>	<u>Model Number:</u>	<u>Serial Numbers:</u>
	03760	00000-99999

When turning around during cross cutting or any time the outside Cutting Units are raised only a few inches from the ground, the motion of the machine may cause the Cutting Unit to swing and make contact with the Lift Cylinder Body. This contact generally causes no structural damage to the cylinder or cutting unit when operated with appropriate care. However, Stop Plate (93-7774) is now available to prevent contact between the Cutting Units and the Lift Cylinder if this condition is of concern.

Floating Cutting Unit Stop Plate (93-7774) for REELMASTER 450-D and 4500-D



Note: Controls forward motion to prevent Cutting Unit and Lift Cylinder contact.