



# Z Master® 4000 Series Riding Mower

## With 52in or 60in TURBO FORCE® Mower

Model No. 74002—Serial No. 413000000 and Up  
 Model No. 74010—Serial No. 413000000 and Up  
 Model No. 74050—Serial No. 413000000 and Up  
 Model No. 74050TA—Serial No. 412000000 and Up  
 Model No. 74052—Serial No. 413000000 and Up  
 Model No. 74053TE—Serial No. 413000000 and Up  
 Model No. 74054—Serial No. 413000000 and Up  
 Model No. 74054TA—Serial No. 412000000 and Up  
 Model No. 74055—Serial No. 413000000 and Up  
 Model No. 74055TA—Serial No. 413000000 and Up  
 Model No. 74056TE—Serial No. 412000000 and Up

### Addendum

Store this document with the *Operator's Manual* for the machine.

In order to use the hitch on your machine, you need to install a caster weight assembly (Toro Part No. 144-2660) to each caster wheel at the front of the machine.

## Safety

### Safety and Instructional Decals



Safety decals and instructions are easily visible to the operator and are located near any area of potential danger. Replace any decal that is damaged or missing.

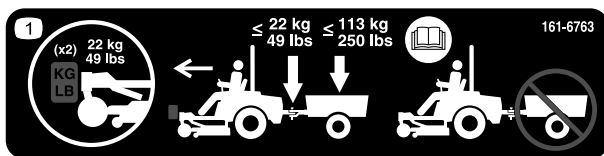

161-6763

decal161-6763

1. Install a caster weight 22 kg (49 lb) to each caster wheel at the front of the machine; do not exceed a tongue weight of 22 kg (49 lb); do not exceed a gross towing weight of 113 kg (250 lb); read the *Operator's Manual*; do not tow without the front weights installed.



## Loose Parts

Use the chart below to verify that all parts have been shipped.

Procedure	Description	Qty.	Use
<b>1</b>	Weight assembly	2	Install the weights.
	Carriage bolt (3/8 x 1 inch)	4	
	Flange nut (3/8 inch)	4	

# 1

## Installing the Weights

Parts needed for this procedure:

2	Weight assembly
4	Carriage bolt (3/8 x 1 inch)
4	Flange nut (3/8 inch)

## Procedure

1. Secure the weight to the caster arm using 2 carriage bolts (3/8 x 1 inch) and 2 flange nuts (3/8 inch).
2. Repeat this procedure on the other side of the machine.

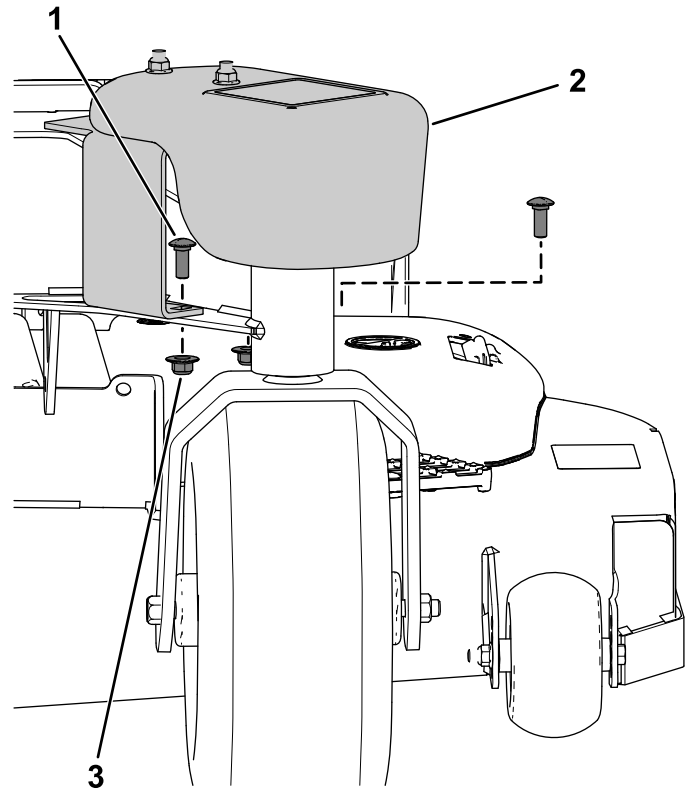

Figure 1

g341474

1. Carriage bolt (3/8 x 1 inch)
2. Weight assembly
3. Flange nut (3/8 inch)