



**Date: October 24, 2003**

**Serial Numbers:**  
80101-230000711

Contact your local authorized Toro distributor for additional information or assistance.



## New Location



## Key Relocation Kit Sand Pro® 5020 Part No. 106-9263

Form No. 3350-480

### Installation Instructions

1. Disconnect the black (negative) battery cable from the battery.
2. Unplug the wire harness connector from the underside of the key switch terminal (Fig. 1).
3. Remove the jam nut securing the key switch to the control panel. Discard the key switch.
4. Under the control panel decal, locate the unused hole in the fender for the auxillary light switch indicator (Fig. 1). Cut out the decal material to expose the hole.

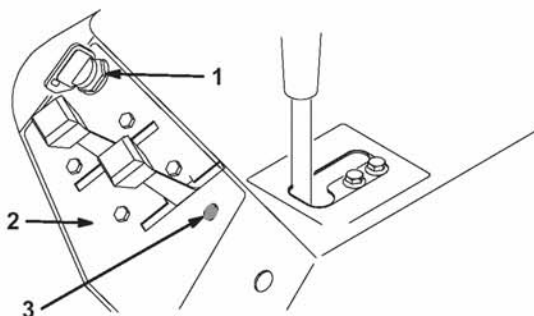

Figure 1

- |                  |                         |
|------------------|-------------------------|
| 1. Key switch    | 3. Unused hole in panel |
| 2. Control panel |                         |

5. Using a 5/8" drill, enlarge the hole in the fender. Remove all the burrs from the hole.
6. From the underside of the fender, insert the new key switch into the hole (Fig. 2).
7. From the top side of the fender, insert the rectangular switch plate onto the exposed threads of the switch (Fig. 2). Position the switch and plate so the flats are downward.
8. Using the switch plate as a template, locate and mark the location of the pilot hole in control panel.
9. Remove the switch and the switch plate from the fender. Drill a 5/32" hole in the fender at the location marked (Fig. 2).

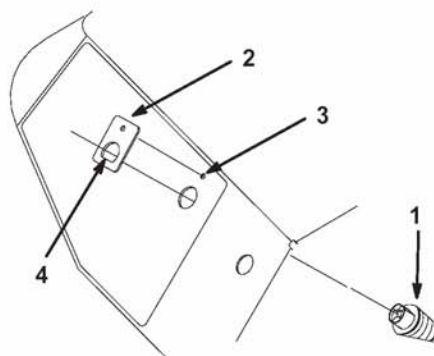

Figure 2

- |                 |                     |
|-----------------|---------------------|
| 1. Switch       | 3. 5/32" pilot hole |
| 2. Switch plate | 4. Flat area        |

10. Insert the switch plate onto the key switch (Fig. 3).

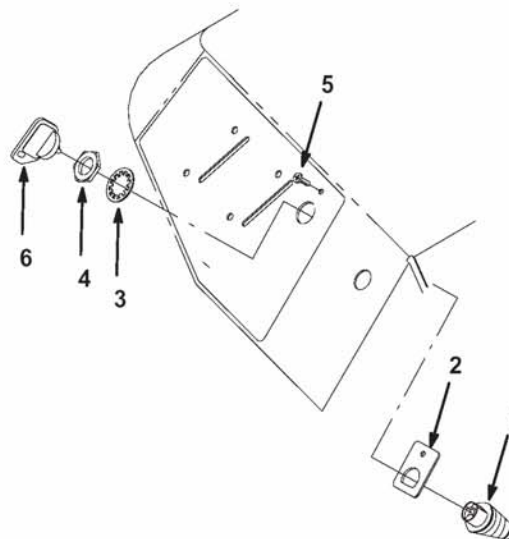

Figure 3

- |                 |            |
|-----------------|------------|
| 1. Switch       | 4. Jam nut |
| 2. Switch plate | 5. Screw   |
| 3. Star washer  | 6. Key     |

11. From the underside of the fender, insert the key switch w/ switch plate into the hole (Fig. 3).

12. Loosely mount the switch and the switch plate to the fender with the star washer and the jam nut provided with the switch (Fig. 3).
13. Align the hole in the switch plate with the pilot hole in the fender. Secure the switch plate to the fender with the screw provided (Fig. 3).
14. Tighten the nut securing the key switch to the fender (Fig. 3).
15. Route the wire harness to the new switch and plug the connectors onto the switch terminals.
16. Remove the knobs from the choke and throttle control levers.
17. Clean the control panel decal and affix the new decal over the decal. Install the knobs the onto control levers.
18. Connect the black (negative) cable to the battery.