



Installation Instructions

Installation

Loose Parts

Use the chart below to verify that all parts have been shipped.

Description	Qty.	Use
No parts required	—	Prepare the machine.
Front panel assembly	1	Install the steel cargo bed solid sides.
Left bed side assembly	1	
Right bed side assembly	1	
Tailgate assembly	1	
Torx-head screw (5/16 x 3/4 inch)	15	
Flange-head shoulder bolt (5/16 x 1-1/2 inches)	2	
Button-head shoulder bolt (5/16 x 1/2 inch)	4	
Lanyard	2	
Anti-rattle tailgate plug	2	
0.2 oz tube of Loctite® 243	1	

Preparing the Machine

- 1. Park the machine on a level surface.
- 2. Engage the parking brake.
- 3. Shut off the machine and remove the key.

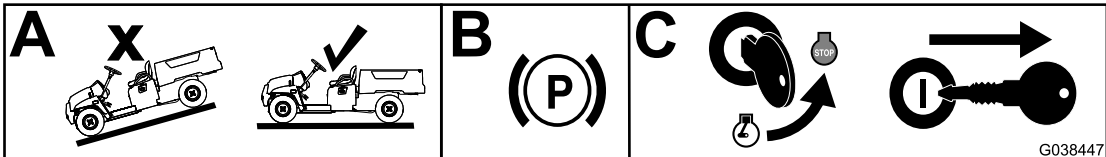

Figure 1

g038447



# Installing the Steel Cargo Bed Solid Sides

1. From underneath the cargo bed, loosely secure the front panel assembly to the cargo bed using 3 torx-head screws (5/16 x 3/4 inch) as shown in [Figure 2](#).

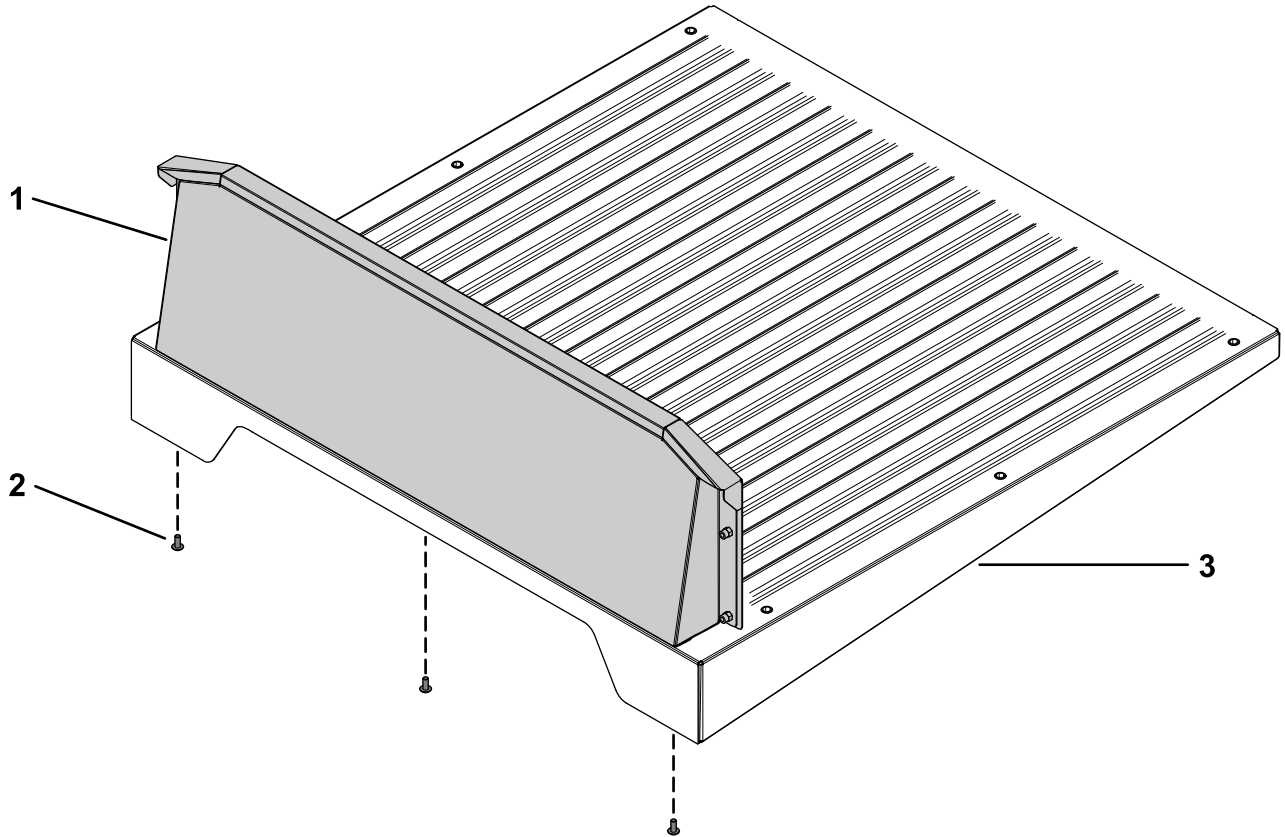
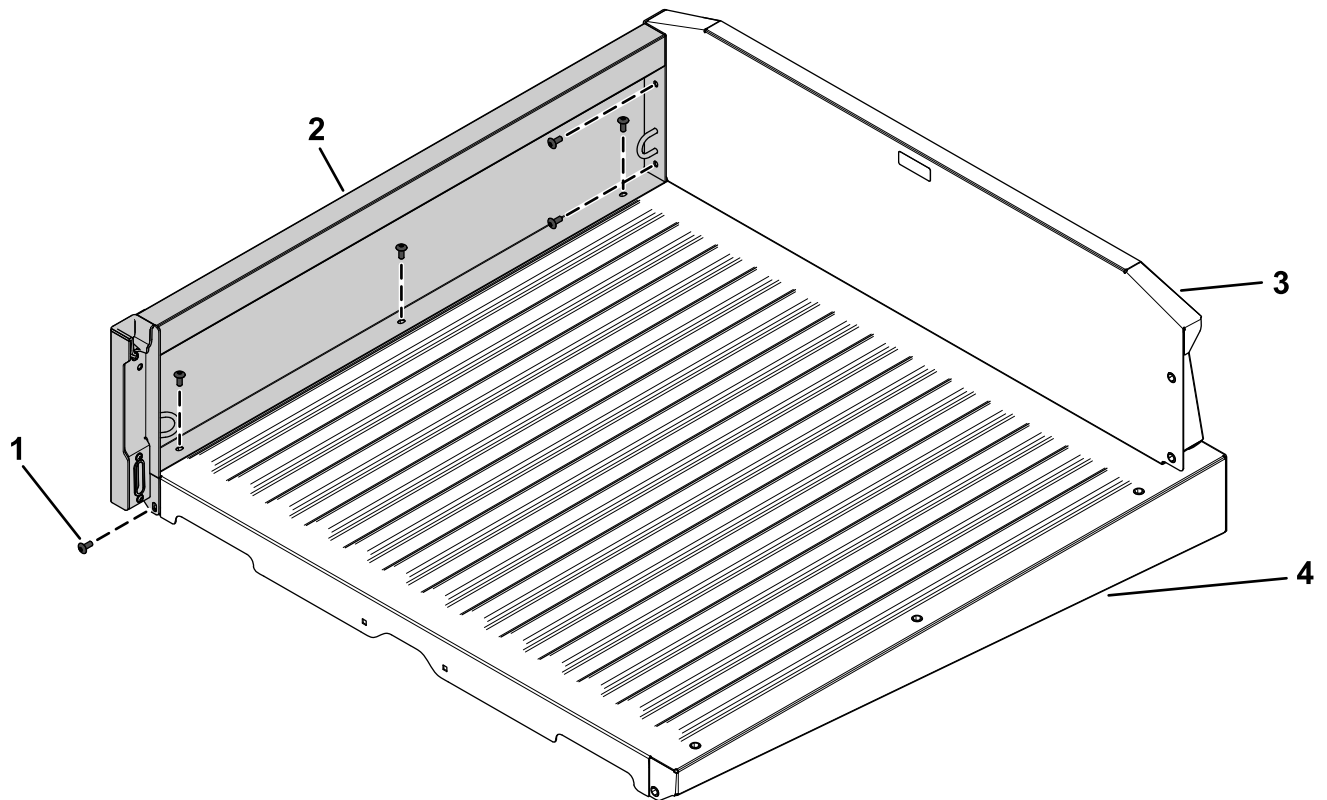

**Figure 2**

g326404

1. Front panel assembly
2. Torx-head screw (5/16 x 3/4 inch)
3. Cargo bed

2. Loosely secure the left bed side assembly to the front panel assembly and cargo bed using 6 torx-head screws (5/16 x 3/4 inch) as shown in [Figure 3](#).



g326405

**Figure 3**

- |                                      |                         |
|--------------------------------------|-------------------------|
| 1. Torx-head screw (5/16 x 3/4 inch) | 3. Front panel assembly |
| 2. Left bed side assembly            | 4. Cargo bed            |

3. Loosely secure the right bed side assembly to the front panel assembly and cargo bed using 6 torx-head screws (5/16 x 3/4 inch) as shown in [Figure 4](#).

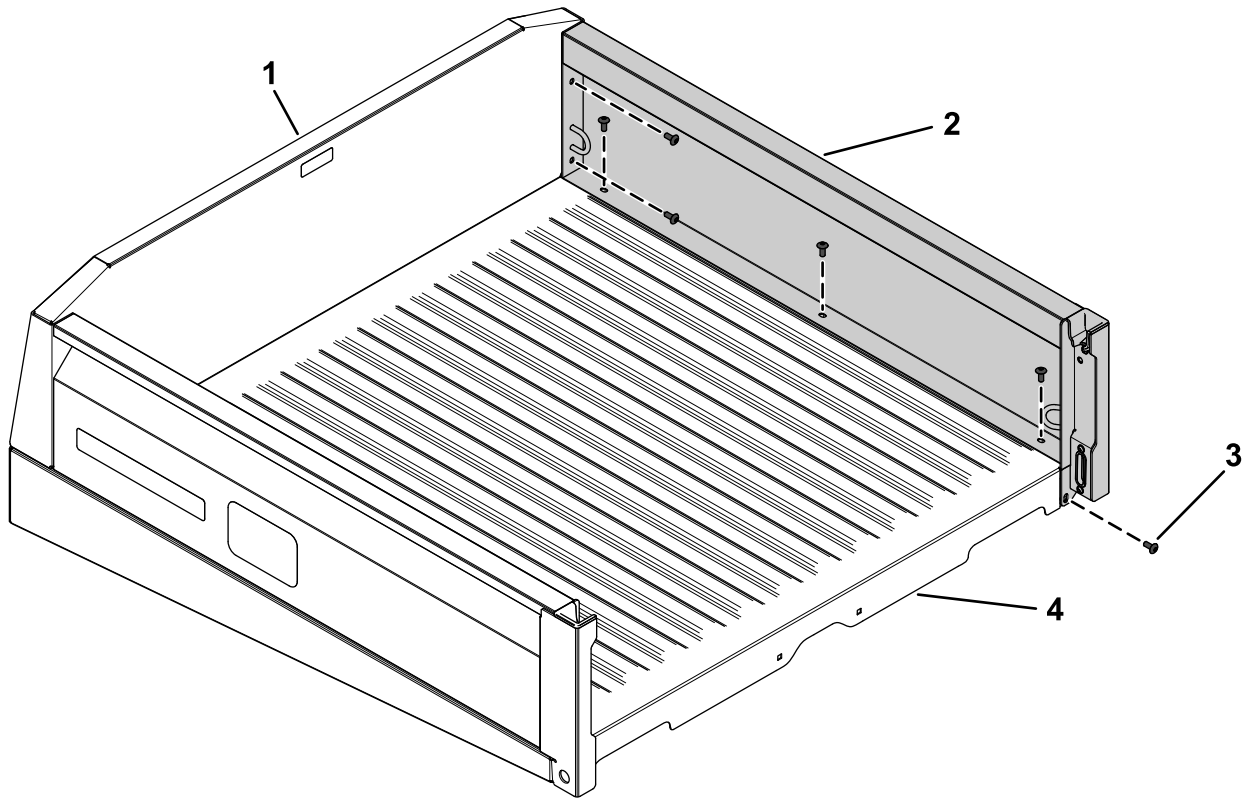

g326406

**Figure 4**

- |                            |                                      |
|----------------------------|--------------------------------------|
| 1. Front panel assembly    | 3. Torx-head screw (5/16 x 3/4 inch) |
| 2. Right bed side assembly | 4. Cargo bed                         |
- 
4. Torque the 15 torx-head screws (5/16 x 3/4 inch) to 20 to 26 N·m (15 to 19 ft-lb).

5. Apply Loctite® 243 to the threads of the 2 flange-head shoulder bolts (5/16 x 1-1/2 inches).
6. Loosely secure the tailgate assembly to the left and right bed side assemblies using the 2 flange-head shoulder bolts (5/16 x 1-1/2 inches) as shown in [Figure 5](#).

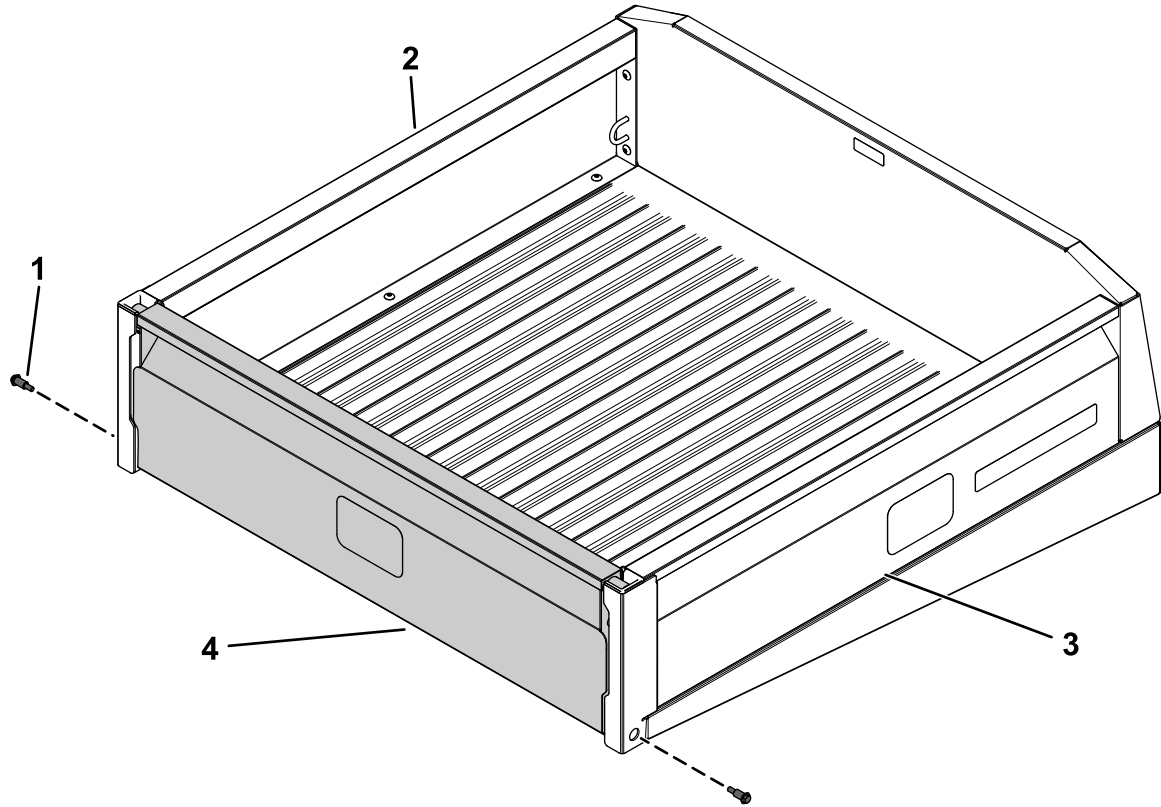

g326407

**Figure 5**

- |  |                            |
|--|----------------------------|
| 1. Flange-head shoulder bolt (5/16 x 1-1/2 inches) | 3. Right bed side assembly |
| 2. Left bed side assembly                          | 4. Tailgate assembly       |

- 
7. Torque the 2 flange-head shoulder bolts (5/16 x 1-1/2 inches) to 23 N·m (17 ft-lb).

8. Secure the 2 lanyards to the tailgate assembly using the 4 button-head shoulder bolts (5/16 x 1/2 inch) as shown in [Figure 6](#).

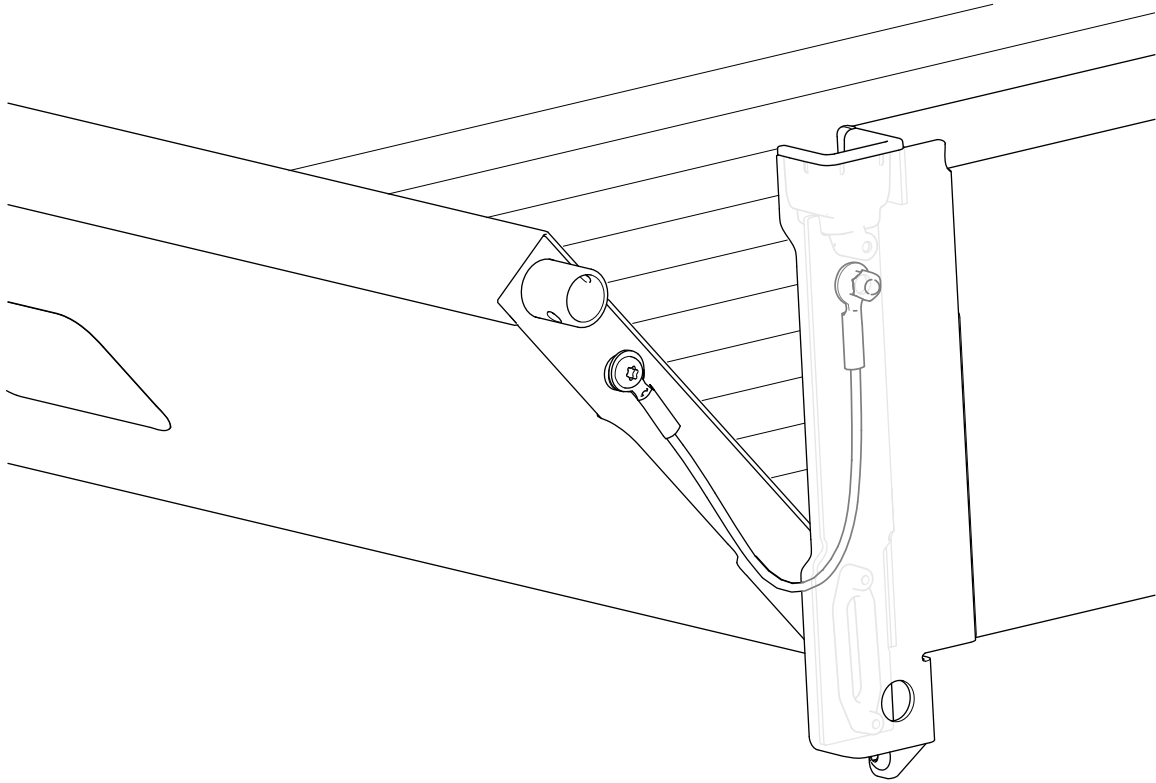

g326459

**Figure 6**  
Right side lanyard shown installed

9. Install the 2 anti-rattle tailgate plugs and ensure that 1.5 mm (1/16 inch) of the plugs protrude from the tailgate-latch pin ([Figure 7](#)).
10. Trim the installation tab so that it is flush with the plug body ([Figure 7](#)).

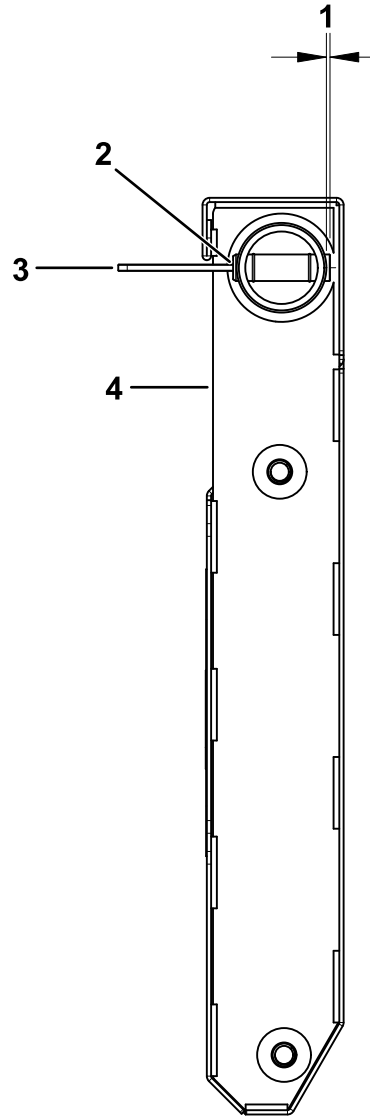

**Figure 7**

g326420

- |                                    |                              |
|------------------------------------|------------------------------|
| 1. 1.5 mm (1/16 inch)              | 3. Anti-rattle tailgate plug |
| 2. Trim the installation tab here. | 4. Tailgate assembly         |



**Count on it.**