



Customer Service Bulletin Commercial Business Group

Reelmaster® 5500-D

July 18, 2002

Model/Serial Range: **Model Number:**

03550
03551

Serial Numbers:

200000101-220000274
200000101-220000227

Subject: Reports of loose fittings

The two high-pressure Hoses (104-0050) that are connected to the left side of the pump may become loose. Hoses that are loose may leak and due to the pressure contained within the hose, any leak could allow large quantities of oil to escape.

At your earliest convenience, check the pump hoses for leaks and verify they are torqued to 59-66 Ft/Lbs (80-89Nm) or 1.50 ± 0.25 F.F.F.T. Should you find the fitting is leaking replace the O-ring (237-65) prior to torquing the fitting.

WARNING



Before disconnecting or performing any work on hydraulic system, all pressure in the system must be relieved by stopping the engine and lowering or supporting the implement.

Keep body and hands away from pin hole leaks or nozzles that eject fluid under pressure. Use paper or cardboard, not hands, to search for leaks. Hydraulic fluid escaping under pressure can have sufficient force to penetrate the skin and do serious damage. If fluid is injected into the skin, it must be surgically removed within a few hours by a doctor familiar with this type of injury or gangrene may result.

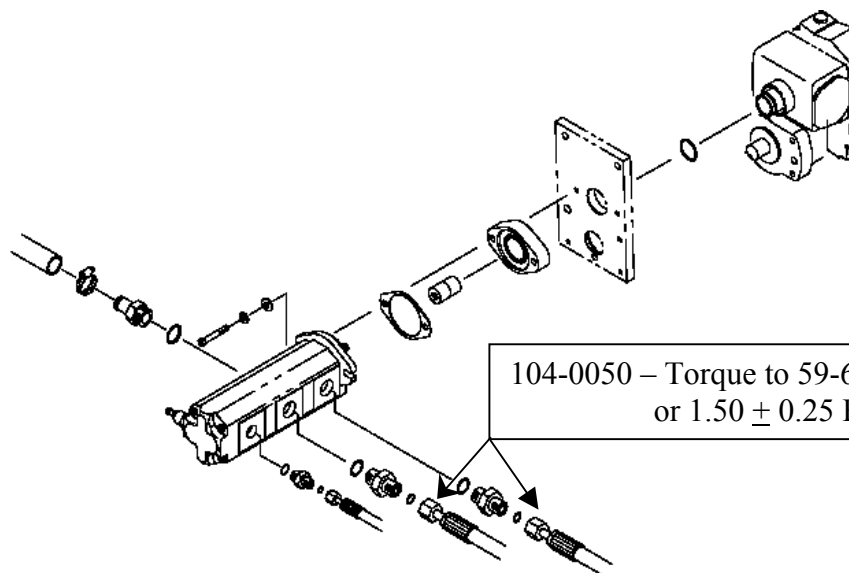

104-0050 – Torque to 59-66 Ft/Lbs (80-89 Nm)
or 1.50 ± 0.25 F.F.F.T.