



**Right-Hand Blade Shaft Kit**  
**ProLine H600 Rotary Mower**  
Model No. 162-0024

Form No. 3467-825 Rev A

**Installation Instructions**

**Note:** Determine the left and right sides of the machine from the normal operating position.

Install this kit onto machines with the following serial numbers.

Model	Serial Number
31040	323000140 and before

# Installation

1

## Preparing the Machine

No Parts Required

### Procedure

1. Park the machine on a level surface, engage the parking brake, shut off the engine, and remove the key.

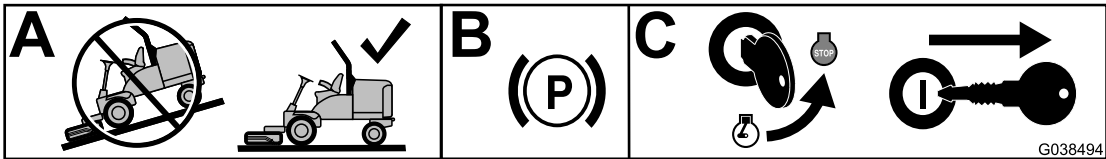

Figure 1

g387526

2. Thoroughly clean the cutting unit. Remove all debris to ensure that the baffles fit properly against the cutting unit.
3. Rotate the cutting unit into the maintenance position as required; refer to your machine *Operator's Manual*.



# 2

## Removing the Existing Spindle Assembly

No Parts Required

### Procedure

1. Remove the right spindle assembly as show in [Figure 4](#). Refer to the service manual for the machine.
2. Set aside the parts for the installation procedure.

# 3

## Installing the New Spindle Shaft and the Oil-Seal Guard

Parts needed for this procedure:

1	Spindle shaft
1	Oil-seal guard

### Procedure

1. Use the following figures to identify the new spindle shaft and oil-seal guard ([Figure 2](#) and [Figure 3](#)).

**Note:** The new spindle shaft has 2 grooves and the new oil-seal guard has a groove for identification.

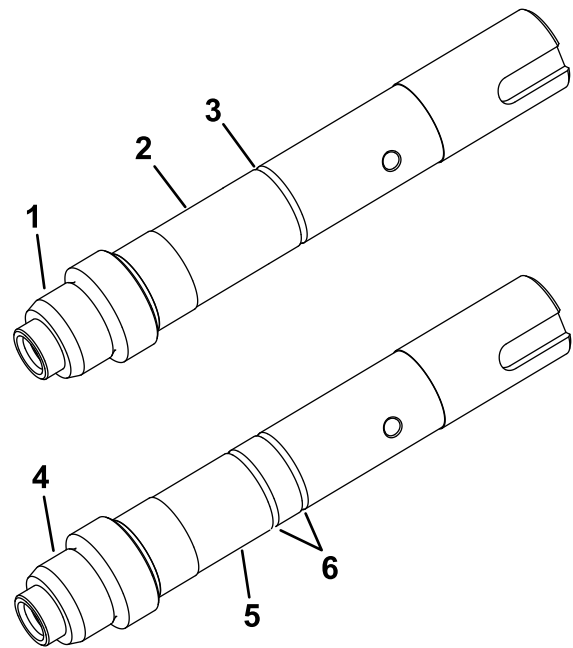

Figure 2

- |                           |                      |
|---------------------------|----------------------|
| 1. Right-hand threads     | 4. Left-hand threads |
| 2. Existing spindle shaft | 5. New spindle shaft |
| 3. Groove                 | 6. Grooves           |

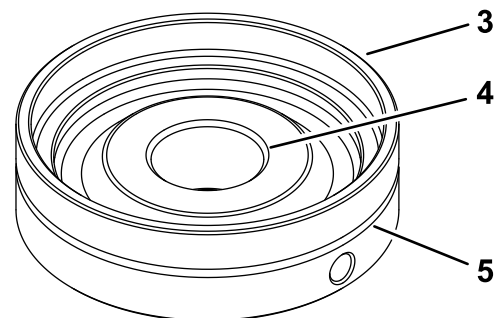
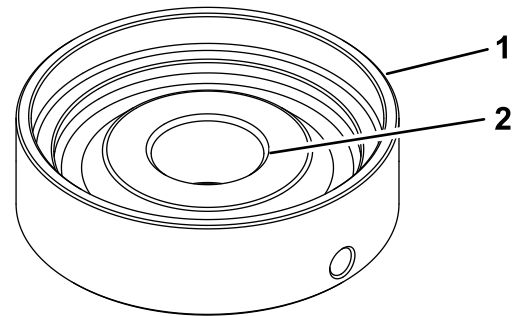

Figure 3

- |                            |                      |
|----------------------------|----------------------|
| 1. Existing oil-seal guard | 4. Left-hand threads |
| 2. Right-hand threads      | 5. Groove            |
| 3. New oil-seal guard      |                      |

2. Use the previously removed parts and [Figure 4](#) to install the new spindle shaft and oil-seal

guard, refer to the service manual for the machine.

**Important:** The new oil-seal guard has a left-hand thread. Turn the new oil-seal guard counter-clockwise to tighten it.

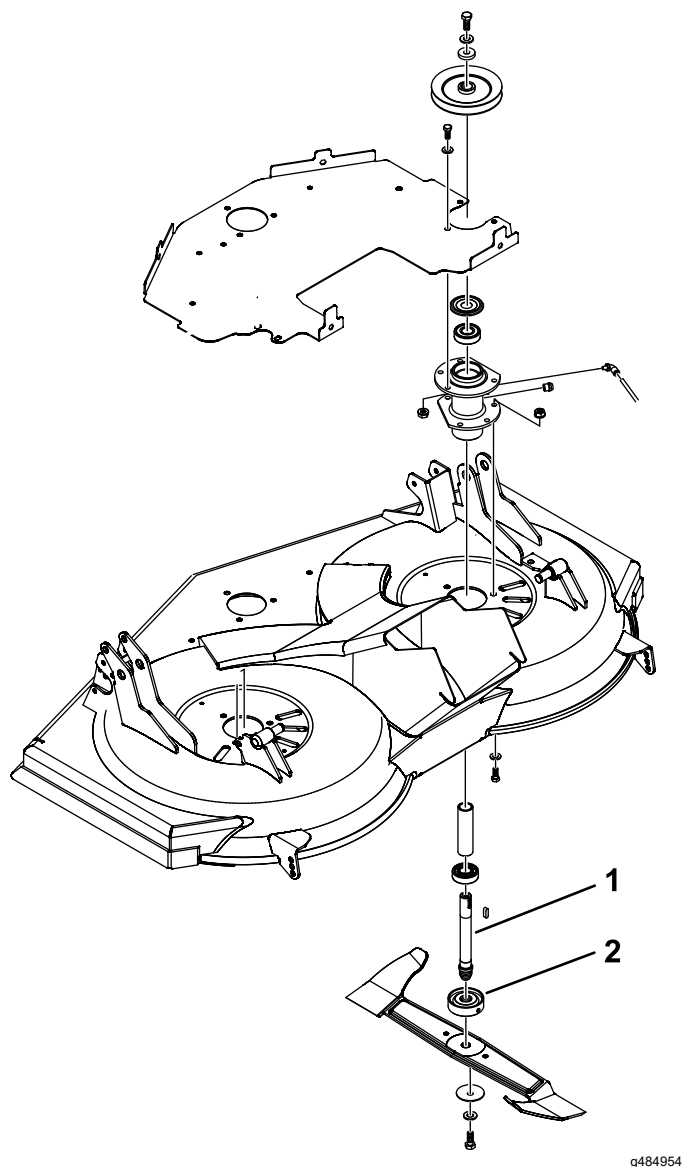

**Figure 4**

- |                  |                   |
|------------------|-------------------|
| 1. Spindle shaft | 2. Oil-seal guard |
|------------------|-------------------|

- 
3. Torque the blade bolt to 53 N·m (39 ft-lb).
  4. Discard the old spindle shaft and the old oil-seal guard.



**Count on it.**