



Power Shovel™ Snowthrower

Model No. 38310—Serial No. 220020001 and Up

Form No. 3327-519 Rev A

Operator's Manual

IMPORTANT SAFETY INSTRUCTIONS

When using an electrical appliance, basic precautions should always be followed, including the following:

READ ALL INSTRUCTIONS BEFORE USING THIS APPLIANCE

WARNING—To reduce the risk of fire, electric shock, or injury, follow these safety instructions.

It is essential that you or any other operator of the appliance read and understand the contents of this manual before operating the appliance. Pay particular attention to the safety alert symbol  which means CAUTION, WARNING or DANGER—personal safety instruction. Read and understand the instruction because it has to do with safety. **Failure to comply with these instructions may result in personal injury, risk of fire, or electrical shock.**

Replacement parts—When servicing use only identical replacement parts. Replace or repair damaged cords.

Do not use on graveled surface unless the snowthrower is adjusted for such a surface in accordance with the operator's manual.

Keep children and bystanders away—All visitors should be kept at a distance from the work area.

Dress properly—Do not wear loose clothing or jewelry. They can be caught in moving parts.

Wear rubber boots when operating the snowthrower.

Operation of the snowthrower in the hand-held position is unsafe, except in accordance with the special instructions for such use provided in the operator's manual.

Warning—To prevent electric shock, use only with an extension cord suitable for outdoor use. (Does not apply to battery-operated snowthrowers.)

Extension cords—To prevent disconnection of snowthrower cord from the extension cord during operation, make a knot as shown in Figure 7.

Avoid accidental starting—Don't carry the snowthrower with your finger on the switch. Be sure switch is off when plugging in.

If cord is damaged in any manner while plugged in, pull extension cord from wall receptacle.

Don't abuse cord—Never carry snowthrower by cord or yank it to disconnect from receptacle. Keep cord from heat, oil, and sharp edges. (Does not apply to battery-operated snowthrowers.)

Keep hands away from moving parts.

Keep guards in place and in working order.

Don't force snowthrower—It will perform better and safer at the rate for which it was designed.

Don't overreach—Keep proper footing and balance at all times.

If the snowthrower strikes a foreign object, follow these steps:

- Stop the snowthrower.
- Inspect for damage.
- Repair any damage before restarting and operating the snowthrower.

Disconnect snowthrower—Disconnect the snowthrower from the power supply when not in use, before servicing, when changing accessories, and the like.

Store idle snowthrowers indoors—When not in use, snowthrowers should be stored indoors in dry, locked place—out of reach of children.

Maintain snowthrowers with care—Follow instructions for lubricating and changing accessories.

SAVE THESE INSTRUCTIONS

Safety and Instruction Decals



Safety decals and instructions are easily visible to the operator and are located near any area of potential danger. Replace any decal that is damaged or lost.



105-9404

AVERTISSEMENT !

Un choc électrique risque de provoquer des blessures graves, voire mortelles. Pour éviter tout choc électrique : RETIRER LA GOUPILLE D'EXPÉDITION AVANT D'ENLEVER CETTE ÉTIQUETTE ET D'ESSAYER DE SÉPARER LES TUBES. NE PAS UTILISER LA PELLE ÉLECTRIQUE SI L'ISOLATION DU FIL À L'INTÉRIEUR DU TUBE EST ENDOMMAGÉE. LIRE LES INSTRUCTIONS D'ASSEMBLAGE ET LE MANUEL DE L'UTILISATEUR.

WARNING!

Electric shock can cause serious injury or death. To avoid electric shock: REMOVE SHIPPING PIN ABOVE BEFORE REMOVING THIS LABEL AND ATTEMPTING TO SEPARATE TUBES. DO NOT USE POWER SHOVEL IF WIRE INSULATION INSIDE OF TUBE IS DAMAGED. READ ASSEMBLY INSTRUCTIONS AND OPERATOR'S MANUAL.

104-9390

! DANGER

AVOID INJURY! FROM ROTOR / IMPELLER.
KEEP HANDS, FEET AND CLOTHING AWAY FROM DISCHARGE AREA.
DO NOT STEP IN FRONT OF MACHINE, OR USE HANDS TO UNCLOG CHUTE.
STOP MOTOR AND UNPLUG CORD BEFORE UNCLOGGING SNOW OR DEBRIS.
DO NOT DIRECT DISCHARGE AT OTHERS. USE FOR SNOW REMOVAL ONLY.
TO PREVENT ELECTRIC SHOCK, REPLACE DAMAGED CORD IMMEDIATELY.

ÉVITER LES BLESSURES ! DU ROTOR/IMPULSEUR.
TENIR MAINS, PIEDS ET VÊTEMENTS À L'ÉCART DE LA ZONE D'ÉVACUATION.
NE PAS MARCHER DEVANT LA MACHINE, NI DÉBOUCHER LA GOULOTTE AVEC LES MAINS.
COUPER LE MOTEUR ET DÉBRANCHER LE CORDON AVANT D'ENLEVER NEIGE OU DÉBRIS.
NE PAS DIRIGER L'ÉVACUATION VERS AUTRUI. N'UTILISER QUE POUR L'ENLÈVEMENT DE LA NEIGE.
POUR ÉVITER TOUT CHOC ÉLECTRIQUE, REMPLACER IMMÉDIATEMENT UN CORDON ENDOMMAGÉ.

DOUBLE INSULATED --- When servicing, use only identical replacement parts.
À DOUBLE ISOLATION ---- Lors de toute réparation, utiliser uniquement des pièces de rechange identiques.

Read operator's manual for operating and safety instructions.
Replacement manual available by sending model and serial numbers to the TORO CO. 8111 Lyndale Av. S., Mpls, MN 55420

Lire le mode d'emploi et les consignes de sécurité figurant dans le manuel de l'utilisateur. Pour obtenir un manuel de rechange, envoyer les numéros de modèle et de série à l'adresse suivante :
TORO CO. 8111 Lyndale Av. S., Mpls, MN 55420

US LISTED SNOW MOVER 546X
LISTED®

MACHINE À DÉPLACER LA NEIGE 546X HOMOLOGUÉE UL

TORO MODEL 38310
115 VAC 60 HZ 6.6 AMP.

TORO MODÈLE 38310
115 VCA 60 HZ 6.6 A.

104-9391

Assembly



Caution



Internal wiring could be damaged during shipping or assembly, causing serious personal injury when operating the snowthrower.

- Use care so that the electrical wiring will not be damaged during assembly.
- If wiring is damaged, do not assemble the snowthrower. Contact your Authorized Service Dealer.

Assembling the Upper and Lower Tubes

1. Remove the shipping wire secured to the upper and lower tube sections (Fig. 1).

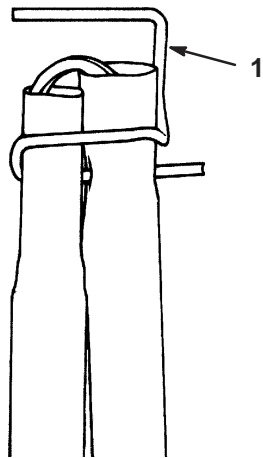
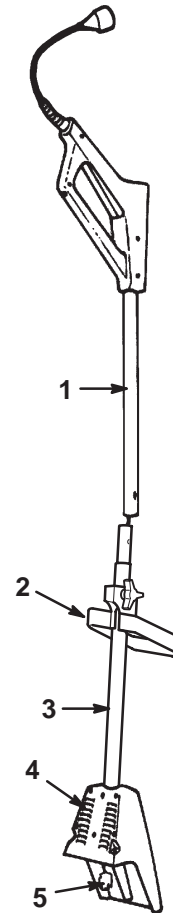

Figure 1

247

1. Shipping wire

2. Slide the adjustable handle onto the lower tube (Fig. 2).



2197

Figure 2

- | | |
|----------------------|-------------------|
| 1. Upper tube | 4. Handle support |
| 2. Adjustable handle | 5. Wire harness |
| 3. Lower tube | |

3. Slide the lower tube into the upper tube until the screw holes line up (Fig. 3).

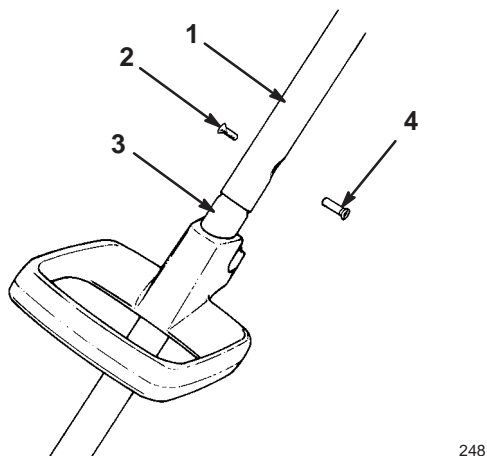

Figure 3

- | | |
|------------------|--------------------|
| 1. Upper tube | 3. Lower tube |
| 2. Slotted screw | 4. Countersunk nut |

4. Secure the upper and lower tubes by inserting the countersunk nut and the slotted screw (supplied in the loose parts bag) through the aligned holes in the tubing (Fig. 3).

Note: If the internal wiring blocks the hole, gently move the wiring to one side using the shipping wire.

5. Loosely install the adjustable handle to the tube with a carriage bolt and a knob (supplied in the loose parts bag) as shown in Figure 4.

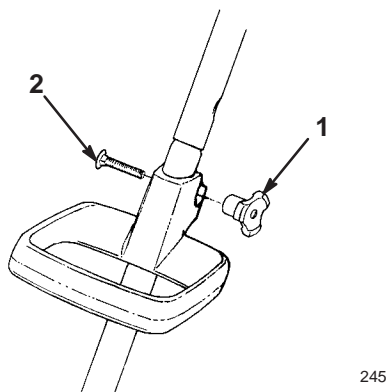

Figure 4

- | | |
|------------------|---------|
| 1. Carriage bolt | 2. Knob |
|------------------|---------|

6. Move the adjustable handle to the desired operating position by sliding the handle to the desired height and tightening the knob.

Attaching the Power Head

1. Position the power head and the handle support as shown in Figure 5A.

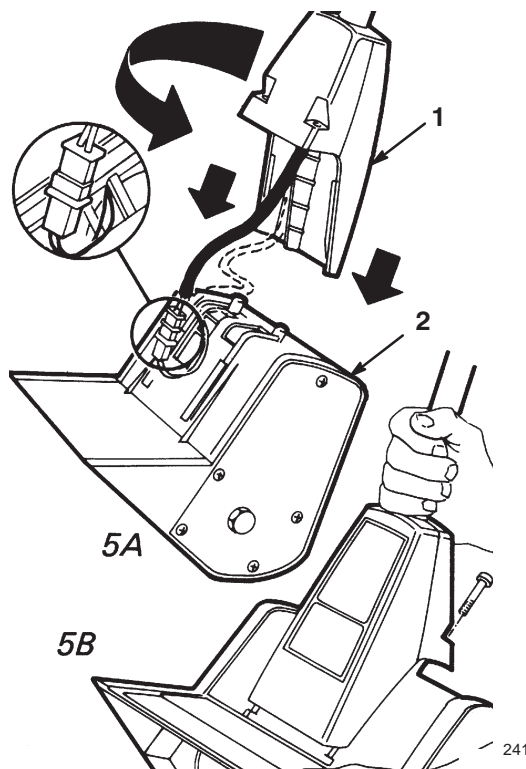

Figure 5

- | | |
|-------------------|---------------|
| 1. Handle support | 2. Power head |
|-------------------|---------------|

2. Pull the power head connector out of the motor housing hole.
3. Assemble the power head connector and the handle connector by sliding the connectors together (Fig. 5A) until they snap.

Note: There is only one way to fit the connectors together.

4. Push the connectors into the motor housing hole.
5. Position the handle support as shown in Figure 5B (the Power Shovel decal should be facing up).
6. Slide the handle support over the power head, ensuring that the grooves in the handle support and power head are interlocked (Fig. 5B).

Important If the handle support does not slide completely into position, check the electrical wiring and connectors to ensure they are inside the motor housing hole and not interfering with the assembly.

7. Insert a Phillips head screw (supplied in the loose parts bag) through the hole in the rear of the handle support (Fig. 5B) and screw securely into the motor housing. Repeat with the second Phillips head screw.



Operation

Preparing the Snowthrower

For safe and efficient use of your Power Shovel, use only a UL-listed extension cord recommended for outdoor use. Refer to the Extension Cord Chart below.

Extension Cord Chart		
If length of extension cord is less than or equal to:	100 ft. (30 m)	150 ft. (46 m)
Assure wire size gauge (A.W.G.) in cord is:	16	14

Note: Do not use an extension cord over 150 feet (46 m) long.

**Warning**

Contact with water while operating the Power Shovel could cause electric shock, causing injury or death.

- **Don't handle the plug or the appliance with wet hands or while standing in water.**
- **Use only a UL-listed extension cord recommended for outdoor cold weather use. Refer to Extension Cord Chart on page 5.**

Your Power Shovel has a polarized plug. One prong in the Power Shovel cord is larger than the other (Fig. 6).

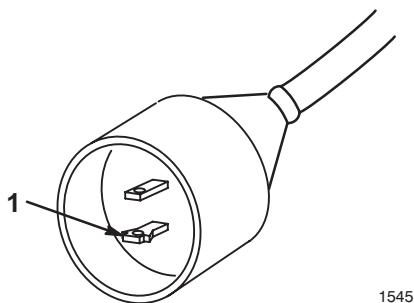

Figure 6

1. Enlarged prong

Note: When inserting the end of a suitable extension cord into the Power Shovel cord, insert the enlarged prong into the wide slot in the extension cord end. See the Important Safety Instructions on page 1 for additional information.

1. Tie the extension cord to the lower handle of the control grip (Fig. 7) before connecting it to the Power Shovel cord. This helps prevent the cords from separating during operation.

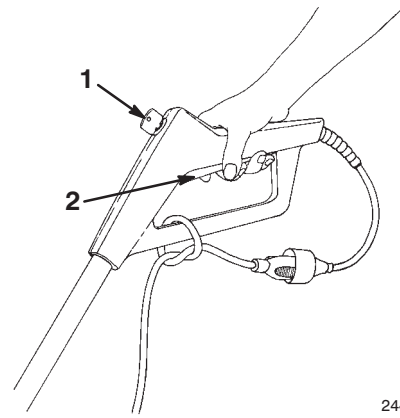

Figure 7

1. Key
 2. Switch bar
2. Plug the extension cord into a wall outlet and insert the key into the hole located on the front side of the control grip (Fig. 7).
 3. Keep the area to be cleared free of stones, toys, or other foreign objects which the rotor blades may pick up and throw. Such items could be covered by snowfall and remain unnoticed. Always keep children and pets away from the area of operation.

Starting and Stopping

To start the Power Shovel, install the key and squeeze the switch bar. To stop, release the switch bar (Fig. 7).

Operating Tips

- Start the Power Shovel and tilt it forward until the scraper blade contacts the ground. Push the Power Shovel forward at a comfortable rate of speed, yet slow enough to clear the path completely. The width and depth of the snow determines your forward speed.
- Direct the snow to the right or to the left by holding the Power Shovel at a slight angle (Fig. 8).

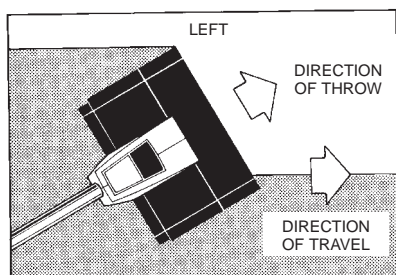
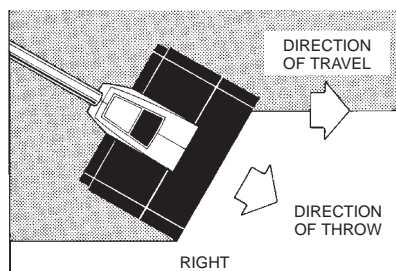

Figure 8

243

- For the most efficient snow removal, throw the snow downwind, and slightly overlap each swath.
- If you need to clear snow from crushed rock or gravel, push down on the handle to raise the scraper clear of loose material that the rotor blades could throw.
- The Power Shovel can remove snow up to 4 in. (10 cm) deep in one pass. When clearing deeper drifts, hold the Power Shovel by the upper and lower handles and use a swinging or sweeping motion. Remove a maximum of 4 in. (10 cm) with each pass and repeat as many times as required.
- Keep the cord clear of obstructions, sharp objects, and rotor. Do not pull sharply on the cord or abuse it in any manner. Frequently inspect the cord for damage. If it is damaged, replace the cord.
- Remove the key and disconnect the extension cord after using the Power Shovel. Hang the Power Shovel on a nail from the hole in the rear of the control grip. Hang the extension cord with the Power Shovel so it will not be misplaced or damaged.

Maintenance



Warning



If the extension cord is plugged into snowthrower and the key is in the handle, someone could accidentally operate snowthrower while you are performing maintenance on it, causing serious personal injury.

Disconnect the extension cord before you perform any maintenance. Remove the key from the handle.

Lubricating the Power Shovel

The Power Shovel does not need lubrication; all bearings are lubricated at the factory for the life of the product.

Preparing the Power Shovel for Storage

1. Examine the Power Shovel thoroughly for worn, loose, or damaged parts. If parts repair or replacement is necessary, contact an Authorized Service Dealer for assistance.
2. Examine the extension cord thoroughly for signs of excess wear or damage. If it is worn or damaged, replace it.
3. Disconnect the extension cord from the Power Shovel before storing. Remove the key from the handle.
4. Store the Power Shovel in a clean, dry, locked-up place out of the reach of children and cover it to provide protection.

Toro Service Support

If your Power Shovel requires service or maintenance, an Toro Master Service Dealer is the best dealer to assist you. Refer to the “Yellow Pages” of your local telephone directory in the section titled “Lawn Mowers.” Toro Master Service Dealers are listed under the Toro trademark. If you need help locating a Toro Master Service Dealer near you, call 1-800-421-9684 for assistance.

Product Identification

A model and serial number decal is located on the lower tube. Always refer to specific numbers on the decal in correspondence or when you need replacement parts.

The Toro Promise

A Two-Year Full Warranty for Residential Use for the United States, Canada, and Mexico

General Conditions

The Toro Company and its affiliate, Toro Warranty Company, pursuant to an agreement between them, jointly warrant this product for two years against defects in material or workmanship when used for normal residential purposes. To receive a replacement or repair, at our option, return the complete unit, postage prepaid, to the seller. **Only** United States customers may return their product, with proof of purchase, to any Authorized Service Dealer, Master Service Dealer, or the Toro Service Center, 5300 Shoreline Boulevard, Mound, MN 55364.

This warranty covers product defects only. **Neither The Toro Company nor Toro Warranty Company is liable for indirect, incidental or consequential damages in connection with the use of the Toro Products covered by this warranty, including any cost or expense of providing substitute equipment or service during reasonable periods of malfunction or non-use pending completion of repairs under this warranty. Some states do not allow exclusions of incidental or consequential damages, so the above exclusions may not apply to you.** This warranty gives you specific legal rights, and you may also have other rights which vary from state to state.

If all other remedies fail, you may contact at: Customer Service Department, Toro Warranty Company, 8111 Lyndale Avenue South, Bloomington, MN 55420-1196. **Do not** return defective product to this address.

Countries Other than the United States, Canada, or Mexico

Customers who have purchased Toro products exported from the United States, Canada, or Mexico should contact their Toro Distributor (Dealer) to obtain guarantee policies for your country, province, or state. If for any reason you are dissatisfied with your Distributor's service or have difficulty obtaining guarantee information, contact the Toro importer. If all other remedies fail, you may contact us at Toro Warranty Company.

Part No. 374-0055 Rev. –