



TransPro Frame Rail Ramp Flat Ramp TransPro 80

Model No. 04238—Serial No. 220000001 and Up

Model No. 04244

Model No. 04245

Form No. 3329-551

Installation Instructions

Mount Tongue Assembly

1. Insert tongue assembly into frame assembly while aligning rear mounting holes (Fig. 1).
2. Secure tongue assembly into frame assembly with a clevis pin, (2) washers and (2) cotter pins (Fig. 1).

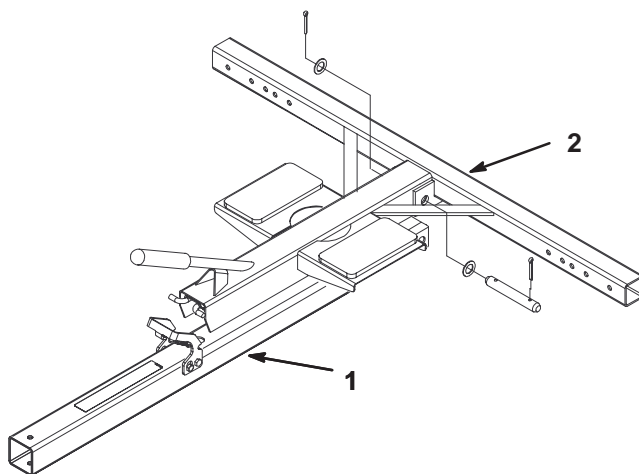

Figure 1

1. Tongue assembly 2. Frame assembly

2. Mount axle assembly and a ramp assembly (Fig. 3) or rail assembly (Fig.) to each end of frame with (2) 3/8-16 x 3-1/2" lg. bolts, (4) washers and (2) nuts.

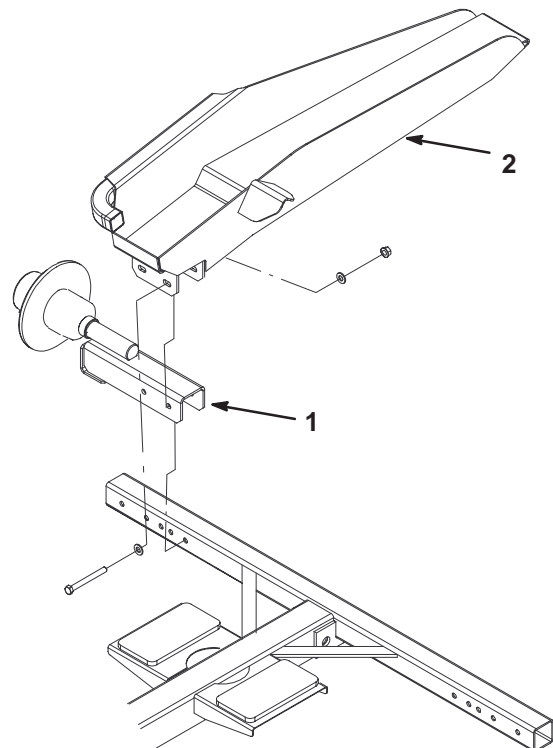

Figure 3

1. Axle assembly 2. Ramp assembly (R.H.)

Mount Axle and Ramp (Model 04245) or Rail (Model 04244) Assemblies

1. Refer to figure 2 to determine which mounting holes should be used to fit the width of your greensmower.

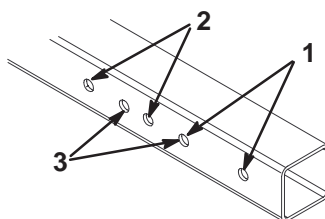

Figure 2

- | | |
|------------------------------------|----------------------|
| 1. GR 1600 or GR 1000
w/Groomer | 2. GR 800 |
| | 3. GR 1000 & Flex 21 |

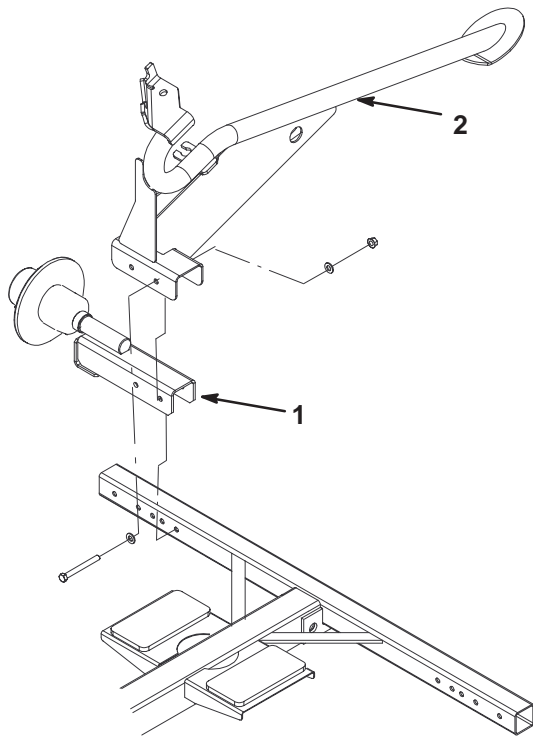

Figure 4

1. Axle assembly 2. Rail assembly (R.H.)

Mount Wheel Assemblies

1. Mount a wheel assembly to each axle hub with (4) lug nuts (Fig. 5). Tighten nut to 80 ft/lb.
2. Inflate tires to 5 psi.

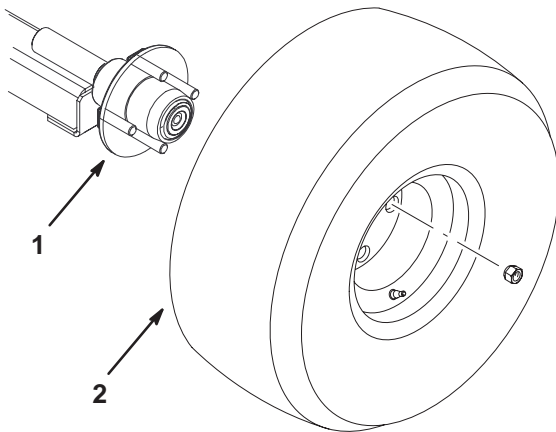

Figure 5

1. Axle 2. Wheel assembly

Important Higher tire pressure may cause damage to greensmower.

Mount/Adjust Hitch Straps

Hitch straps are shipped mounted in the standard position (Fig. 6).

Important Trailer tongue to be parallel to ground when aligned with tow vehicle hitch.

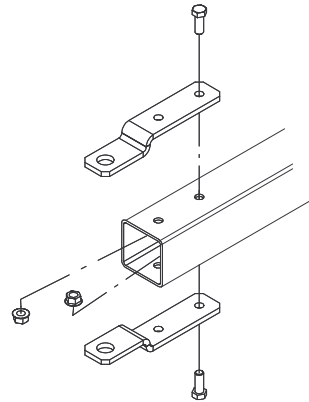

Figure 6

1. Standard position

1. Using one of the configurations in figure 7 or 8, adjust and secure hitch straps to trailer tongue.

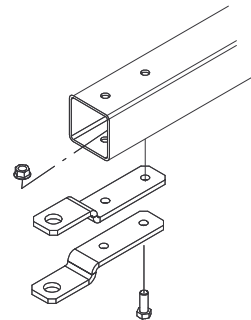

Figure 7

1. Low hitch position 2.

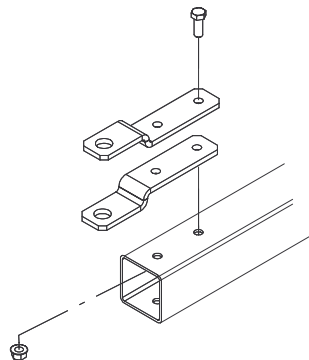

Figure 8

1. High hitch position

Mount Greensmower Wheel Assemblies (Model 04244 only)

Note: On Greensmaster 1000 equipped with a groomer, Model 04052, the wheel shaft, on the groomer end, must be removed and a new wheel shaft, part no. 106-5385 must be purchased and installed. Also, the rail assembly, on the groomer end, must be mounted in the outside (GR 1600) hole locations (Fig. 2).

1. Remove existing standard transport wheels from wheel shafts on greensmower (if so equipped).

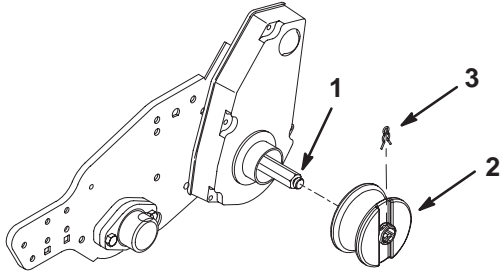

Figure 9

1. Wheel shaft (L.H. shown)
2. Wheel
3. Wheel clip

2. Insert a wheel onto each shaft and secure with a wheel clip (Fig. 9).

Loading Trailer

1. Press down on latch assembly and lift handle (Fig. 10). Lower trailer bed to ground.

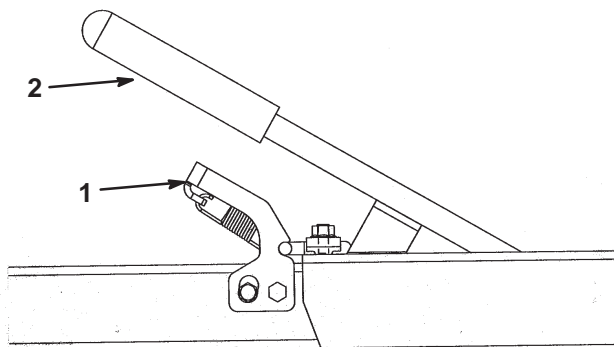

Figure 10

1. Latch assembly
2. Handle

2. Pivot wheel rods upward (Fig. 11).
3. Remove baskets from greens mower, disengage reel drive and move throttle to slowest position. SLOWLY drive greens mower onto trailer until wheel stops are contacted.
4. Stop engine and engage parking brake.

5. Engage wheel rods as follows:

- On flat ramps, rotate wheel rods downward over greens mower transport wheels (Fig. 11).
- On rail ramps, lift wheel rod and rotate behind greens mower transport wheels (Fig. 12).

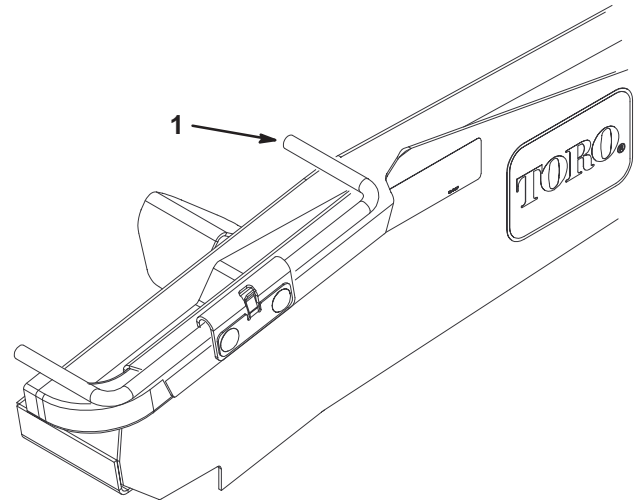

Figure 11

1. Wheel rod

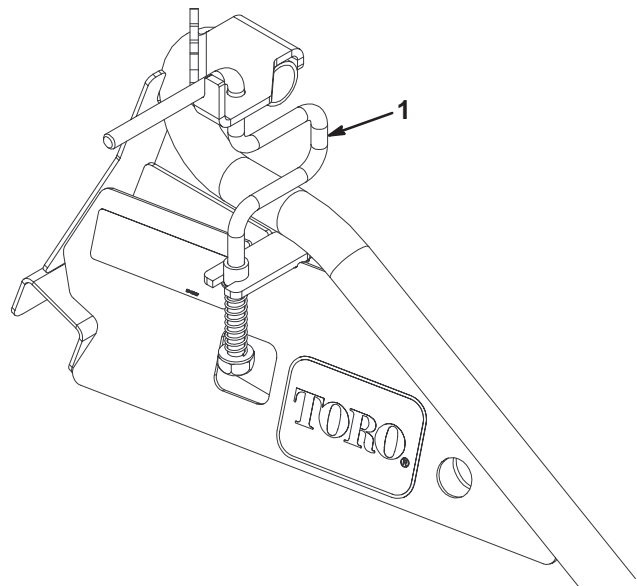

Figure 12

1. Wheel rod

6. Push down on handle until trailer assembly locks into latch assembly.
7. Store basket in tow vehicle.

Operation

1. The TRANSPRO 80 is intended for use with Greensmaster 800, 1000, 1600 and Flex 21 Walk Greens Mowers. The towing of other products may result in damage to axles and transmissions that continue to rotate when towed.
2. **USE ONLY A VEHICLE WITH THE PROPER TOW RATING.** The TRANSPRO 80 and one greens mower weigh approximately 400 lbs. Ensure that the tow vehicle has adequate braking and handling capacity by checking the recommendations of the vehicle manufacturer.
3. Ensure that the trailer is properly connected to the tow vehicle before loading or unloading the greens mower to prevent sudden unintended tongue movement or flip up. Use a retention device on hitch pin to secure connection.

Important Trailer tongue to be parallel to ground when aligned with tow vehicle hitch.

4. Strap Greensmower to trailer when driving on rough or hilly terrain.
5. The TRANSPRO 80 adds extra towing weight to the vehicle. Drive the vehicle safely.
 - Do not drive on highway or public roads.
 - Always SLOW the tow vehicle when approaching and while making a turn.
 - Always SLOW the tow vehicle when driving in unfamiliar areas or over rough terrain.
 - Always SLOW the tow vehicle when changing direction of travel or preparing to stop.
 - When turning or driving on slopes, always SLOW the tow vehicle, then turn to prevent loss of control and possible upset.
 - DO NOT make sudden or sharp turns. DO NOT suddenly change direction of travel on an incline, ramp, grade, slope or similar surface.
 - Maximum towing speed is 15 mph (24 kmh). Always adjust the tow vehicle speed to allow for existing ground conditions such as wet slick surfaces, loose sand or gravel and/or low visibility conditions such as dim or bright lighting, fog, mist or rain.
 - Be especially careful when driving a heavily loaded vehicle down an incline or slope. Drive the vehicle UP and DOWN the face of the slopes, inclines or grades whenever possible. DO NOT DRIVE across the face if at all possible. There is a risk of upsetting the vehicle, which can result in serious injury or death.

6. Before backing up, look to the rear and assure no one is behind. Back up slowly and watch the trailer movement closely.
7. Use extreme caution and slow speed when backing up the trailer and tow vehicle.
8. Watch out for traffic when near or crossing roads. Always yield the right of way to pedestrians and other vehicles.
9. If the trailer begins to vibrate abnormally, stop immediately. Shut off the tow vehicle engine. Repair all damage before commencing towing.
10. Before servicing or making any adjustments to the trailer:
 - Stop the tow vehicle and set the parking brake.
 - Shut off the tow vehicle's engine and remove key from ignition.
11. Keep all nuts, bolts and other fasteners tightened securely. Replace any parts removed during servicing or adjustments.
12. To assure optimum performance and continued safety of this product, always use genuine TORO replacement parts. Replacement parts and accessories made by other manufacturers may affect the product's operation, performance or durability. Such use could also void the warranty of The Toro Company.