



MODEL NO. 41359

OPERATORS, SET-UP  
AND PARTS MANUAL**ENCLOSED WALKING BOOM TRAILER**

SERIAL NO. 200000121 &amp; UP

To assure maximum safety, optimum performance, and to gain knowledge of the product, it is essential that you or any other operator of this equipment read and understand the contents of this manual before the product is used. Pay particular attention to the **SAFETY INSTRUCTIONS** highlighted by the triangular safety alert symbol.



The safety alert symbol means **CAUTION, WARNING, or DANGER** — personal safety instruction. Failure to comply with the instruction may result in personal injury.

**FOREWORD**

You have purchased a product from the industry leader in maintenance excellence. Its future performance and dependability are of prime importance. TORO is also concerned about future use of the product and of safety to the user. Therefore, this manual must be read by you and those involved with the **ENCLOSED WALKING BOOM TRAILER** to assure that safety, proper set-up, operation and maintenance procedures are followed at all times. The major sections of the manual are:

1. SAFETY INSTRUCTIONS
2. SET-UP INSTRUCTIONS

3. OPERATING INSTRUCTIONS
4. MAINTENANCE

**SAFETY INSTRUCTIONS**

Keep this manual in the plastic tube on the spray vehicle or sprayer.

It is very important that all persons operating this equipment have easy access to these instructions at all times!

Carefully read and follow the "SAFETY" "SET-UP" and "OPERATING" Instructions.



The safety alert symbol means **CAUTION, WARNING OR DANGER** - "personal safety instruction". Read and understand the instruction because it has to do with safety. Failure to comply with the instruction may result in personal injury.

Safety, mechanical and some general information in this manual are emphasized. **DANGER, WARNING** and **CAUTION** identify safety messages. Whenever the triangular safety symbol appears, it is followed by a safety message that must be read and understood. For more details concerning safety, read the **SAFETY** Instructions on this page and page 2.

**IMPORTANT** identifies special mechanical information and **NOTE** identifies general information worthy of special attention. These instructions are provided as a guide for the safe set-up, operation and maintenance of this equipment. However, the operator's personal safety, as well as the persons in the work area, will depend on the careful actions and good judgement of the operator. To reduce the potential for injury or death, comply with the following safety instructions.



## SAFETY INSTRUCTIONS

### BEFORE OPERATING:

1. Operate this machine only after reading and understand the contents of this manual. A replacement manual is available by sending complete model and serial number to:

**Hahn Equipment Co.,**  
A subsidiary of The Toro Company  
1625 N. Garvin  
Evansville, IN 47711

2. Drive Vehicle slowly.

3. Ensure the Hair Pin is used with Hitch Pin.

### WHILE OPERATING:

1. Make certain everyone is clear of the machine before starting the engine to move the vehicle.

2. Drive the vehicle safely:

A. Always SLOW the vehicle when approaching and while making a turn.

B. Always SLOW the Vehicle when driving in unfamiliar areas or over rough terrain.

C. Always SLOW the Vehicle when changing direction of travel or preparing to stop.

D. When turning or driving on slopes, always SLOW the Vehicle, then turn the Vehicle to prevent loss of control and possible upset.

E. DO NOT make sudden or sharp turns. DO NOT suddenly change direction of travel on an incline, ramp, grade, slope or similar surface.

F. Always adjust the vehicle speed to allow for existing conditions such as wet or slick surfaces, low visibility, etc.

G. Be especially careful when driving a heavily loaded vehicle UP and DOWN the face of the slopes, inclines or grades whenever possible. DO NOT DRIVE across the face if at all possible. There is a risk of upsetting the vehicle.

3. Before backing up, look to the rear and assure no one is behind. Back up slowly.

4. Watch out for traffic when near or crossing roads. Always yield the right of way to pedestrians and other vehicles.

5. Keep all nuts, bolts and other fasteners tightened securely. Replace any shields removed during servicing or adjustments.

6. To assure optimum performance and continued safety of this product, always use genuine TORO replacement parts and accessories. Replacement parts and accessories made by other manufacturers may affect the product's operation, performance or durability. Such use could also void the warranty of The Toro Company.

7. This trailer is to be used exclusively for transporting the 41358 Enclosed Walking Broom.



## SAFETY DECAL & SERIAL PLATE

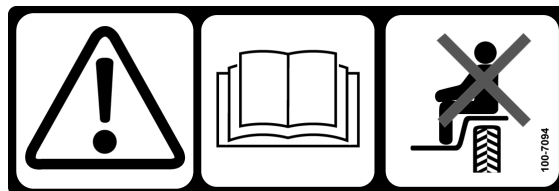

Part No. 100-7094  
Located on Hitch.

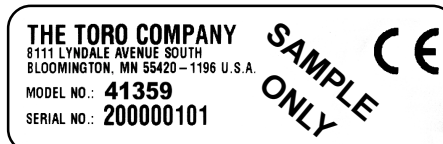

Serial Plate - Located on Main Frame

## SET-UP INSTRUCTIONS

Refer to illustrated Parts List for details of parts used in assembling the ENCLOSED WALKING BOOM TRAILER.

NOTE: "Right", Left", "Front" and "Rear" are referenced while standing in the operator's position.

### MAIN FRAME ASSEMBLY:

1. Assemble the (2) Wheel Mounts onto the Main Frame using (2) 1/2" x 2" hex hd cap screws and locknuts. The head of the cap screw should be on the side of the tube with the larger hole and when tightened should recess into the hole until it contacts the main frame tube.
2. Assemble Spring Latch onto the Main Frame using (2) 1/4" x 2" hex hd cap screws and locknuts.

### TOW HITCH ASSEMBLY

**NOTE:** There are two alternative mounting positions for the Tow Hitch. The position chosen will depend on the height of the hitch tongue on the tow vehicle. If the Trailer is being towed behind the ENCLOSED BOOM, the higher holes should be used. If being towed behind the MULTI-PRO 1100, MULTI-PRO 5500 or WORKMAN, equipped with the Universal Hitch included with the ENCLOSED WALKING BOOM TRAILER, the lower holes should be used. If the Enclosed Walking Boom Trailer is to be towed behind some other type of vehicle. The hitch height can be determined as follows:

If the tow hitch is less than 14" off the ground the lower holes should be used; If the tow hitch tongue is higher than 14" off the ground the higher holes should be used.

1. Assemble the hitch into the Main Frame using the (2) 3/8" x 2" hex hd cap screws and locknuts.

### WHEEL ASSEMBLY:

1. Assemble the (2) Wheels onto Wheel Mounts using a Wheel Bearing Tube, (2) washers, 1/2" x 9" hex hd cap screw and locknut on each side.

### UNIVERSAL TOW HITCH MOUNTING

1. On the MULTI-PRO 1100, MULTI-PRO 5500 and WORKMAN Spray Systems, without the Enclosed Boom, the Universal Tow Hitch can be mounted to the Main Frame Tube-Welded Assy. (Refer to applicable Parts Manual) using the (2) 3/8" x 1 1/2" Square x 3" U-bolts and (4) 3/8" locknuts.

Refer to the OPERATING INSTRUCTIONS for proper operating procedures.

## OPERATING INSTRUCTIONS

### ATTACHING THE ENCLOSED WALKING BOOM TRAILER TO THE TOW VEHICLE:

1. Align the Trailer Tow Hitch with the tow vehicle tow hitch tongue so that the tongue is between the two Tow Hitch pull tabs.
2. Insert the Hitch Pin through the Trailer Tow Hitch tabs and the vehicle tow hitch tongue.
3. Insert the Hair Pin through the Hitch Pin.



#### CAUTION

**Failure to insert the Hair Pin in the Hitch Pin could allow the Trailer to become detached from the tow vehicle and cause personal injury or death**

### LOADING THE ENCLOSED WALKING BOOM ON THE ENCLOSED WALKING BOOM TRAILER:

1. Ensure that the Boom Extensions on the Enclosed Waling Boom are locked in the Transport Position.
2. Approach the center of the back of the Trailer and insert the front wheel of the Walking Boom into the holder on the Trailer.
3. Push the handle on the Walking boom forward and up so that the detent pins on the Walking Boom Handle Cross Bar align, and insert in, the holes in the horizontal bar on the Trailer, and the latch on the Trailer catches on the Walking Boom fully.



#### CAUTION

**If the Latch does not fully engage, the Walking Boom could release from the Trailer and cause personal injury or death.**

## MAINTENANCE

The Trailer Wheel Bearings should be greased daily with a No. 2 General Purpose Lithium Base Grease

# WALKING BOOM TRAILER

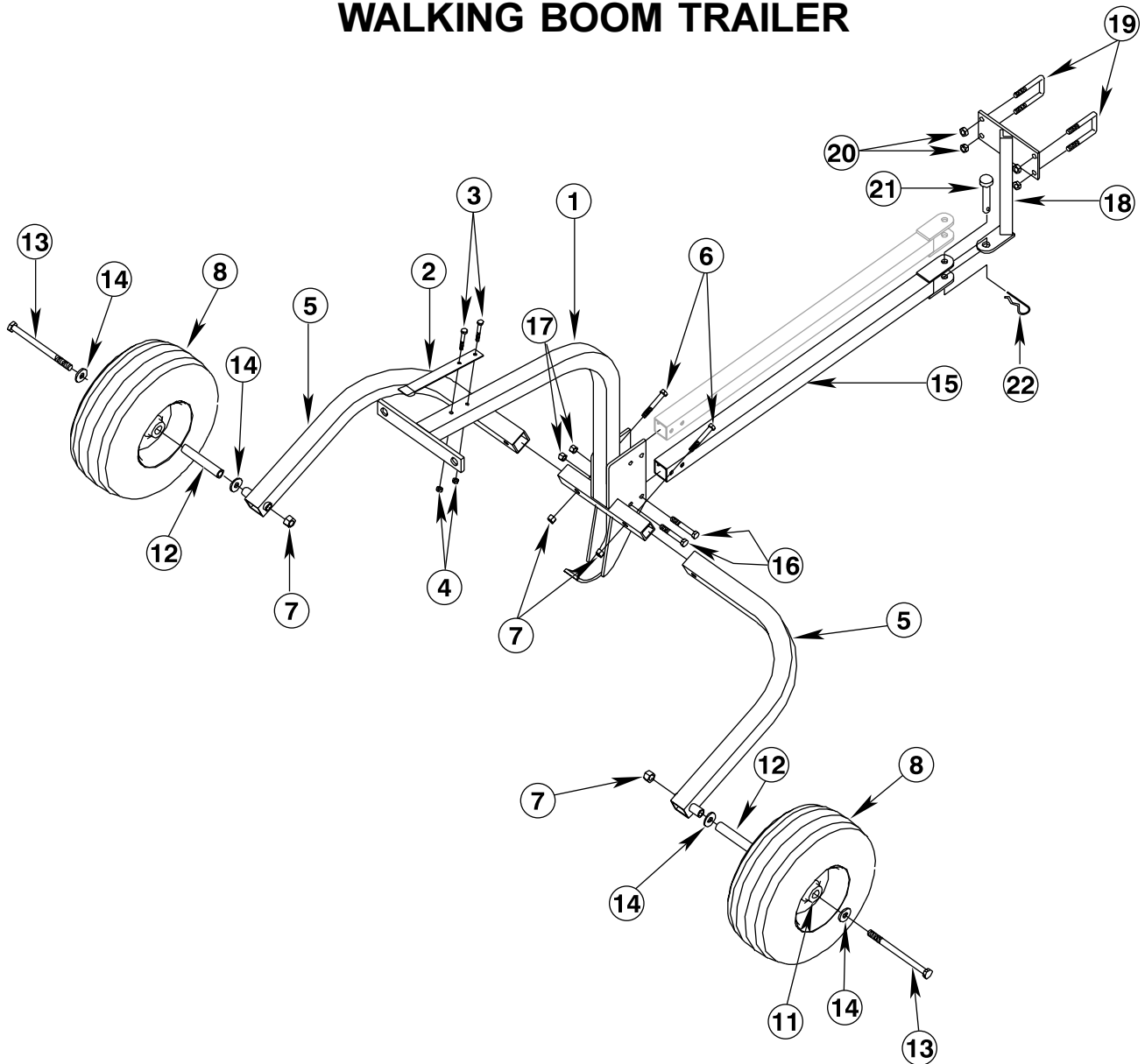

Ref	Part No.	Description	Qty
1	95-2047	Main Frame - WB Trailer	1
2	95-2048	Spring Latch	1
3	321-11	Hex hd cap screw, 1/4" UNC x 2"	2
4	32146-17	Locknut, 1/4" UNC	2
5	95-2049	Wheel Mount	2
6	325-8	Hex hd cap screw, 1/2" UNC x 2"	2
7	32146-13	Locknut, 1/2" UNC	4
8	95-2050	Wheel Assembly, Including:	2
		Wheel Rim - 6" x 4" - 6" Centered	
		Hub - 1 of	
		Tire - 13 x 5.00 - 6.00 Turf Rib - 1 of	
		Wheel Bushing - 3/4" Flanged - 2 of	
	94-8694	Wheel Rim - 6" x 4" - 6" Centered	2
		Hub c/w Bushing	

Ref	Part No.	Description	Qty
	95-2052	Tire - 13 x 5.00 - 6.00 Turf Rib	2
11	94-8696	Wheel Bushing - 3/4" flanged	4
12	94-8697	Wheel Bearing Tube - 3/4" OD x 6"	2
13	95-2053	Hex hd cap screw, 1/2" UNC x 9"	2
14	3256-6	Flat Washer, 1/2"	4
15	95-2054	Tow Hitch	1
16	322-11	Hex hd cap screw, 3/8" UNC x 2 1/2"	2
17	32146-2	Locknut, 3/8" UNC	2
18	95-2055	Tow Hitch - Universal	1
19	95-2056	U-bolt - 3/8" UNC x 1 1/2" sq x 3"	2
20	3296-59	Locknut, 3/8" UNC	4
21	95-2079	Hitch Pin - 1/2" x 2"	1
22	328967	Hair Pin - 1/8" x 2"	1

**NOTES:**



## **The Toro Promise A One Year Limited Warranty**

*The Toro Company promises to repair your Model 41359 ENCLOSED WALKING BOOM TRAILER if defective in materials or workmanship. The following time periods from the date of purchase apply special warranty terms, on certain components, may be offered through The Toro Company by the component manufacturers:*

### **Commercial Products.....1 Year**

*The cost of parts, labor and transportation are included.*

If you feel your TORO Product is defective and wish to rely on The Toro Promise, the following procedure is recommended:

1. Contact your Authorized TORO Distributor or Commercial Dealer (the Yellow Pages of your telephone directory is a good reference source).
2. The TORO Distributor or Commercial Dealer will advise you on the arrangements that can be made to inspect and repair your product.
3. The TORO Distributor or Commercial Dealer will inspect the product and advise you whether the product is defective and, if so, make all repairs necessary to correct the defect without an extra charge to you.

If for any reason you are dissatisfied with the distributor's analysis of the defect or the service performed, you may contact us.

Write:

TORO Commercial Products Service Department  
8111 Lyndale Avenue South  
Bloomington, MN 55420-1196

The above remedy of product defects through repair by an Authorized TORO Distributor or Commercial Dealer is the purchaser's sole remedy for any defect.

THERE IS NO OTHER EXPRESS WARRANTY. ALL IMPLIED WARRANTIES OF MERCHANTABILITY AND FITNESS FOR USE ARE LIMITED TO THE DURATION OF THE EXPRESS WARRANTY.

Some states do not allow limitations on how long an implied warranty lasts, so the above limitation may not apply to you.

This Warranty applies only to parts or components which are defective and does not cover repairs necessary due to normal wear, misuse, accidents, or lack of proper maintenance. Regular, routine maintenance of the unit to keep it in proper operating condition is the responsibility of the owner.

All warranty repairs reimbursable under The Toro Promise must be performed by an Authorized Toro Commercial Dealer or Distributor using Toro approved replacement parts.

Repairs or attempted repairs by anyone other than an Authorized TORO Distributor or Commercial Dealer are not reimbursable under The TORO Promise. In addition, these unauthorized repair attempts may result in additional malfunctions, the correction of which is not covered by warranty.

THE TORO COMPANY IS NOT LIABLE FOR INDIRECT, INCIDENTAL OR CONSEQUENTIAL DAMAGES IN CONNECTION WITH THE USE OF THE PRODUCT INCLUDING ANY COST OR EXPENSE OF PROVIDING SUBSTITUTE EQUIPMENT OR SERVICE DURING PERIODS OF MALFUNCTION OR NON-USE.

Some states do not allow the exclusion of incidental or consequential damages, so the above exclusion may not apply to you.

This warranty gives you specific legal rights, and you may also have other rights which vary from state to state.

### **COUNTRIES OTHER THAN THE UNITED STATES OR CANADA**

Customers who have purchased TORO products exported from the United States or Canada should contact their TORO Distributor (Dealer) to obtain guarantee policies for your country, province, or state. If for any reason you are dissatisfied with your Distributor's service or have difficulty obtaining guarantee information, contact the TORO importer. If all other remedies fail, you may contact us at The Toro Company.