



Glass Windshield and Wiper Kit

Workman® UTX or UTX-D 2 Passenger Utility Vehicle with Canopy

Model No. 08112

Installation Instructions

Important: If you are installing this kit and the Overhead Console Kit (Model 08130) at the same time, install the Glass Windshield and Wiper Kit first, then the Overhead Console Kit.

Installation

Loose Parts

Use the chart below to verify that all parts have been shipped.

Procedure	Description	Qty.	Use
1	No parts required	—	Prepare the machine.
2	Latch-mount bracket Torx-head screw (M6 x 25 mm) Washer (6 mm) Latch	1 4 2 1	Install the latch-mount bracket and latch.
3	Windshield Nut plate (8 mm) Button-head bolt (M8 x 20 mm)	1 2 4	Install the windshield.
4	Gas spring Strut mount Button-head bolt (M6 x 10 mm)	2 4 4	Install the gas spring.
5	No parts required	—	Tighten the latch.
6	Wiper motor Wiper arm Wiper blade Bulkhead fitting Wiper hose Washer bottle Hex-washer head bolt (1/4 x 5/8 inch)	1 1 1 1 1 1 2	Install the wiper motor, arm, and blade.
7	Switch	1	Install the switch.



1

Preparing the Machine

No Parts Required

Procedure

1. Park the machine on a level surface.
2. Shift the transmission lever to the P (Park) position.
3. Shut off the engine and remove the key.

2

Installing the Latch-Mount Bracket and Latch

Parts needed for this procedure:

1	Latch-mount bracket
4	Torx-head screw (M6 x 25 mm)
2	Washer (6 mm)
1	Latch

Procedure

1. Remove the 2 plastic rivets from the dash (Figure 1).

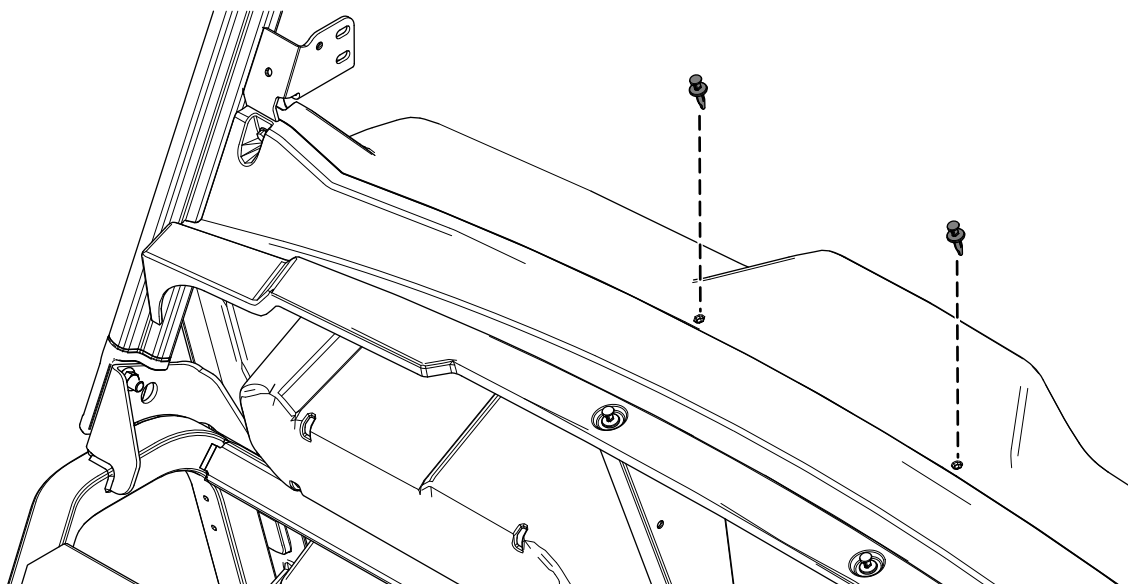
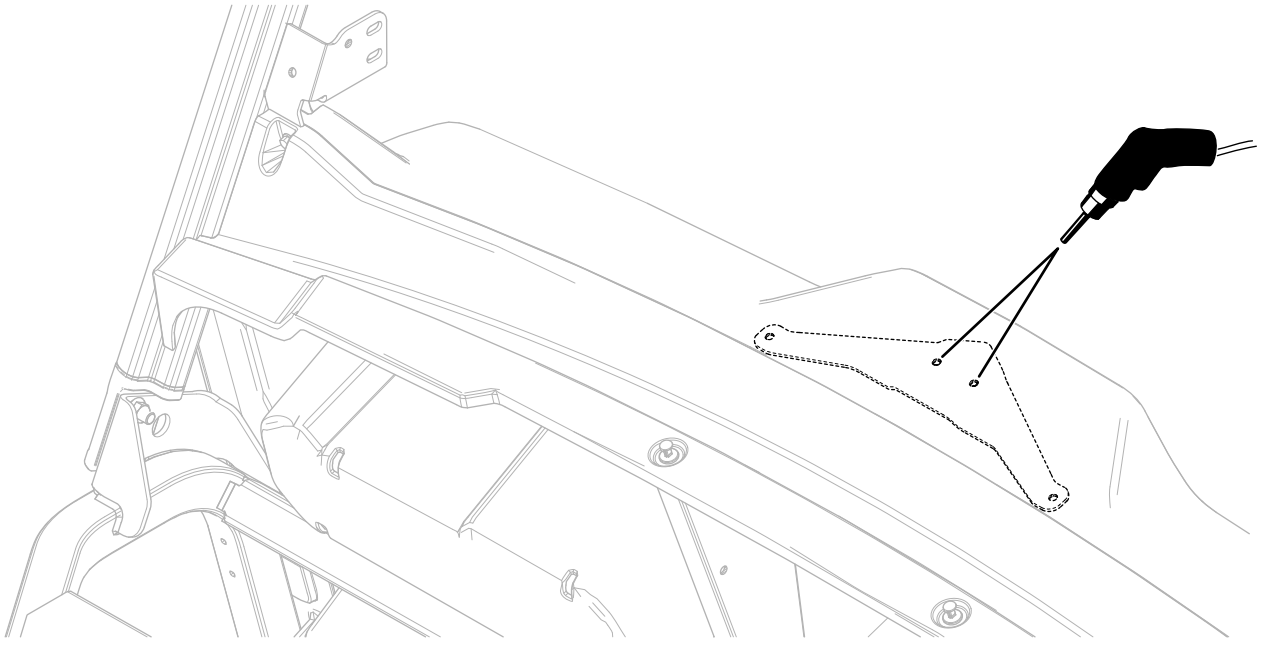

Figure 1

g389333

2. Using the latch-mount bracket as the template, mark and then drill 2 holes (5/16 inch) into the dash (Figure 2).



g382255

Figure 2

3. Secure the latch-mount bracket to the dash using 2 torx-head screws (M6 x 25 mm) and 2 washers (6 mm) as shown in Figure 3.
4. Torque the 2 torx-head screws (M6 x 25 mm) to 3.6 to 4.5 N·m (32 to 40 in-lb).

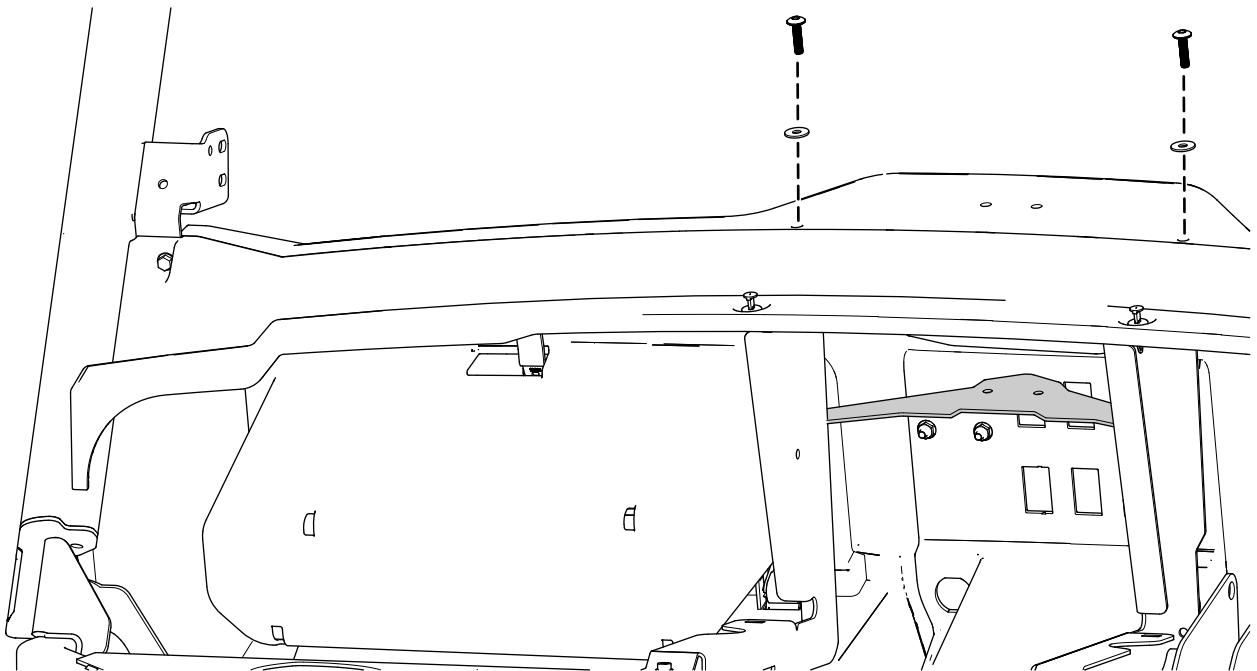

g388863

Figure 3

5. Loosely secure the latch to the dash using 2 torx-head screws (M6 x 25 mm) as shown in [Figure 4](#). Do not torque the bolts until later.

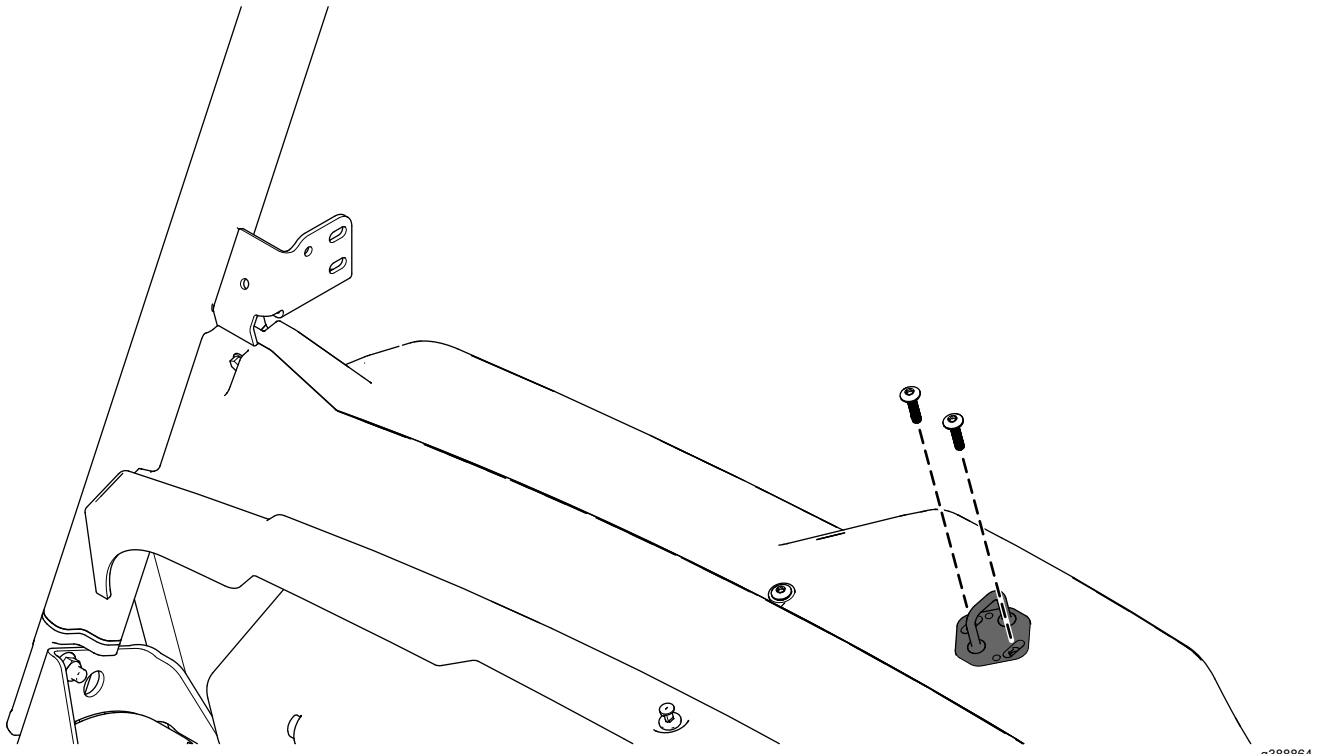

Figure 4

3

Installing the Windshield

Parts needed for this procedure:

1	Windshield
2	Nut plate (8 mm)
4	Button-head bolt (M8 x 20 mm)

Procedure

Important: You need 2 people for installing the windshield.

1. Align the windshield with the opening on the machine.
2. Loosely secure the windshield using 2 nut plates (8 mm) and 4 button-head bolts (M8 x 20 mm) as shown in [Figure 5](#).

Ensure that the windshield is even on each side of the ROPS when installing the fasteners.

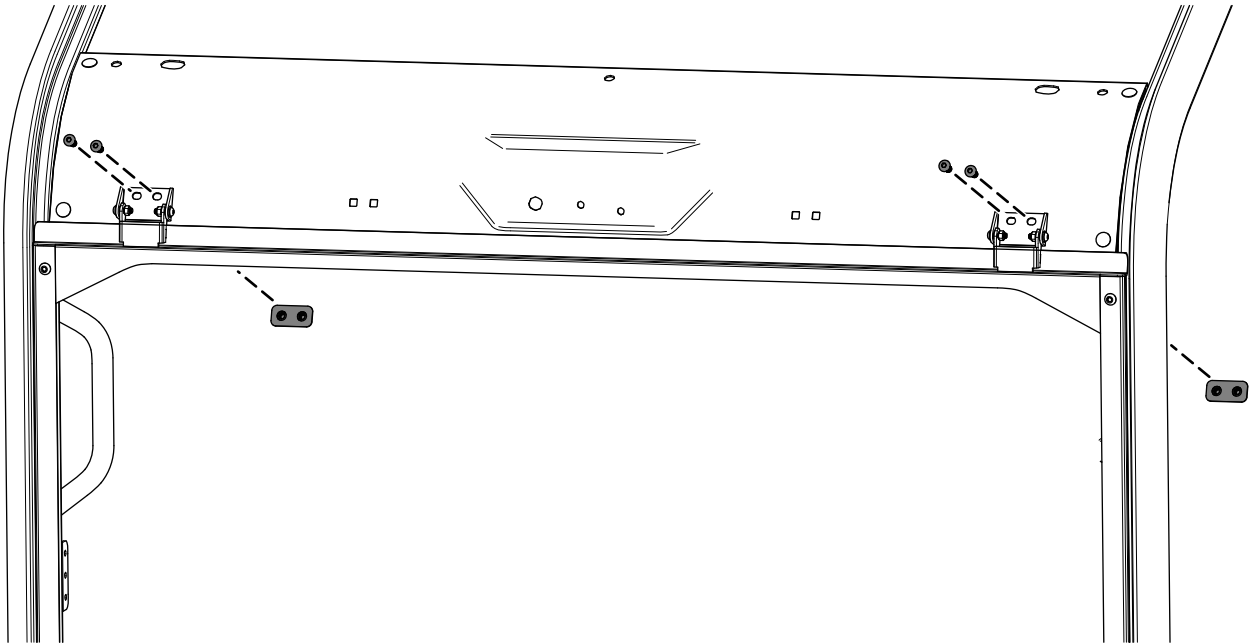

g382258

Figure 5

3. When the windshield is even with the ROPS, torque the 4 button-head bolts (M8 x 20 mm) to 26 N·m (230 in-lb).

4

Installing the Gas Springs

Parts needed for this procedure:

2	Gas spring
4	Strut mount
4	Button-head bolt (M6 x 10 mm)

Procedure

1. Secure a strut mount to the right windshield frame using a button-head bolt (M6 x 10 mm) as shown in [Figure 6](#).
- Note:** It is recommended to use the lower hole on the windshield frame.
2. Secure a strut mount to the right door-latch bracket using a button-head bolt (M6 x 10 mm) as shown in [Figure 6](#).
3. Repeat steps 1 and 2 on the other side.
4. Torque the 4 button-head bolts (M6 x 10 mm) to 11 N·m (96 in-lb).

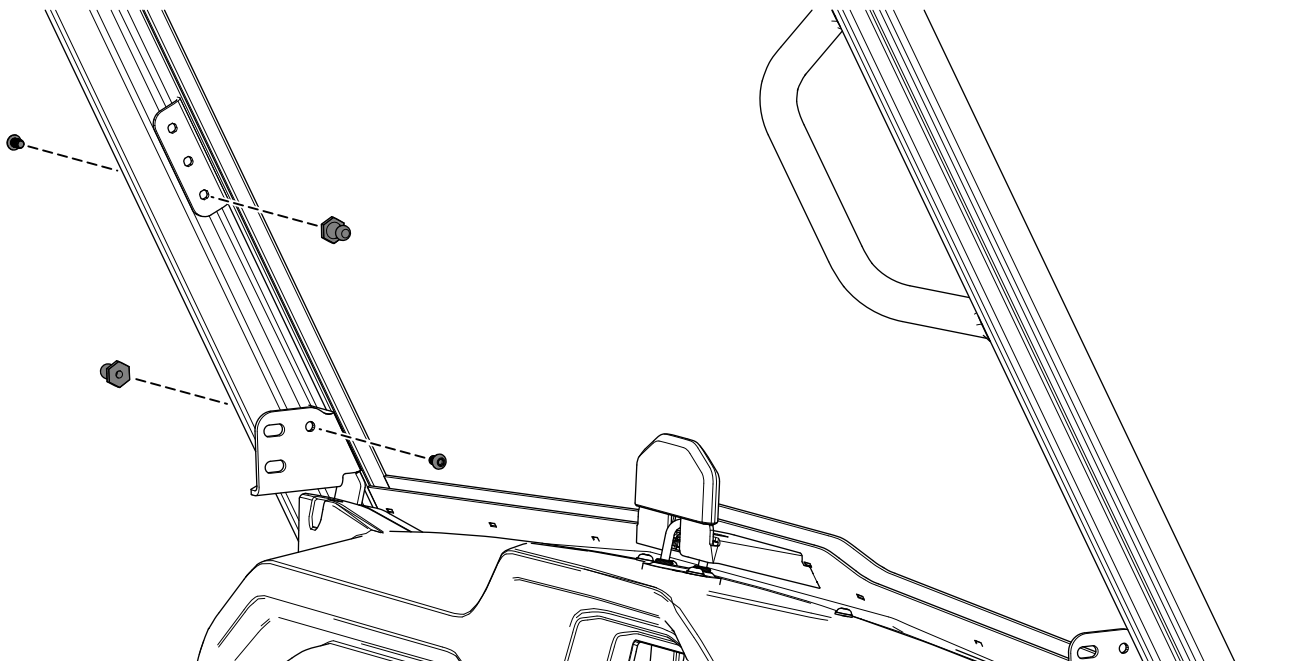

g512727

Figure 6

- Secure the 2 gas springs to the strut mounts ([Figure 7](#)).
Ensure that you orient the gas spring as shown in [Figure 7](#).

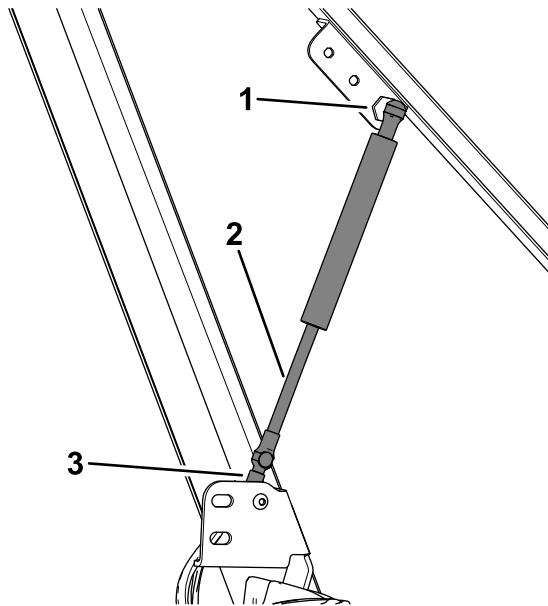

g515925

Figure 7

Extended view shown

1. Windshield frame

2. Piston rod

3. ROPS bracket

5

Tightening the Latch

No Parts Required

Procedure

- If needed, adjust the latch, and ensure that windshield latches correctly.
- Torque the 2 torx-head screws (M6 x 25 mm) to 11 N·m (96 in-lb).

6

Installing the Wiper Motor, Arm, and Blade

Parts needed for this procedure:

1	Wiper motor
1	Wiper arm
1	Wiper blade
1	Bulkhead fitting
1	Wiper hose
1	Washer bottle
2	Hex-washer head bolt (1/4 x 5/8 inch)

Procedure

1. Secure the wiper motor to the front ROPS crosslink using the fasteners provided with the motor ([Figure 8](#)).
Box A represents the fasteners needed to secure the wiper motor housing. Box B represents the fasteners needed to secure the wiper motor and wiper arm.
The crosslink is shown as a solid, black line in box A and B of [Figure 8](#).

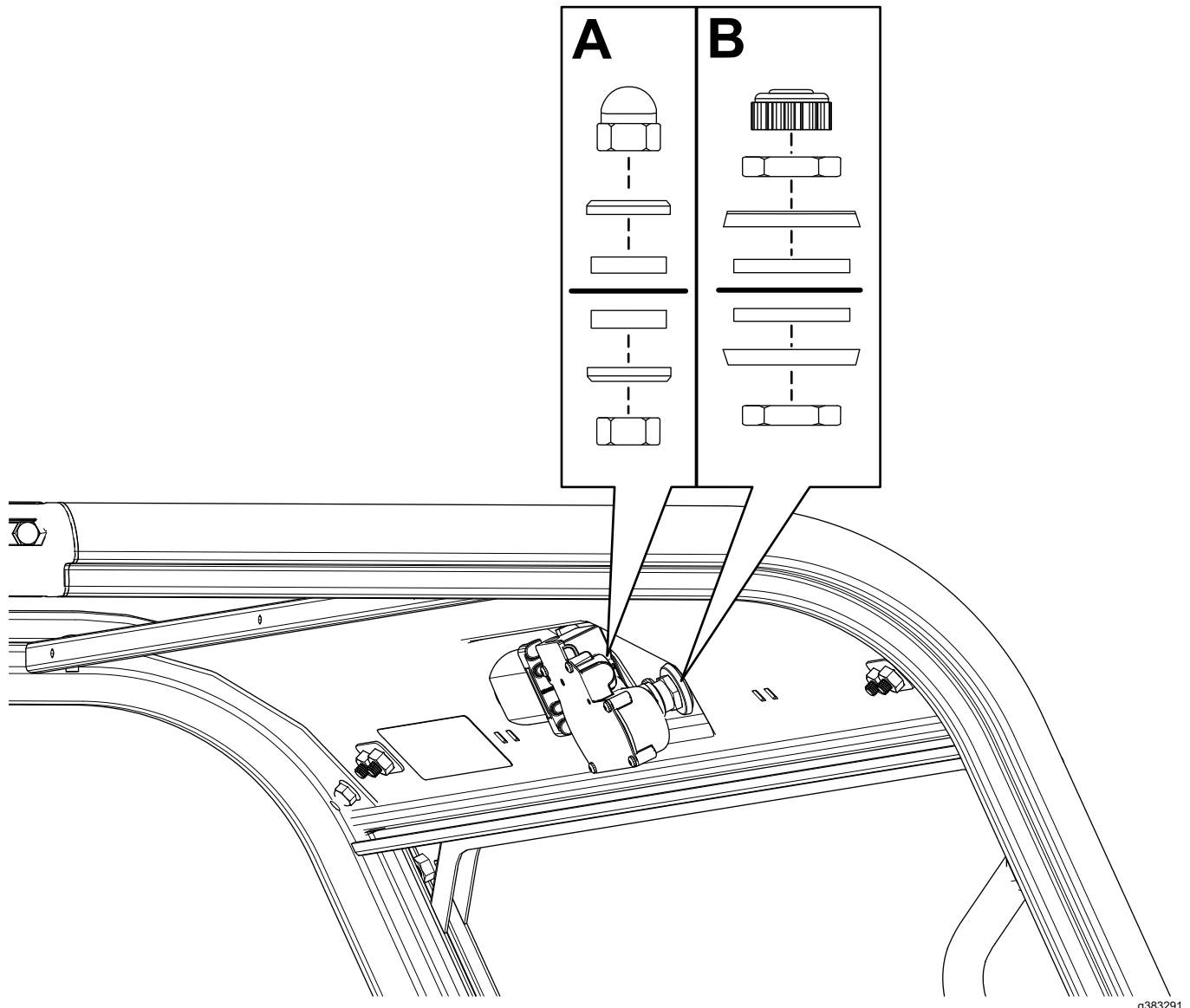
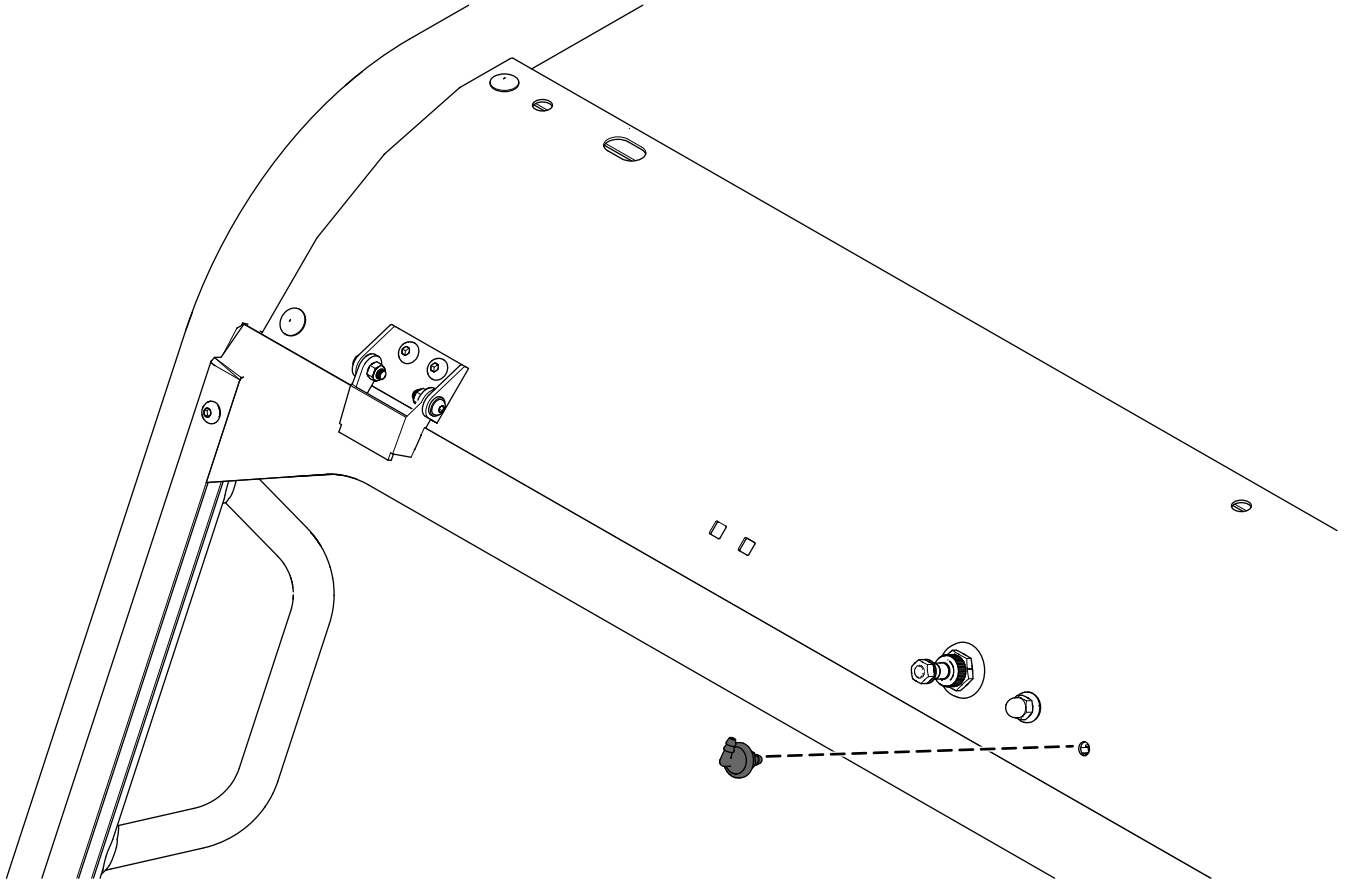

Figure 8

g383291

2. Secure the bulkhead fitting to the front ROPS crosslink using the washer and nut included with the fitting ([Figure 9](#)).

Hand-tighten the nut.



g388861

Figure 9

3. While holding the end of the wiper arm with a rag, secure the wiper arm to the motor using the nut and lock washer from the motor assembly ([Figure 10](#)).

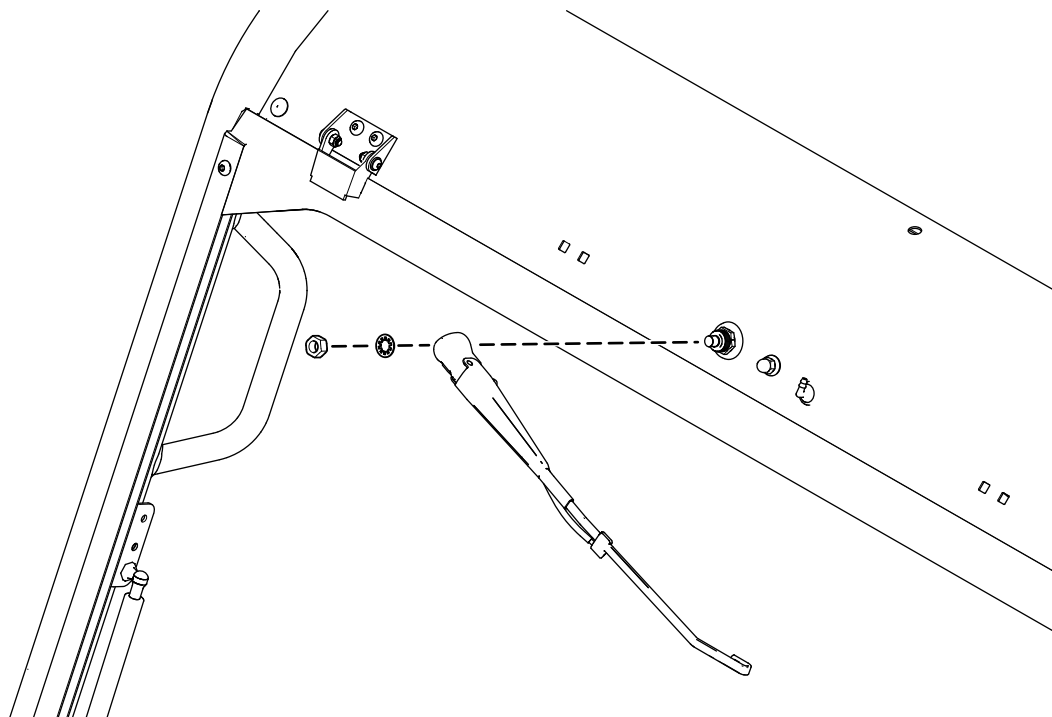

Figure 10

g512725

4. Secure the wiper blade to the hook on the wiper arm ([Figure 11](#)).

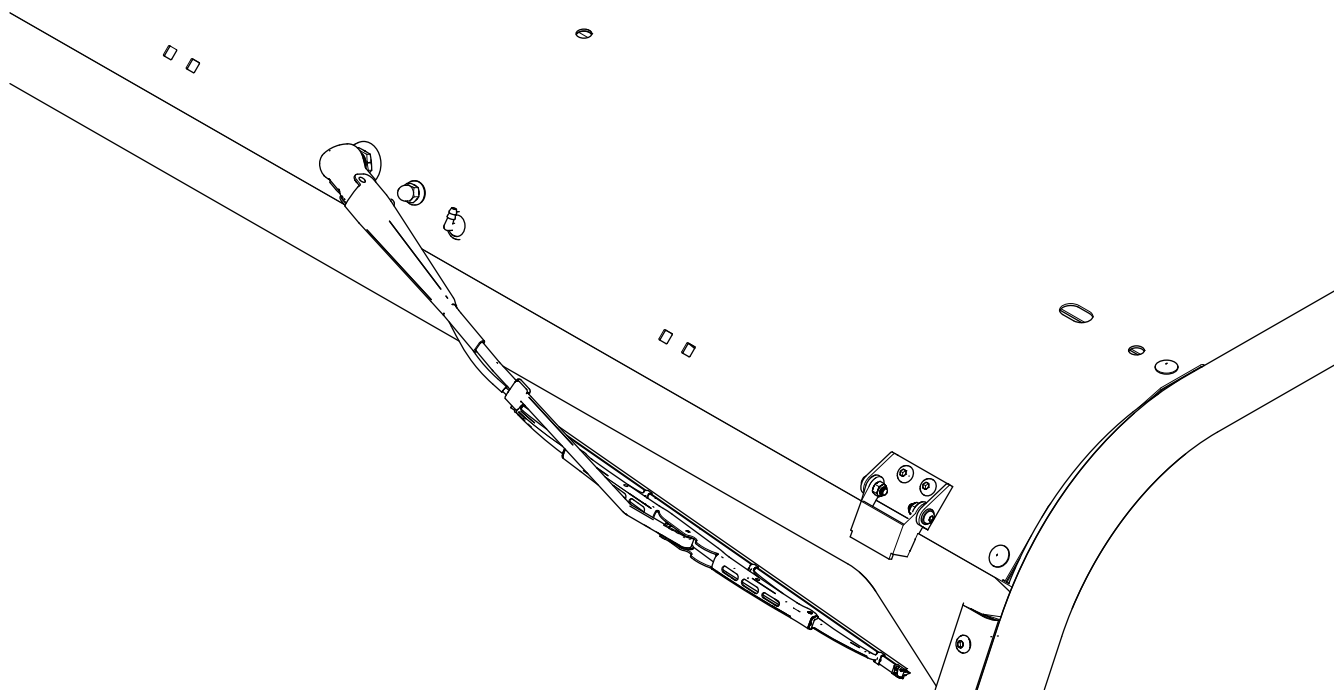
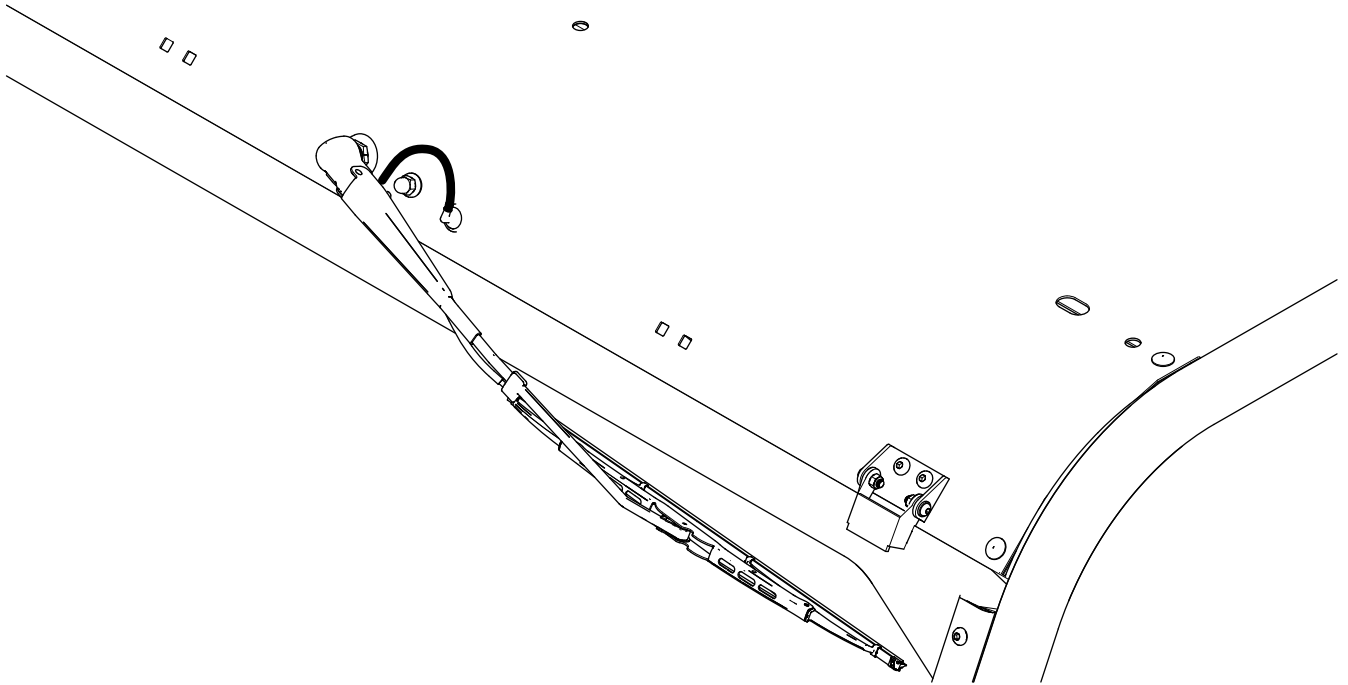

Figure 11

g388862

5. Attach the hose line on the wiper arm to the bulkhead fitting ([Figure 12](#)).



g389334

Figure 12

6. Install the wire raceway channel and route the wiper hose through the raceway channel; refer to procedure **Installing the Wire Raceway Channel** in the Overhead Console Kit (Model 08130) *Installation Instructions*.
7. Attach the wiper hose to the bulkhead fitting ([Figure 13](#)).

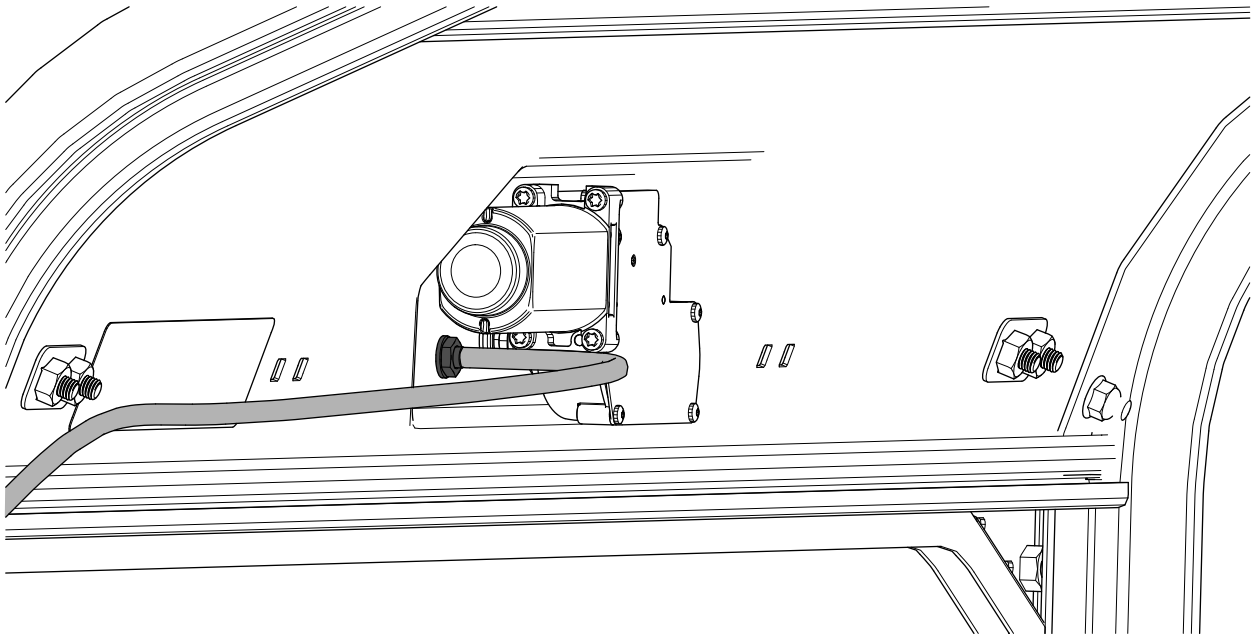

g382290

Figure 13

8. Secure the washer bottle to the front frame column mount using the 2 hex-washer head bolts (1/4 x 5/8 inch) as shown in [Figure 14](#).
9. Attach the wiper hose to the washer bottle ([Figure 14](#)).

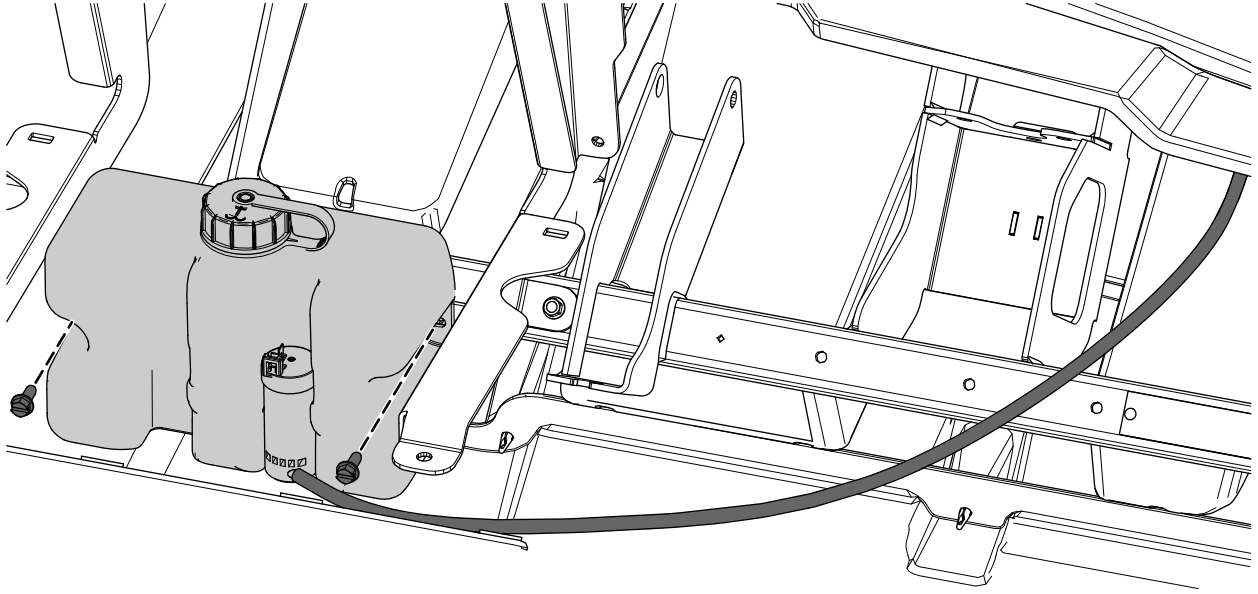

g382293

Figure 14

10. Connect the machine wire-harness connector labeled WASHER PUMP to the washer bottle. You will find the harness connector underneath the front frame shock tower ([Figure 15](#)).

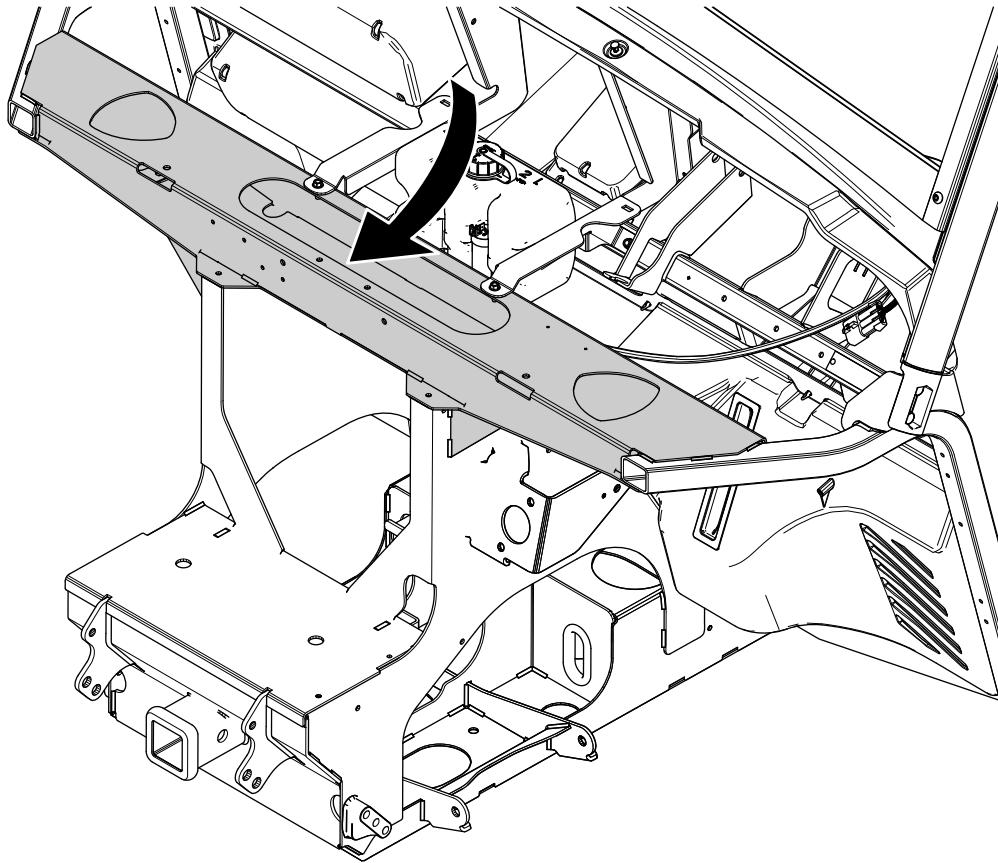

Figure 15

g383292

-
11. Fill the washer bottle with the appropriate climate-compatible windshield washer fluid.

7

Installing the Switch

Parts needed for this procedure:

1	Switch
---	--------

Procedure

1. Install the switch into the opening of the console switch bracket ([Figure 16](#)) from the Overhead Console Kit (Model 08130).

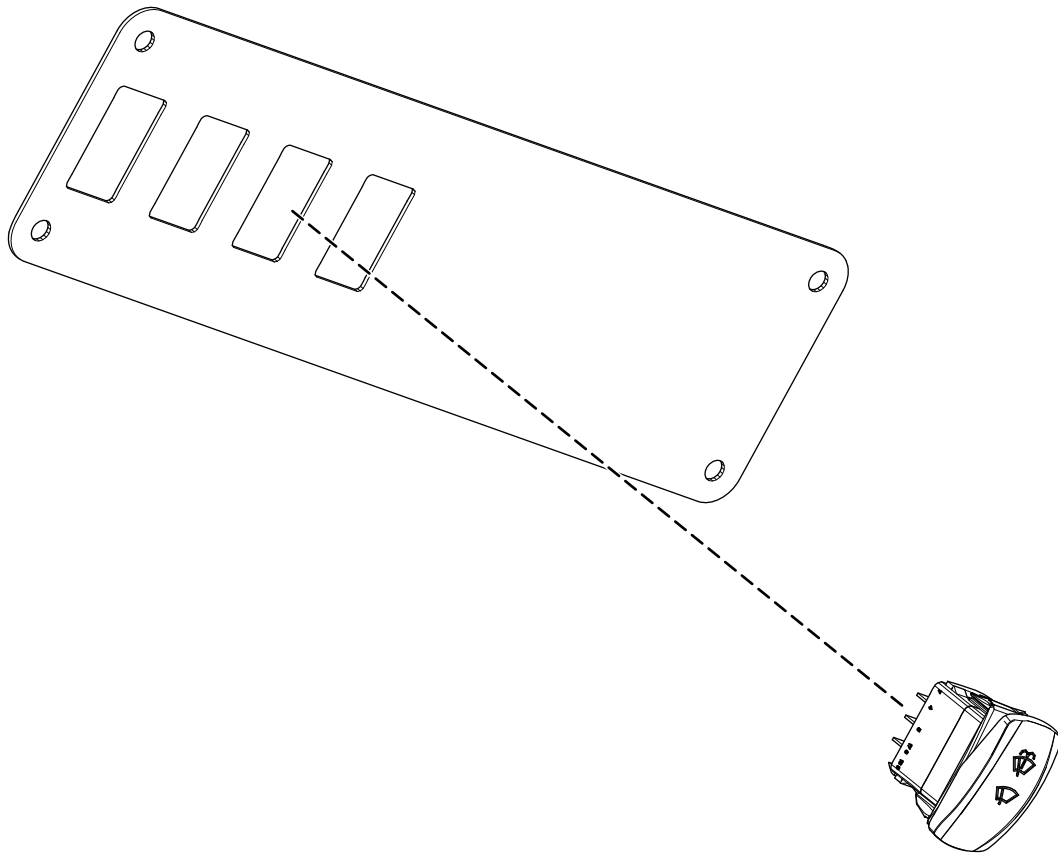

Figure 16

g382341

2. Secure the console switch bracket and the remaining 3 plugs; refer to the Overhead Console Kit (Model 08130) *Installation Instructions*.
3. Connect the switch to the Overhead Console Kit wire-harness connector labeled WINDSHIELD WIPER SWITCH; refer to procedure **Routing the Wire Harness and Installing the Dome Light** in the Overhead Console Kit (Model 08130) *Installation Instructions*.

Operation

Operating the Wiper Switch

Down position—Wiper off

Middle position—Continuously run the wiper

Up position—Momentarily spray washer fluid on-demand