



Model No. 41183-90001 & UP

**SET-UP &
PARTS MANUAL****OPERATOR ENCLOSURE**
for the MULTI-PRO™ 1100 Vehicle

NOTE: AN ASSISTANT MAY BE NEEDED IN THE ASSEMBLY OF THE OPERATOR ENCLOSURE.

INSERT ANCHORS HAVE BEEN PROVIDED IN THE ROPS BAR TO ALLOW INSTALLATION OF THE OPERATOR ENCLOSURE.

REFER TO THE ILLUSTRATED PARTS LIST FOR DETAILS OF PARTS USED IN ASSEMBLING THE OPERATOR ENCLOSURE.

NOTE: "RIGHT", "LEFT", "FRONT", AND "REAR" ARE REFERENCED WHILE SEATED IN THE OPERATORS POSITION.

SET-UP INSTRUCTIONS

1. Install the ROPS kit as per the instructions provided with that kit. Leave bolts loose until operator enclosure is completely installed.
2. Locate and remove the Blower Wiring Harness and the (2) 5/16" grommets from the parts bags.
3. Remove the wire loom and ring terminal end of the Wiring Harness by disconnecting the connector located approx. 6" inside the wire loom. This section will be reconnected later. See FIG. 1.

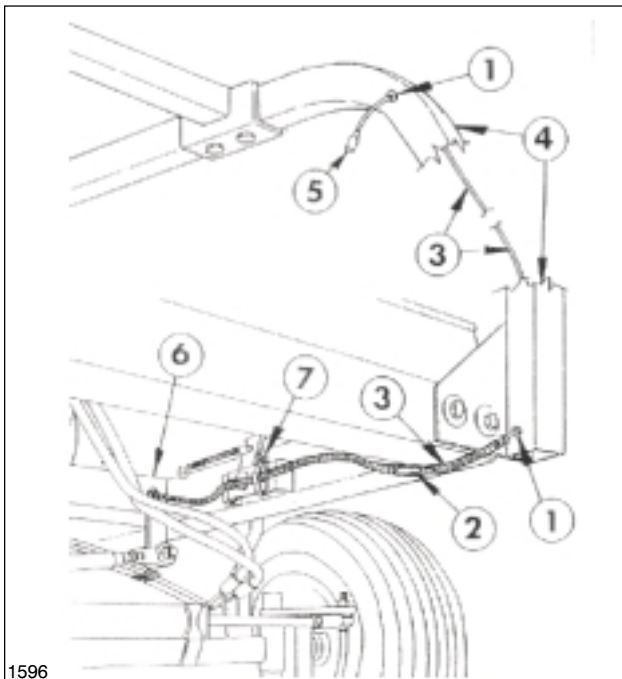

FIG. 1

- | | |
|--------------------------|----------------------------|
| 1. Grommet | 5. Female Bullet Connector |
| 2. Male Bullet Connector | 6. Frame Cross Tube |
| 3. Blower Wiring Harness | 7. Sta- Strap |
| 4. L.H. ROPS Bar | |

4. Slide a 5/16" grommet on the Blower Wire Harness by sliding it over the Male Bullet Connector, along the wire to the Female Bullet Connector at the other end.
5. Beginning with the end of the Wiring Harness having the male connector, thread the Wiring Harness down through the left hand ROPS Bar.
6. Push the Grommet into the top of the ROPS Bar. Slide a 5/16" grommet over the Male Bullet Connector coming out of hole at the bottom of the ROPS Bar. Push Grommet into place.
7. At the bottom of the ROPS Bar, reconnect the portion of the Wiring Harness removed in Step 3.
8. Route Wiring Harness back towards engine compartment and through hole in the Frame Cross Member. Secure Wiring Harness to Clutch Pivot Bracket with the Sta-Strap.
9. From the hole in the Frame Cross Member route the Wiring Harness through the hole in the Engine Cross Member and up to Starter Solenoid. Attach 5/16" Ring Terminal to (+) positive post on the Starter Solenoid. See FIG. 2.

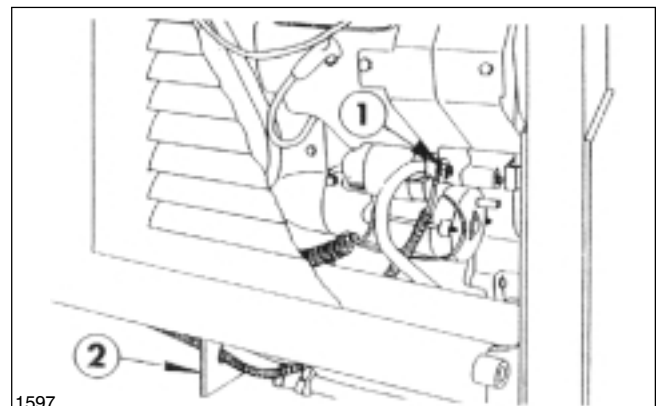

FIG. 2

- | | |
|--------------------------------|------------------------|
| 1. Starter Solenoid Connection | 2. Engine Cross Member |
|--------------------------------|------------------------|

NOTE: IF YOU HAVE COMPLETELY INSTALLED THE ROPS UNIT ON YOUR VEHICLE YOU WILL NEED TO REMOVE THE ROPS CROSS BAR AND SEAT BELT ASSEMBLY BEFORE INSTALLING THE ENCLOSURE.

10. Remove the Enclosure Cover and Blower from the shipping carton.

11. Remove the (3) 1/4" flange hd. bolts that secure the Blower Assembly to the front of the Enclosure Cover and remove Blower. Set Blower and flange bolts aside for future installation.

12. Remove the (4) 3/8" x 3/4" flange hd. bolts, lockwashers, and hex nuts that secure the two Door Channels to Enclosure Cover. Set Door Channels and flange bolts aside for future installation.

13. Set Enclosure Cover on top of the ROPS by hooking the rear of Enclosure Cover over the back of the Rear ROPS Bar and slide Cover forward to align front mounting holes. See FIG. 3.

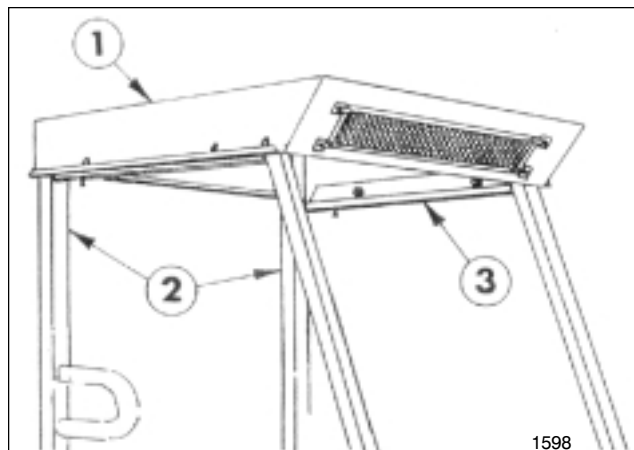

FIG. 3

- 1. Enclosure Cover
- 2. Rear ROPS Bar
- 3. Door Channel

14. Secure the Enclosure Cover to the ROPS by screwing (4) 3/8" x 3/4" flange hd. bolts through the Enclosure Cover into the ROPS Bar. Do not tighten fasteners.

15. Secure the two Door Channels to the inside of the Enclosure Cover using (4) 3/8" x 3/4" flange hd. bolts, lockwashers, and hex nuts removed in step 12. Tighten fasteners securely.

16. Loosely mount the ROPS Cross Bar (furnished with the ROPS Bars by screwing (4) 3/8" x 1" hex hd. cap screws, flatwashers, and lockwashers into the ROPS Bars. Slide the Cross Bar towards the rear to make clearance for the Blower installation. Do not tighten fasteners. See FIG. 4.

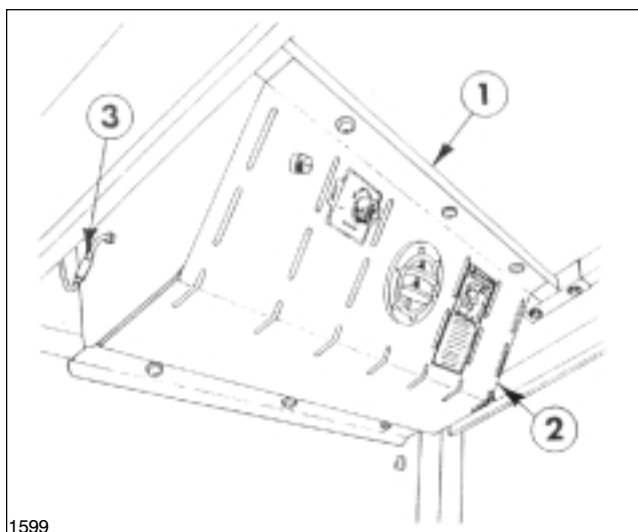

FIG. 4

- 1. ROPS Cross Bar
- 2. Blower Assembly
- 3. Bullet Connector

17. Loosely mount Blower Assembly inside the Enclosure by sliding rear of Blower Assembly over the front of the ROPS Cross Bar and sliding front of Blower outside filter side panels. Slide the Cross Bar forward and start (6) 1/4" flange hd. cap screws. Leave loose. Do not tighten until Front Window is installed.

18. Connect the Bullet Connector from side of Blower to Bullet Connector from top of left hand ROPS. Bar.

19. Loosely mount the Front Window to the front of the ROPS using (6) 1/4" x 3/4" flange hd. bolts through the Front Window Clamps and screwing into the ROPS bar. Place the Wiper Stop on the right center mounting bolts before screwing into ROPS bar. See FIG. 5.

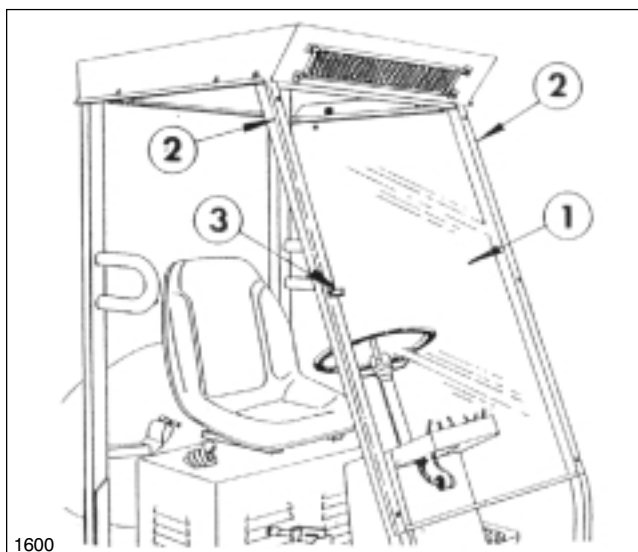

FIG. 5

- 1. Front Window
- 2. Front Window Clamps
- 3. Wiper Stop

20. Slide the Front Window up until the top Window Trim meets the lower flange of the Enclosure Cover. Tighten mounting bolts securely.

21. Slide the Blower Assembly forward until Blower Flange meets with top of Front Window. Slide ROPS Cross Bar as far forward as it will go and tighten the (6) 1/4" flange hd. cap screws.

22. Loosely mount the Rear Window and (2) Window Clamps to rear ROPS Bar by screwing (4) 1/4" x 3/4" flange hd. bolts into the ROPS bar. Slide Rear Window up to meet the lower rear flange of the Enclosure Cover. Tighten bolts securely. See FIG. 6.

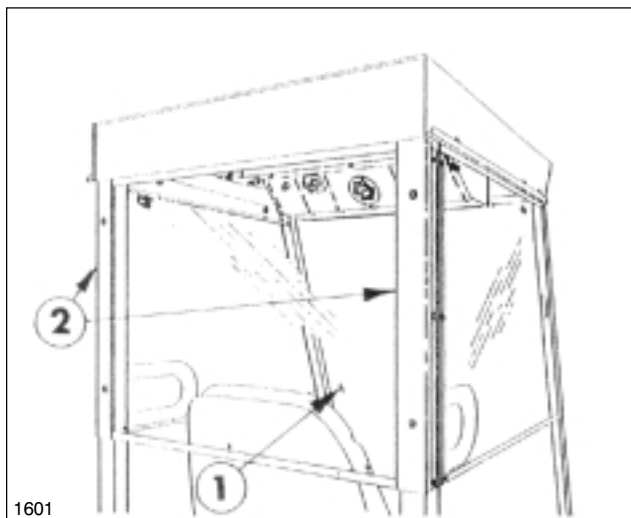

FIG. 6

1. Rear Window 2. Window Clamps

23. Loosely mount the Noise Shield to the bottom of the Rear Window using (3) 1/4" x 3/4" flange hd. bolts, flatwashers, lockwashers, and hex nuts. Secure the bottom of the Noise Shield to the Seat Box Angle using (3) 1/4" x 3/4" flange hd. bolts, flatwashers, lockwashers, and hex nuts. Tighten all fasteners securely. See FIG. 7.

24. Mount the Seat Belt Assembly (furnished with the ROPS Kit) to the rear ROPS Bar at a 45° angle using (2) 7/16" x 1-1/4" hex hd. cap screws, lockwashers, and hex nuts.

25. Loosen and remove the (2) 5/16" bolts, flatwashers, spacers that secure the Storage Tube to the rear of the Seat. Mount the Storage Tube to the front side of the Noise Shield using the 5/16" bolts, flatwashers, and spacers removed earlier. Secure with (2) 5/16" locknuts provided with the ROPS Kit.

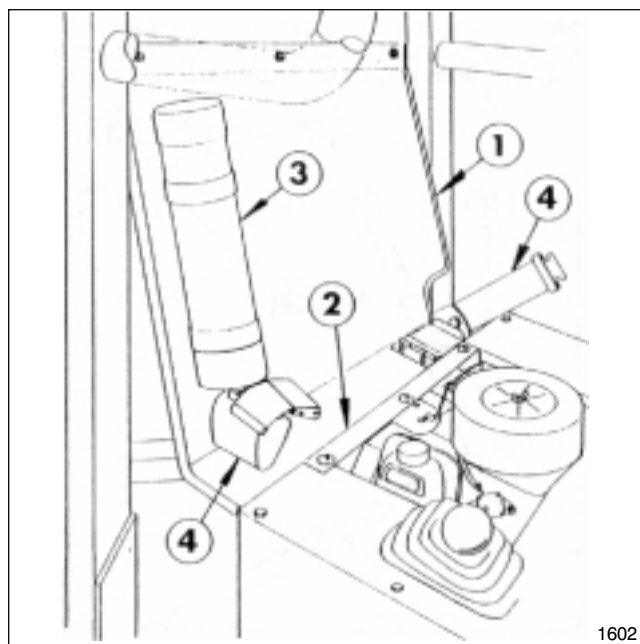

FIG. 7

1. Noise Shield 3. Storage Tube
2. Seat Box Angle 4. Seat Belt Ass'y

26. Loosely mount the R.H. and L.H. Doors to the ROPS Bar with (6) 1/4" x 3/4" flange hd. bolts and flatwashers through the Door Hinges into the ROPS bar. See FIG. 8.

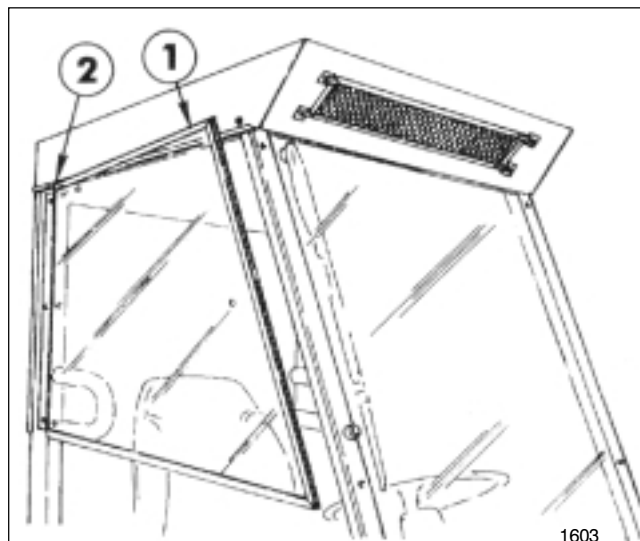

FIG. 8

1. Door 2. Door Hinge

27. By using the slots in the Hinges align the Doors so the top Door Trim is parallel with the Enclosure Cover. Tighten mounting bolts securely.

28. Install the Inner Door Latch Assembly through the 5/16" hole in Door with the flatwasher between latch and glass. See FIG. 9.

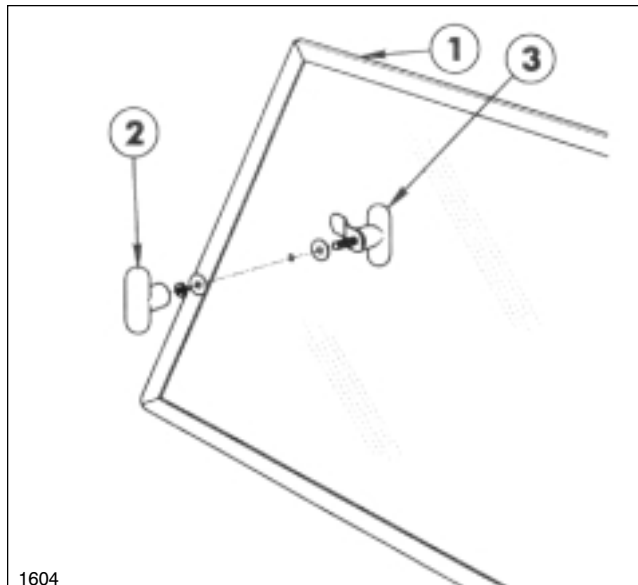

FIG. 9

- | | |
|---------------|------------------------------|
| 1. Door | 3. Inner Door Latch Assembly |
| 2. Outer Knob | |

29. Secure Inner Door Latch Assembly with 5/16" jam nut and flatwasher from outside of glass. Tighten jam nut until there is a light drag when door latch is rotated.

30. While holding the outer jam nut with a wrench, tighten Outer Knob securely.

31. Remove the (4) 1/4" x 3/4" flange hd. bolts securing the (2) Magnet Clamps and (2) Door Magnets to the ROPS. See FIG. 10.

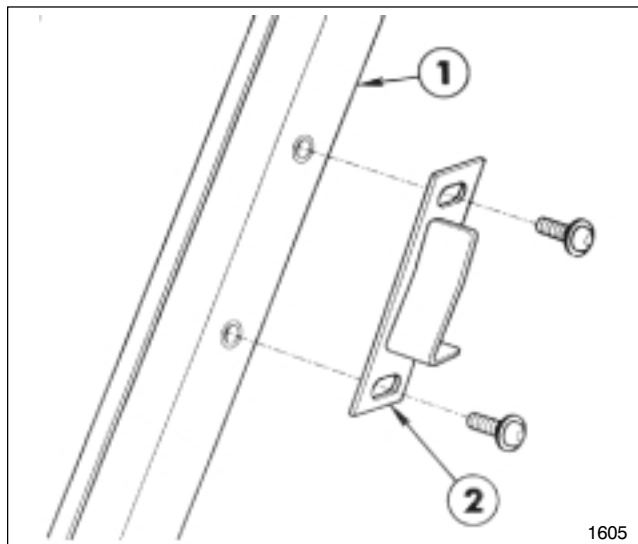

FIG. 10

- | | |
|------------------|--------------------|
| 1. L.H. ROPS Bar | 2. L.H. Door Catch |
|------------------|--------------------|

32. Loosely mount the (2) Door Catches to the ROPS with the (4) 1/4" x 3/4" flange hd. bolts removed in step 31.

33. With the Door closed against the Front ROPS Bar, tighten the mounting bolts securing the Door Catches to the Front ROPS Bar.

34. Flip the Operator Seat forward and install Seat Panel Noise Barrier by removing pressure sensitive paper from barrier and applying to bottom of seat panel centered between the (4) seat mounting bolts.

35. Remove the Wiper Arm and Blade from the shipping carton. Install the Wiper Blade to the Wiper Arm using the screw and locknut provided. Tighten the screw and locknut securely but do not tighten enough to compress the saddle. The Blade must be free to move within the saddle.

36. Slide one of the rubber gaskets onto the Wiper Arm Shift and insert through the hole in the Front Window, towards the inside of the Enclosure. Slide a rubber gasket and lockwasher provided onto the Wiper Arm Shift to Front Window with jam nut. See FIG. 11.

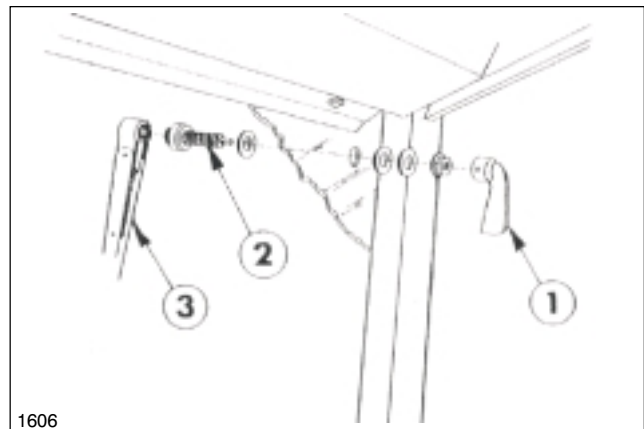

FIG. 11

- | | |
|--------------------|-----------------------|
| 1. Wiper Handle | 3. Wiper Arm Assembly |
| 2. Wiper Arm shaft | |

37. Slide the Wiper Handle onto the Wiper Arm Shaft from inside the Enclosure and secure by tightening the set screw in the side of the Wiper Handle.

38. Align the Wiper Arm Assembly with the Wiper Handle and slide the Wiper Arm Assembly onto the serrated Wiper Arm Shaft until the clip/tap locks underneath the edge.

39. Remove the protective paper from the front Window, Rear Window, and Doors by grasping paper at one corner and gently pulling away the protective paper.

IMPORTANT: DO NOT USE KNIVES, BLADES, OR SCRAPERS TO REMOVE THE PROTECTIVE PAPER AS THIS WILL SCRATCH OR CUT THE DOORS AND WINDOW!

40. Check the operation of the blower assembly and make certain all fasteners are tightened securely.

NOTE: WHEN USING AN OPEN TRAILER TO TRANSPORT A MULTI-PRO EQUIPPED WITH THIS OPERATOR ENCLOSURE, ALWAYS USE HOLD-DOWN CLAMPS PROVIDED, TO HOLD DOORS SHUT.

TO INSTALL HOLD-DOWN CLAMPS:

41. Loosen the (4) 1/4" x 3/4" flange hd. bolts securing the Front Window and Wiper Stop to the ROPS. See FIG. 12.

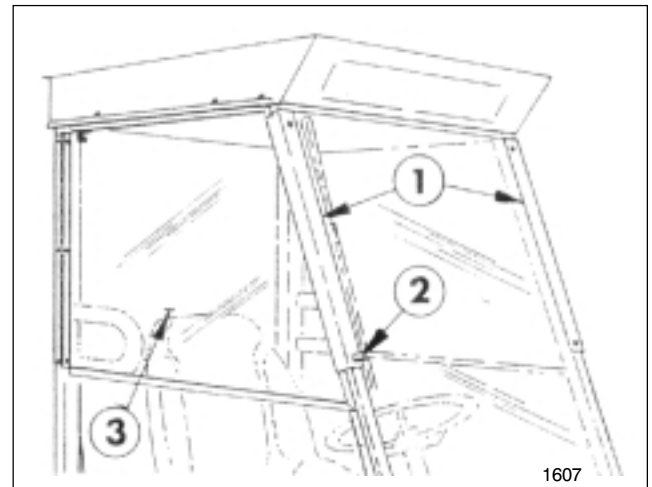

FIG.12

- | | |
|---------------------|---------|
| 1. Hold-Down Clamps | 3. Door |
| 2. Wiper Stop | |

42. Slide the Hold-Down Clamps under the flange hd. bolts and the Wiper Stop.

43. Push them toward the center of the Front Window until they engage the Front Doors. Tighten fasteners securely.

44. Refer to the Operator Enclosure Operators Manual for the proper operation, adjustment, and maintenance of the Operator Enclosure.

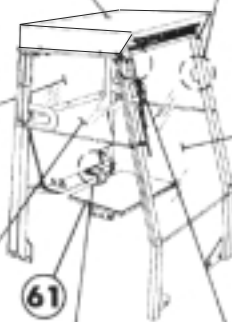
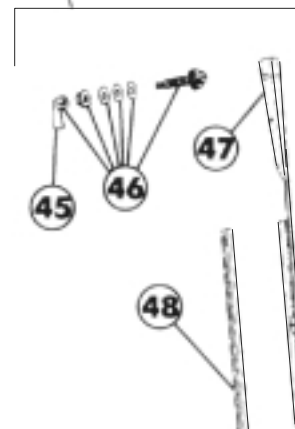
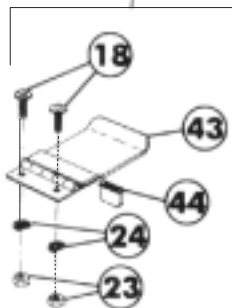
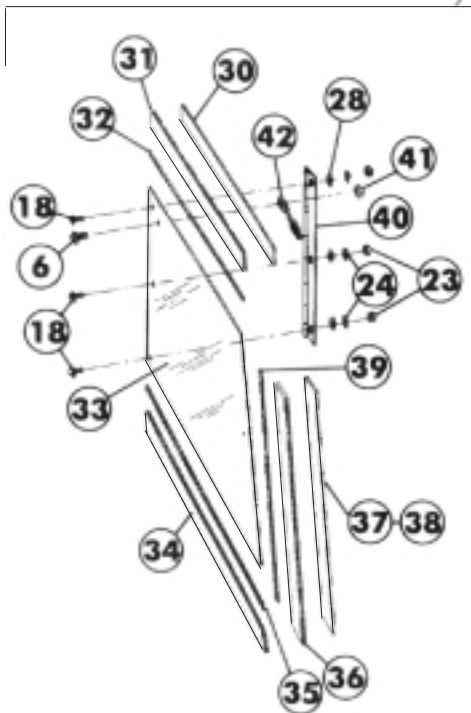
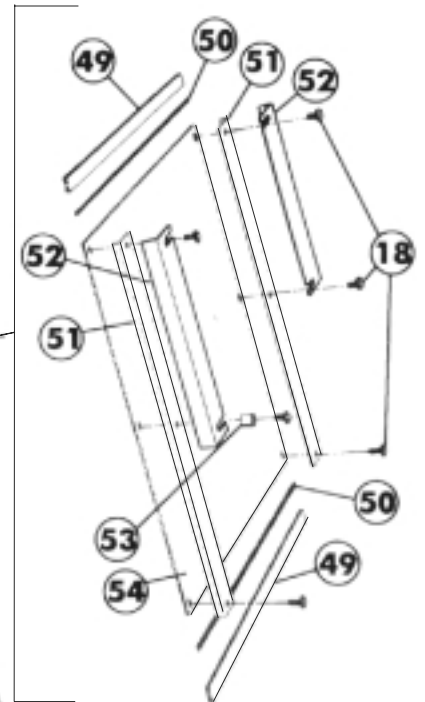
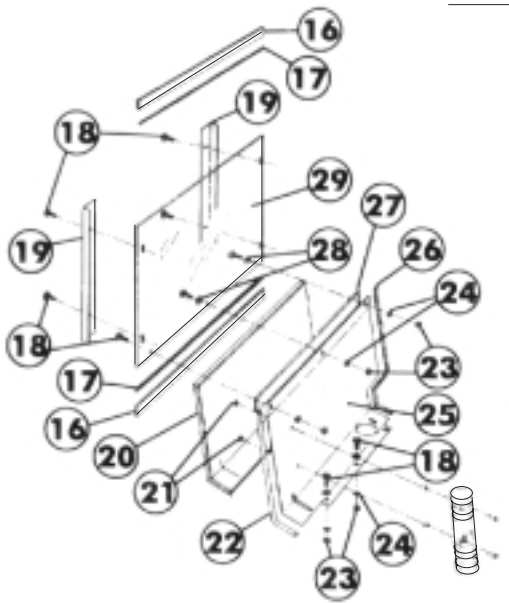
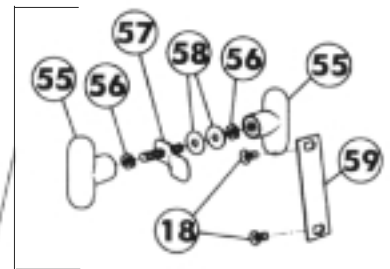
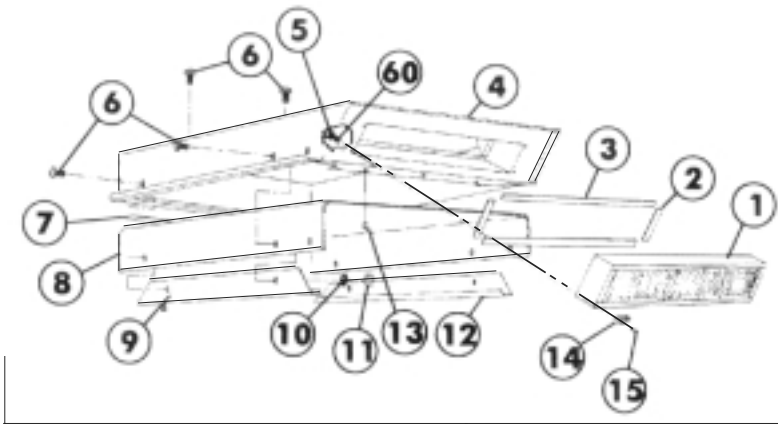

ENCLOSURE

| Ref | Part No. | Description | Qty |
|-----|----------|--|-----|
| 1 | 92-3814 | Charcoal Filter | 1 |
| 2 | 92-3902 | Foam Strip 1/8 x 1/2 x 4" | 2 |
| 3 | 92-3903 | Foam Strip 1/8 x 1/2 x 22-7/8" | 2 |
| 4 | 92-3806 | Enclosure Cover | 1 |
| 5 | 32153-1 | Hex Nut No. 10-24 | 4 |
| 6 | 92-3904 | Flange Hd. Bolt 3/8 x 3/4 | 10 |
| 7 | 92-3901 | Rear Panel Foam Strip | 1 |
| 8 | 92-3900 | Enclosure Headliner | 1 |
| 9 | 92-3811 | RH - Door Channel | 1 |
| 10 | 3253-11 | Lockwasher 3/8" | 4 |
| 11 | 3217-7 | Hex Nut 3/8-16 | 4 |
| 12 | 92-3810 | LH - Door Channel | 1 |
| 13 | 92-3983 | Insert Anchor 1/4" (with setting tool) | 3 |
| 14 | 029263 | Filter Retainer | 4 |
| 15 | 32105-8 | Phillips Hd. Mach. Scr No. 10 x 1/2 | 4 |
| 16 | 92-3918 | Rear Window Trim | 2 |
| 17 | 92-3920 | Rear Window Glazing | 2 |
| 18 | 92-3911 | Flange Hd. Bolt 1/4 x 3/4 | 26 |
| 19 | 92-3773 | Rear Window Clamp | 2 |
| 20 | 92-3787 | Foam Noise Barrier | 1 |
| 21 | 32153 | Lock Nut 5/16 | 2 |
| 22 | 92-3931 | Noise Shield Trim - RH | 1 |
| 23 | 3217-5 | Hex Nut 1/4-20 | 14 |
| 24 | 3253-3 | Lockwasher 1/4 | 14 |
| 25 | 92-3924 | Noise Shield | 1 |
| 26 | 92-3932 | Noise Shield Trim - LH | 1 |
| 27 | 92-3928 | Noise Shield Foam Strip | 1 |
| 28 | 3256-2 | Flatwasher 1/4 | 12 |
| 29 | 92-3760 | Rear Window | 1 |
| 30 | 92-3913 | Foam Strip Door Top | 2 |
| 31 | 92-3774 | Door Trim - Top | 2 |

| Ref | Part No. | Description | Qty |
|-----|----------|-----------------------------|-----|
| 32 | 92-3908 | Door Glazing - Top | 2 |
| 33 | 93-1075 | Door | 2 |
| 34 | 92-3776 | Door Trim - Bottom | 2 |
| 35 | 92-3910 | Door Glazing - Bottom | 2 |
| 36 | 92-3775 | Door Trim - Front | 2 |
| 37 | 92-3914 | Foam Strip Door Front - RHS | 1 |
| 38 | 92-3936 | Foam Strip Door Front - LHS | 1 |
| 39 | 92-3909 | Door Glazing Front | 2 |
| 40 | 92-3780 | Hinge | 2 |
| 41 | 321397 | Flange Lock Nut 3/8" | 2 |
| 42 | 042198 | Rubber Strap | 2 |
| 43 | 92-3925 | Oil Check Door | 1 |
| 44 | 92-3700 | Oil Check Door Magnet | 1 |
| 45 | 92-3946 | Replacement Wiper Handle | AR |
| 46 | 92-3929 | Wiper Handle Assembly | 1 |
| 47 | 92-3947 | Wiper Arm | 1 |
| 48 | 92-3948 | Wiper Blade | 1 |
| 49 | 92-3919 | Front Shield Trim | 2 |
| 50 | 92-3921 | Front Window Glazing | 2 |
| 51 | 92-3772 | Front Window Clamp | 2 |
| 52 | 92-8265 | Door Hold Down Clamp | 2 |
| 53 | 92-3934 | Wiper Stop | 1 |
| 54 | 92-3759 | Front Window | 1 |
| 56 | 41446 | Knob | 4 |
| 57 | 3296-47 | Hex Locking Jam Nut - 5/16" | 4 |
| 58 | 93-1077 | Door Latch Assembly | 2 |
| 59 | 356303 | Flat Washer - 5/16" | 4 |
| | 93-1080 | Door Catch Assembly - L. H. | 1 |
| | 93-1093 | Door Catch Assembly - R.R. | 1 |
| 60 | 3253-17 | #10 Lockwasher | 4 |
| 61 | 92-3785 | Seat Panel Noise Barrier | 1 |

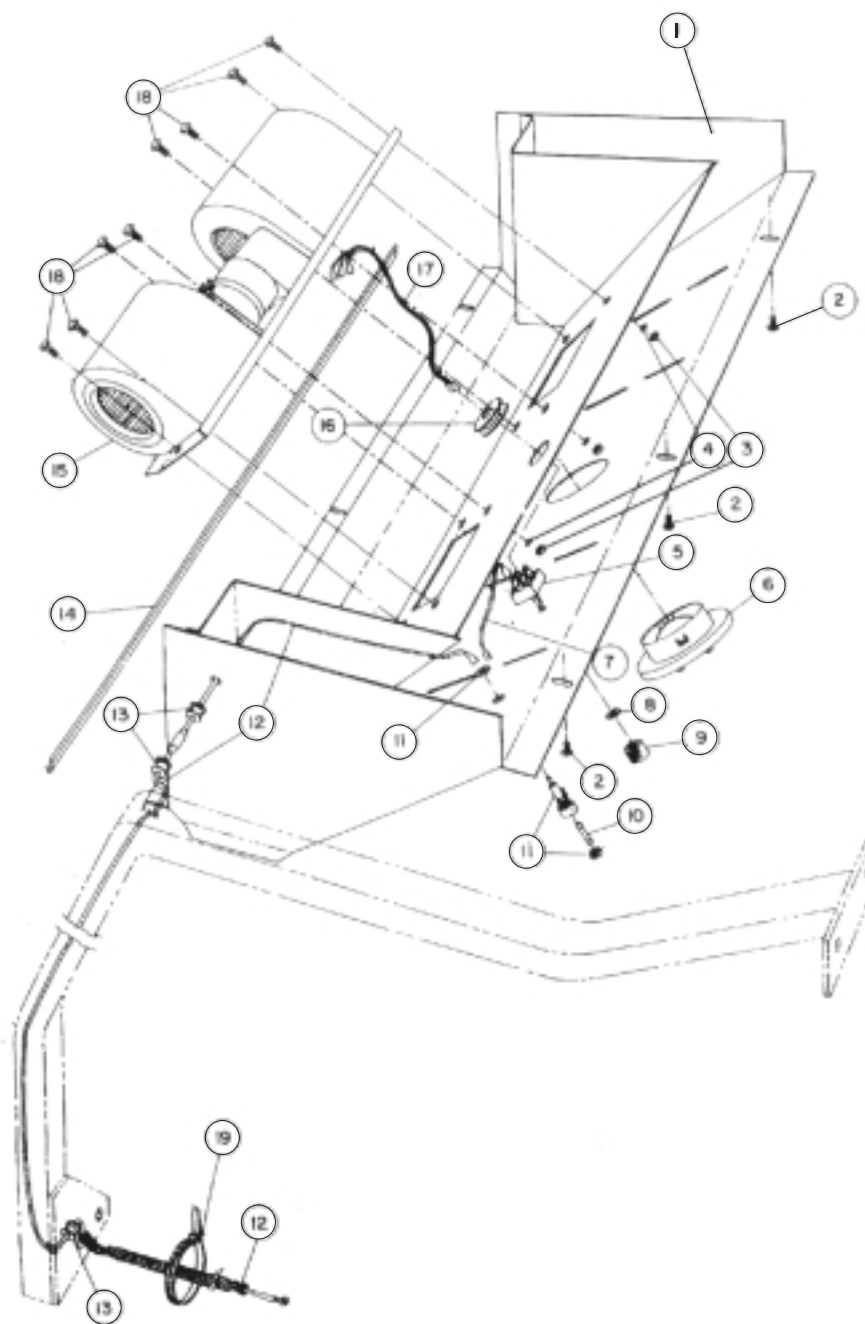

1609

BLOWER

| Ref | Part No. | Description | Qty |
|-----|----------|---------------------------|-----|
| 1 | *93-0826 | Blower Housing | 1 |
| 2 | 92-3911 | Flange Hd. Cap Screw 1/4" | 6 |
| 3 | 3217-5 | Hex Nut 1/4 UNC | 5 |
| 4 | 3253-3 | Lockwasher 1/4" | 5 |
| 5 | 92-3825 | Control Switch | 1 |
| 6 | 92-3824 | Blower Vent | 1 |
| 7 | 92-3944 | Fuse to Switch Wire | 1 |
| 8 | 92-3831 | Switch Nut | 1 |
| 9 | 92-3826 | Control Knob | 1 |
| 10 | 92-3945 | 20 Amp Fuse | 1 |

* Units purchased prior to July, 1994, Will use the following Part Numbers: 92-3816, Blower Housing; 92-3823, Blower Assembly.

| Ref | Part No. | Description | Qty |
|-----|----------|--------------------------------|-----|
| 11 | 92-0251 | Fuse Holder | 1 |
| 12 | 92-3935 | Blower Wire Harness | 1 |
| 13 | 92-0075 | 5/6" Grommet | 3 |
| 14 | 92-3905 | Foam Strip | 1 |
| 15 | *93-0825 | Blower Assembly | 1 |
| | * | Blower Motor (f/w 92-3823) | 1 |
| | * | Blower Fan Wheel (f/w 92-3823) | 2 |
| 16 | 42811 | 1" Grommet | 1 |
| 17 | 92-3827 | Wire Harness - Switch | 1 |
| 18 | 321-3 | HHCS 1/4 UNC x 5/8" | 8 |
| 19 | 95672 | Nylon Sta- Strap | 1 |