



MODEL NO. 41026-60101 & UP

OPERATOR'S
INSTRUCTIONS

HOSE REEL KIT

To assure maximum safety, optimum performance, and to gain knowledge of the product, it is essential that you or any other operator of this equipment read and understand the contents of this manual before the vehicle engine is ever started. Pay particular attention to the **SAFETY INSTRUCTIONS** highlighted by this symbol—

 The safety alert symbol means **CAUTION, WARNING or DANGER**—personal safety instruction. Failure to comply with the instruction may result in personal injury.

SAFETY INSTRUCTIONS

Keep this Operator's Manual in the plastic tube behind the operator seat.

It is very important that all persons operating this equipment have easy access to these instructions at all times.

Carefully read and follow the Installation Instructions that are provided with this equipment and the Safety Instructions in the Multi Pro® 1100 or 5500 Vehicle Operator's Manual.

 This safety-alert symbol is used to call attention to a **dangerous** situation, which could result in serious injury or death to the operator or a bystander.

Safety, mechanical and some general information in this manual are emphasized. **DANGER, WARNING** and **CAUTION** identify safety messages. Whenever the triangular safety symbol appears, it is followed by a safety message that must be read and understood. For more details concerning safety, read the Safety Instructions that follow. **IMPORTANT** identifies special mechanical information and **NOTE** identifies general information worthy of special attention.

These instructions are provided as a guide for the safe operation and maintenance of this equipment. However, the operator's personal safety, as well as those persons in the work area, will depend on the careful actions and good judgement of the operator. To reduce the potential for injury or death, comply with the following safety instructions.

BEFORE OPERATING:

1. Operate this machine only after reading and understanding the contents of this manual. A replacement manual is available by sending complete model and serial number to: Hahn Equipment Co, 1625 N. Garvin, Evansville, IN 47711.
2. Learn how to operate the Hose Reel and how to use the controls properly. **DO NOT** let anyone operate this equipment without first receiving thorough instructions.
3. Keep all shields, safety devices and decals in place. If a shield, safety device or decal is malfunctioning, illegible or damaged, repair or replace it before operating the machine.
4. Chemicals can injure persons, animals, plants, soils or other property. To eliminate environmental damage and personal injury:
 - A. Follow manufacturer's instructions on chemical container labels. Apply and handle chemicals as recommended.
 - B. Handle and apply chemicals with care. Wear goggles and other necessary protective equipment. Handle chemicals in well ventilated areas. Never smoke while handling chemicals.
 - C. Properly dispose of chemical container and unused chemicals.

5. Make certain everyone is clear of the machine and work site before starting the engine and beginning to spray.

WHILE OPERATING:

6. Do **not** direct spray at any persons or pets; even low pressure is very dangerous and can cause serious injury.

7. If equipment begins to vibrate abnormally, stop **immediately**. Shut off the vehicle engine and disengage all power. Repair all damage before commencing operation.

8. Keep hands clear of chain/sprocket drive system.

9. Do **not** wear loose fitting clothing or jewelry which could get caught in moving parts and cause personal injury.

10. If a leak occurs in the supply hose or reel, **immediately** disengage spray pump to release the supply hose pressure.

MAINTENANCE:

11. **Before** servicing or making any adjustments to the Hose Reel:

A. Stop the vehicle and set the parking brake.

B. Shut off the vehicle's engine and remove key from ignition.

C. Disengage all power and wait until all moving parts have stopped.

12. Keep all nuts, bolts and other fasteners tightened securely. Replace any shields removed during servicing or adjustments.

13. To be sure of optimum performance and safety, always purchase genuine TORO replacement parts and accessories. Replacement parts and accessories made by other manufacturers could be dangerous. Altering this equipment in any manner may affect the machine's operation, performance, durability or its use may result in injury or death. Such use could void the productwarranty of the TORO Company.

SAFETY AND INSTRUCTION DECALS

The following safety and instruction decals are installed on this equipment. If any become damaged or illegible, replace them. Decal part numbers are listed below and in the parts catalog. Order replacements from your Authorized Toro Distributor.



Part No. 87-0540; Located under reel switch on electric box.

CONTROLS AND OPERATION

HOSE REEL SWITCH (FIG. 1): Activates the hose reel motor which spins the hose reel.

HOSE REEL VALVE HANDLE (FIG. 1): Opens and closes hose reel valve to open up or shut off the supply of spray liquid to the hose reel.

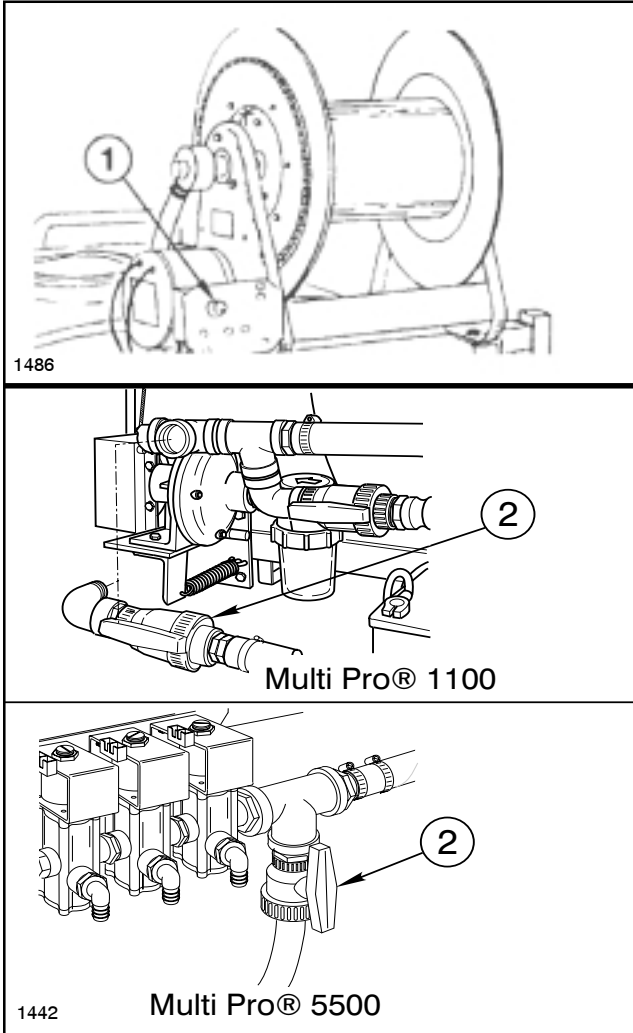

FIG. 1

1. Hose Reel Switch 2. Hose Reel Valve Handle

OPERATION:

WINDING HOSE ONTO REEL:

NOTE: Be aware that the reel switch is an ON/OFF switch and does NOT control the speed of the winding action. Push the switch button intermittently when beginning to wind the hose onto an empty reel.



CAUTION

KEEP HANDS AWAY FROM THE CHAIN DRIVE SYSTEM WHEN HOSE REEL IS SPINNING. SERIOUS PERSONAL INJURY MAY RESULT IF FINGERS BECOME LODGED BETWEEN CHAIN AND SPROCKETS.

1. Press and hold the reel switch while feeding the hose onto the spool. Feed the hose slowly and as evenly across the spool as possible.

IMPORTANT! If the reel stops winding, release the hose reel switch IMMEDIATELY. Do NOT pull or jerk on the hose. Always find and correct the problem before continuing to rewind the hose.

UNWINDING THE HOSE:

1. Pull the hose from the reel by grasping the hose itself, not the hand gun.

IMPORTANT! If the reel stops unwinding, do NOT pull or jerk on the hose. Always find and correct the problem before continuing to unwind the hose.

2. If the spool is running faster than desired, causing hose backlash, adjust the “drag” by tightening the set screw on the hub casting. See FIG. 2.

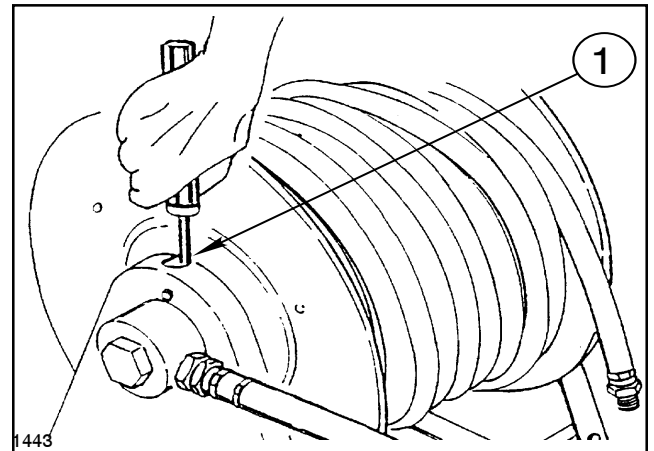

FIG. 2

1. Set Screw

3. When the hose reel is not in use, tighten the lock handle located on frame side, motor end, to prevent the spool from rotating freely.

SERVICE

MAINTENANCE:

CHAIN TENSION:



CAUTION

TO PREVENT PERSONAL INJURY, REMOVE ALL ELECTRICAL POWER FROM MOTOR BEFORE ADJUSTING CHAIN TENSION. DISCONNECT THE BATTERY WIRE FROM THE VEHICLE BATTERY'S POSITIVE (+) POST TO REMOVE ELECTRICAL POWER.

IMPORTANT! Over-tensioning (tightening) of chain results in reduced motor life. Adjust the chain to allow between 1/4"-1/2" play in chain.

1. Loosen (do not remove) the (4) bolts which hold the motor mounting bracket to the reel. See FIG. 3.
2. Move motor mounting bracket and motor until proper chain tension is achieved.
3. Tighten all of the motor mounting bracket bolts securely.

CHAIN REPLACEMENT:

1. Disconnect the battery wire from the vehicle battery's positive (+) post.
2. Loosen (do not remove) the (4) bolts which hold the motor mounting bracket to the reel. See FIG. 3.

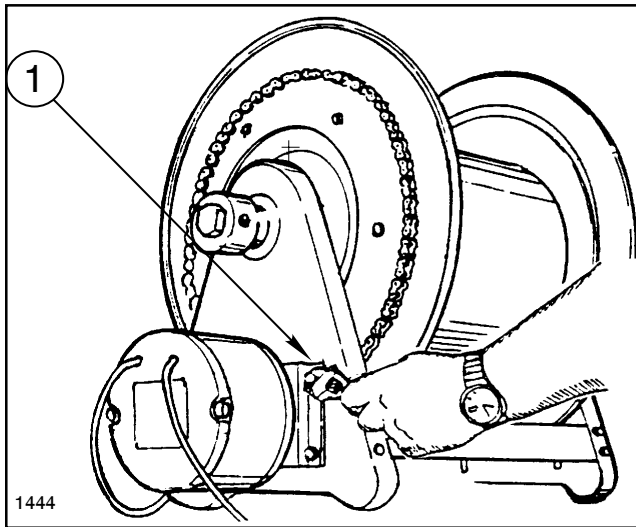

FIG. 3

1. Motor Mounting Bracket

3. Remove the chain's master link and use it to install the new chain.

4. Move motor mounting bracket and motor until proper chain tension is achieved (see CHAIN TENSION under MAINTENANCE). Tighten the (4) mounting bolts securely.

5. Reinstall the battery wire on positive (+) post of the vehicle battery.

SWIVEL REPLACEMENT:



CAUTION

TO AVOID EXPOSURE TO SPRAY SOLUTION WHICH MAY CONTAIN HARMFUL CHEMICALS, DISENGAGE THE SPRAY PUMP (USING THE PUMP SWITCH) TO REMOVE PRESSURE BEFORE PERFORMING THE FOLLOWING PROCEDURE.

1. Remove supply hose from swivel.
2. Remove swivel assembly from inlet shaft. See FIG. 4.

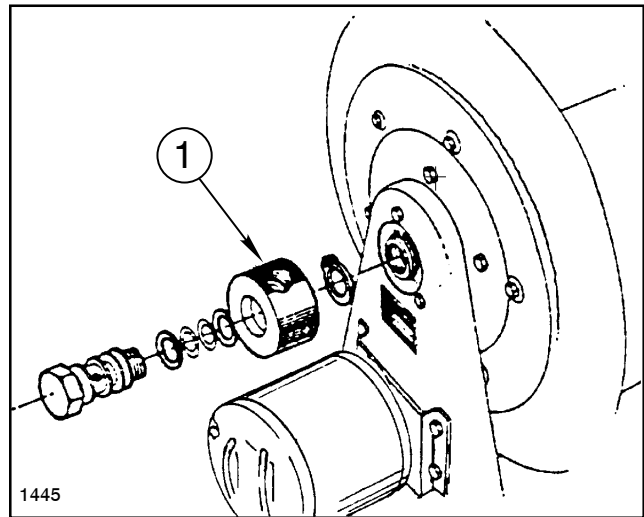

FIG. 4

1. Swivel

3. To replace "O" rings (4 each), disassemble swivel by removing clip ring from swivel shaft.
4. Reassemble and reinstall swivel assembly on the inlet shaft using Thread Tape on threads.

MOTOR REPLACEMENT:

1. Disconnect the battery wire from the positive (+) post of the vehicle battery.
2. Remove the 3/8" x 1" hex hd cap screw, flat washer, and locknut securing the negative (-) wire from the motor to the reel frame.

SERVICE

3. Remove the (4) #10 x 1/2" screws, washers, and nuts that secure the cover plate on the electric box assembly.

4. Disconnect the positive (+) wire of the reel motor from the terminal on the circuit breaker located on the cover plate assembly. Pull the wire out through the opening found in the bottom of the electric box.

5. Remove the (4) 5/16" x 1/2" hex hd cap screws and nuts securing motor mounting bracket and motor to hose reel. Remove bracket and motor. See FIG. 3.

6. Remove the (4) 5/16" x 1/2" hex hd cap screws and flat washers securing the motor mounting bracket to motor. Remove motor.

7. Loosen the (2) set screws on the motor sprocket and remove sprocket and key from motor shaft.

8. Install sprocket and key earlier removed on new motor shaft and secure by tightening the (2) set screws securely.

9. Attach motor mounting bracket to motor using the (4) 5/16" x 1/2" hex hd cap screws and flat washers. Tighten fasteners securely.

10. Loosely mount the motor mounting bracket and motor to the hose reel using the fasteners earlier removed.

11. Move motor mounting bracket and motor until proper chain tension is achieved (see CHAIN TENSION under MAINTENANCE). Tighten fasteners securely.

12. Feed the positive (+) wire from the reel motor through the wire bushing in the bottom of the electric box and crimp a #10 ring terminal to the end of the wire.

13. Connect the positive (+) wire from the reel motor to the terminal on the circuit breaker located on the cover plate assembly.

14. Reinstall the cover plate assembly to the electrical box using the fasteners previously removed. Tighten fasteners securely.

15. Reconnect the negative (-) wire to the hose reel frame using the fasteners previously removed. Tighten fasteners securely.

16. Reinstall the battery wire on the positive (+) post of the vehicle battery.

Spray Hose Replacement:



CAUTION

TO AVOID EXPOSURE TO SPRAY SOLUTION WHICH MAY CONTAIN HARMFUL CHEMICALS, DISENGAGE THE SPRAY PUMP (USING THE PUMP SWITCH) TO REMOVE PRESSURE BEFORE PERFORMING THE FOLLOWING PROCEDURE.

1. Unwind hose to be replaced and remove from Hose Reel.

2. Apply Teflon thread tape and hand thread the male hose connector into the outlet tube of the Inlet Assembly.

3. Using a wrench, firmly hold the outlet tube while tightening the hose connector.

IMPORTANT! FULLY EXTEND AND CHARGE THE SPRAY HOSE BEFORE WINDING IT ONTO THE SPOOL.

4. Open the Hose Reel Valve handle to purge the hose of gases. When fluid appears, close the Hose Reel Valve Handle. This prevents the flattening of the hose resulting in excessive pressure on the spool when spraying is resumed and fluid supply is discharged under high pressure.

5. Remove Spray Gun from defective hose. Apply thread tape and hand thread the male connector into the Spray Gun. Tighten Securely.

NOTES:



Helping you put quality into play.®

The Toro Commercial Products Two Year Limited Warranty

The Toro Company warrants your 1996 or newer Toro Commercial Product ("Product") purchased after January 1, 1997, to be free from defects in materials or workmanship for the period of time listed below. Where a warrantable condition exists, Toro will repair the Product at no cost to you including diagnosis, labor, parts, and transportation. This warranty begins on the date the Product is delivered to the original retail purchaser.

Warranty Duration: Two years or 1500 operational hours*, whichever occurs first.

***Product equipped with hour meter**

Owner Responsibilities:

As the Product owner, you are responsible for required maintenance and adjustments stated in your Owner's Manual. Failure to perform required maintenance and adjustments can be grounds for disallowing a warranty claim.

Instructions for Obtaining Warranty Service:

You are responsible for notifying the Commercial Products Distributor or Authorized Commercial Products Dealer from whom you purchased the Product as soon as you believe a warrantable condition exists.

If you need help locating a Commercial Products Distributor or Authorized Dealer, or if you have questions regarding your warranty rights or responsibilities, you may contact us at:

TORO Commercial Products Service Department
8111 Lyndale Avenue South
Minneapolis, MN 55420-1196
Telephone: (612) 888-8801
Facsimile: (612) 887-8258
E-Mail: Commercial.Service@Toro.Com

Maintenance Parts:

Parts scheduled for replacement as required maintenance ("Maintenance Parts"), are warranted for the period of time up to the scheduled replacement time for that part.

Items/Conditions Not Covered:

Not all product failures or malfunctions that occur during the warranty period are defects in material or workmanship. The items / conditions listed below are not covered by this warranty:

- Product failures which result from the use of non-Toro replacement parts, or from installation and use of add-on, modified, or unapproved accessories are not covered.
- Product failures which result from failure to perform required maintenance and/or adjustments are not covered.
- Product failures which result from operating the Product in an abusive, negligent, or reckless manner are not covered.
- This warranty does not apply to parts subject to consumption through use unless found to be defective.

Examples of parts which are consumed, or used up, during normal Product operation include, but are not limited to, blades, reels, bedknives, tines, spark plugs, castor wheels, tires, filters, belts, etc.

- This warranty does not apply to failures caused by outside influence. Items considered to be outside influence include, but are not limited to, weather, storage practices, contamination, use of unapproved coolants, lubricants, additives, or chemicals, etc.
- This warranty does not apply to normal "wear and tear" items. Normal "Wear and Tear" includes, but is not limited to, damage to seats due to wear or abrasion, worn painted surfaces, scratched decals or windows, etc.

Other Legal Disclaimers:

The above remedy of product defects through repair by an authorized distributor or dealer is the purchaser's sole remedy for any defect. This warranty gives you specific legal rights, and you may also have other rights which vary from state to state.

Except for the Emissions warranty referenced below, If applicable, there is no other express warranty. All implied warranties of merchantability and fitness for use are limited to the duration of the express warranty.

Some states do not allow limitations on how long an implied warranty lasts, so the above limitations may not apply to you.

The Toro Company is not liable for indirect, incidental or consequential damages in connection with the use of the Product, including any cost or expense of providing substitute Product or service during periods of malfunction or non-use.

Some states do not allow the exclusion of incidental or consequential damages, so the above exclusion may not apply to you.

Note to California residents: The Emissions Control System on your Product may be covered by a separate warranty meeting requirements established by the U.S. Environmental Protection Agency (EPA), or the California Air Resources Board (CARB). The hour limitations set forth above do not apply to the Emissions Control System Warranty. Refer to the California Emission Control Warranty Statement printed in your Owner's Manual or contained in the engine manufacturer's documentation for details.