



Discharge Upgrade Kit

13-32G and 13-32H Rear Engine Riding Mowers

Model No. 106-6527

Form No. 3329-406 Rev A

Installation Instructions

Save these instructions with your *Operator's Manual* for future reference.

Contents of the Kit

DESCRIPTION	QUANTITY
Locknuts (M6)	6
Washers (M6)	6
Bolt (M6)	1
Locknuts (M8)	2
Short bolts (M6)	4
Straps	2
Washers (M8)	2
Washers (9 x 32 x 2.5 mm)	2
Bolt (M8)	1
Grooved pin	1
Washers (6.6 x 18 x 2 mm)	2
Hairpin	1

Removing the Recycler[®] Cover or Discharge Chute

1. Park the machine on a level surface.
2. Disengage the blade (PTO).
3. Shift the ground speed lever into Neutral and set the parking brake.
4. Stop the engine, wait for all moving parts to stop, and remove the ignition key.

5. Raise the grass collector, and remove and discard the bolt, washer, and locknut that secure the discharge tube to the rear plate.

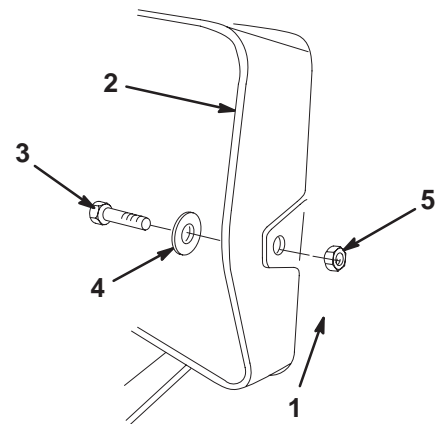

m-6339

Figure 1

1. Rear plate
2. Discharge tube
3. Bolt
4. Washer
5. Locknut

6. Remove the locknut and outer washer that secure the discharge chute to the discharge tube as shown in Figure 2 (discharge chute only).

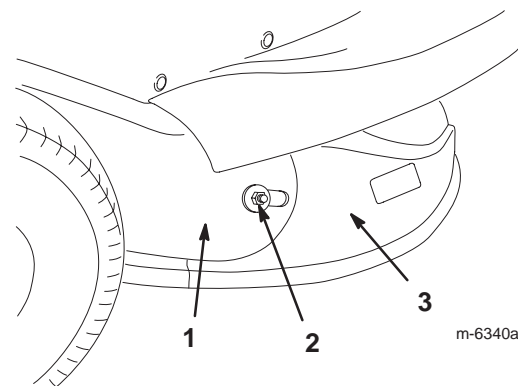

m-6340a

Figure 2

1. Discharge tube
2. Locknut and outer washer
3. Discharge chute

7. Move the height-of-cut lever to the lowest position.

- Remove and discard the 4 sets of bolts, washers, and locknuts from the housing as shown in Figure 3.

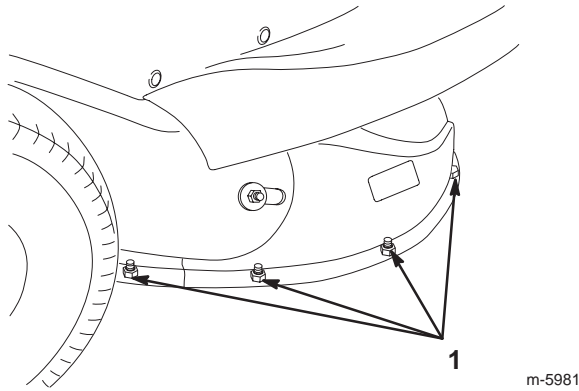

Figure 3

- Bolts

- Remove the discharge chute or Recycler cover from the mower housing.

Creating the Slots

- Insert the template into the holes in the housing toward the front as shown in the inset in Figure 4.

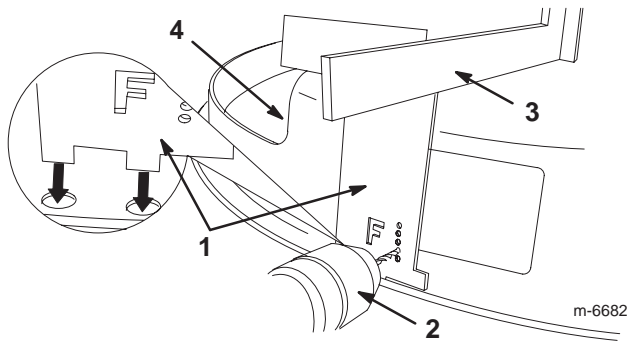

Figure 4

- Template
- Drill
- Straight edge
- Edge of the opening in the housing

- Drill the holes (3 mm) in the front of the housing using the "F" (front) side of the template and a straight edge as shown in Figure 4.

- Remove the right rear tire and block the machine to support it.

- Insert the template into the hole in the housing toward the rear as shown in the inset in Figure 5.

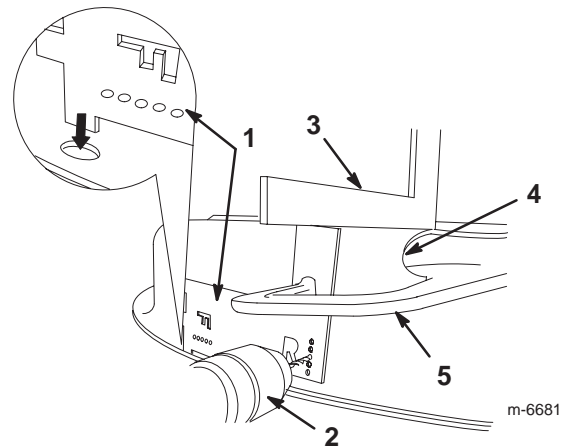

Figure 5

- Template
- Drill
- Straight edge
- Edge of the opening in the housing
- Clamp

- Drill the holes (3 mm) in the rear of the housing using the "R" (right) side of the template and a straight edge as shown in Figure 5.

- Use a file or a die grinder on both the front and rear sets of holes to make 2 slots for the straps.

- Insert the ends of the straps into the front and rear slots (Fig. 6).

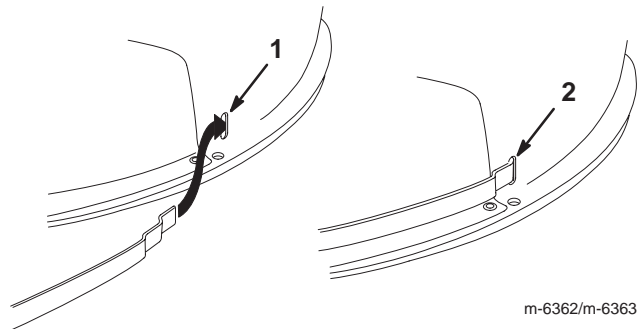

Figure 6

- Insert the strap end into the front slot.
- The strap end is in the front slot.

- Install the 4 sets of short bolts, washers, and locknuts provided in the kit to replace those you previously removed in step 8 of Removing the Recycler Cover or Discharge Chute above.

9. Install the Recycler cover or discharge chute onto the mower.

Note: To install the Recycler cover or the discharge chute using the straps for the first time, do one of the following:

- To install the Recycler cover, go to step 11 of Installing the Recycler Cover on page 3.
- To install the discharge chute, go to step 10 of Installing the Discharge Chute on page 4.

Installing the Recycler Cover



Danger



Without the grass deflector, discharge cover, or complete grass catcher assembly mounted in place, you and others are exposed to blade contact and thrown debris. Contact with the rotating mower blade and thrown debris will cause injury or death.

- Never remove the grass deflector from the mower because the grass deflector routes material down toward the turf. If the grass deflector is ever damaged, replace it immediately.
- Never put your hands or feet under the mower.
- Never try to clear the discharge area or mower blades unless you disengage the power take-off (PTO) and turn the ignition key to Off. Also remove the key and disconnect the wire from the spark plug.

1. Park the machine on a level surface.
2. Disengage the blade (PTO).
3. Shift the ground speed lever into Neutral and set the parking brake.
4. Stop the engine, wait for all moving parts to stop, and remove the ignition key.

5. Raise the grass collector and remove the hairpin, 2 washers, and grooved pin that secure the discharge tube to the rear plate (Fig. 7).

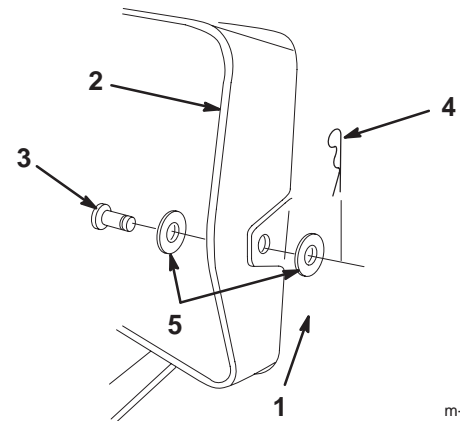

m-6339

Figure 7

- | | |
|-------------------|---------------------------------|
| 1. Rear plate | 4. Hairpin |
| 2. Discharge tube | 5. Washers
(6.6 x 18 x 2 mm) |
| 3. Grooved pin | |

6. Remove the locknut and outer washer that secure the discharge chute to the discharge tube (Fig. 2).
7. Move the height-of-cut lever to the lowest position.
8. Remove the bolt, washer, and locknut that secure the 2 strap ends together (Fig. 8).

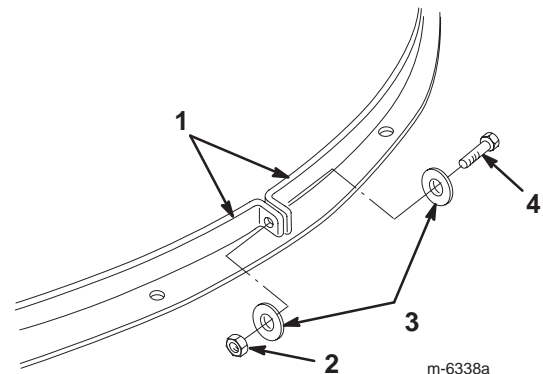

m-6338a

Figure 8

- | | |
|-----------------|-----------------|
| 1. Straps | 3. Washers (M6) |
| 2. Locknut (M6) | 4. Bolt (M6) |

9. Move the straps away from the the discharge chute, but do not remove the straps from the housing.
10. Remove the discharge chute from the mower housing.
Note: Attach the hardware you removed to the discharge chute to prevent losing it.
11. Install the Recycler cover onto the mower.
12. Raise the grass collector and install the grooved pin, 2 washers, and hairpin to secure the discharge tube to the rear plate (Fig. 7).
13. Join the 2 strap ends around the Recycler cover (Fig. 8).
14. Align the holes in the strap ends and fasten them together snugly with a bolt, 2 washers, and a locknut (Fig. 8).

8. Move the straps away from the the discharge chute, but do not remove the straps from the housing.
9. Remove the Recycler cover from the housing.
10. Install the discharge chute onto the mower.
11. Raise the grass collector and install the grooved pin and hairpin to secure the discharge tube to the rear plate (Fig. 7).
12. Secure the discharge chute to the discharge tube (refer to Fig. 2) using a bolt (M8), 2 washers (M8), 2 washers (9 x 32 x 2.5 mm), and 2 locknuts (M8).
13. Join the 2 strap ends around the discharge chute (Fig. 8).
14. Align the holes in the strap ends and fasten them together snugly with a bolt, 2 washers, and a locknut (Fig. 8).

Installing the Discharge Chute



Danger



Without the grass deflector, discharge cover, or complete grass catcher assembly mounted in place, you and others are exposed to blade contact and thrown debris. Contact with the rotating mower blade and thrown debris will cause injury or death.

- **Never remove the grass deflector from the mower because the grass deflector routes material down toward the turf. If the grass deflector is ever damaged, replace it immediately.**
- **Never put your hands or feet under the mower.**
- **Never try to clear the discharge area or mower blades unless you disengage the power take-off (PTO) and turn the ignition key to Off. Also remove the key and disconnect the wire from the spark plug.**

1. Park the machine on a level surface.
2. Disengage the blade (PTO).
3. Shift the ground speed lever into Neutral and set the parking brake.
4. Stop the engine, wait for all moving parts to stop, and remove the ignition key.
5. Raise the grass collector and remove the hairpin and grooved pin that secure the discharge tube to the rear plate (Fig. 7).
6. Move the height of cut lever to the lowest position.
7. Remove the bolt, washer, and locknut that secure the 2 strap ends together (Fig. 8).