



Installation Instructions

# Installation

## Loose Parts

Use the chart below to verify that all parts have been shipped.

Procedure	Description	Qty.	Use
1	No parts required	–	Prepare the machine.
2	Air ride seat suspension assembly	1	Install the seat.
3	Fuse – 20 A (for use on machines without an air ride suspension fuse slot only) Fuse block (for use on machines without an air ride suspension fuse slot only) Screw (for use on machines without an air ride suspension fuse slot only)	1 1 2	Connect the seat.
4	No parts required	–	Complete the installation.



# 1

## Preparing the Machine

### No Parts Required

### Procedure

1. Position the machine on a level surface, lower the cutting units, shut off the engine, engage the parking brake, and remove the key from the ignition.
2. Disconnect the negative battery cable from the battery.
3. Disconnect the seat switch wire from the harness at the rear of the control arm.
4. Remove the 2 adjusting bolts securing the control arm to the seat mount (Figure 1). Carefully set the control arm aside.

**Important:** Ensure that you do not damage the wire harness or the throttle cable.

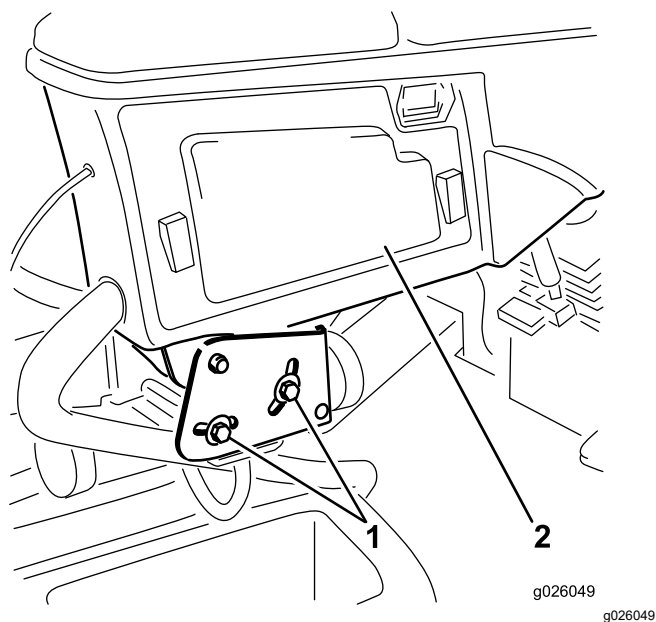

Figure 1

1. Control arm adjusting bolts    2. Control arm access panel

5. Remove the 4 nuts securing the seat adjusters and the manual tube clamps to the seat suspension (Figure 2).
6. Remove the 4 washers between the seat adjusters and seat suspension and remove the seat assembly; carefully set the seat assembly aside.
7. Remove the 4 bolts, spacers, and nuts securing the lower seat brackets to the seat base (Figure 2).
8. Remove the seat suspension and the seat brackets from the seat base.
9. Remove the 4 bolts securing the seat suspension to the lower seat brackets (Figure 2).

**Important:** Ensure that you do not misplace the spacers during removal.

**Important:** Retain the removed bolts and brackets for later installation.

# 2

## Installing the Seat

### Parts needed for this procedure:

1	Air ride seat suspension assembly
---	-----------------------------------

### Procedure

1. Secure the air ride seat suspension to the lower seat brackets with the 4 bolts previously removed (Figure 2).  
**Note:** When assembling the seat components, use the **front** mounting holes in the seat and the **rear** mounting holes in the suspension.
2. Mount the lower seat brackets to the seat base with the 4 bolts, spacers, and nuts previously removed (Figure 2).
3. Position the seat assembly onto the seat suspension. Ensure that a washer is on each adjuster stud before placing it on the suspension (Figure 2).

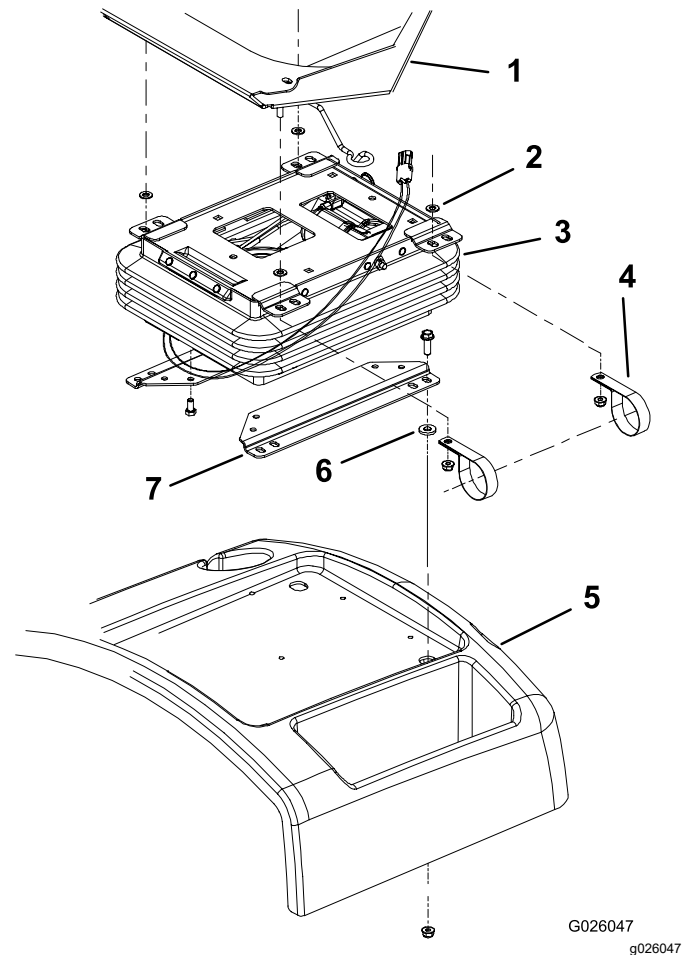

Figure 2

- |                            |                        |
|----------------------------|------------------------|
| 1. Seat assembly           | 5. Seat base           |
| 2. Washer (4)              | 6. Spacer              |
| 3. Seat suspension         | 7. Lower seat brackets |
| 4. Manual tube R-clamp (2) |                        |

4. Secure the seat adjusters and the manual tube clamps to the seat suspension with the 4 nuts previously removed (Figure 2).
5. Install the control arm with the 2 control arm adjusting bolts previously removed (Figure 1). Adjust as desired.

# 3

## Connecting the Seat

### Parts needed for this procedure:

1	Fuse – 20 A (for use on machines without an air ride suspension fuse slot only)
1	Fuse block (for use on machines without an air ride suspension fuse slot only)
2	Screw (for use on machines without an air ride suspension fuse slot only)

## Determining the Appropriate Seat Connection

There are 3 configurations for connecting the seat. Determine the appropriate configuration for your machine:

If your machine has a fuse block in the control arm **without** an air ride suspension fuse slot, refer to [Installing the Fuse Block and Connecting the Seat \(page 4\)](#).

If your machine has a fuse block in the control arm **with** an air ride suspension fuse slot, refer to [Checking the Fuse in the Arm Console \(page 4\)](#).

If your machine does not have a fuse block in the control arm, refer to [Checking the Fuse Under the Seat \(page 4\)](#).

## Installing the Fuse Block and Connecting the Seat

### For machines with control arm fuse blocks without an air ride suspension fuse slot

1. Remove the access panel from the side of the control arm.
2. Mount the fuse block next to the existing fuse block with 2 screws (#8 x 1/2 inch) as shown in [Figure 3](#).

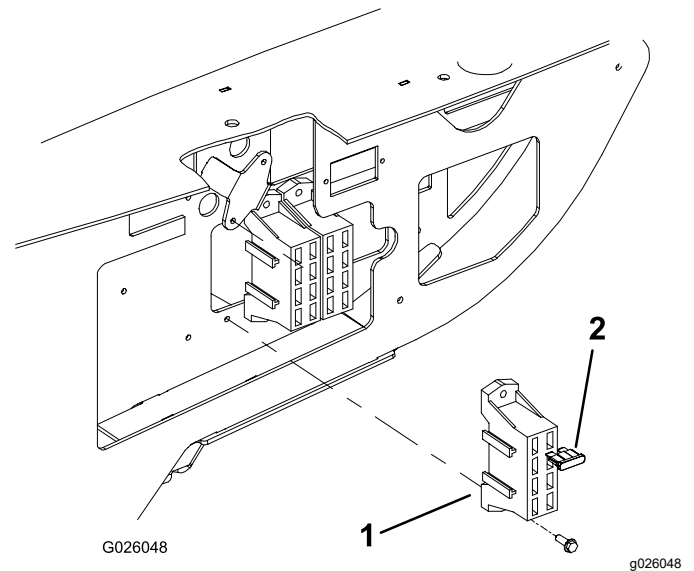

Figure 3

1. Fuse block
2. Fuse – 20 A

3. Connect the large red wire from the traction unit wire harness to the wire on the fuse block.
4. Connect the red wire with the white stripe labeled “Air Ride Seat” to one of the red wires from the fuse block.
5. Insert the 20 A fuse into the fuse slot where the wire is connected.
6. Install the access panel to the control arm ([Figure 1](#)).
7. Plug the traction unit power harness from the back of the control arm into the seat harness connector.

## Checking the Fuse in the Arm Console

### For machines with arm console fuse blocks with an air ride suspension fuse slot

1. Remove the access panel from the side of the control arm.
2. Ensure that there is a 20 A fuse in the air ride suspension fuse slot.
3. Plug the traction unit power harness from the back of the control arm into the seat harness connector.

## Checking the Fuse Under the Seat

### For machines with fuse blocks under the seat

1. Unlatch, tilt open, and support the seat base with the prop rods.

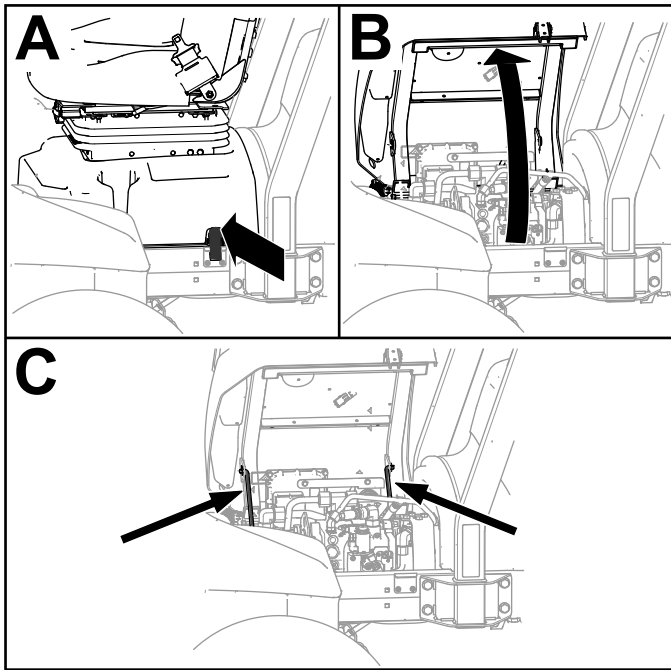

**Figure 4**

g419565

5. Plug the traction unit power harness from the back of the control arm into the seat harness connector.

# 4

## Completing the Installation

**No Parts Required**

### Procedure

1. Slide the seat completely forward and backward to ensure proper operation and that the seat wires and connectors are not pinched or do not contact any moving parts.
2. Connect the negative battery cable to the battery.

2. Refer to the decal on the fuse block cover to locate the air ride suspension fuse slot.

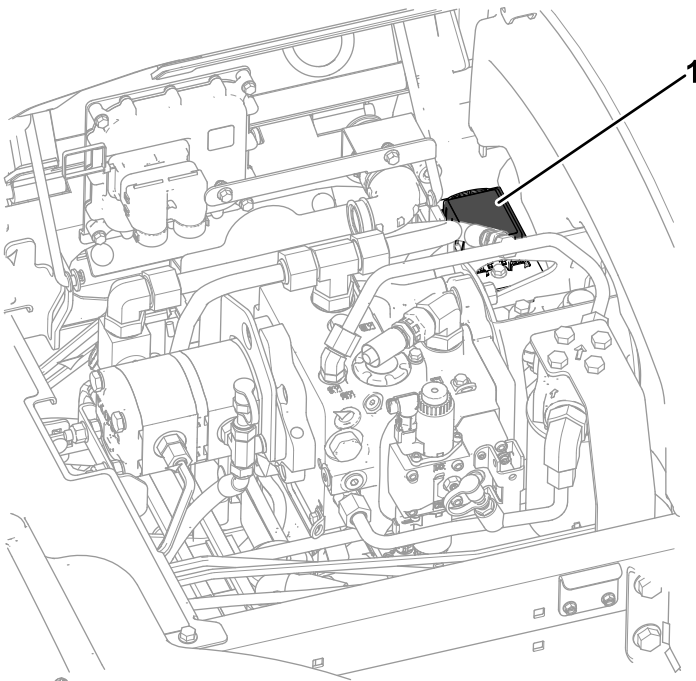

**Figure 5**

g420144

1. Fuse block cover

3. Remove the cover from the fuse block.
4. Ensure that there is a 20 A fuse in the air ride suspension fuse slot.

# Operation

## Seat Adjusting Knobs

### Adjusting Lever

Fore and aft seat adjustment ([Figure 6](#)).

### Air Control Valve

Push in control valve to inflate suspension. Pull out valve to deflate suspension ([Figure 6](#)).

### Weight Guide

Indicates when seat is adjusted to the weight of the operator ([Figure 6](#)).

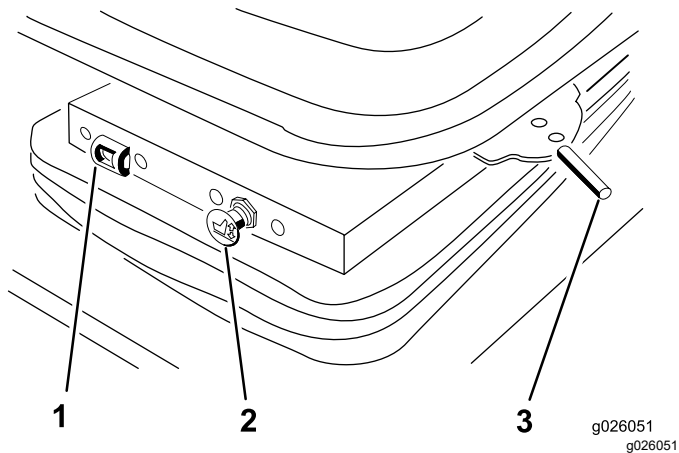

**Figure 6**

- |                      |                                   |
|----------------------|-----------------------------------|
| 1. Weight guide      | 3. Adjusting lever (fore and aft) |
| 2. Air control valve |                                   |
-

**Notes:**



**Count on it.**