



Pedal Switch Kit

Workman 1100, 2100, and 2110 Vehicles

Model No. 107-0340

Form No. 3350-207

Installation Instructions

Loose Parts

Description	Qty.	Use
Switch	1	Replacing the pedal switch
Plate tapped	1	
Electrical sealant	1	
Heat shrink tube	1	
Screw (3/8 x 5/8 inch)	2	

Preparing the Vehicle

Position the machine on a level surface, stop the engine, remove the key, and disconnect the negative (-) battery terminal. Engage the parking brake.



Caution



If you leave the key in the ignition switch, someone could accidentally start the engine and seriously injure you or other bystanders.

Remove the key from the ignition switch before you do any maintenance.

Replacing the Pedal Switch

1. If you have a floor mat, remove it from around the accelerator and brake pedals.
2. Remove the metal plate on the floor surrounding the pedals.
3. Remove switch from pedal box. If necessary, drill out the rivets securing the switch to the pedal box.
4. Pull the switch and cabling out, away from the pedal box.
5. Disconnect the faulty switch and discard.
6. Clean the connector from the cabling of any debris or foreign material.
7. Slide the heat shrink tubing over the cabling.

8. Pack the new switch connector with electrical sealant provided in the kit (Fig. 1).

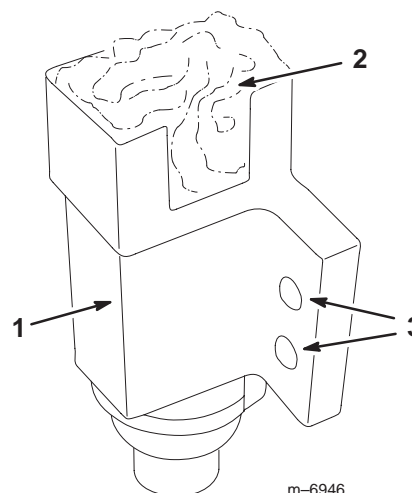
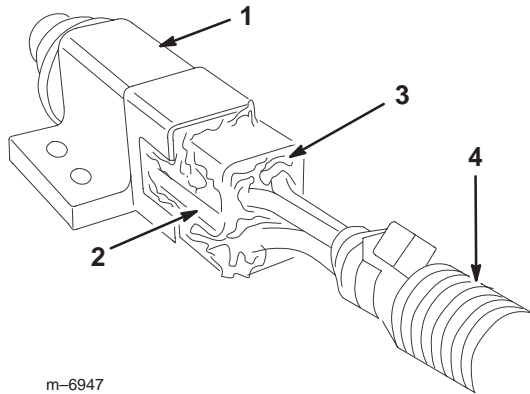

Figure 1

1. Switch
 2. Electrical sealant
 3. Mounting holes
-
9. Pack the connector with the electrical sealant.
 10. Connect the switch to the connector in the cabling.
 11. Disconnect the switch from the connector and repack both with electrical sealant.
 12. Repeat steps 10 and 11 until the switch and connector are packed with sealant; approximately 2-3 times.

13. Once connected, pack the rear end of the cable connector with electrical sealant to prevent debris or foreign material from entering (Fig. 2).



m-6947

Figure 2

- | | |
|--------------------|--|
| 1. Switch | 3. Cable connector packed with sealant |
| 2. Cable connector | 4. Cabling |

14. Slide the heat shrink tube over the combined unit so it evenly covers the switch, connector, and exposed wires.

15. Using a heat gun, heat shrink the tube to seal the assembled connection by slowly moving the heat source the length of the tube while rotating the unit (Fig. 3).

Important Do not use a heat source more powerful than a heat gun. A torch, for example, can melt the heat shrink tubing and the plastic switch as well; possibly damaging the switch.

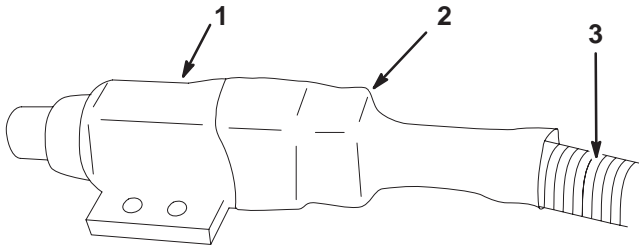

m-6948

Figure 3

- | | |
|-------------------|------------|
| 1. Switch | 3. Cabling |
| 2. Tubing, shrunk | |

Note: Use care when performing this step. Keeping the heat source in one area for too long could damage the switch, and not shrinking the tubing completely could allow foreign debris to enter the switch connection causing it to fail.

16. After allowing the unit to cool, replace the switch and cabling to its original position in the pedal box.
17. Place the tapped plate under the pedal box, aligning the holes in the pedal box and the plate.

18. Mount the switch using 2 screws (3/8 x 5/8 inch) and the tapped plate to secure it to the pedal box.

Note: The pedal switch can be mounted using rivets if desired.

Completing the Installation

1. Install the metal plate surrounding the pedals.
2. Install the floor mat if necessary.
3. Reconnect the negative (-) battery terminal.