



Towing Bracket Kit

13-32G and 13-32H Rear Engine Riding Mowers

Model No. 107-2206

Form No. 3350-304

Installation Instructions

Save these instructions with your *Operator's Manual* for future reference.

Contents of the Kit

DESCRIPTION	QUANTITY
Towing bracket	1
Locknuts	2
Washers	2
Bolts	2

Installing the Towing Bracket

1. Park the machine on a level surface.
2. Disengage the blade (PTO).
3. Shift the ground speed lever into Neutral and set the parking brake.
4. Stop the engine, wait for all moving parts to stop, and remove the ignition key.
5. Pull the collection rod forward to tilt the collection bin.
6. Prop up the collection bin.

7. Remove the existing locknut and washer from **behind** the rear plate, but do not remove the existing bolt, washer, and latch on the opposite side (Fig. 1).

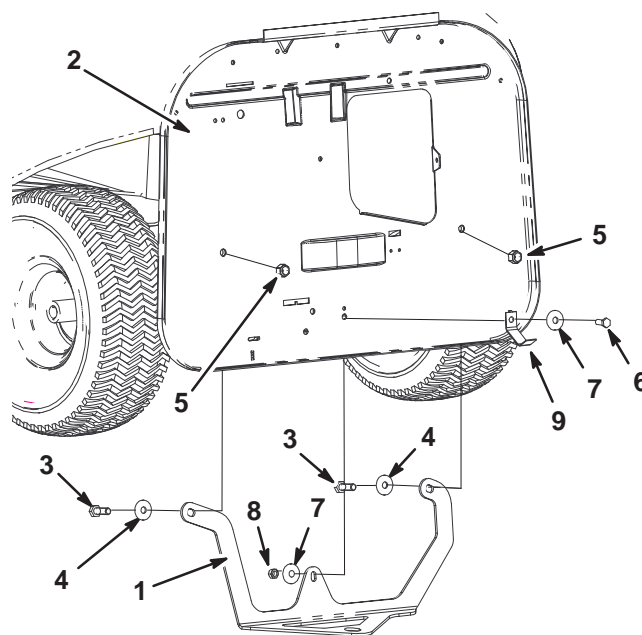

Figure 1

- | | |
|-----------------------|-----------------------|
| 1. Towing bracket | 6. Bolt (existing) |
| 2. Rear plate | 7. Washer (existing) |
| 3. Bolt (from kit) | 8. Locknut (existing) |
| 4. Washer (from kit) | 9. Latch |
| 5. Locknut (from kit) | |

Note: The collection bin is not shown for the purpose of clarity.

8. Install the towing bracket **behind** the rear plate onto the existing bolt as shown in Figure 1 and secure it with the washer and locknut you removed in step 7.
9. Secure the ends of the towing bracket with the 2 bolts, 2 washers, and 2 locknuts provided in the kit as shown in Figure 1.
10. Return the collection bin and the collection rod to the operating position.