



Windshield Washer Fluid Kit

2015 and after Workman® GTX/HDX/MD/HD Series Utility Vehicle

Model No. 130-5615

Installation Instructions

Installation

Loose Parts

Use the chart below to verify that all parts have been shipped.

Description	Qty.	Use
No parts required	–	Prepare the machine.
Washer-fluid tank	1	Install the windshield washer fluid kit (GTX-series models).
Washer bottle mount bracket	1	
Washer-fluid hose	1	
Locknut (5/16 inch)	4	
Carriage bolt (5/16 x 3/4 inch)	4	
Wire harness	1	
Male straight fitting	1	
Female straight fitting	1	
Flange-head screw (1/4 x 5/8 inch)	4	
Locknut (1/4 inch)	4	
Washer-fluid tank	1	Install the windshield washer fluid kit (HD-series models).
Washer bottle mount bracket	1	
Washer fluid hose	1	
Carriage bolt (5/16 x 3/4 inch)	2	
Locknut (5/16 inch)	2	
Carriage bolt (1/4 x 1-1/4 inch)	2	
Strap	1	
Spacer (1/4 inch)	2	
Locknut (1/4 inch)	2	
Barbed hose connector	1	
Wire harness	1	
Push fastener	8	
Washer-fluid tank	1	Install the windshield washer fluid kit (MD-series models).
Washer bottle mount bracket	1	
Washer fluid hose	1	
Locknut (5/16 inch)	2	
Carriage bolt (5/16 x 3/4 inch)	2	
Barbed hose connector	1	
Wire harness	1	
Push fastener	3	
Cable tie	1	

Note: The loose parts are packaged in 3 model-specific bags, each clearly labeled, along with 1 bag that contains common parts.



Preparing the Machine

1. Park the machine on a level surface and set the parking brake.
2. Raise the hood; refer to your *Operator's Manual*.
3. Raise the cargo box; refer to your *Operator's Manual*.
4. Shut off the engine and remove the key.
5. Disconnect the negative-battery cable; refer to your *Operator's Manual*.
6. Select the loose parts bag for your model and locate the common parts bag. Discard the unused parts bags.

Installing the Windshield Washer Fluid Kit

For GTX-Series Models

Installing the Washer-Fluid Tank

For Machines with the Storage Box Kit Installed

If you have the Storage Box Kit installed, discard the washer bottle bracket mount.

1. Install the washer-fluid tank to the storage box with the 4 flange-head screws (1/4 x 5/8 inch) and the 4 locknuts (1/4 inch) as shown in [Figure 1](#).

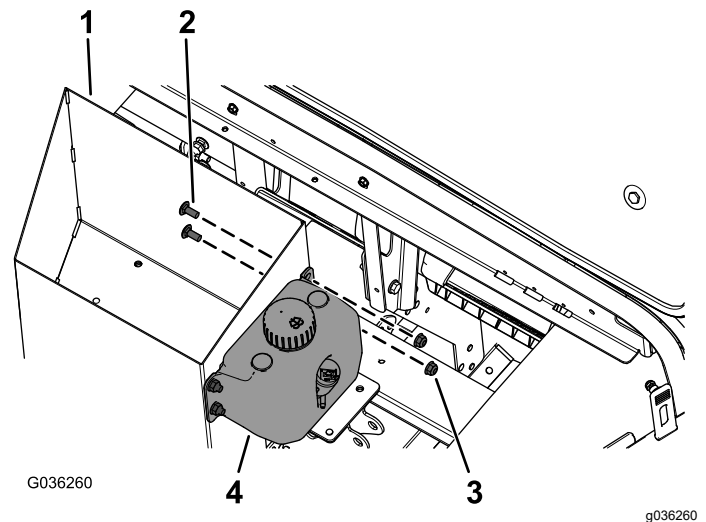

Figure 1

- | | |
|---------------------------------|-----------------------|
| 1. Storage box | 3. Locknut (1/4 inch) |
| 2. Flange-head (1/4 x 5/8 inch) | 4. Washer-fluid tank |

2. Torque the locknuts to 1017 to 1243 N·cm (90 to 110 in·lb).

Installing the Washer-Fluid Tank

For Machine without the Storage Box Kit Installed

1. Install the washer-fluid tank to the washer bottle bracket mount with the 4 carriage bolts (5/16 x 3/4 inch) and 4 locknuts (5/16 inch) as shown in [Figure 2](#).

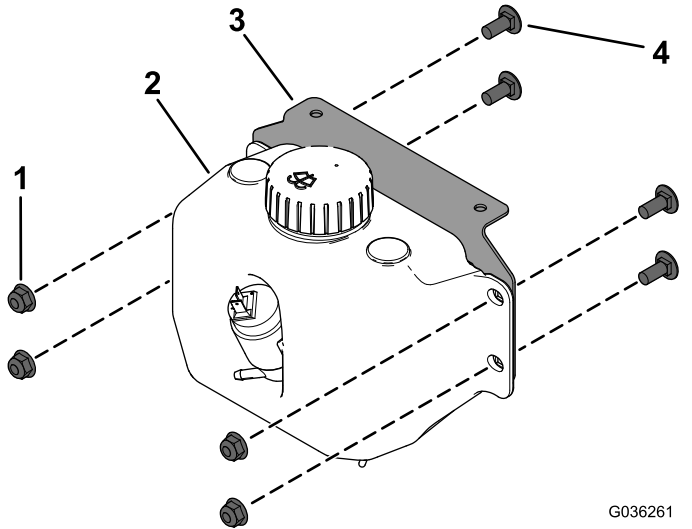

Figure 2

- | | |
|------------------------|------------------------------------|
| 1. Locknut (5/16 inch) | 3. Washer bottle bracket mount |
| 2. Washer-fluid tank | 4. Carriage bolt (5/16 x 3/4 inch) |

2. Torque the flange nuts (5/16 inch) to 1,987 to 2,542 N·cm (175 to 225 in·lb).
3. Install the washer bottle bracket mount to the dash reinforcement with the 2 flange-head screws (1/4 x 5/8 inch) and 2 locknuts (1/4 inch) as shown in [Figure 3](#).

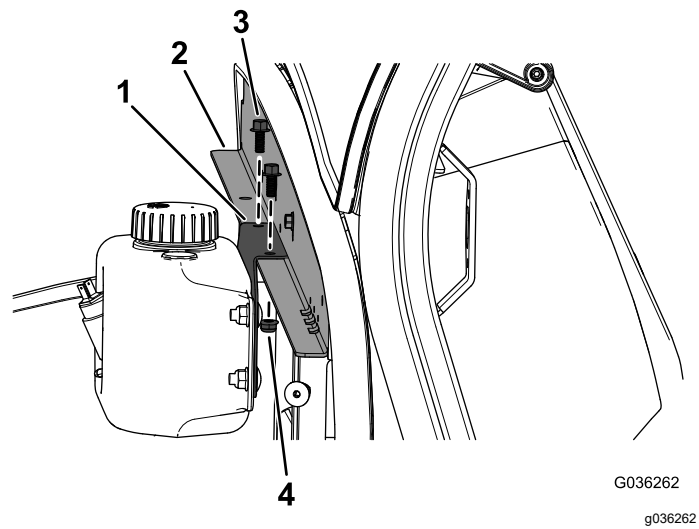

Figure 3

- | | |
|--------------------------------|---------------------------------------|
| 1. Washer bottle bracket mount | 3. Flange-head screw (1/4 x 5/8 inch) |
| 2. Dash reinforcement | 4. Locknut (1/4 inch) |

4. Torque the locknuts (1/4 inch) to 1,017 to 1,243 N·cm (90 to 110 in·lb).

Routing and Connecting the Hose

1. Raise the machine with jack stands.
2. Connect the female straight fitting to the cab hose and the male straight fitting to the kit hose ([Figure 4](#)).

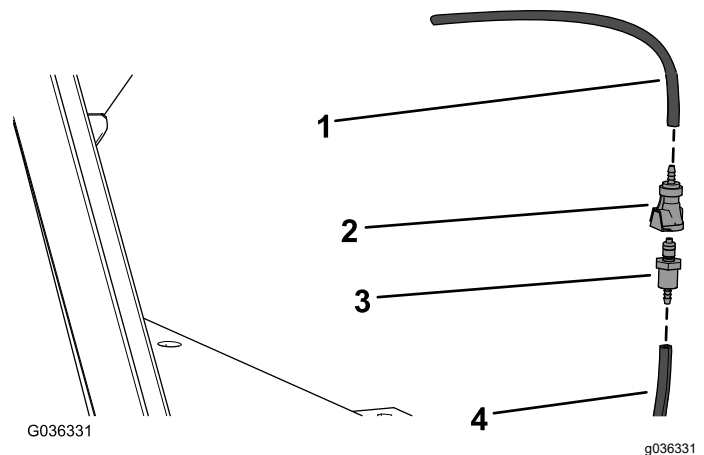

Figure 4

- | | |
|----------------------------|--------------------------|
| 1. Cab hose | 3. Male straight fitting |
| 2. Female straight fitting | 4. Kit hose |

3. Connect the female straight fitting on the kit hose to the male straight fitting on the cab hose ([Figure 5](#)).

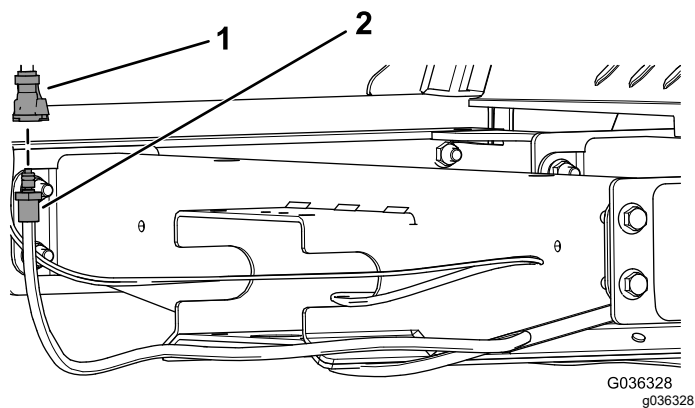

Figure 5

- 1. Female straight fitting
- 2. Male straight fitting

- 4. Route the kit hose along the floor-channel plate and through the opening in frame channel (Figure 6).

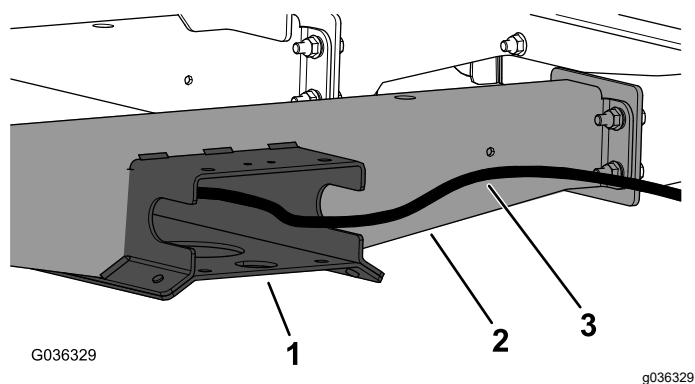

Figure 6

- 1. Frame channel
- 2. Floor-channel plate
- 3. Kit hose

- 5. Route the kit hose through the opening in the top of the frame channel (Figure 7).

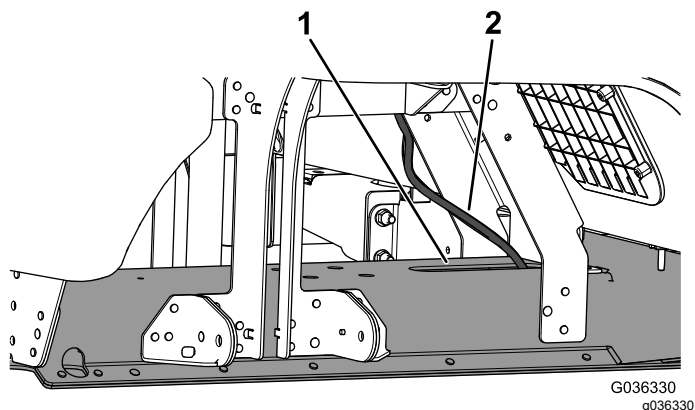

Figure 7

- 1. Frame channel
- 2. Kit hose

- 6. Secure the kit hose along the frame channel and as necessary.

- 7. Connect the kit to the pump; refer to [Connecting the Hose to the Pump](#) (page 5).

Connecting the Hose to the Pump

1. At the washer-fluid tank, align the end of the hose to the barbed fitting in the washer pump (Figure 8).

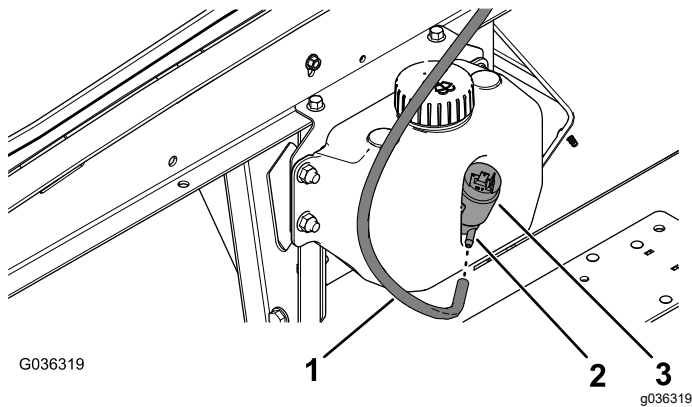

Figure 8

1. Hose
2. Barbed fitting
3. Washer-pump motor

2. Push the hose onto the fitting until the hose fully seats onto the fitting (Figure 8).

Note: If the hose is too long, shorten it.

Routing and Connecting the Kit Wire Harness to the Cab Wire Harness

1. Connect the male connector on the kit wire harness to the female connector on the cab wire harness (Figure 9).

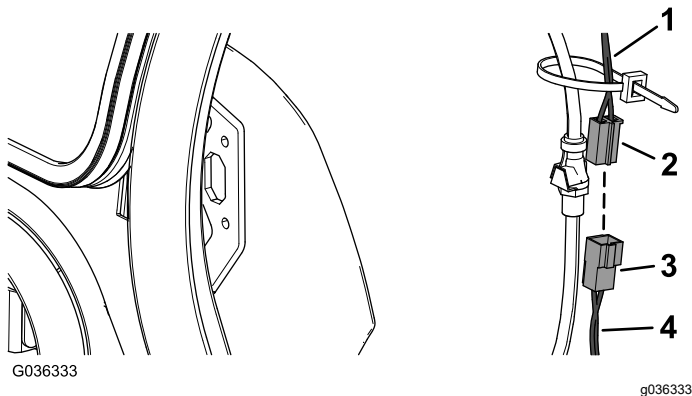

Figure 9

1. Cab wire harness
2. Female connector
3. Male connector
4. Kit wire harness

2. Route the kit wire harness along the floor-channel plate and through the opening in frame channel (Figure 10).

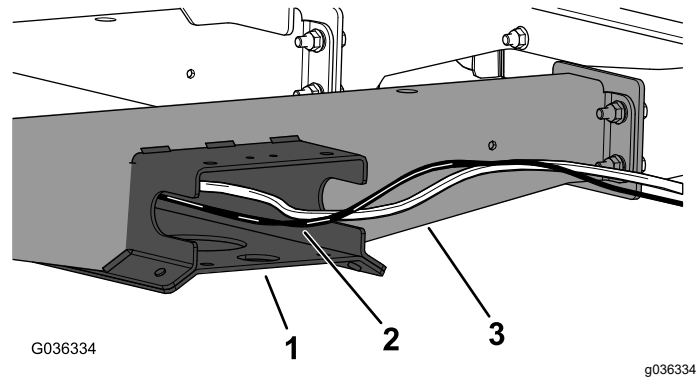

Figure 10

1. Frame channel
2. Kit wire harness
3. Floor-channel plate

3. Route the kit wire harness through the opening in the top of the frame channel (Figure 11).

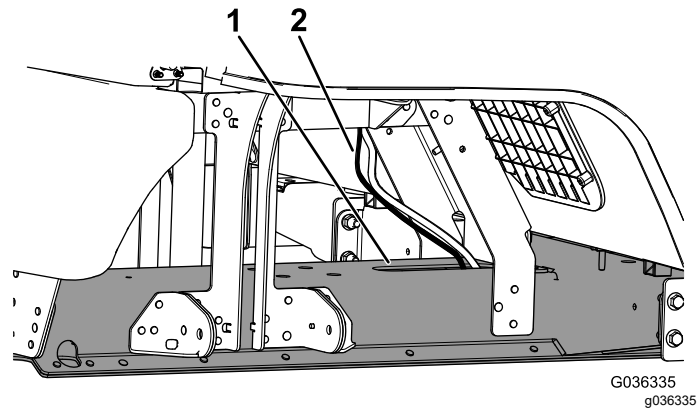

Figure 11

1. Frame channel
2. Kit wire harness

4. Secure the kit wire harness along the frame channel and as necessary.

Connecting the Kit Wire Harness to the Washer Pump

1. Align the 2-socket connector of the wire harness to the 2-blade connector of the washer pump (Figure 12).
2. Push the wire-harness connector onto the pump until the connector fully seats (Figure 12).

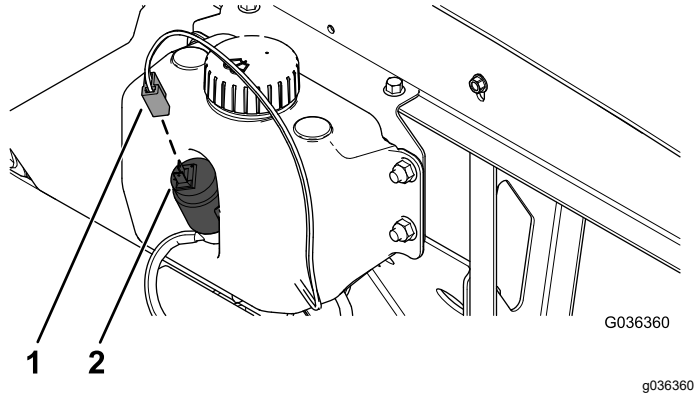

Figure 12

1. 2-socket connector (wire harness)
2. 2-blade connector (washer pump)

Connecting the Battery

1. Connect the negative-battery cable; refer to your *Operator's Manual*.
2. Lower the cargo box and close the hood; refer to your *Operator's Manual*.

Installing the Windshield Washer Fluid Kit

For HD-Series Models

Removing the Roof Panel

Roof panel weight: 9.5 kg (21 lb)

1. Remove the 10 bolts (1/4 x 1 inch) and 10 sealing washers (1/4 inch) that secure the roof panel to the roof-support brackets of the cab (Figure 13).

Note: Retain the bolts and washers for installation of the roof panel in [Installing the Overhead Console Plug and the Roof Panel](#) (page 13).

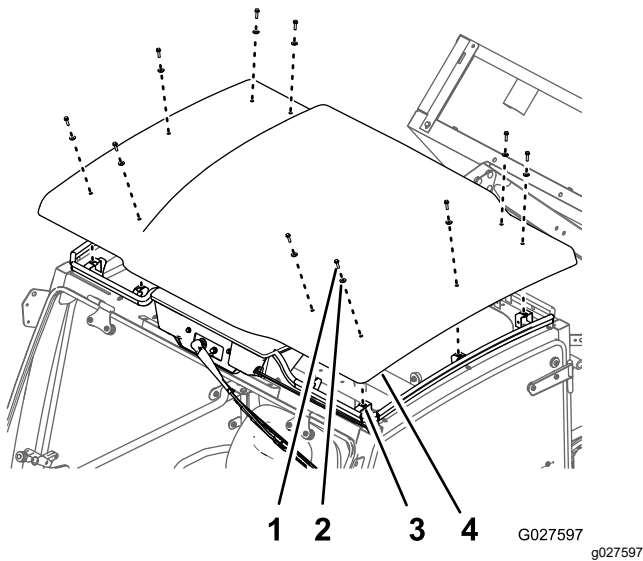

Figure 13

1. Bolt (1/4 x 1 inch)
2. Sealing washer (1/4 inch)
3. Roof-support bracket
4. Roof panel

2. Lift the roof panel straight up and remove it from the cab of the machine.

Note: Be careful when you set the roof panel down to avoid damaging the surface and edges of the panel.

3. Remove the plug from the overhead console (Figure 14).

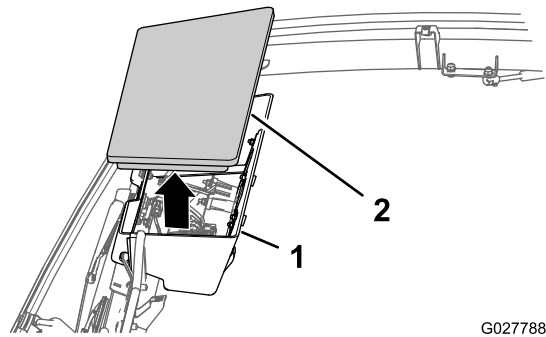

Figure 14

1. Overhead console
2. Plug

Installing the Washer-Fluid Tank

1. Assemble the washer-fluid tank to the washer bottle bracket-mount with the 2 carriage bolts (5/16 x 3/4 inch) and 2 locknuts (5/16 inch) as shown in Figure 15.

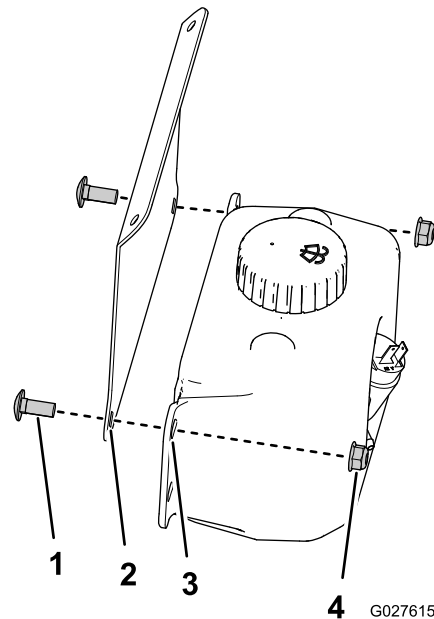

Figure 15

1. Carriage bolt (5/16 x 3/4 inch)
2. Hole—square (tank support bracket for HD-series)
3. Hole (washer fluid tank)
4. Locknut (5/16 inch)

2. Torque the locknuts to 1,987 to 2,542 N·cm (175 to 225 in·lb).

3. Locate the 2 holes 6.3 mm (1/4 inch) at the center of the rear panel of the cab (Figure 16).

Note: The holes are spaced apart 178 mm (7 inches).

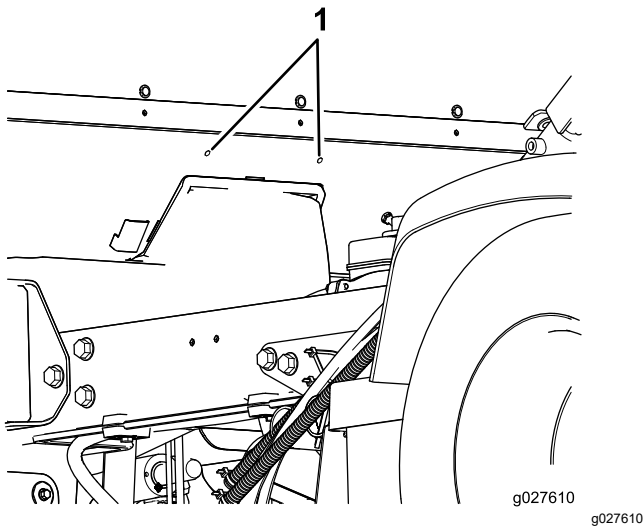

Figure 16

1. Holes—6.3 mm (1/4 inch)

4. Use an awl or punch to open a hole through the interior foam panel (Figure 17) at the hole locations that you identified in step 3.

Note: Use caution when working with sharp awl or punch.

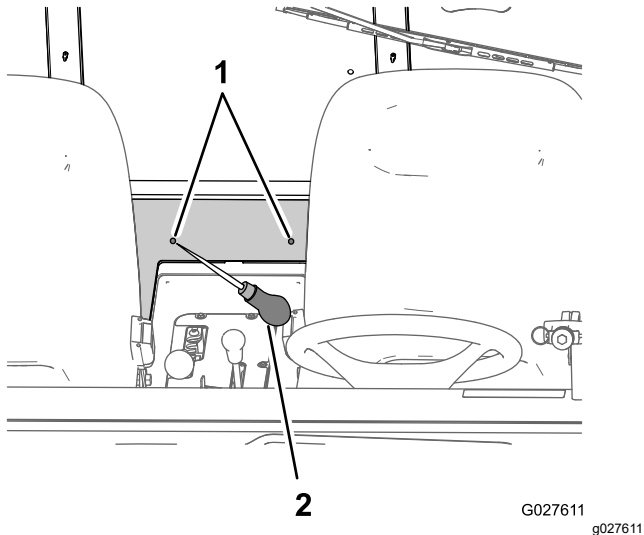

Figure 17

1. Hole locations 6.3 mm (1/4 inch)—interior foam panel
2. Awl or punch

5. Assemble the 2 carriage bolts (1/4 x 1-1/4 inches), strap, and 2 spacers (1/4 inch) to the holes that you made in the interior foam panel (Figure 18).

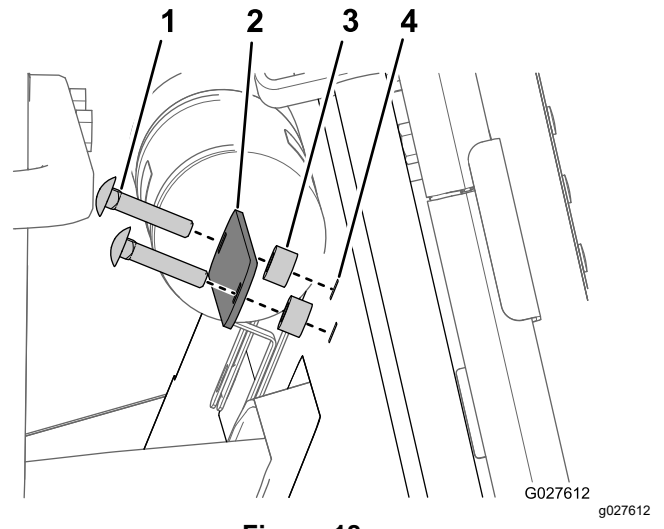

Figure 18

1. Carriage bolt (1/4 x 1-1/4 inches)
2. Strap
3. Spacer (1/4 inch)
4. Hole location 6.3 mm (1/4 inch)—interior foam panel

6. Assemble the washer bottle bracket mount and washer-fluid tank (Figure 19) onto the 2 carriage bolts (1/4 x 1-1/4 inches) with the 2 locknuts (1/4 inch).

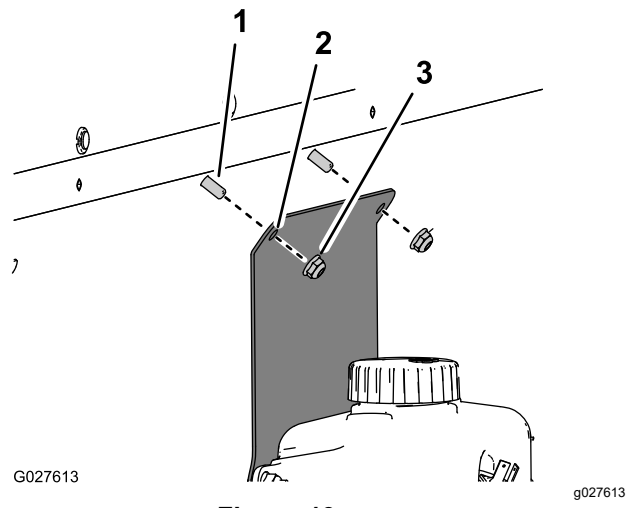

Figure 19

1. Carriage bolt (1/4 x 1-1/4 inches)
2. Hole (washer bottle bracket mount)
3. Locknut (1/4 inch)

7. Torque the flanged locknuts to 1,017 to 1,243 N·cm (90 to 110 in-lb).

Connecting the Hose to the Wiper

1. At the overhead console, route 1 end of the hose through the hole in the overhead console (Figure 20).

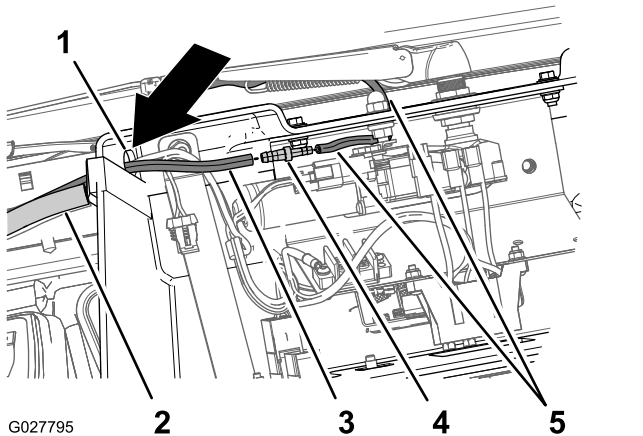

Figure 20

- | | |
|----------------------------|------------------------|
| 1. Hole (overhead console) | 4. Barbed hose fitting |
| 2. Bulb seal | 5. Hose (wiper arm) |
| 3. Hose | |

2. Insert the small end of the barbed hose fitting into the end of the hose from the wiper arm until the fitting fully seats (Figure 20).
3. Insert the large end of the barbed hose fitting to the end of the hose until the fitting fully seats (Figure 20).

Routing the Hose

1. Route the hose to the left of the overhead console along the bulb seal at the front of the cab frame (Figure 21).

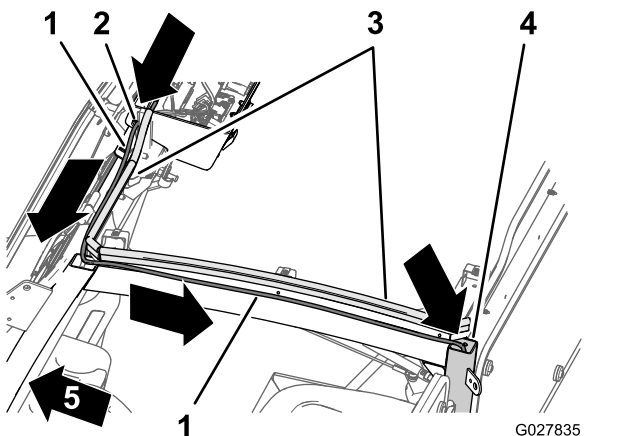

Figure 21

- | | |
|----------------------------|-------------------------|
| 1. Hose | 4. Pillar B (cab frame) |
| 2. Hole (overhead console) | 5. Front of the machine |
| 3. Bulb seal | |

2. Route the hose rearward along the left frame channel of the cab (Figure 21).
3. Route the free end of the hose into the opening at the top of the driver's side pillar B of the cab frame, and down through the frame (Figure 22).

Note: Use a stiff piece of wire, about 173 cm (68 inch) long, to pull (fish) the hose through pillar B of the cab frame.

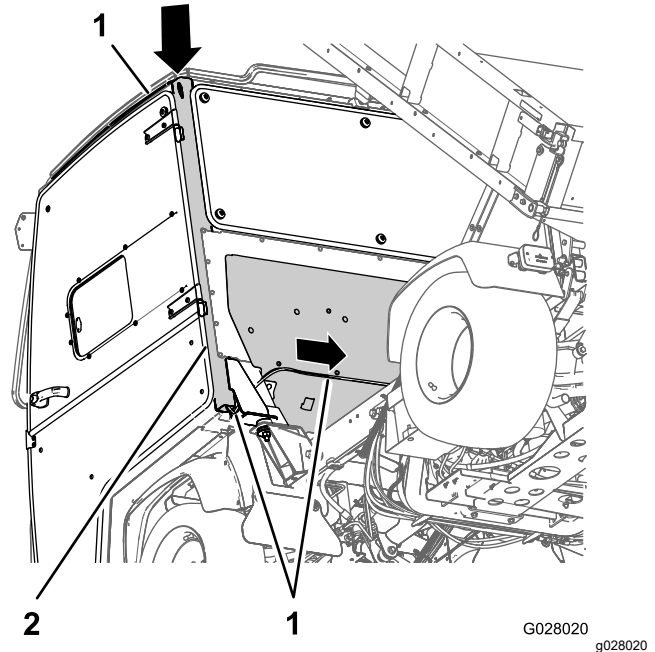

Figure 22

- | | |
|---------|-------------------------|
| 1. Hose | 2. Pillar B (cab frame) |
|---------|-------------------------|

4. Route the free end of the hose across the back of the cab, and align the hose with the barbed fitting in the washer pump (Figure 23).

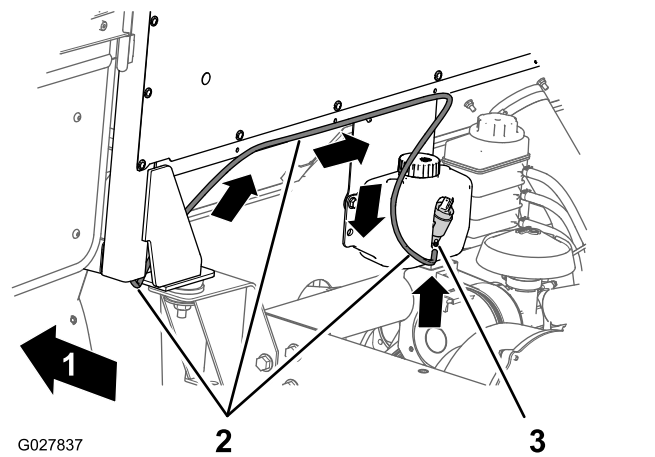

Figure 23

- | | |
|-------------------------|---------------------------------|
| 1. Front of the machine | 3. Barbed fitting (washer pump) |
| 2. Hose | |

Connecting the Hose to the Pump

1. At the washer-fluid tank, align the end of the hose to the barbed fitting in the washer pump (Figure 24).

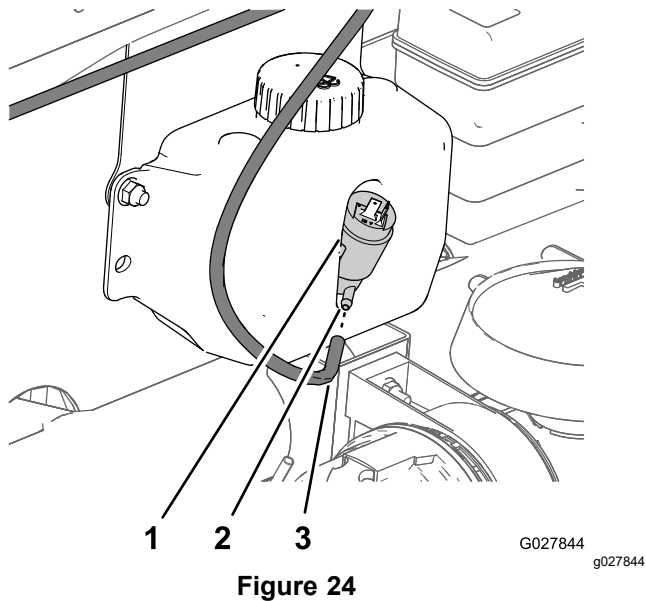

Figure 24

1. Washer-pump motor
2. Barbed fitting
3. Hose

2. Push the hose onto the fitting until the hose fully seats onto the fitting (Figure 24).

Note: If the hose is too long, shorten it in step 9 of [Securing the Wire Harness and Hose \(page 12\)](#).

Connecting the Wire Harness at the Overhead Console

1. At the overhead console, route the 2-pin connector end of the wire harness for the washer pump through the hole in the overhead console (Figure 25).

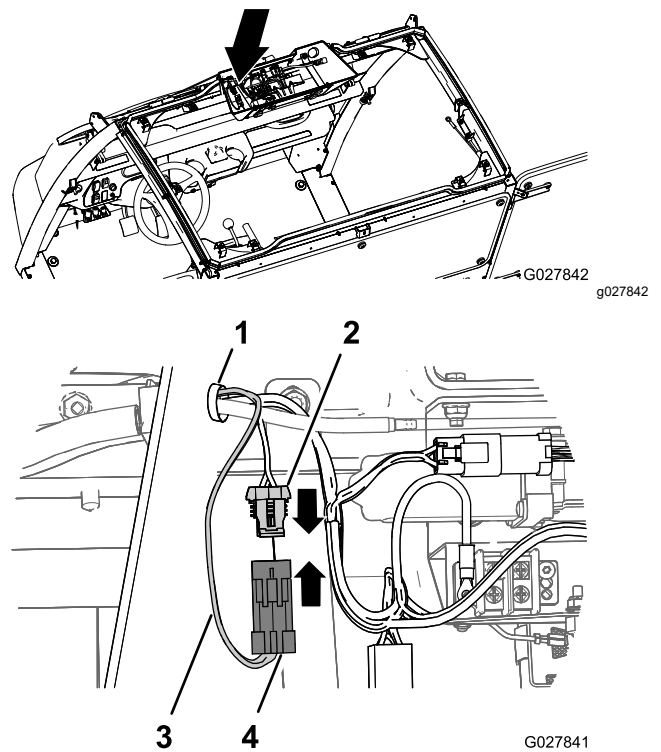

Figure 25

1. Hole (overhead console)
2. 2-socket connector (cab wire harness)
3. Washer pump wire harness
4. 2-pin connector (washer pump wire harness)

2. Align the 2-pin connector of the washer pump wire harness to the 2-socket connector of the cab wire harness (Figure 25).
3. Push the 2 connectors together until the connector lock snaps secure (Figure 25).
4. Route the 2-socket connector of the wire harness for the washer pump to the left of the overhead console along the bulb seal at the front of the cab frame (Figure 25).

Routing the Wire Harness

- At the overhead console, route the wire harness for the washer pump (Figure 26) to the left and along side of the hose installed in Routing the Hose (page 9).

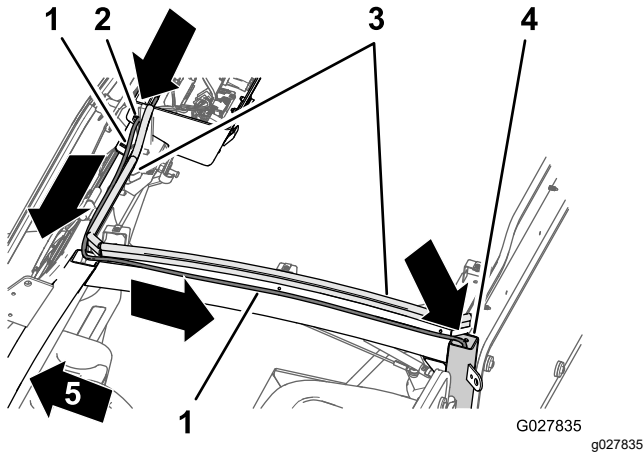

Figure 26

- | | |
|-----------------------------|-------------------------|
| 1. Washer pump wire harness | 4. Pillar B (cab frame) |
| 2. Hole (overhead console) | 5. Front of the machine |
| 3. Bulb seal | |

- Route the wire harness rearward along the left frame channel of the cab (Figure 26).
- Route the 2-socket connector of the wire harness into the opening at the top of the driver's side pillar B of the cab frame and down through the frame (Figure 27).

Note: Use a stiff piece of wire, about 173 cm (68 inch) long, to pull the wire harness through pillar B of the cab frame.

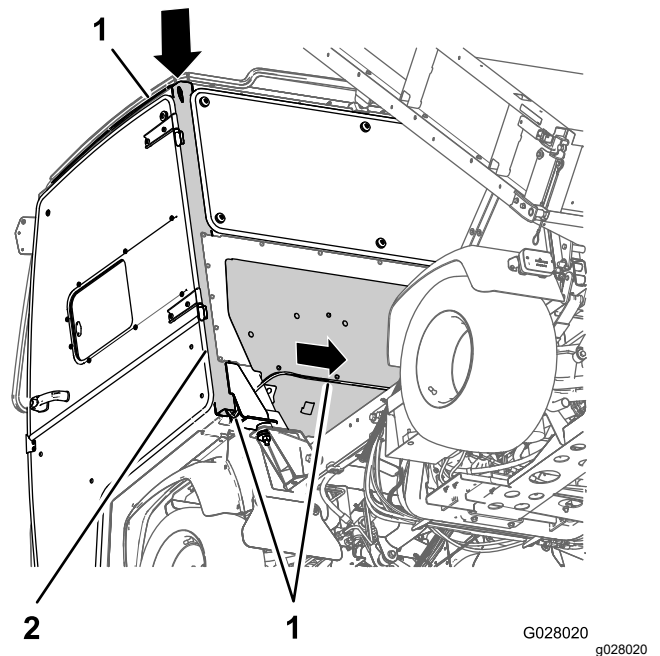

Figure 27

- | | |
|-----------------------------|-------------------------|
| 1. Washer pump wire harness | 2. Pillar B (cab frame) |
|-----------------------------|-------------------------|

- Route the wire harness for the washer pump across the back of the cab, and aligned to the 2-blade connector in the washer-pump motor (Figure 28).

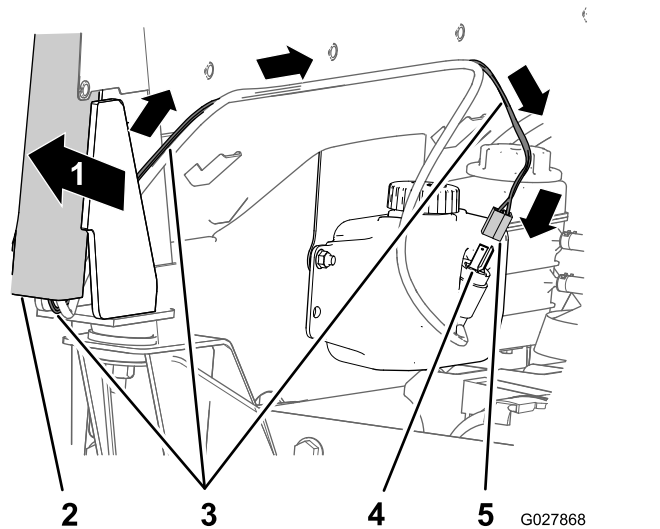

Figure 28

- | | |
|-----------------------------|--|
| 1. Front of the machine | 4. 2-blade connector (washer-pump motor) |
| 2. Pillar B (cab frame) | 5. 2-socket connector (washer pump wire harness) |
| 3. Washer pump wire harness | |

Connecting the Wire Harness to the Washer Pump

1. Align the 2-socket connector of the wire harness to the 2-blade connector of the washer pump (Figure 29).

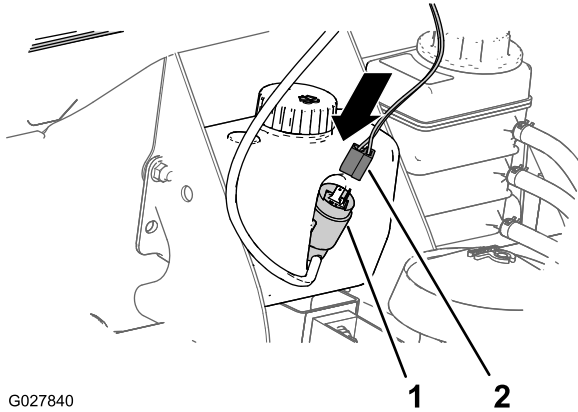

Figure 29

1. 2-blade connector (washer pump)
2. 2-socket connector (washer pump wire harness)

2. Push the wire-harness connector onto the pump until the connector fully seats (Figure 29).

Securing the Wire Harness and Hose

1. Remove the 2 harness clips that secure the cab wire harness to the front, left cab frame (Figure 30).

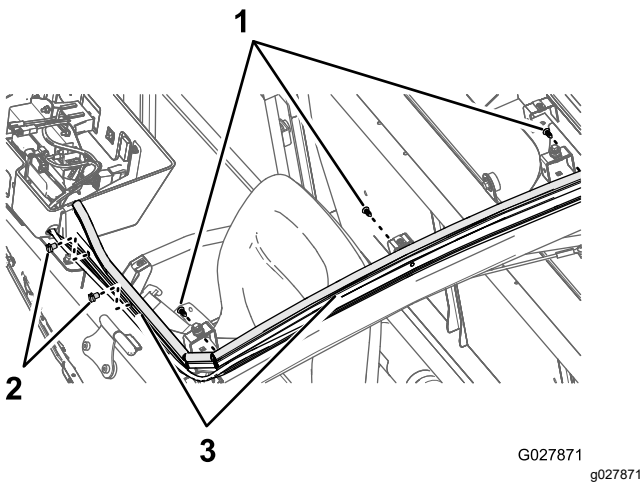

Figure 30

1. Push fasteners
2. Harness clips
3. Bulb seal

2. Install 2 push fasteners at the location where you removed the harness clips in step 1 (Figure 30 and Figure 31).

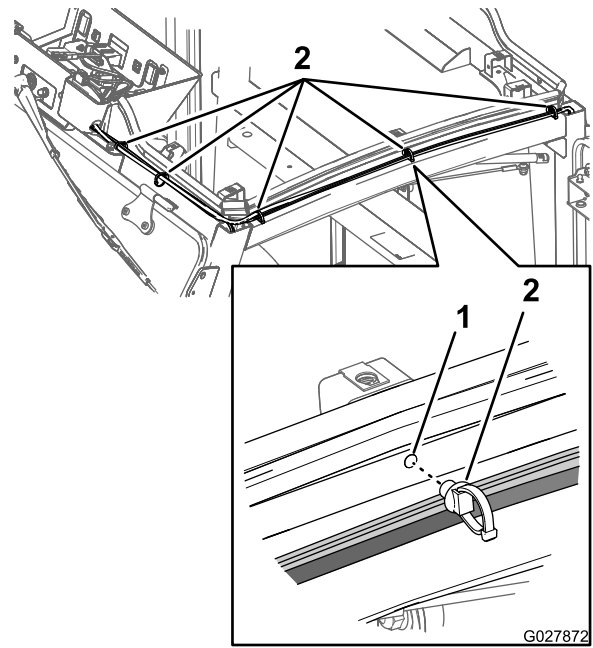

Figure 31

1. Hole (seal mount)
2. Push fasteners

3. Secure the cab harness, washer-pump harness, and hose with the cable tie portion of the push fasteners (Figure 31).

Note: Tighten the cable tie only snug. Do not pinch or collapse the hose.

4. Remove the 3 push fasteners above the driver's door frame (Figure 30).
5. Install 3 push fasteners at the location where you removed the push fasteners in step 4 (Figure 30 and Figure 31).
6. Secure the washer-pump harness and hose with the cable-tie portion of the push fasteners.
7. At the back of the cab, install 3 push fasteners into the 3 hole across the back panel of the cab (Figure 32).

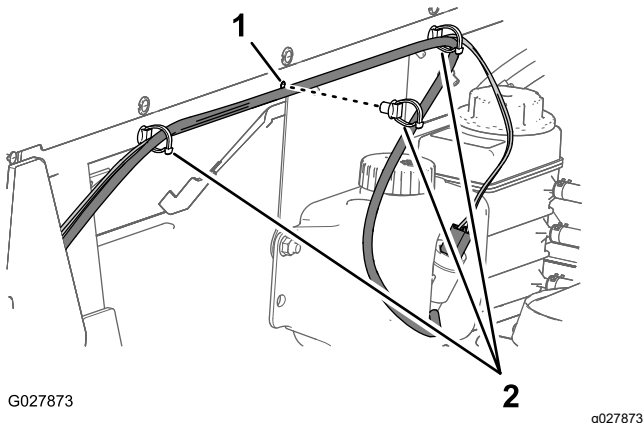

Figure 32

1. Hole (back cab panel)
2. Push fasteners

8. Secure the washer-pump harness and hose with the cable tie portion of the push fasteners.
9. If needed, shorten the hose as follows:
 - A. At the washer fluid tank, remove the hose from the barbed fitting at the pump (Figure 24).
 - B. Cut the hose to remove the excess hose length.
 - C. Push the hose onto the fitting until the hose fully seats onto the fitting (Figure 24).

Installing the Overhead Console Plug and the Roof Panel

1. Align the plug that you removed in step 3 of [Removing the Roof Panel \(page 7\)](#) with the top opening of the overhead console (Figure 14).
2. Push the plug down into the overhead console until it is seated (Figure 14).
3. Align the holes in the roof panel with the clip nuts at the brackets of the cab frame (Figure 13).
4. Assemble the roof panel to the cab frame with the 10 bolts (1/4 x 1 inch) and 10 sealing washers (1/4 inch) as shown in Figure 13 that you removed in step 1 of [Removing the Roof Panel \(page 7\)](#).
5. Torque the bolts to 520 to 678 N·cm (41 to 55 in-lb).

Connecting the Battery

1. Connect the negative-battery cable; refer to your *Operator's Manual*.
2. Lower the cargo box; refer to your *Operator's Manual*.

Installing the Windshield Washer Fluid Kit

For MD-Series Models

Removing the Roof Panel

Roof-panel weight: 9.5 kg (21 lb)

1. Remove the 10 bolts (1/4 x 1 inch) and 10 sealing washers (1/4 inch) that secure the roof panel to the roof-support brackets of the cab (Figure 33).

Note: Retain the bolts and washers for installation of the roof panel in [Installing the Overhead-Console Plug and the Roof Panel \(page 20\)](#).

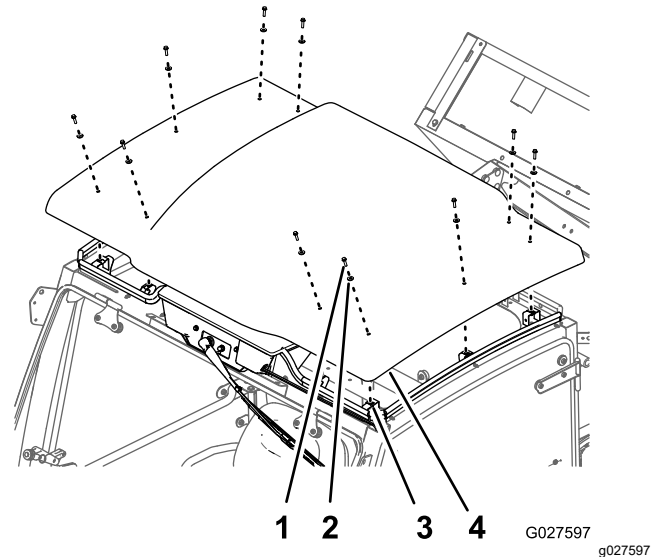

Figure 33

1. Bolt (1/4 x 1 inch)
2. Sealing washer (1/4 inch)
3. Roof-support bracket
4. Roof panel

2. Lift the roof panel straight up and remove it from the cab of the machine.

Note: Be careful when you set the roof panel down to avoid damaging the surface and edges of the panel.

3. Remove the plug from the overhead console (Figure 34).

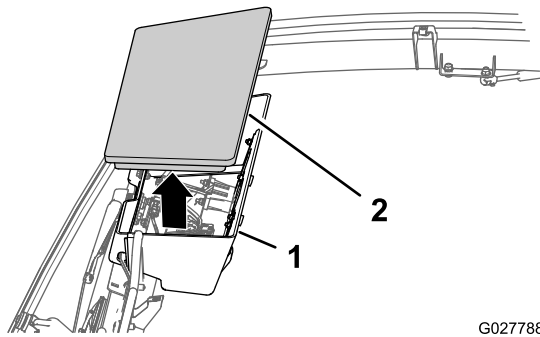

Figure 34

1. Overhead console 2. Plug

G027788 g027788

Installing the Washer-Fluid Tank

1. Assemble the washer-fluid tank to the washer bottle mount bracket with the 2 carriage bolts (5/16 x 3/4 inch) and 2 locknuts (5/16 inch) as shown in [Figure 35](#).

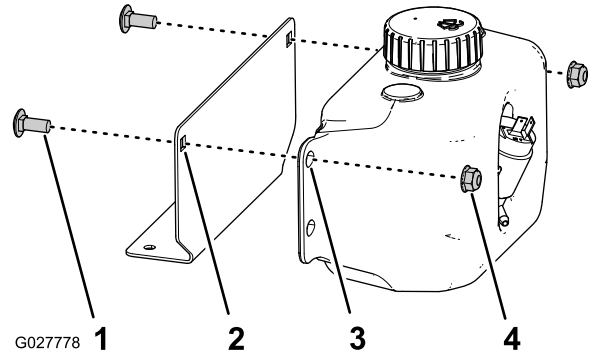

Figure 35

- | | |
|--|---------------------------------------|
| 1. Carriage bolt (5/16 x 3/4 inch) | 3. Hole (washer bottle mount bracket) |
| 2. Hole—square (tank support bracket for MD-series models) | 4. Locknut (5/16 inch) |

2. Torque the locknuts to 1,987 to 2,542 N-cm (175 to 225 in-lb).
3. At the lower headlight support, remove the 2 hex washer head bolts (1/4 x 7/8 inch), inboard of the right headlight, that secures the headlight brackets to the headlight ([Figure 36](#)).

Note: Retain the 2 hex washer head bolts (1/4 x 7/8 inch) for installation of the washer-fluid tank and washer bottle mount bracket.

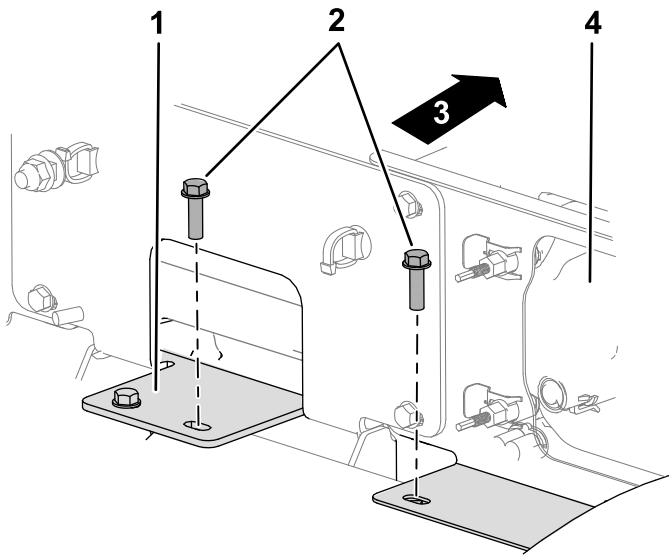

Figure 36

g444050

- | | |
|---|---------------------|
| 1. Bumper support bracket | 3. Front of machine |
| 2. Hex washer head bolts (1/4 x 7/8 inch) | 4. Right headlight |

-
4. Align the holes in the washer bottle mount bracket with the holes in the lower headlight support (Figure 37).

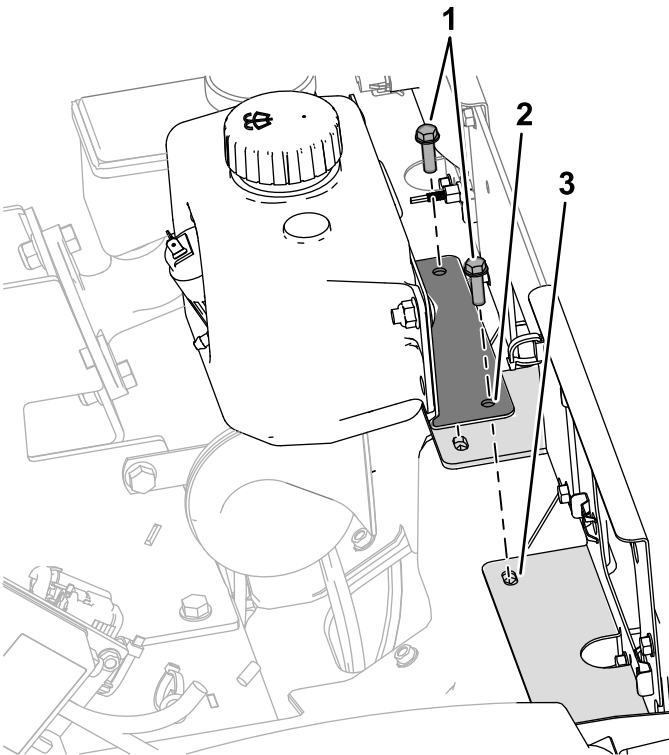

Figure 37

g444051

- | | |
|---|-----------------------------------|
| 1. Hex washer head bolts (1/4 x 7/8 inch) | 3. Hole (lower headlight support) |
| 2. Hole (tank-support bracket—MD-series models) | |

- Assemble the tank-support bracket to the lower headlight support with the 2 hex washer head bolts (1/4 x 7/8 inch) that were removed in step 3 (Figure 37).
- Torque the 2 bolts to 79 to 147 N·cm (7 to 13 in-lb).

Connecting the Hose to the Wiper

- At the overhead console, route 1 end of the hose through the hole in the overhead console (Figure 38)

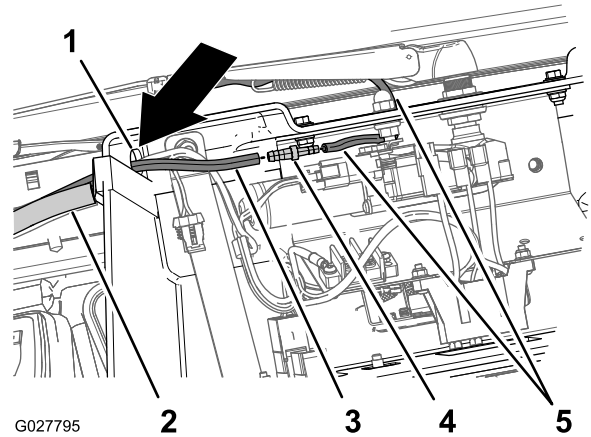

G027795

g027795

Figure 38

- | | |
|----------------------------|------------------------|
| 1. Hole (overhead console) | 4. Barbed hose fitting |
| 2. Bulb seal | 5. Hose (wiper arm) |
| 3. Hose | |

-
- Insert the small end of the barbed hose fitting into the end of the hose from the wiper arm until the fitting fully seats (Figure 38).
 - Insert the large end of the barbed hose fitting to the end of the hose until the fitting fully seats (Figure 38).

Routing the Hose

- Route the hose to the left of the overhead console along the bulb seal at the front of the cab frame (Figure 39).

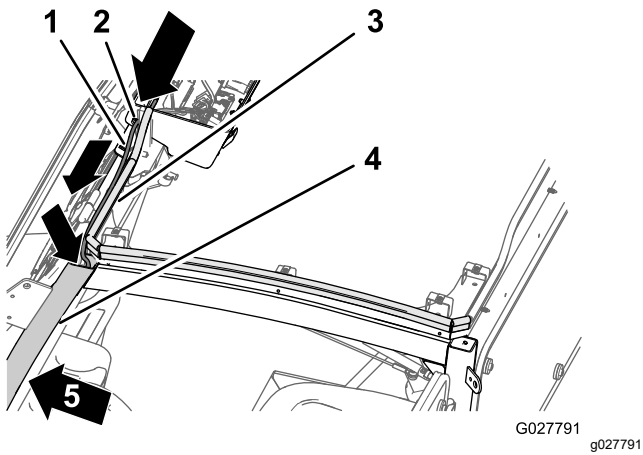

Figure 39

- | | |
|----------------------------|-----------------------------|
| 1. Hose | 4. Pillar A (driver's side) |
| 2. Hole (overhead console) | 5. Front of the machine |
| 3. Bulb seal | |

2. Route the free end of the hose into the opening at the top of pillar A (driver's side) of the cab frame and down to the hole at the bottom of the pillar (Figure 39 and Figure 40).

Note: The hole is about level with the midpoint in the dash

Note: Use a stiff piece of wire, about 130 cm (51 inch) long, to pull the hose through pillar A of the cab frame.

3. Route the free end of the hose forward, between the fender and the steering column (Figure 40 and Figure 41).

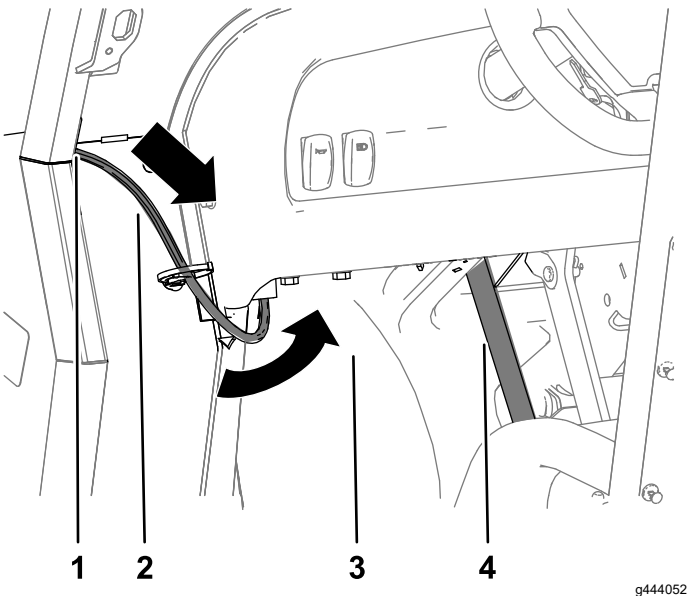

Figure 40

- | | |
|----------------------------------|--------------------|
| 1. Hole—pillar A (driver's side) | 3. Fender |
| 2. Hose | 4. Steering column |

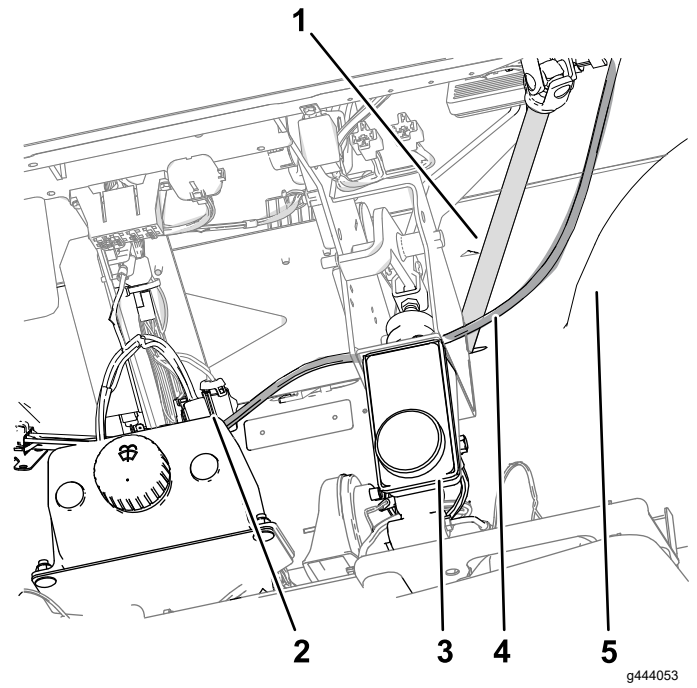

Figure 41

- | | |
|----------------------|-----------|
| 1. Steering column | 4. Hose |
| 2. Washer-fluid tank | 5. Fender |
| 3. Master cylinder | |

4. Route the free end of the hose inboard toward the washer-fluid tank (Figure 41).

Connecting the Wire Harness at the Overhead Console

1. At the overhead console, route the 2-pin connector end of the wire harness for the washer pump through the hole in the overhead console (Figure 42).

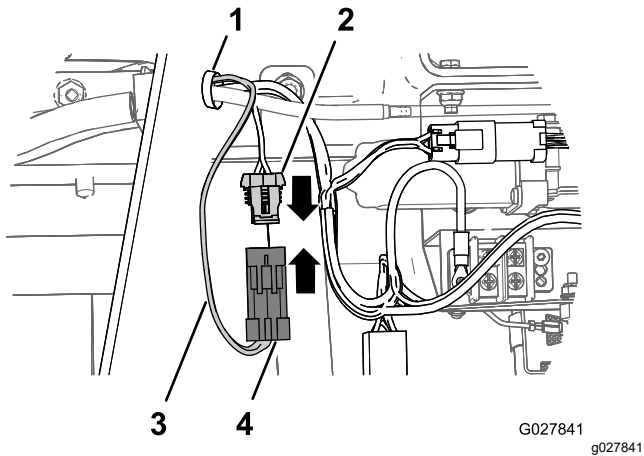
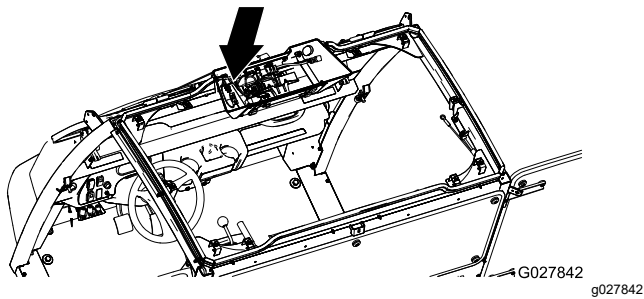

Figure 42

- | | |
|--|---|
| 1. Hole (overhead console) | 3. Washer pump wire harness |
| 2. 2-socket connector (cab wire harness) | 4. 2-pin connector (washer pump wire harness) |

2. Align the 2-pin connector of the washer pump wire harness to the 2-socket connector of the cab wire harness (Figure 42).
3. Push the 2 connectors together until the connector secures (Figure 42).
4. Route the 2-socket connector of the wire harness for the washer pump to the left of the overhead console along the bulb seal at the front of the cab frame (Figure 42).

Routing the Wire Harness

1. At the overhead console, route the wire harness for the washer pump (Figure 43) to the left and along side of the hose installed in Routing the Hose (page 15).

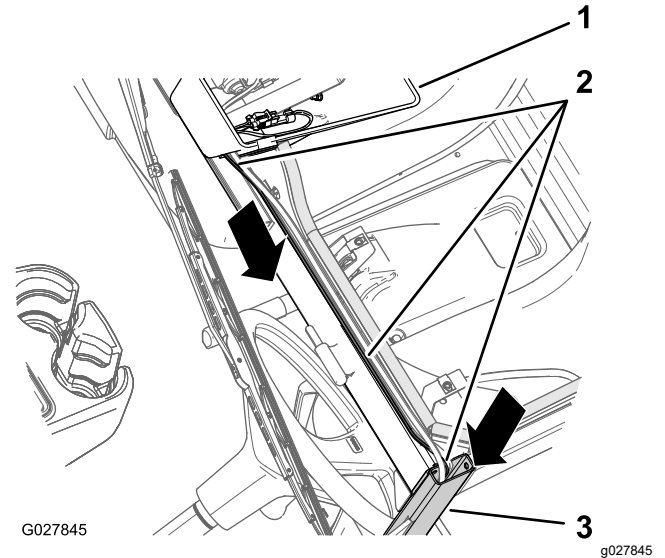

Figure 43

- | | |
|-----------------------------|-----------------------------|
| 1. Overhead console | 3. Pillar A (driver's side) |
| 2. Washer pump wire harness | |

2. Route the 2-socket connector of the wire harness into the opening at the top of pillar A (driver's side) of the cab frame and down to the hole at the bottom of the pillar (Figure 44).

Note: Use a stiff piece of wire, about 130 cm (51 inch) long, to pull the wire harness through pillar A of the cab frame.

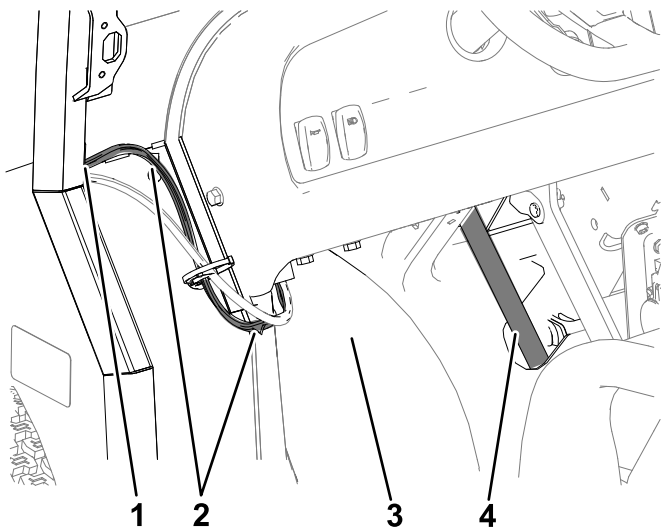

Figure 44

g444054

- | | |
|----------------------------------|--------------------|
| 1. Hole—pillar A (driver's side) | 3. Fender |
| 2. Washer pump wire harness | 4. Steering column |

3. Route the wire harness forward, between the fender and the steering column (Figure 44 and Figure 45).
4. Route the wire harness for the washer pump inboard toward the washer-fluid tank, and align the harness with the 2-blade connector on the washer-pump motor (Figure 45).

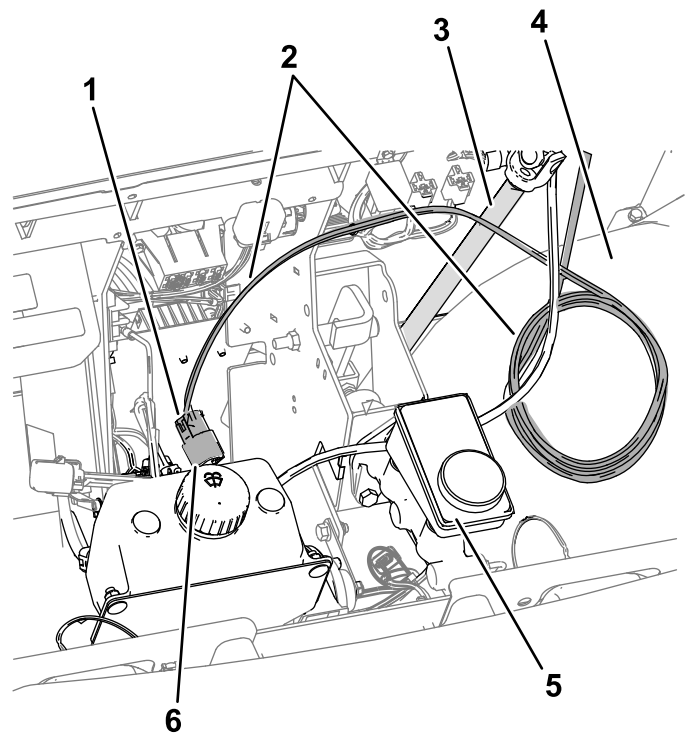

Figure 45

g444055

- | | |
|--|------------------------------------|
| 1. 2-socket connector (washer pump wire harness) | 4. Fender |
| 2. Washer pump wire harness | 5. Master cylinder |
| 3. Steering column | 6. 2-blade connector (washer pump) |

Connecting the Wire Harness to the Washer Pump

1. Align the 2-socket connector of the wire harness for the washer pump to the 2-blade connector of the washer pump (Figure 46).

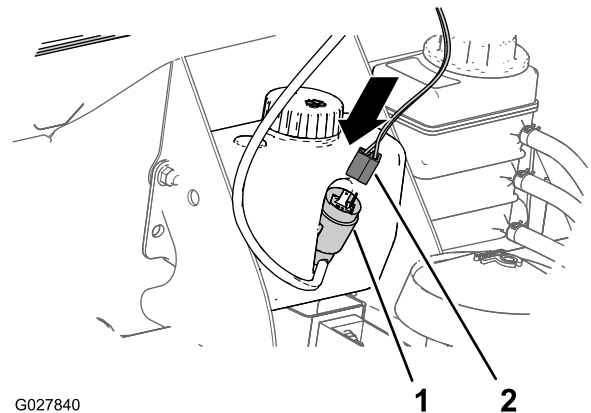

G027840

g027840

Figure 46

- | | |
|------------------------------------|--|
| 1. 2-blade connector (washer pump) | 2. 2-socket connector (washer pump wire harness) |
|------------------------------------|--|

2. Push the wire-harness connector onto the pump until the connector fully seats ([Figure 46](#)).

Securing the Wire Harness

1. Remove the 2 harness clips that secure the cab wire harness to the front, left cab frame ([Figure 47](#)).

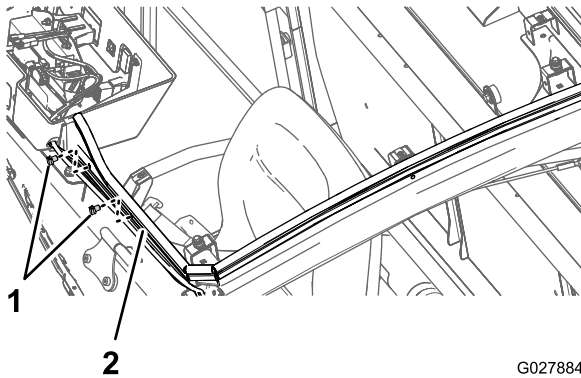

G027884
g027884

Figure 47

1. Harness clips
2. Cab frame

2. Install 2 push fasteners at the location where you removed the harness clips in step 1 ([Figure 47](#) and [Figure 48](#)).

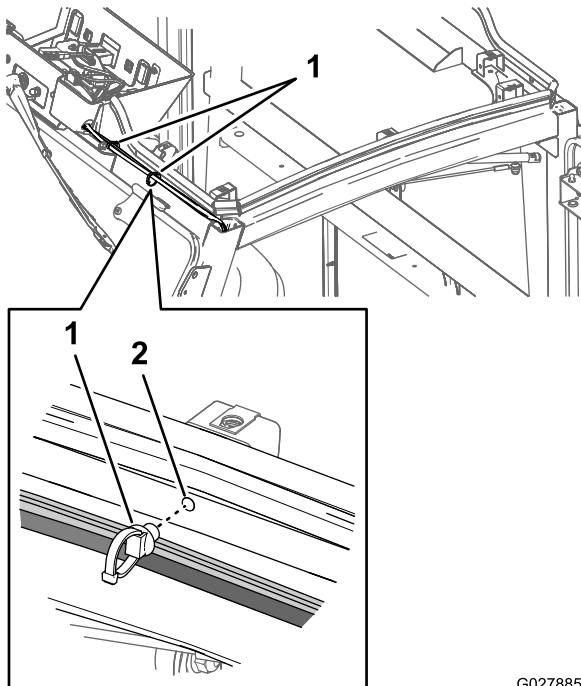

G027885
g027885

Figure 48

1. Push fastener
2. Hole (cab frame)

3. Secure the cab harness, washer-pump harness, and hose with the cable tie portion of the push fasteners ([Figure 48](#)).

Note: Tighten the cable tie only snug. Do not pinch or collapse the hose.

4. Remove the harness clip that secures the cab wire harness to the lower forward-cab panel at the driver's side of the machine ([Figure 49](#)).

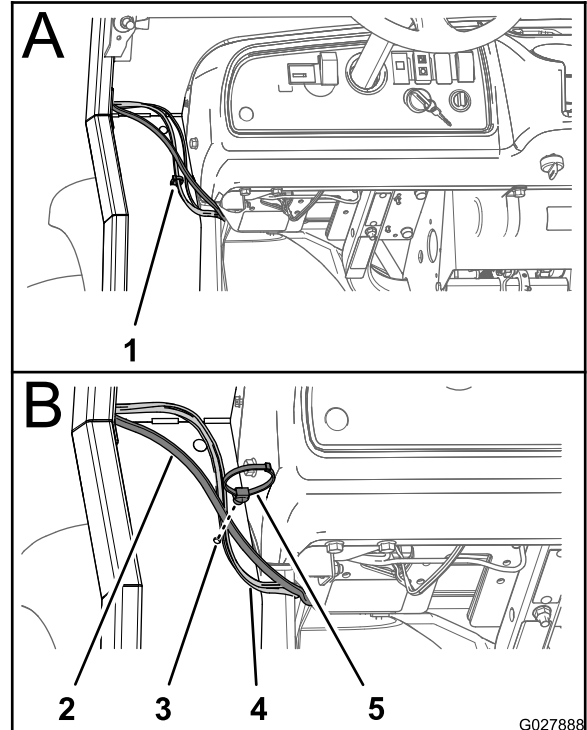

G027888

g027888

Figure 49

1. Harness clip
2. Hose
3. Hole (lower, forward cab panel)
4. Wire harnesses (cab harness and washer-pump harness)
5. Push fastener

5. Install a push fastener at the location where you removed the harness clip in step 4 ([Figure 49](#)).
6. Secure the cab harness, washer-pump harness, and hose with the cable tie portion of the push fastener ([Figure 49](#)).
7. Coil the excess washer-pump harness ([Figure 50](#)), and secure the coiled harness and hose with a cable tie.

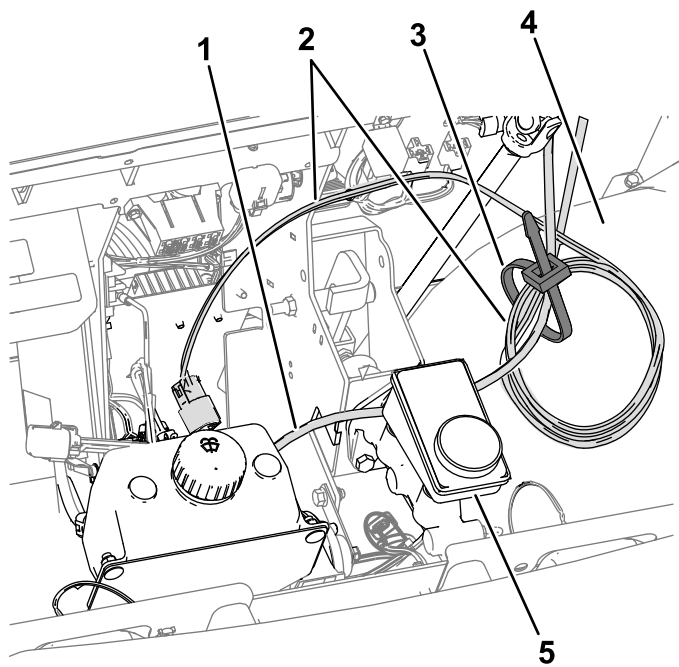

g444056

Figure 50

- | | |
|------------------------------------|--------------------|
| 1. Hose | 4. Fender |
| 2. Washer pump harness
(coiled) | 5. Master cylinder |
| 3. Cable tie | |

Installing the Overhead-Console Plug and the Roof Panel

1. Align the plug that you removed in step 3 of [Removing the Roof Panel \(page 13\)](#) with the top opening of the overhead console ([Figure 34](#)).
2. Push the plug down into the overhead console until it fully seats ([Figure 34](#)).
3. Align the holes in the roof panel with the clip nuts on the brackets of the cab frame ([Figure 33](#)).
4. Assemble the roof panel to the cab frame with the 10 bolts (1/4 x 1 inch) and 10 sealing washers (1/4 inch) as shown in [Figure 33](#) that you removed in step 1 of [Removing the Roof Panel \(page 13\)](#).
5. Torque the bolts to 520 to 678 N·cm (41 to 55 in-lb).

Connecting the Battery

1. Connect the negative-battery cable; refer to your *Operator's Manual*.
2. Lower the cargo box and close the hood; refer to your *Operator's Manual*.

Operation

Using the Windshield Washer

Using the Wiper/Washer Control

- Push the wiper/washer switch up to run the windshield wipers (Figure 51).

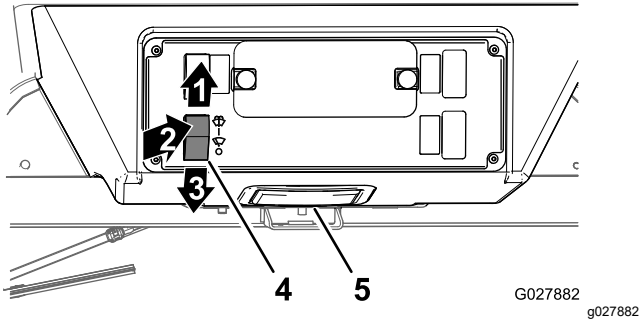

Figure 51

1. Wiper On
2. Washer On (momentary)
3. Wiper Off
4. Wiper/washer switch
5. Overhead console

- Push the wiper/washer switch down to stop the windshield wipers (Figure 51).
- Momentarily push in the upper half of the wiper/washer switch to spray the washer fluid onto the windshield (Figure 51).

Filling the Washer Tank

1. Access the washer tank as follows:
 - For HD-series Workman machines, raise the cargo bed and place the safety support on the lift cylinder; refer to your *Operator's Manual*.
 - For GTX-series and MD-series Workman machines, raise the hood; refer to your *Operator's Manual*.
2. Remove the cap from the washer tank (Figure 52).

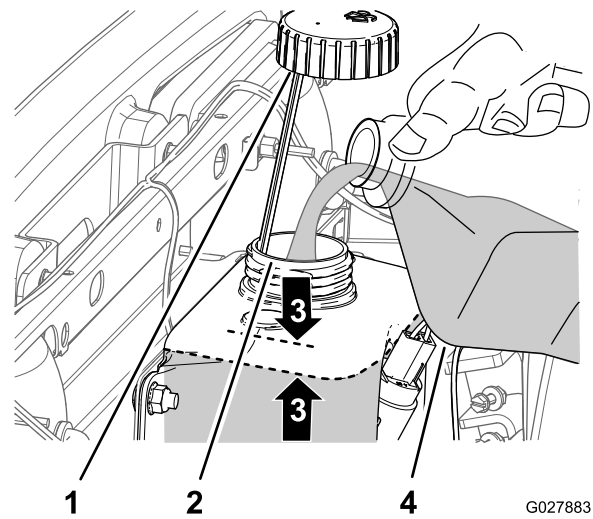

Figure 52

1. Cap
2. Filler neck (washer tank)
3. 25 mm (1 inch) fill level
4. Water or windshield-washer fluid

3. Add water or windshield-washer fluid through the filler neck of the tank to within 25 mm (1 inch) of the top of the tank (Figure 52).

Note: In climates where freezing temperatures occur, use all season (ethanol type) windshield-washer fluid.

4. Install the cap onto the filler neck securely (Figure 52).
5. Prepare the machine for operation as follows:
 - HD-series Workman machines— Remove the safety support from the bed lift cylinder, stow the safety support, and lower the bed; refer to your *Operator's Manual*.
 - GTX-series and MD-series Workman machines— Lower the hood and secure it with the hood latches; refer to your *Operator's Manual*.

Notes:

Declaration of Incorporation

Model No.	Serial No.	Product Description	Invoice Description	General Description	Directive
130-5615	None and Up	Windshield Washer Fluid Kit, 2015 and after Workman GTX/HDX/MD/HD Series Utility Vehicle	WASHER FLUID KIT [WORKMAN]	Utility Vehicle	2006/42/EC, 2004/108/EC

Relevant technical documentation has been compiled as required per Part B of Annex VII of 2006/42/EC.

We will undertake to transmit, in response to requests by national authorities, relevant information on this partly completed machinery. The method of transmission shall be electronic transmittal.

This machinery shall not be put into service until incorporated into approved Toro models as indicated on the associated Declaration of Conformity and in accordance with all instructions, whereby it can be declared in conformity with all relevant Directives.

Certified:



Tom Langworthy
Engineering Director
8111 Lyndale Ave. South
Bloomington, MN 55420, USA
May 23, 2023

Authorized Representative:

Marcel Dutrieux
Manager European Product Integrity
Toro Europe NV
Nijverheidsstraat 5
2260 Oevel
Belgium



Count on it.