



# Ultra Sonic Boom Finishing Kit

## Multi Pro 1750 Turf Sprayer

Model No. 164-1051

### Installation Instructions

Install the finishing kit along with the Sonic Boom Leveling Kit. Start with the Finishing Kit instructions first.

## 1 Preparing the Machine

Refer to your machine *Operator's Manual* for all safety information.

1. Park the machine on a level surface.
2. Engage the parking brake.
3. Shut off the engine and remove the key.

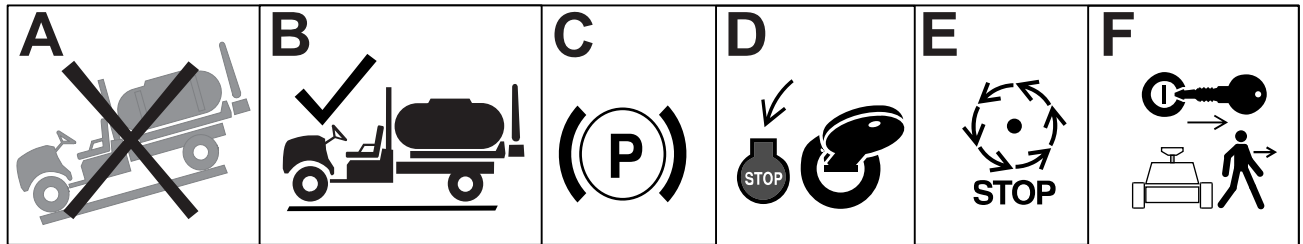

G036361s

4. Disconnect the battery.



# 2

## Installing the Manifold Bracket

1. Disconnect the wiring harness from the hydraulic manifold block.
2. Label all the hoses connected to the hydraulic manifold block and disconnect them from the block.

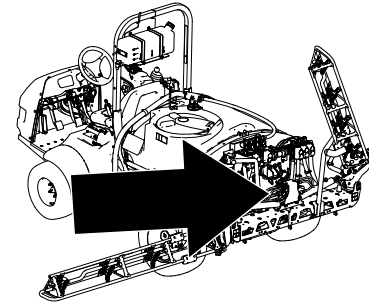

G572577

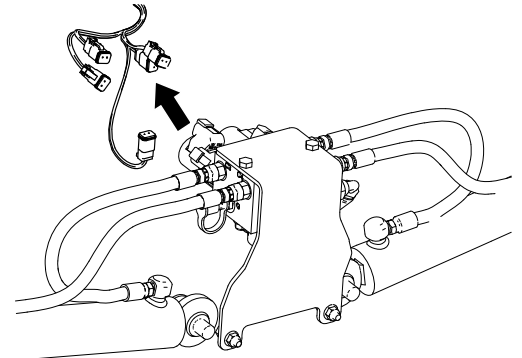

G572437

3. Remove the mounting bracket from the machine.

**Note:** Retain the fasteners.

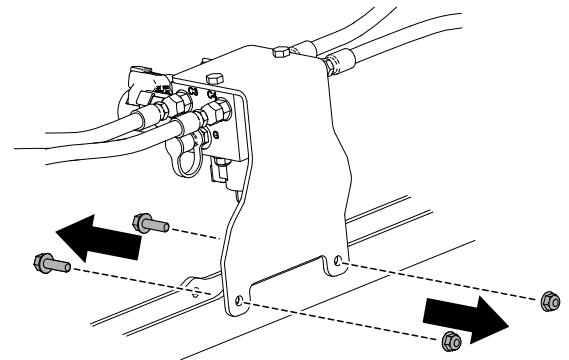

G576890

4. Remove the hydraulic manifold block from the mounting bracket.

**Note:** Retain the fasteners.

**Note:** The new bracket will be installed along with the electronic communications unit in the *Sonic Marker Leveling Kit* instructions.

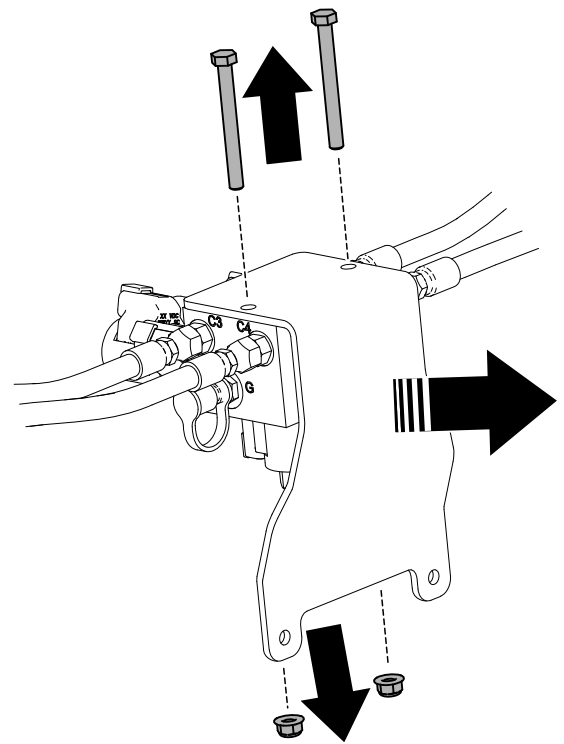

g576891

# 3

## Wire Harness

### Routing the Wire Harness

#### Parts Required

1	Wire harness
---	--------------

Route the wire harness from the rear of the machine to the console.

**Note:** Secure harness along the existing machine harness.  
The wire harness will be connected during the installation of the *Sonic Boom Leveling Kit*.

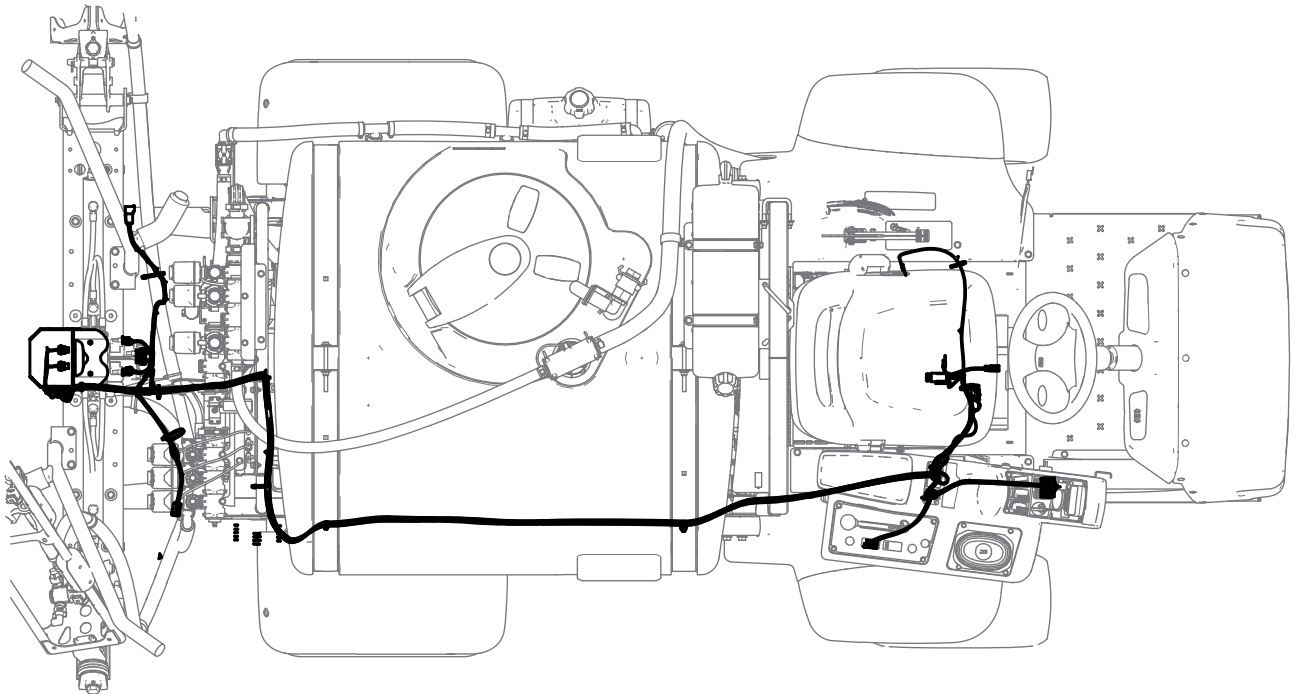

G588041

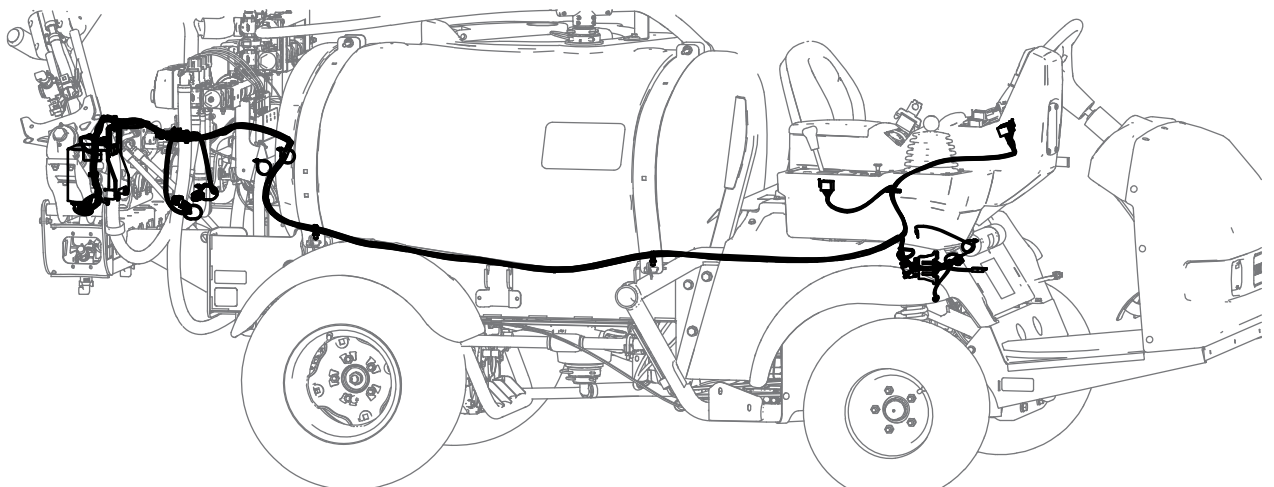

G588039

# Routing the Rear Section of the Wire Harness

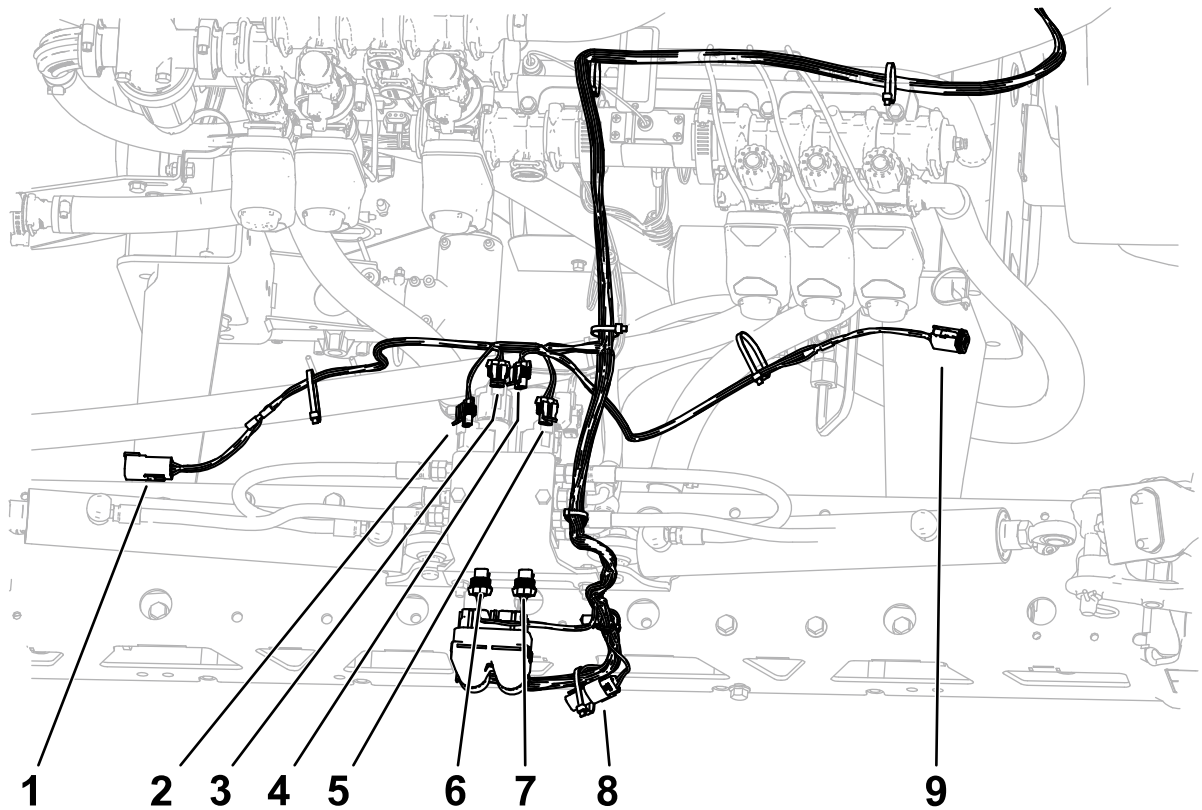

G590299

Callout	Connector Type	Label
1	6 Pin	LEFT SONIC BOOM SENSOR
2	2 socket	LEFT BOOM DOWN
3	2 socket	LEFT BOOM UP
4	2 socket	RIGHT BOOM UP
5	2 socket	RIGHT BOOM DOWN
6	2 socket	LEFT ENABLE
7	2 socket	RIGHT ENABLE
8	3 socket	TERMINATOR
9	6 socket	RIGHT SONIC BOOM SENSOR

## Routing the Rear Section of the Wire Harness (continued)

1. Route the rear section of the wire harness as shown.

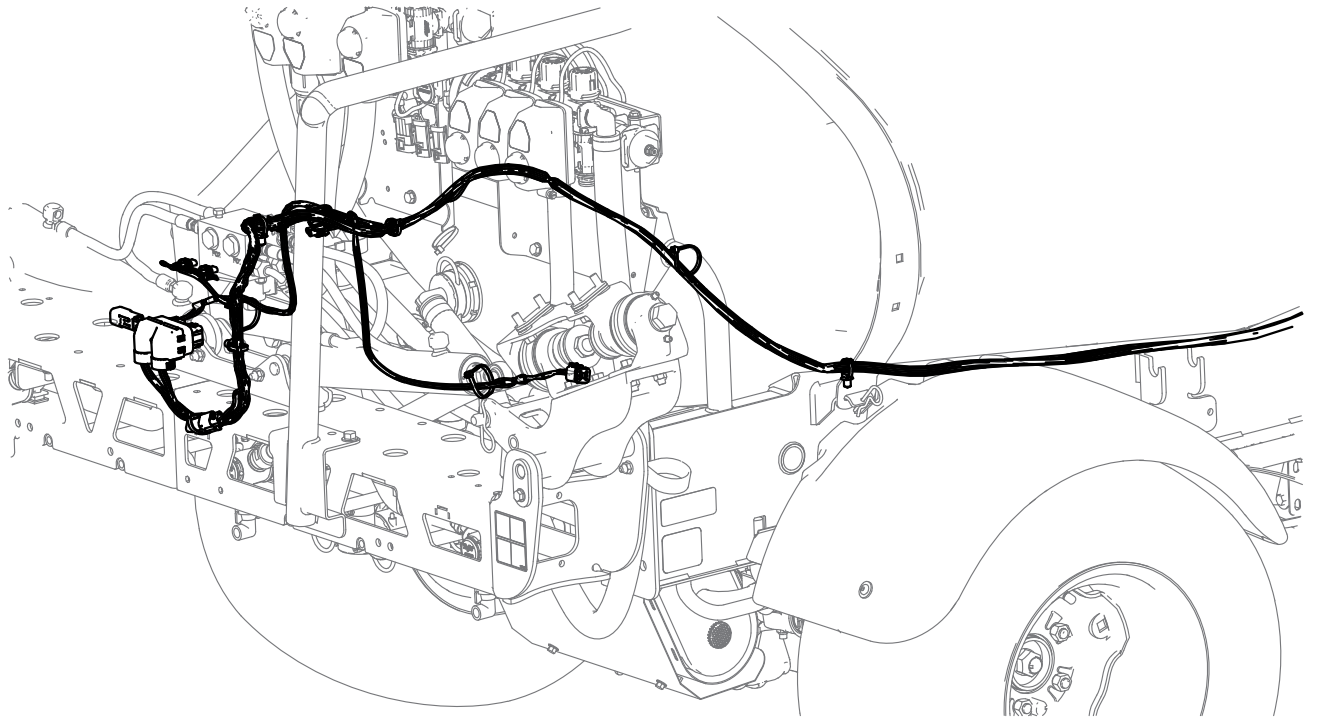

G588056

2. Continue to route the machine along the machine wire harness to the front of the machine.

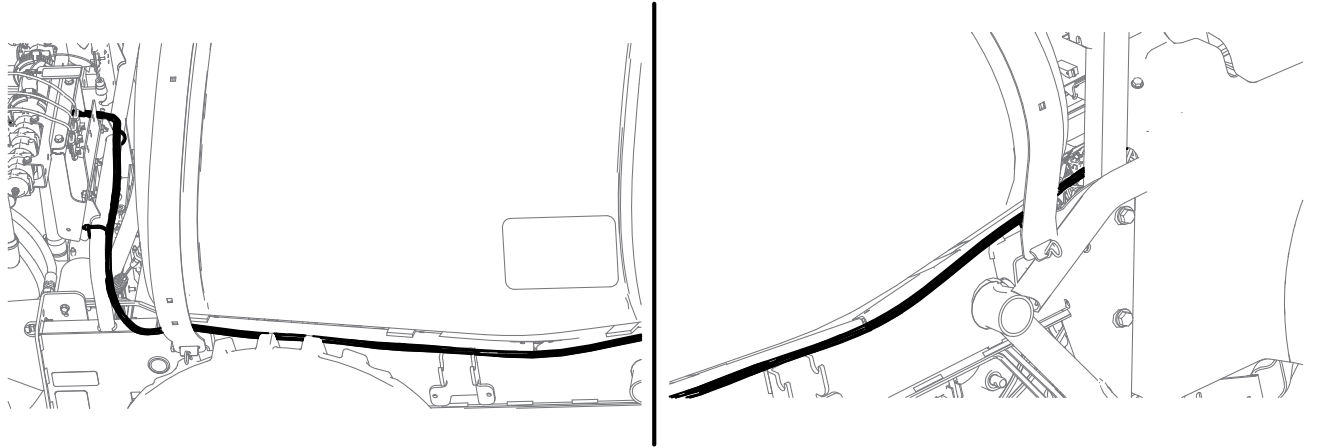

G588057

# Routing the Front Section of the Wire Harness

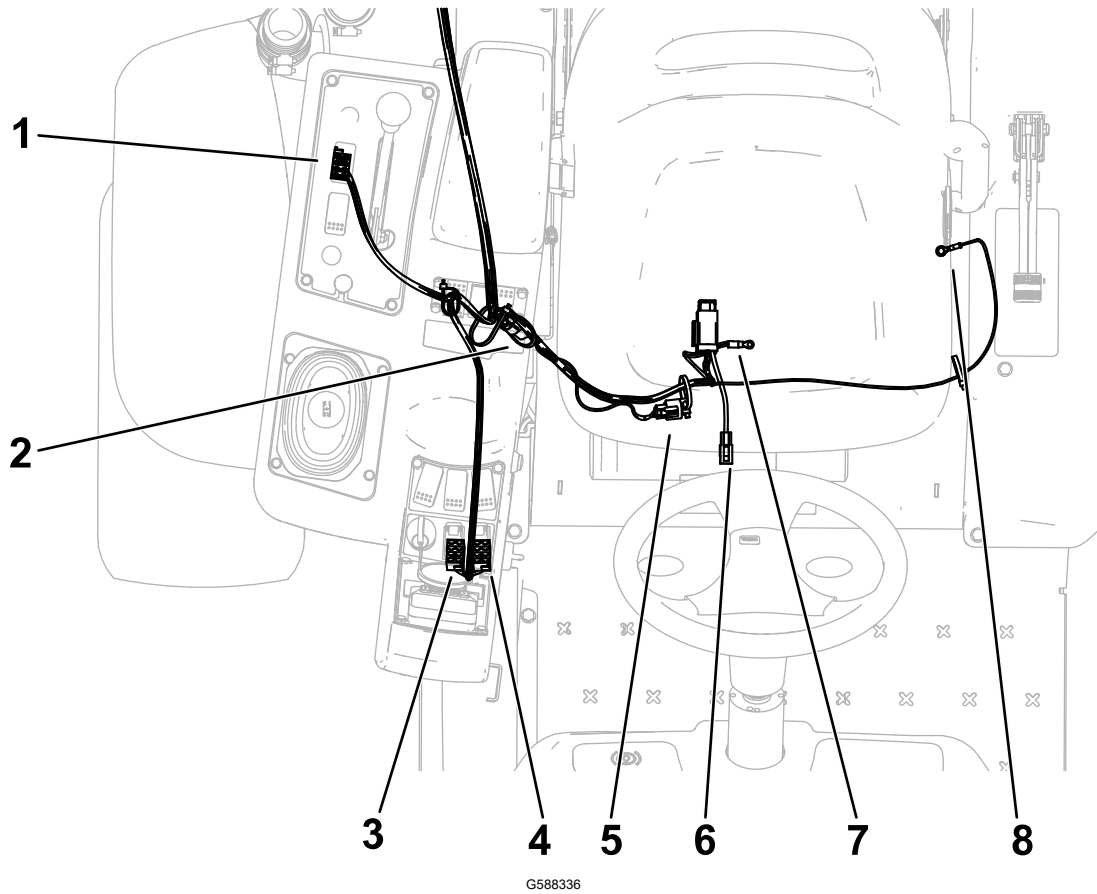

Callout	Connector Type	Label
1	8 socket	MODE INDICATOR
2	3 socket	TERMINATOR
3	8 socket	RIGHT ACTUATOR SW
4	8 socket	LEFT ACTUATOR SW
5	3 socket	CAN DIAGNOSTIC PORT
6	Blade	TO MAIN FUSE BLOCK
7	Terminal	BATTERY -
8	Terminal	BATTERY +

## Routing the Front Section of the Wire Harness (continued)

1. Route the harness to the controls.

Route the wire harness along the machine wire harness, steering hoses, and up to the controls.

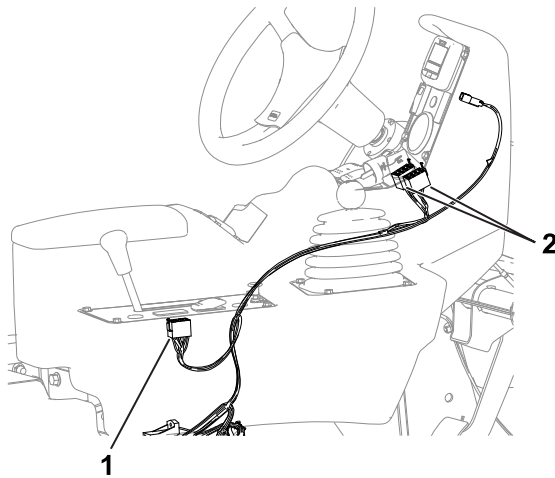

G210252s

① 8-socket connector—ultra sonic-mode switch

② 8-socket connector—boom-lift switch

2. Route the harness to the fuse blocks and battery.

A. Route the wire harness under the seat following the machine wire harness.

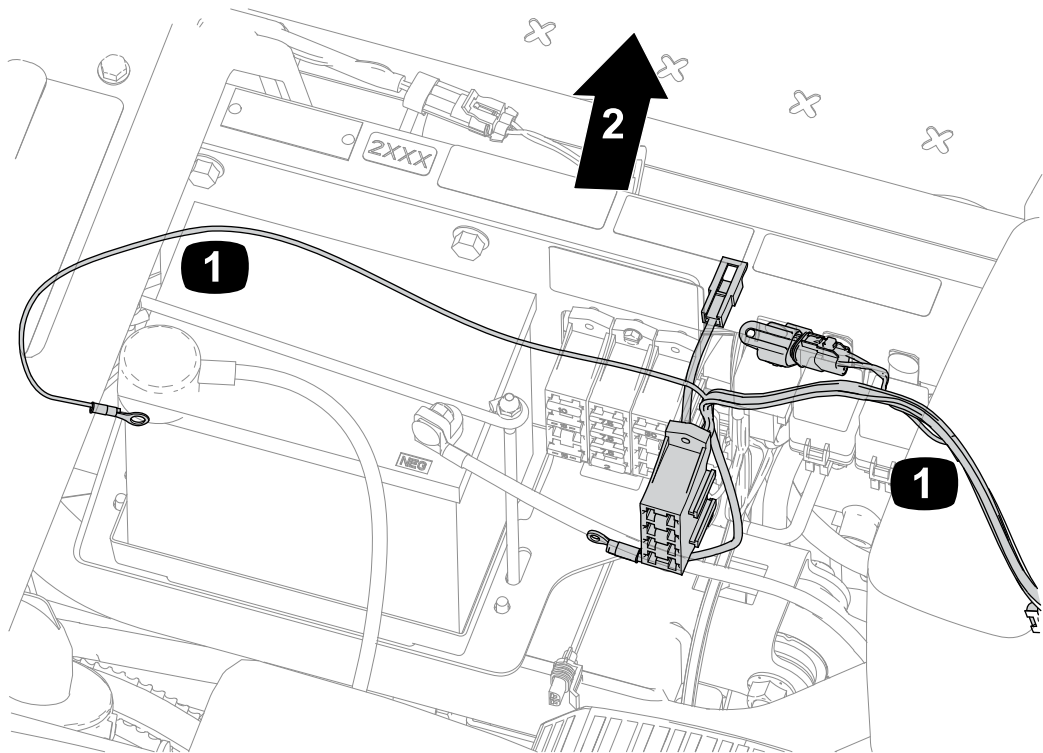

G210299S

① Wire harness

② Front of the machine

## Routing the Front Section of the Wire Harness (continued)

- B. Install the kit fuse block to the machine fuse block.

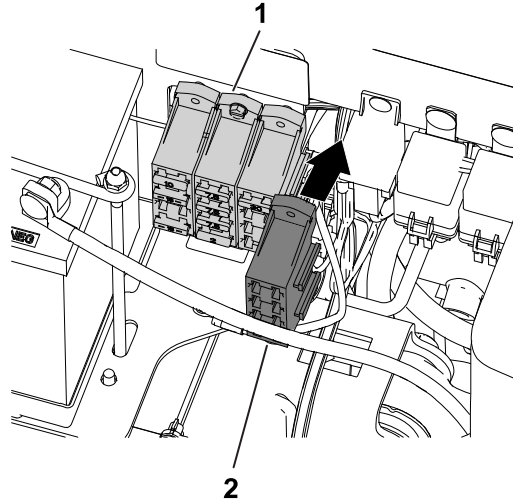

g208927s

① Fuse block—machine

② Fuse block—ultra sonic boom finishing kit

- C. Install the power circuit by attaching the connectors for the machine fuse block and the kit fuse block.

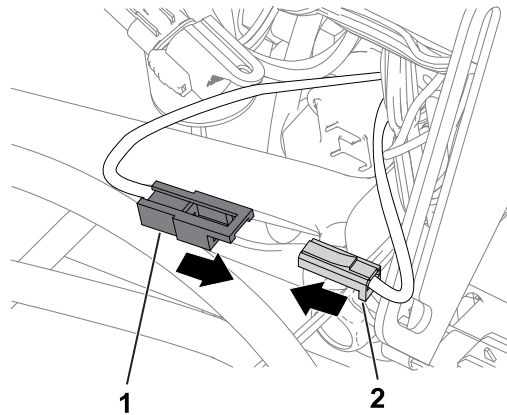

g210250s

① Connector—ultra sonic boom finishing kit

② Connector—machine

- D. Route the harness to the terminal block and connect the ground wire.

## Routing the Front Section of the Wire Harness (continued)

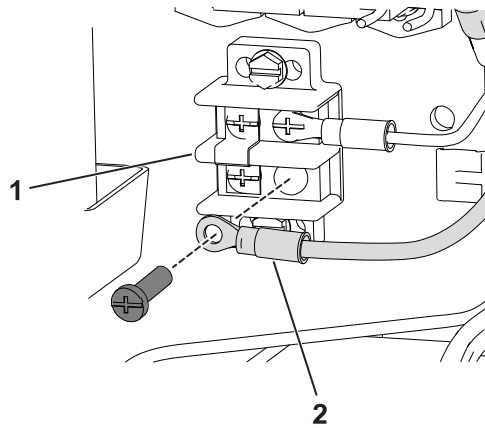

g208928s

① Terminal block

② Ground wire—ultra sonic boom finishing kit wire harness

- E. Route the harness to the left from the side console to the flasher module.
- F. Route the harness leg with the ring terminal to the positive post of the battery.

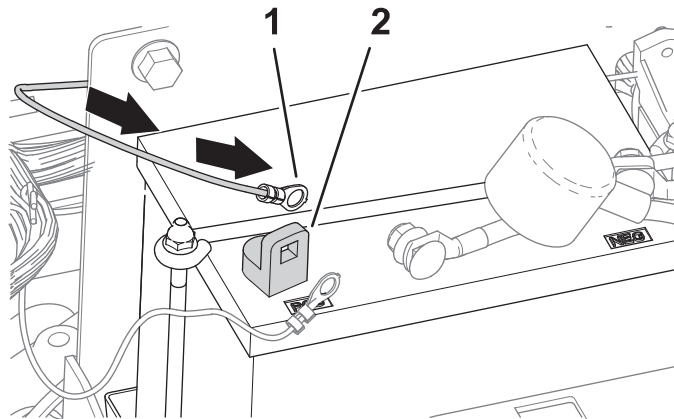

g036958s

① Ring terminal

② Positive (+) battery post

# 4

## Completing the Installation

Follow the instructions in the *Sonic Boom Leveling Kit* to complete the installation.

**Notes:**

