



Switch Panel

Groundsmaster® e3200 or e3300 Series Traction Unit with Universal Sunshade

Model No. 32314

Installation Instructions

Installation

Loose Parts

Use the chart below to verify that all parts have been shipped.

Procedure	Description	Qty.	Use
1	No parts required	–	Prepare the machine.
2	No parts required	–	Remove the sunshade.
3	Decal Switch panel Plug	1 1 4	Prepare the switch panel.
4	Sunshade wire harness Carriage bolt Nut Cable tie	1 4 4 6	Install the switch panel to the sunshade frame.
5	Jumper wire harness	1	Install the jumper wire harness (Groundsmaster e3200 machines with a serial number of 417407940 or below only).
6	No parts required	–	Install the sunshade.
7	No parts required	–	Complete the installation.



1

Preparing the Machine

No Parts Required

Procedure

1. Park the machine on a level surface.
2. Ensure that the parking brake is engaged; refer to your *Operator's Manual*.
3. Lower the cutting unit (if equipped).
4. Shut off the machine and remove the key.
5. Turn the battery-disconnect switch to the OFF position.

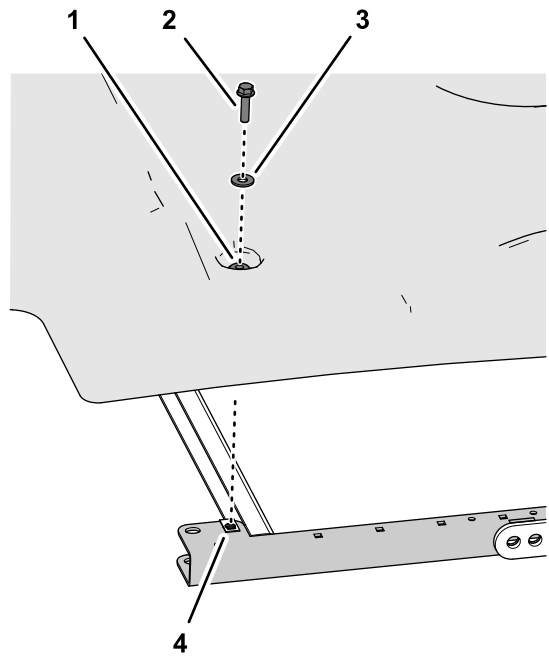

Figure 2

g244328

1. Grommet
2. Flange-head bolt (5/16 x 1-1/4 inches)
3. Washer (5/16 inch)
4. Clip nut (side-frame channel)

2. Remove the sunshade from the machine (Figure 1).

3

Preparing the Switch Panel

Parts needed for this procedure:

1	Decal
1	Switch panel
4	Plug

Installing the Decal to the Switch Panel

1. Carefully remove the backing from the decal (Figure 3).

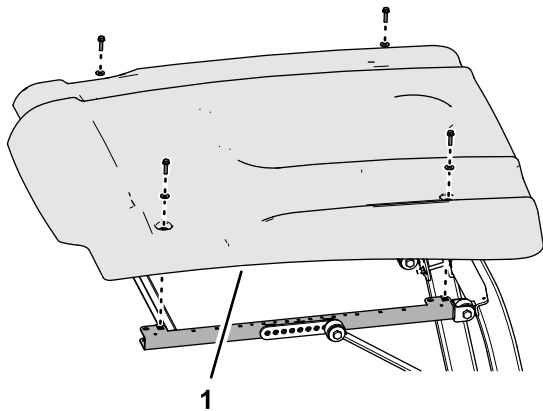

Figure 1

g244329

1. Sunshade

1. Remove the 4 flange-head bolts (5/16 x 1-1/4 inches) and 4 washers (5/16 inch) that secure the sunshade to the side-frame channels (Figure 1 and Figure 2).

Note: Do not remove the grommets from the sunshade.

4

Installing the Switch Panel to the Sunshade Frame

Parts needed for this procedure:

1	Sunshade wire harness
4	Carriage bolt
4	Nut
6	Cable tie

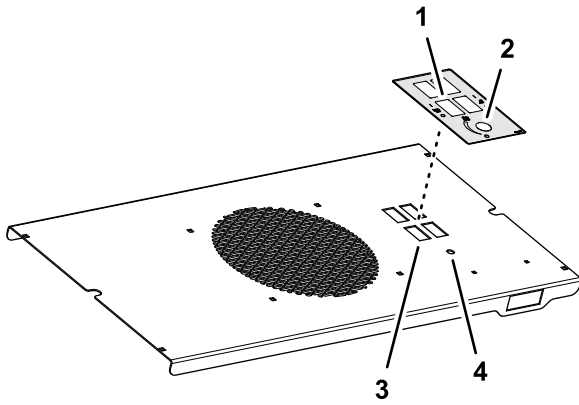

Figure 3

g245155

1. Rectangular opening (decals)
2. Hole (decals)
3. Rectangular opening (switch panel)
4. Hole (switch panel)

2. Align the rectangular openings and hole in the decal with the rectangular openings and hole in the switch panel as shown in [Figure 3](#).
3. Apply the decal to the switch panel.

Installing the Plugs to the Switch Panel

1. Align the plug to the rectangular openings in the switch panel ([Figure 4](#)).

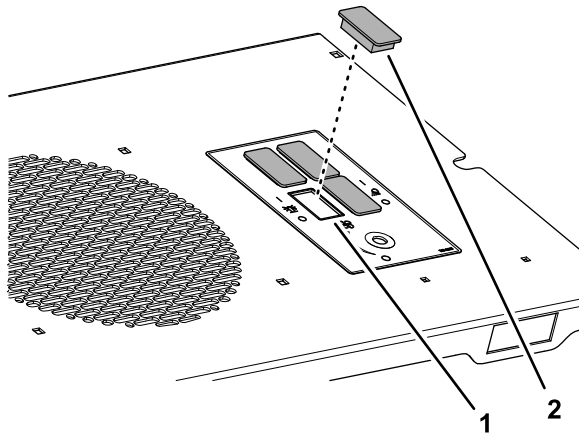

Figure 4

g245156

1. Rectangular opening (switch panel)
2. Plug

2. Insert the plug into the opening until the plug snaps securely into the panel ([Figure 4](#)).
3. Repeat step 1 and 2 for the 3 other plugs ([Figure 4](#)).

Aligning the Sunshade Wire Harness to the Switch Panel

Align the sunshade wire harness to the switch panel as shown in [Figure 5](#).

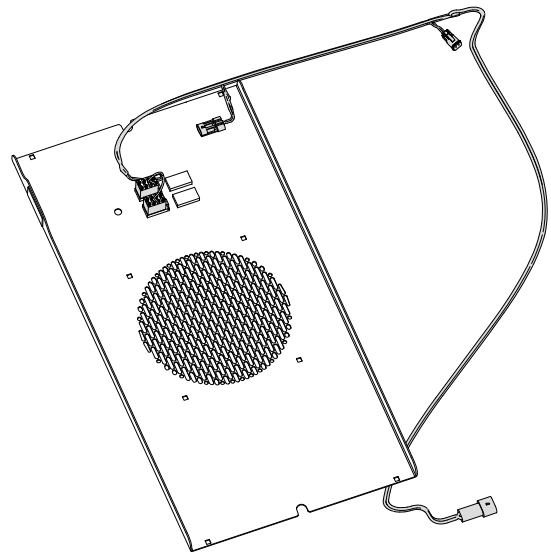

Figure 5

g466095

Assembling the Switch Panel to the Sunshade Frame

1. Align the square holes in the switch panel with the square holes in the 2 side-frame channels of the sunshade as shown in [Figure 6](#).

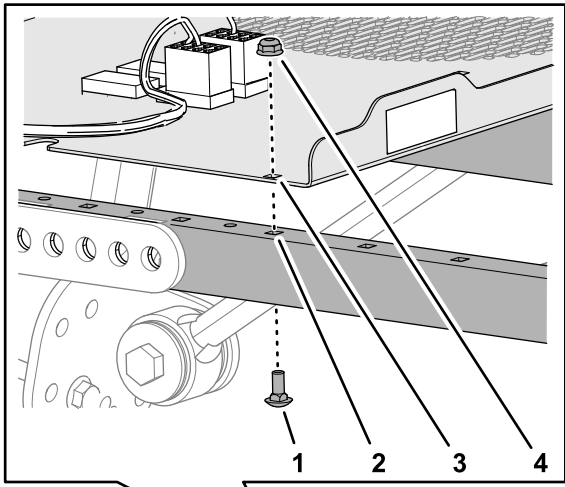

Figure 6

g465133

- | | |
|-------------------------------------|-------------------------------|
| 1. Carriage bolt | 3. Square hole (switch panel) |
| 2. Square hole (side-frame channel) | 4. Nut |

2. Assemble the switch panel to the side-frame channels (Figure 6) with the 4 carriage bolts and 4 nuts.
3. Torque the nuts to 419 to 513 N·cm (37 to 47 in-lb).

Routing the Sunshade Wire Harness

1. Route the sunshade wire harness along the roll-bar tube as shown in Figure 7.

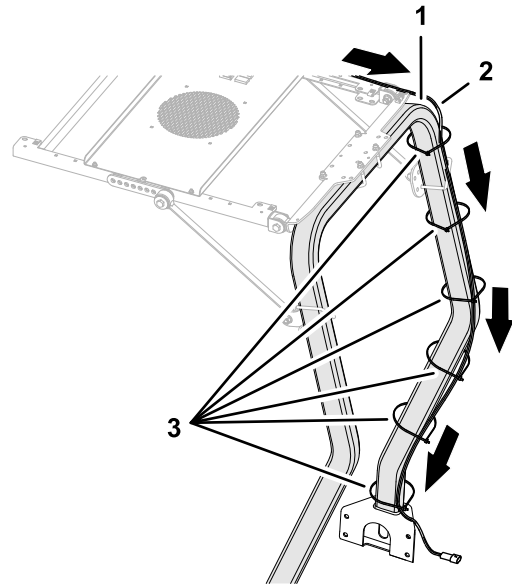

Figure 7

g245157

- | | |
|--------------------------|---------------|
| 1. Roll-bar tube | 3. Cable ties |
| 2. Sunshade wire harness | |

2. Route the wire-harness end labeled P08 through the platform grommet (Figure 8).

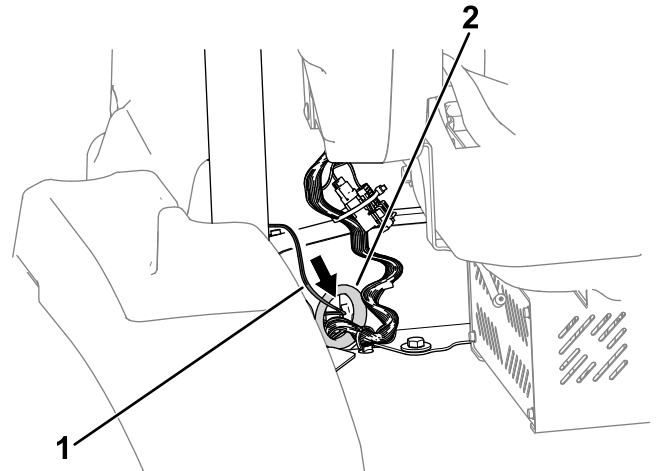

Figure 8

g453224

- | | |
|-----------------|---------------------|
| 1. Wire harness | 2. Platform grommet |
|-----------------|---------------------|

- **For Groundsmaster e3300 machines:** Perform the following steps to complete the wire-harness installation:
 1. Raise the hood and install the kit wire-harness connector labeled P08—WORK LIGHT KIT POWER to the machine wire-harness connector labeled P19—WORK LIGHT KIT POWER.

Note: The P19 connector is located above the hydraulic-tank cap.

2. Secure the wire harness to the roll-bar tube with the cable ties as needed ([Figure 7](#)).

Note: The additional jumper wire harness is not needed for the Groundsmaster e3200.

- **For Groundsmaster e3200 machines with a serial number of 417407940 or below only:**
Refer to [5 Installing the Jumper Wire Harness](#) (page 5) to complete the wire-harness installation.

5

Installing the Jumper Wire Harness

Groundsmaster e3200 Machines with Serial Number 417407940 or Below Only

Parts needed for this procedure:

1	Jumper wire harness
---	---------------------

Procedure

Perform this procedure for Groundsmaster e3200 machines with a serial number of 417407940 or below only.

1. Raise the hood and install the connector for the sunshade wire harness labeled P08—WORK LIGHT KIT POWER to the connector for the jumper wire harness labeled P02—TO SUNSHADE HARNESS ([Figure 9](#)).
2. Install the connector for the jumper wire harness labeled P03—TO MAIN HARNESS to the connector on the machine wire harness labeled P19—WORK LIGHT KIT POWER ([Figure 9](#)).
3. Route the connector for the jumper wire harness labeled P01—TO EXPANSION PORT along the machine wire harness to the left side of the machine and install it to the connector labeled P17—EXPANSION PORT ([Figure 9](#)).
4. Secure the sunshade wire harness to the roll-bar tube with the cable ties as needed ([Figure 7](#)).

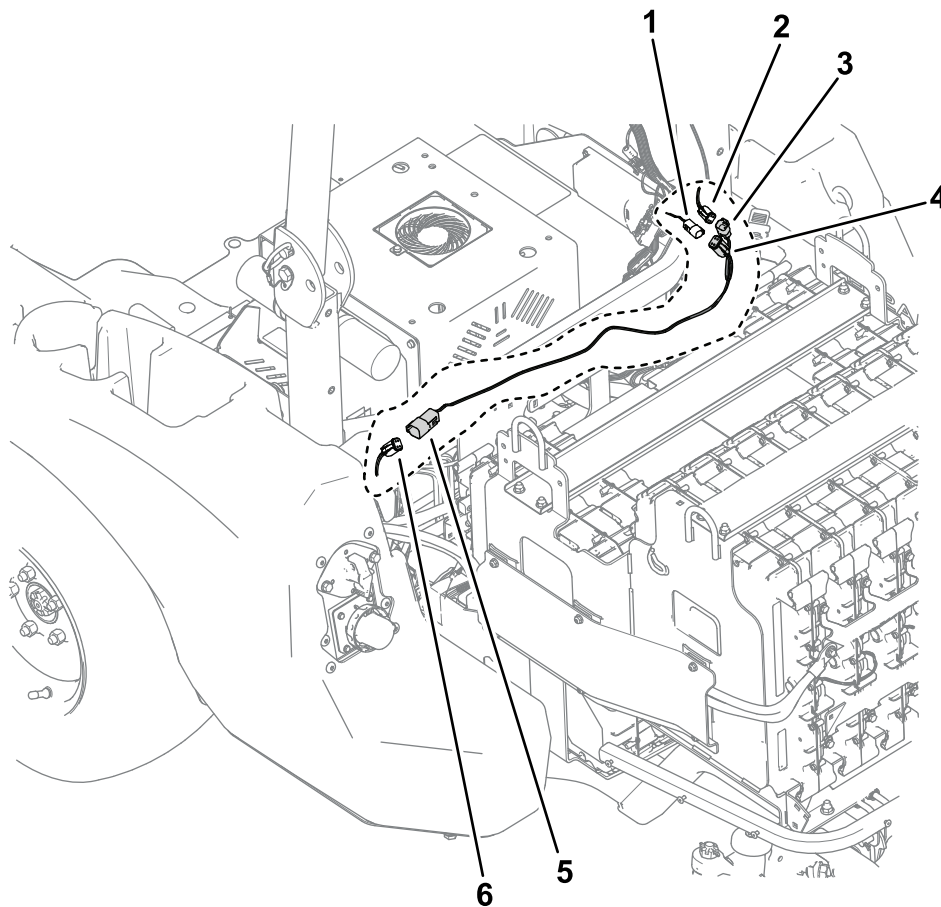

Figure 9

Several parts removed from the machine for clarity.

g550354

- | | |
|---|--|
| 1. P08—WORK LIGHT KIT POWER—sunshade wire harness | 4. P02—To SUNSHADE HARNESS—jumper wire harness |
| 2. P19—WORK LIGHT KIT POWER—machine wire harness | 5. P01—To EXPANSION PORT—jumper wire harness |
| 3. P03—To MAIN HARNESS—jumper wire harness | 6. P17—EXPANSION PORT—machine wire harness |

6

Installing the Sunshade

No Parts Required

Procedure

1. Align the holes in the grommets of the sunshade with the 4 clip nuts of the side-frame channels.
2. Assemble the sunshade to the frame channels ([Figure 10](#)) with the 4 flange-head bolts (5/16 x 1-1/4 inches) and 4 washers (5/16 inch) that you removed in [2 Removing the Sunshade](#) (page 2).
3. Torque the flange-head bolts to 1,017 to 1,355 N·cm (90 to 120 in·lb).

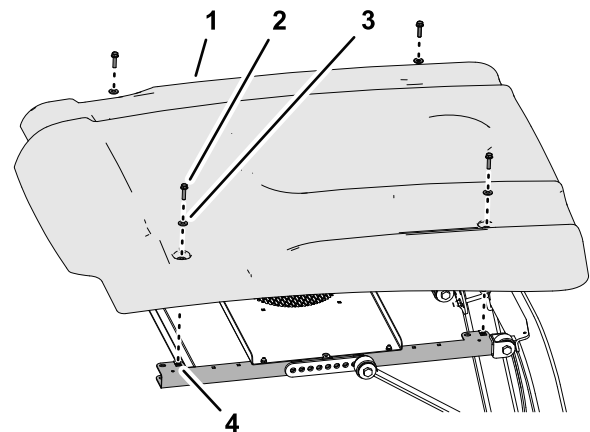

Figure 10

- | | |
|---|----------------------------------|
| 1. Sunshade | 3. Washer (5/16 inch) |
| 2. Flange-head bolt (5/16 x 1-1/4 inches) | 4. Clip nut (side-frame channel) |

g245179

7

Completing the Installation

No Parts Required

Procedure

Turn the battery-disconnect switch to the ON position.



Count on it.