



Rear Roller Scraper Kit

Cutting Units for Reelmaster® 5010 Series

Model No. 107-3280

Installation Instructions

Note: Determine the left and right sides of the machine from the normal operating position.

Installation

Loose Parts

Use the chart below to verify that all parts have been shipped.

Description	Qty.	Use
Right scraper bracket	1	Install the kit.
Scraper rod	1	
Left scraper bracket	1	
Flange locknut (3/8 inch)	4	
Flange locknut (5/16 inch)	4	

Installing the Kit

- Place the cutting unit on a level surface.
- Remove the 2 flange locknuts and 2 washers securing each roller bracket to the side plates (**Figure 1**). Do not remove the bolts.

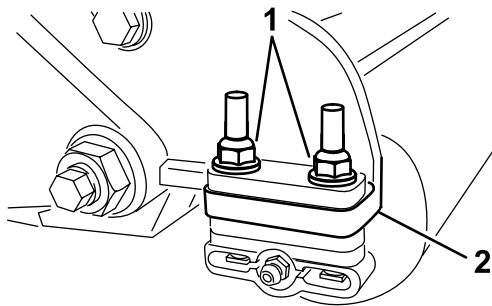

g570557

Figure 1

- Remove the locknuts and washers securing the each end of roller
- Side-plate mounting flange

- Mount the appropriate scraper bracket (right or left) to each roller bracket with 2 flange locknuts (5/16 inch) and 2 washers. Position the brackets as shown in **Figure 3**. Ensure that the roller is secure in the roller brackets.

Note: When operating in higher heights of cut, it may be necessary to remove the 1/4 inch spacer from on top of the side-plate mounting flange and to reposition it under the side-plate

mounting flange. When operating in lower heights of cut, it may be necessary to remove the 1/4 inch spacer from under the side-plate mounting flange and to reposition it on top of the side-plate mounting flange (**Figure 2**). Ensure that the scraper is always positioned on the top.

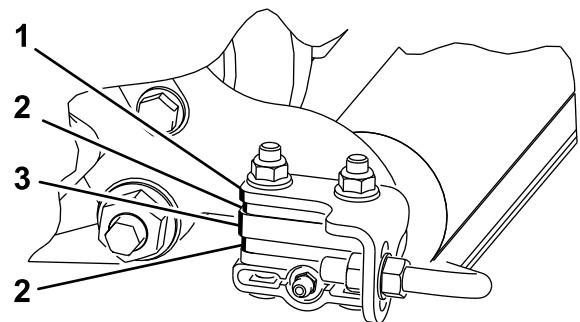

g570558

Figure 2

- Scraper bracket
- 1/4 inch spacer
- Side-plate mounting flange

- Thread a flange locknut (3/8 inch) onto each end of the scraper rod as shown in **Figure 3**.
- Insert the scraper rod into the scraper brackets and loosely secure it with 2 flange locknuts (3/8 inch) as shown in **Figure 3**.
- Adjust the locknuts to attain a clearance of 0.8 to 1.5 mm (0.03 to 0.06 inch) between the scraper bar and the roller. The distance between the



bottom of the bar and the level surface should be slightly higher than the height of cut.

Note: When the scraper is properly installed, the bottom of the bar should just brush the turf.

7. Ensure that the scraper bar is parallel to the roller and the level surface.

8. Tighten all fasteners.

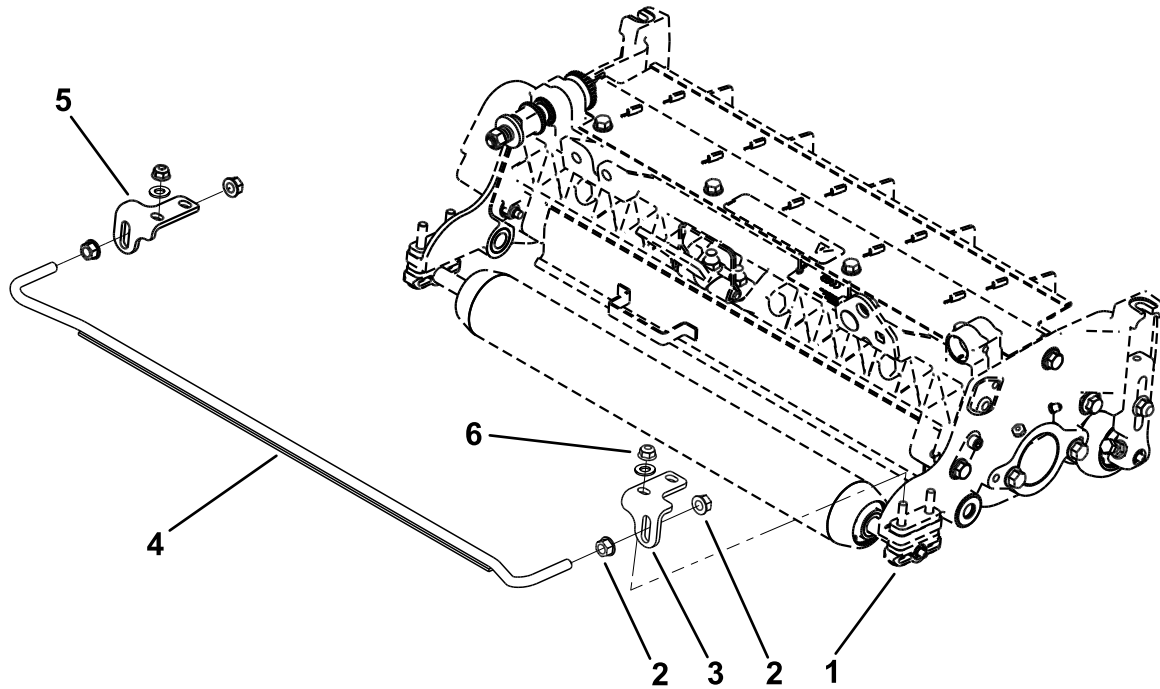

Figure 3

g570559

- | | | |
|------------------------------|--------------------------|-------------------------------|
| 1. Cutting unit | 3. Right scraper bracket | 5. Left scraper bracket |
| 2. Flange locknut (3/8 inch) | 4. Scraper rod | 6. Flange locknut (5/16 inch) |