



Leaf Mulching Kit

Groundsmaster® 4100-D

Model No. 30419

Form No. 3350-925

Installation Instructions

Note: On machines with serial numbers 240000001 & Up, the mounting holes for the mulching screens are already drilled in the decks.

1. Remove the covers from the center deck.
2. Using the instructions in the Operator's Manual, pivot (tilt) the cutting unit to the upright position.
3. While aligning the holes in the center deck mulching screen with the existing holes in the deck, position the center deck mulching screen into the deck as shown in figure 1.
4. Using carriage bolts and nuts, mount the center deck mulching screen to the deck as shown in figure 1.
5. Rotate the center deck blades to assure there is enough clearance between the blades and the mulching screen. There should be approximately 3/8" clearance.
6. Using the mulching screen as a template, mark the remaining mounting hole locations in the deck.
7. Remove the mulching screen and drill 11/32" dia. holes at the locations marked.
8. Secure the mulching screen to the deck with (6) carriage bolts and flange nuts. The carriage bolts are to be installed from the bottom of the deck. Torque to 105 in-lb.
9. Pivot (tilt) the deck down into the operating position and install the covers.
10. Remove the cover from the left or right wing decks.
11. Raise the wing deck in which the cover was removed.
12. While aligning the holes in the wing deck mulching screen with the existing holes in the deck, position the wing deck mulching screen into the deck as shown in figure 1.
13. Rotate the wing deck blades to assure there is enough clearance between the blades and the mulching screen. There should be approximately 3/8" clearance.

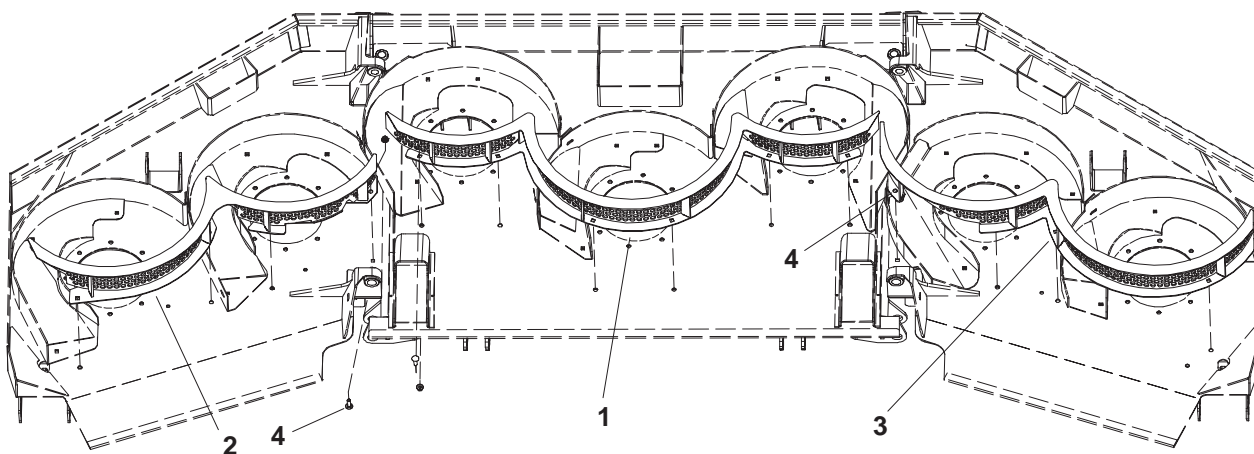

Figure 1

- | | |
|--------------------------------|--|
| 1. Center deck mulching screen | 4. Install the carriage bolts from the top at these two locations only |
| 2. R.H. deck mulching screen | |
| 3. L.H. deck mulching screen | |

14. Using the mulching screen as a template, mark the remaining mounting hole locations in the deck.
15. Remove the mulching screen and drill 11/32" dia. holes at the locations marked.
16. Secure the mulching screen to the deck with (4) carriage bolts and flange nuts. The carriage bolts are to be installed from the bottom of the deck except for at the inward most location where it must be installed from the top of the deck. Torque to 105 in-lb.
17. Lower the deck into the operating position and install the cover.
18. Repeat the procedure on the opposite wing deck.