



Leaf Mulching Kit

Groundsmaster® 4000-D

Model No. 30422

Form No. 3350-927

Installation Instructions

Note: On machines with serial numbers 240000001 & Up, the mounting holes for the mulching screens are already drilled in the decks.

1. Remove the covers from the front deck.
2. Using the instructions in the Operator's Manual, pivot (tilt) the front cutting deck to the upright position.
3. While aligning the holes in the front deck mulching screen with the existing holes in the deck, position the front deck mulching screen into the deck as shown in figure 1.
4. Using carriage bolts and nuts, mount the front deck mulching screen to the deck as shown in figure 1.

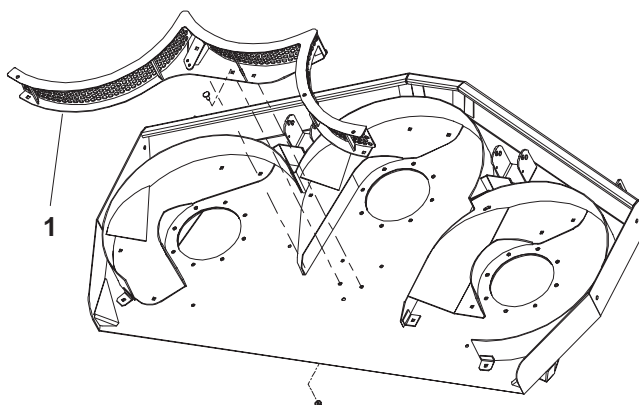

Figure 1

1. Front deck mulching screen

5. Rotate the front deck blades to assure there is enough clearance between the blades and the mulching screen. There should be approximately .50" clearance.
6. Using the mulching screen as a template, mark the remaining mounting hole locations in the deck.
7. Remove the mulching screen and drill 11/32" dia. holes at the locations marked.
8. Secure the mulching screen to the deck with (6) carriage bolts and locknuts. The carriage bolts are to be installed from the bottom of the deck. Torque to 105 in-lb.

9. Pivot (tilt) the deck down into the operating position and install the covers.
10. Remove the cover from the left wing deck.
11. Raise the wing deck.
12. While aligning the holes in the wing deck mulching screen with the existing holes in the deck, position the wing deck mulching screen into the deck as shown in figure 2.
13. Using carriage bolts and nuts, mount the wing deck mulching screen to the deck as shown in figure 2.

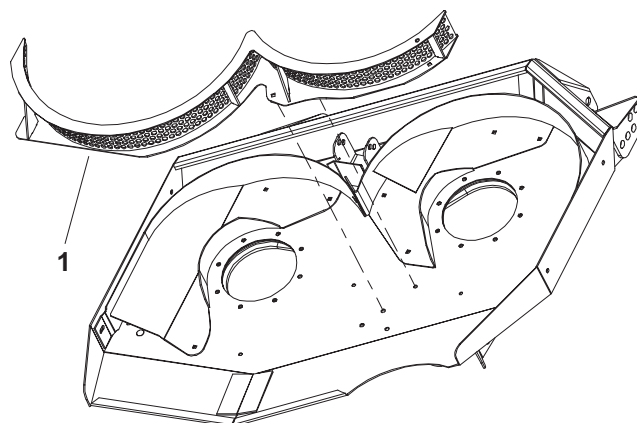

Figure 2

1. Left wing deck mulching screen

14. Rotate the wing deck blades to assure there is enough clearance between the blades and the mulching screen. There should be approximately .50" clearance.
15. Using the mulching screen as a template, mark the remaining mounting hole locations in the deck.
16. Remove the mulching screen and drill 11/32" dia. holes at the locations marked.
17. Secure the mulching screen to the deck with (4) carriage bolts and locknuts. The carriage bolts are to be installed from the bottom of the deck. Torque to 105 in-lb.
18. Lower the deck into the operating position and install the cover.

19. Repeat the procedure on the right wing deck (Fig. 3).

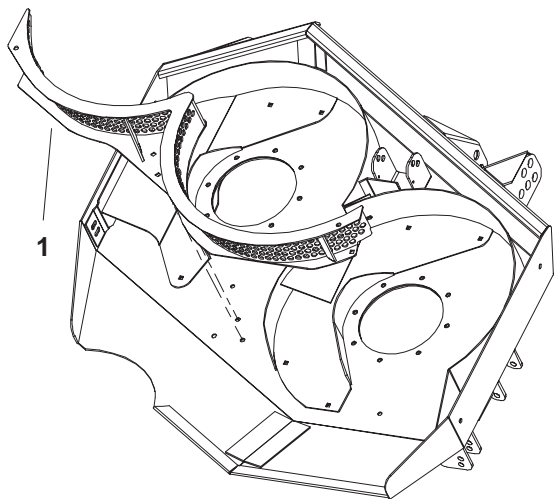

Figure 3

1. Right wing deck mulching screen
