



CE Kit

Groundsmaster® 7200 or 7210 Traction Unit

Model No. 30240

Installation Instructions

Note: Determine the left and right sides of the machine from the normal operating position.

Safety

Safety and Instructional Decals

Note: Safety decals and instructions are easily visible to the operator and are located near any area of potential danger. Replace any decal that is damaged or missing.

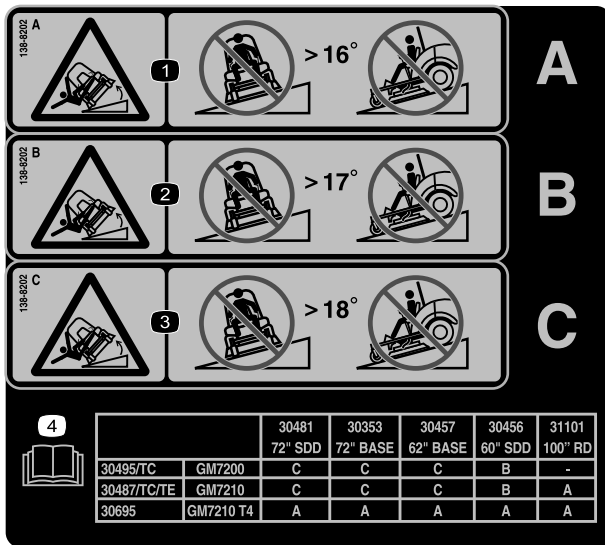

138-8202

decal138-8202

Note: This machine complies with the industry standard stability test in the static lateral and longitudinal tests with the maximum recommended slope indicated on the decal. Review the instructions for operating the machine on slopes in the *Operator's Manual* as well as the conditions in which you would operate the machine to determine whether you can operate the machine in the conditions on that day and at that site. Changes in the terrain can result in a change in slope operation for the machine. If possible, keep the cutting units lowered to the ground while operating the machine on slopes. Raising the cutting units while operating on slopes can cause the machine to become unstable.

1. Tipping hazard—do not drive the machine on a slope greater than 16 degrees.
2. Tipping hazard—do not drive the machine on a slope greater than 17 degrees.
3. Tipping hazard—do not drive the machine on a slope greater than 18 degrees.
4. Read the *Operator's Manual*.

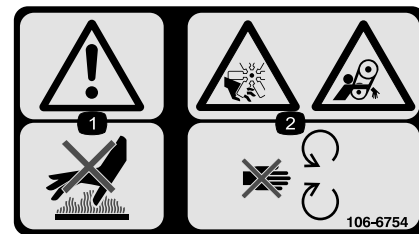

106-6754

decal106-6754

1. Warning—do not touch the hot surface
2. Cutting/dismemberment hazard, fan and entanglement hazard, belt—stay away from moving parts.

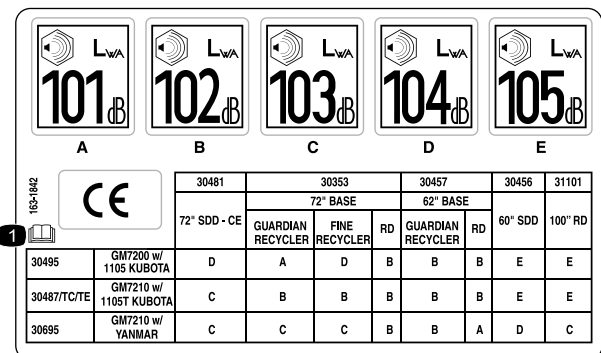

163-1842

decal163-1842

1. Read the *Operator's Manual*.



Installation

Loose Parts

Use the chart below to verify that all parts have been shipped.

Procedure	Description	Qty.	Use
1	No parts required	–	Prepare the machine.
2	Latch support Latch bracket Lock assembly Bolt (5/16 x 3/4 inch) Bolt (5/16 x 2 inches) Locknut (5/16 inch)	1 1 1 1 2 3	Install the hood-lock assembly (Kubota models).
3	Latch support Latch bracket Lock assembly Bolt (1/4 x 1/2 inch) Bolt (1/4 x 3/4 inch) Washer (5/16 inch) Locknut (1/4 inch)	1 1 1 1 2 2 3	Install the hood-lock assembly (Yanmar models).
4	Lock assembly Floor-plate latch Carriage bolt (1/4 x 3/4 inch) Locknut (1/4 inch)	1 1 2 2	Install the floor-plate-lock assembly (2008 and after models).
5	Hood handle Bolt (1/4 x 1-1/8 inches) Washer (5/16 inch) Clamp	1 2 2 1	Install the hood handle.
6	Bolt (5/16 x 1-1/4 inches) Retaining nut (5/16 inch) Push nut	2 2 2	Install the belt covers.
7	Bolt (5/16 x 1-1/4 inches)	1	Secure the seat plate.
8	Safety decal (Part No. 106-6754) Stability decal (Part No. 138-8202) Sound decal (Part No. 163-1842)	1 1 1	Install the decals.

1

Preparing the Machine

No Parts Required

Procedure

1. Move the machine to level ground and engage the parking brake.
2. Lower the cutting units to the ground.
3. Shut off the engine, wait for all moving parts to stop, and remove the key.
4. Unlatch and raise the engine hood, and secure it in the raised position with the prop rod.

2

Installing the Hood-Lock Assembly

Kubota Models

Parts needed for this procedure:

1	Latch support
1	Latch bracket
1	Lock assembly
1	Bolt (5/16 x 3/4 inch)
2	Bolt (5/16 x 2 inches)
3	Locknut (5/16 inch)

Procedure

1. Locate the upper (rear) metal frame support running across the underside of the hood.
2. In the upper, left corner of the metal frame, locate the hole drilled in the face of the support.
3. Open the hole using a 5/16 inch drill bit.
4. Install the latch support using a bolt (5/16 x 3/4 inch) and locknut (5/16 inch) as shown in [Figure 1](#).
5. Mark the hood at the center hole on the punch-out of the latch support.

6. Remove the latch support.
7. Drill a pilot hole in the plastic hood at the marked spot and then expand the hole to a diameter of 2.54 cm (1 inch).
8. Remove the punch-out from the latch support.
9. Install the latch support to the frame using the bolt (5/16 x 3/4 inch) and locknut (5/16 inch) as shown in [Figure 1](#).
10. Remove the locking nut from the lock assembly.
11. Install the lock assembly through the hood and the latch support, with the catch facing the forward ([Figure 1](#)).
12. Install the locking nut onto the bottom of the lock assembly to secure it in place ([Figure 1](#)).

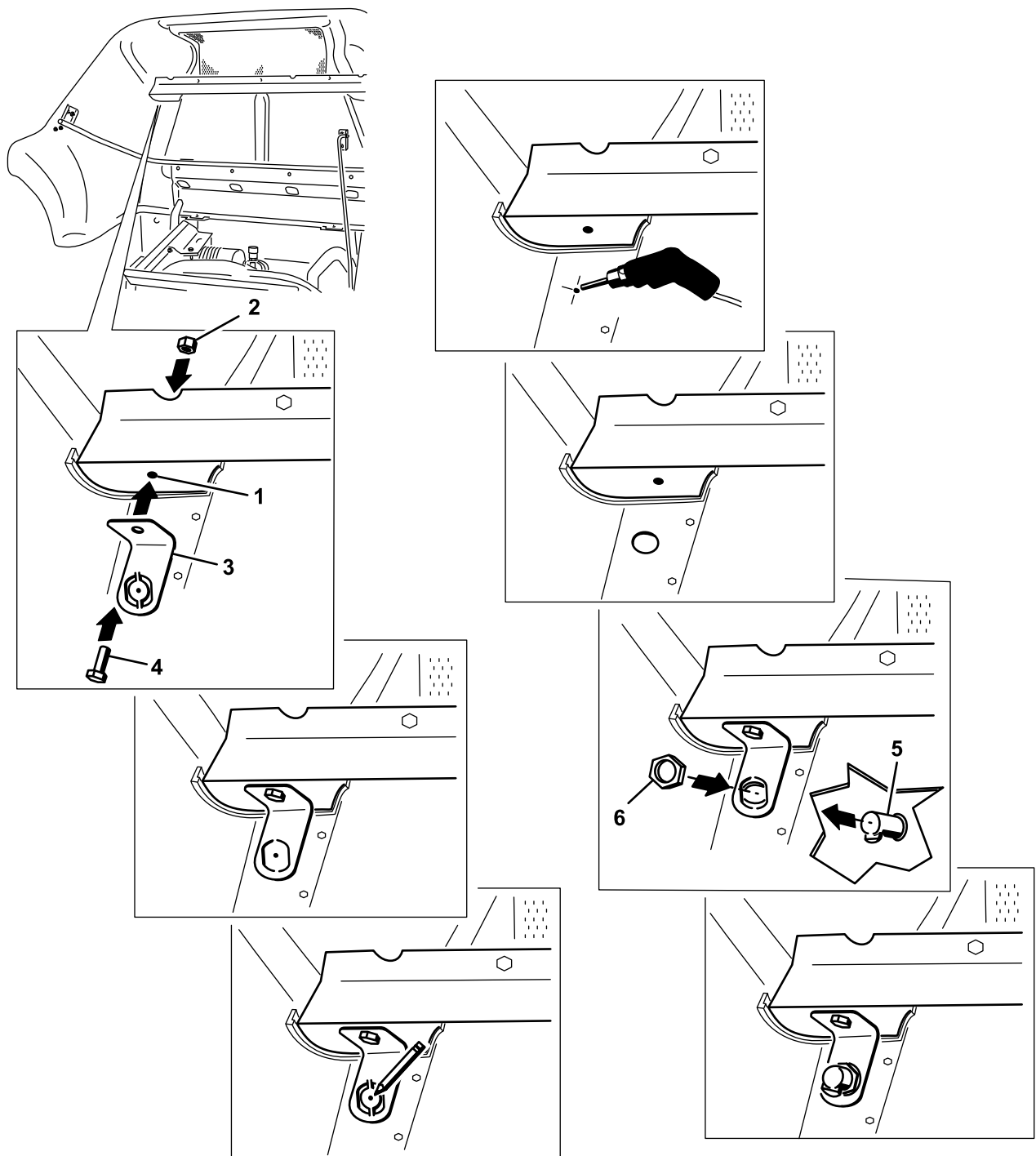

G004787

g004787

Figure 1

- | | |
|------------------------------------|---------------------------|
| 1. Hole in the metal frame support | 4. Bolt (5/16 x 3/4 inch) |
| 2. Locknut (5/16 inch) | 5. Lock assembly |
| 3. Latch support | 6. Locking nut |

13. Install the latch bracket to the left frame member, directly below the lock assembly, in the existing holes, as shown in [Figure 2](#).

Note: Center the bolts in the slots of the latch bracket.

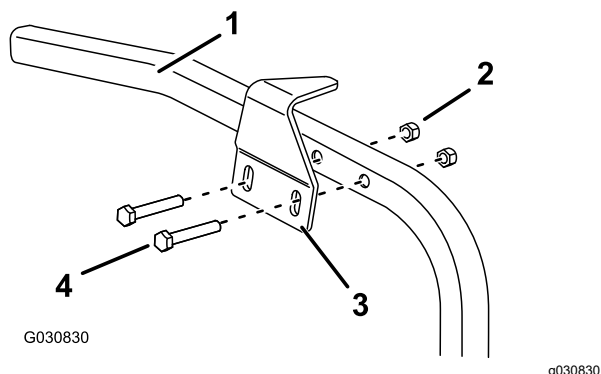

Figure 2

1. Left frame member
2. Locknut (5/16 inch)
3. Latch bracket
4. Bolt (5/16 x 2 inches)

14. Secure the latch bracket to the frame member with 2 bolts (5/16 x 2 inches) and 2 locknuts (5/16 inch) as shown in [Figure 2](#).

15. Close the hood slowly to verify that the lock assembly catches on the latch bracket.

Note: If it does not catch, loosen the bolts securing the latch bracket to the frame member and adjust the latch bracket as necessary. Tighten the bolts and verify that the latch catches.

3

Installing the Hood-Lock Assembly

Yanmar Models

Parts needed for this procedure:

1	Latch support
1	Latch bracket
1	Lock assembly
1	Bolt (1/4 x 1/2 inch)
2	Bolt (1/4 x 3/4 inch)
2	Washer (5/16 inch)
3	Locknut (1/4 inch)

Procedure

1. Locate the upper (rear) metal frame support running across the underside of the hood.
2. In the upper, left corner of the metal frame, locate the hole drilled in the face of the support.
3. Open the hole using a 5/16 inch drill bit.
4. Install the latch support as shown in [Figure 3](#).

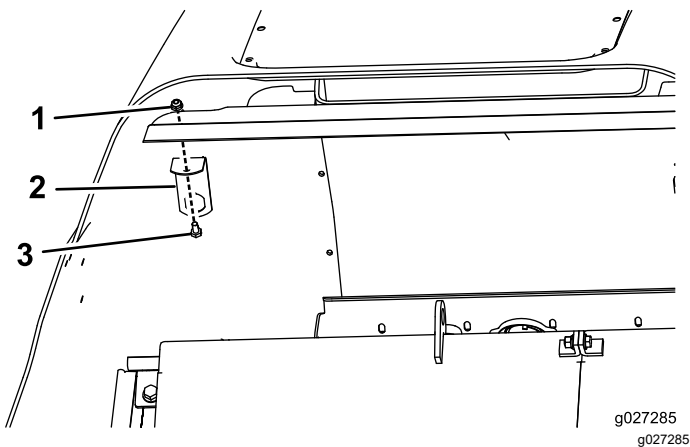

Figure 3

1. Bolt (1/4 x 1/2 inch)
2. Latch support
3. Locknut (1/4 inch)

5. Mark the hood at the center hole on the punch-out of the latch support.
6. Remove the latch support.

7. Drill a pilot hole in the plastic hood at the marked spot and then expand the hole to 25.4 mm (1 inch).
8. Remove the punch-out from the latch support.
9. Install the latch support to the frame (Figure 3).
10. Remove the locking nut from the lock assembly.
11. Install the lock assembly through the hood and the support latch bracket with the catch facing forward (Figure 4).

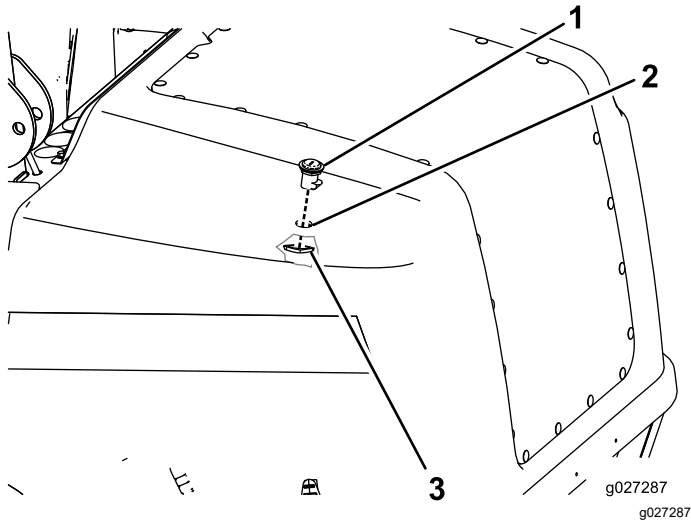

Figure 4

1. Lock assembly
2. Hole
3. Locking nut

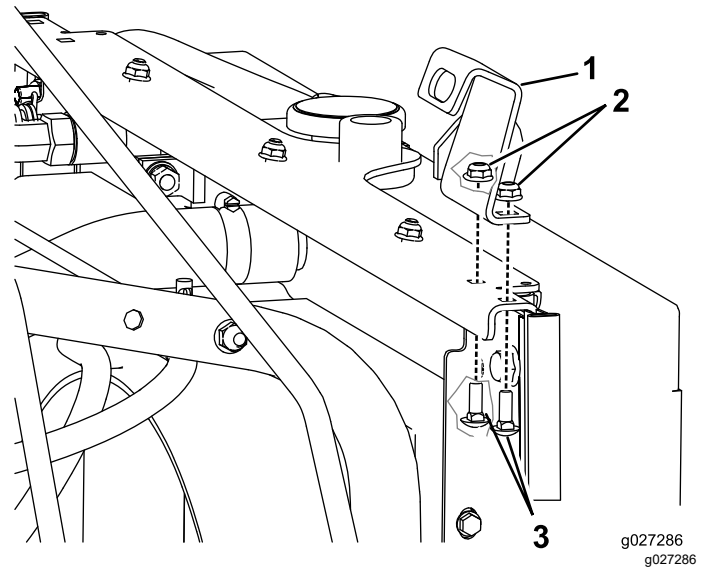

Figure 5

1. Latch bracket
2. Locknut (1/4 inch)
3. Bolt (1/4 x 3/4 inch)

14. Close the hood slowly to verify that the latch catches.

Note: If the latch does not catch, loosen the bolts securing the latch bracket to the frame member and adjust the bracket as necessary. Tighten the bolts and verify that the latch catches.

12. Install the locking nut onto the bottom of the lock assembly to secure it into place (Figure 4).
13. Install the latch bracket on the left side of the frame under the rear of the hood (Figure 5).

Note: The bolts should be approximately centered in the slots of the latch bracket.

4

Installing the Floor-Plate-Lock Assembly

2008 and After Models

Parts needed for this procedure:

1	Lock assembly
1	Floor-plate latch
2	Carriage bolt (1/4 x 3/4 inch)
2	Locknut (1/4 inch)

Procedure

1. Raise the floor plate (Figure 6).

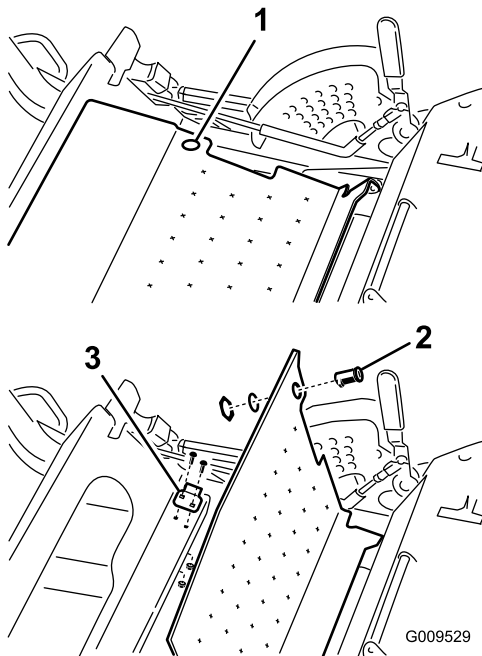

Figure 6

1. Hole in the floor plate
2. Lock assembly
3. Floor-plate latch

2. Install the floor-plate latch to the frame (Figure 6) using 2 carriage bolts (1/4 x 3/4 inch) and 2 locknuts (1/4 inch).
3. Remove the 2 locking nuts from the lock assembly.
4. Insert the lock assembly into the hole in the floor plate with the catch facing to the left.

5. Install the locking nuts onto the bottom of the lock assembly to secure it in place.

Note: The mounting holes in the latch are slotted so that you can adjust the lock assembly.

5

Installing the Hood Handle

Parts needed for this procedure:

1	Hood handle
2	Bolt (1/4 x 1-1/8 inches)
2	Washer (5/16 inch)
1	Clamp

Procedure

1. Locate the hood support rail on the inside of the left side of the hood.
2. Measure along the rail, from the support edge, 3.8 cm (1-1/2 inches) as shown in Figure 7.
3. Install the clamp around the rail at this location.
4. Using the clamp as a template, mark and drill an 8 mm (5/16 inch) diameter hole.
5. Install a washer (5/16 inch) and bolt (1/4 x 1-1/8 inches) through the clamp and drilled hole in the hood and into the hood handle.
6. With the hood handle in the approximate position shown in Figure 7, mark the second hole to drill.
- Note:** The second hole is 12.2 cm (4-13/16 inches) from the first hole.
7. Swing the hood handle out of position and drill a 5/16 inch diameter hole at the marked location.
8. Install a washer onto the other bolt (1/4 x 1-1/8 inches) and through the hood.
9. Secure the handle to the hood using the other washer (5/16 inch) and bolt (1/4 x 1-1/8 inches) as shown in Figure 7.

Note: Tighten the bolts.

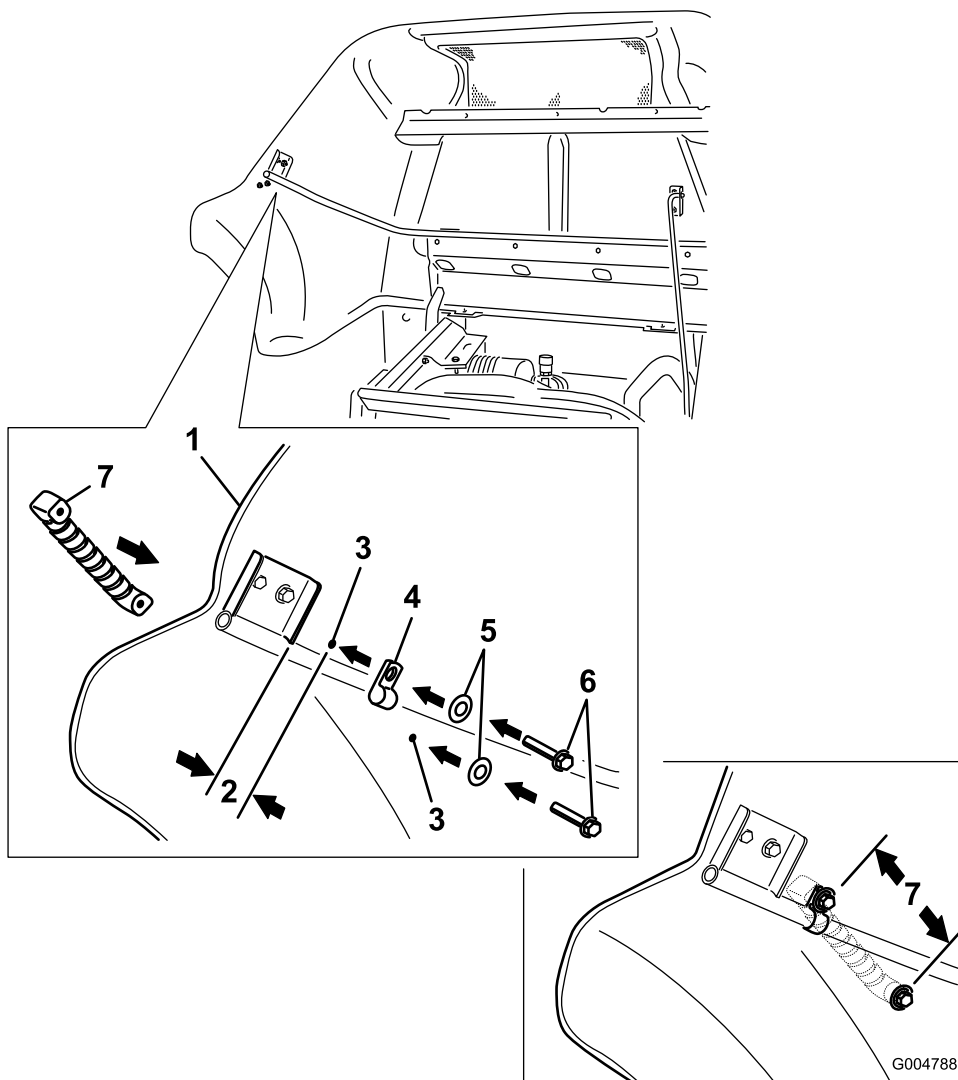

g004788

Figure 7

- | | |
|--|--|
| 1. Hood | 5. Washer (5/16 inch) |
| 2. Distance from the support edge—3.81 cm (1-1/2 inches) | 6. Bolt (1/4 x 1-1/8 inches) |
| 3. Drilled hole | 7. Distance between the holes—12.2 cm (4-13/16 inches) |
| 4. Clamp | |

6

Securing the Belt Covers

Parts needed for this procedure:

2	Bolt (5/16 x 1-1/4 inches)
2	Retaining nut (5/16 inch)
2	Push nut

Procedure

Note: Perform this procedure for the right and left side belt covers.

1. Remove the hand knobs securing the belt covers to the mower deck.
2. Remove the belt covers.
3. Install a retaining nut at the forward hole in the deck bracket (Figure 8).

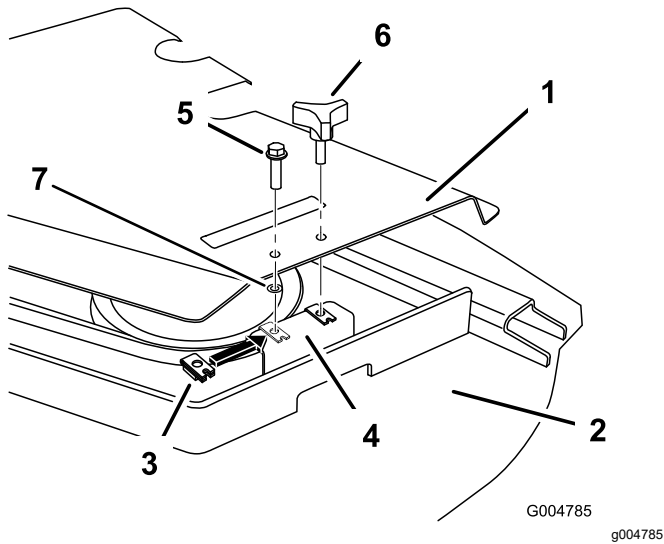

Figure 8

- | | |
|------------------|-------------------------------|
| 1. Belt cover | 5. Bolt (5/16 x 1-1/4 inches) |
| 2. Mower deck | 6. Hand knob |
| 3. Retaining nut | 7. Push nut |
| 4. Deck bracket | |

4. Install the belt cover with the bolt (5/16 x 1-1/4 inches) and push nut (5/16 inch) as shown in Figure 8.
5. Install the hand knob.

7

Securing the Seat Plate

Parts needed for this procedure:

1	Bolt (5/16 x 1-1/4 inches)
---	----------------------------

Procedure

1. Install a bolt in the seat plate to the secure it.
2. Locate the hole in the front, right side of the seat plate, in front of the manual housing.
3. Install a bolt (5/16 x 1-1/4 inches) in the hole to secure the seat plate (Figure 9).

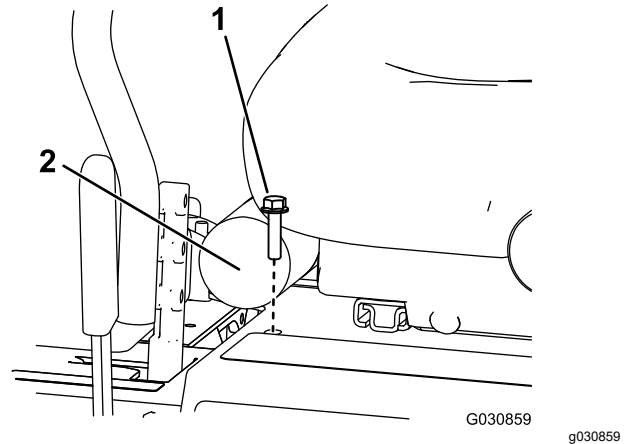

Figure 9

- | | |
|-------------------------------|-------------------|
| 1. Bolt (5/16 x 1-1/4 inches) | 2. Manual housing |
|-------------------------------|-------------------|

8

Installing the Decals

Parts needed for this procedure:

1	Safety decal (Part No. 106-6754)
1	Stability decal (Part No. 138-8202)
1	Sound decal (Part No. 163-1842)

Applying the Safety Decal

1. Thoroughly clean the area of the hood where you are installing the decal (Figure 10).

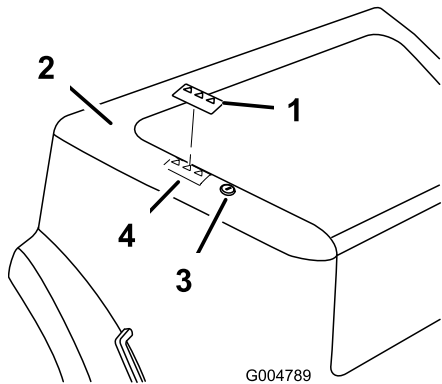

Figure 10

- | | |
|-------------------------------------|-------------------|
| 1. Safety decal (Part No. 106-6754) | 3. Lock assembly |
| 2. Hood | 4. Decal location |

2. Dampen the area with water or mildly soapy water.
3. Peel off the backing of safety decal, apply it to the hood as shown in Figure 10, and squeegee across the decal using overlapping strokes from the center toward the edges.

Applying the Tipping Hazard Decal Portion

Angle Decal Portion Table

A	B	C
16 Degrees	17 Degrees	18 Degrees

2015 and After Model-Number Configuration Table

		30354	30353	30457	30456	31101
		72-inch SDD	72-inch base	62-inch base	60-inch SDD	100-inch RD
30495/TC	GM7200 1105 Kubota	C	C	C	B	—
30487/TC/TE	GM7210 1105T Kubota	C	C	C	B	A
30695	GM7210 T4	A	A	A	A	A

Pre-2015 Model-Number Configuration Table

30360TE	GM7200 72-inch SDD - CE deck	C	C	C	B
30363TE	GM7210 72-inch SDD - CE deck	C	C	C	B
30461	GM7200 <25hp 72-inch base deck	C	C	C	B
30464	GM7210 T4i 72-inch base	C	C	C	B
30467	GM7200 <25hp 60-inch SDD	C	C	C	B
30468	GM7210 T4i 60-inch SDD	C	C	C	B
30462	GM7200 <25hp 62-inch base	C	C	C	B
30465	GM7210 62-inch base	C	C	C	B

Shaded values show the standard configuration of the model.

1. Use the Angle Decal Portion Table and the 2 model-number configuration tables to select the tipping hazard portion of the stability decal (138-8202) for your machine.
2. Thoroughly clean the existing decal where you will install the stability decal ([Figure 11](#)).

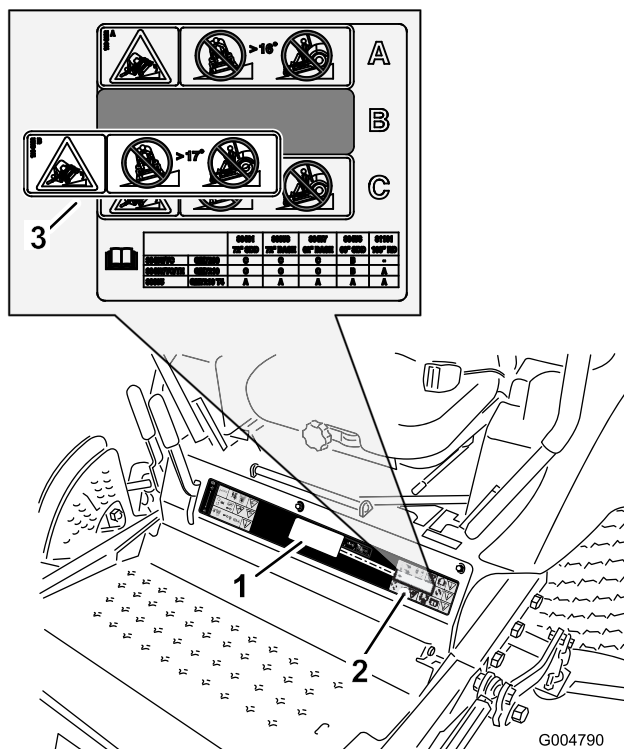

Figure 11

1. Tipping hazard portion—stability decal (Part No. 138-8202)
2. Existing decal
3. Install the correct tipping-hazard warning at this location over the existing decal.

3. Dampen the area with water or mildly soapy water.
4. Peel off the backing of the decal portion, apply it over the existing tipping-hazard warning as shown in [Figure 11](#), and squeegee across the decal using overlapping strokes from the center toward the edges.

Applying the Sound Power and CE Decal Portions

Sound-Power Decal Portion Table

A	B	C	D	E
101 dBA	102 dBA	103 dBA	104 dBA	105 dBA

2015 and After Model-Number Configuration Table

		30354	30353			30457		30456	31101
		72-inch SDD - CE	72-inch Base			62-inch Base		60-inch SDD	100-inch RD
			Guardian Recycler	Fine Recycler	RD	Guardian Recycler	RD		
30495/TC/TE	GM7200 1105 Kubota	D	A	D	B	B	B	E	E
30487/TC/TE	GM7210 1105T Kubota	C	B	B	B	B	B	E	E
30695	GM7210 w/ Yanmar	C	C	C	B	B	A	D	C

Pre-2015 Model-Number Configuration Table

30360TE	GM7200 72" SDD - CE deck	D	A	D	B	B	B	E
30363TE	GM7210 72" SDD - CE deck	C	B	B	B	B	B	E
30461	GM7200 <25hp 72-inch base deck	D	A	D	B	B	B	E
30464	GM7210 T4i 72-inch base	C	B	B	B	B	B	E
30467	GM7200 <25hp 60-inch SDD	D	A	D	B	B	B	E
30468	GM7210 T4i 60-inch SDD	C	B	B	B	B	B	E
30462	GM7200 <25hp 62-inch base	D	A	D	B	B	B	E
30465	GM7210 62-inch base	C	B	B	B	B	B	E

Shaded values show the standard configuration of the model.

These numbers include an uncertainty value (k) of 1 dBA. Sound power level was determined according to procedures outlined in ISO 11094.

1. Use the Sound-Power Decal Portion Table and the 2 model-number configuration tables to select the portion of the sound decal (163-1842) for your machine.
2. Thoroughly clean the regulatory decal and the area near the left motion-control lever where you will apply the sound decal and CE decal ([Figure 12](#)).

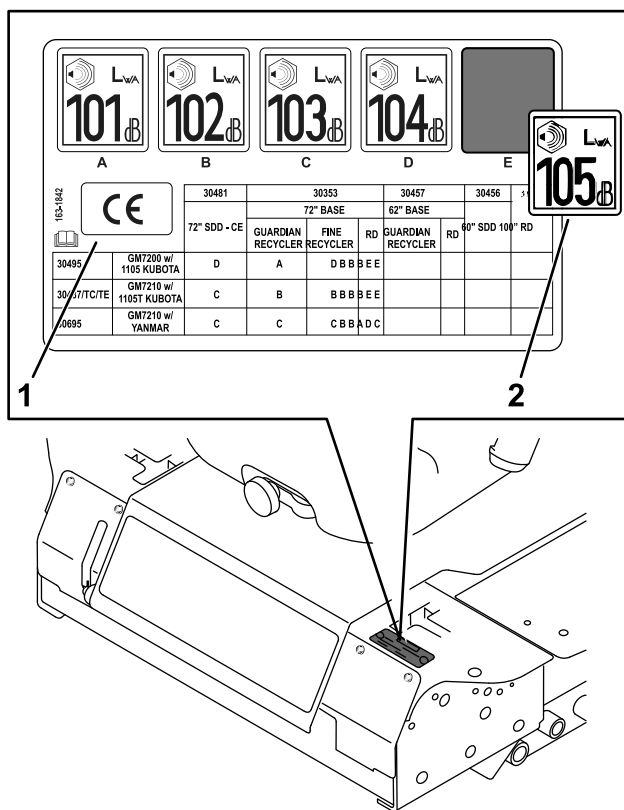

Figure 12

g573701

1. CE regulatory portion—sound decal (Part No. 163-1842)
 2. Sound-power portion—sound decal (Part No. 163-1842)
-
3. Dampen the areas with water or mildly soapy water.
 4. Peel off the backing of the decal sound-power portion, apply it to the existing regulatory decal near the left motion-control lever as shown in [Figure 12](#), and squeegee across the decal using overlapping strokes from the center toward the edges.
 5. Peel off the backing of the CE portion of sound decal 163-1842 ([Figure 12](#)), place it wherever there is space near the regulatory decal, and squeegee across the decal using overlapping strokes from the center toward the edges.

Notes:



Count on it.