



# DFS Vac Collection System Weight Kit 500 Series Z Master<sup>®</sup> with 52in Mower

Model No. 107-1760

## Parts Catalog

### Ordering Replacement Parts

To order replacement parts, please supply the part number, the quantity, and the description of each part desired.

### Understanding Reference Numbers

Each Identified part in an illustration has a reference number. The reference number for a part also appears in the parts list, along with other information about the part.

This catalog uses two special reference number formats, one to indicate parts in a service assembly and another to indicate the quantity of a given part in an illustration.

### Service Assembly Reference Numbers

Parts in service assemblies have reference numbers in the form a:b. The a represents the reference number of the entire service assembly and the b represents a sequential number unique to each part within the service assembly.

For example, a wheel assembly might be identified by reference number 6, the tire by 6:1, the valve by 6:2, and the wheel by 6:3. When you order the assembly identified by reference number 6, you receive all parts identified by reference numbers 6:1, 6:2, and 6:3. However, you may also order any part individually. Reference numbers of this type appear in illustrations and in part lists.

### Reference Numbers Indicating Quantity

In an illustration, if a reference number indicates more than one part, the reference number has the form nX y. The n represents the quantity of the part, the X is the multiplication symbol, and the y represents the reference number.

For example, in an illustration, the reference number 2X 37 means that two of the parts identified by reference number 37 are indicated.

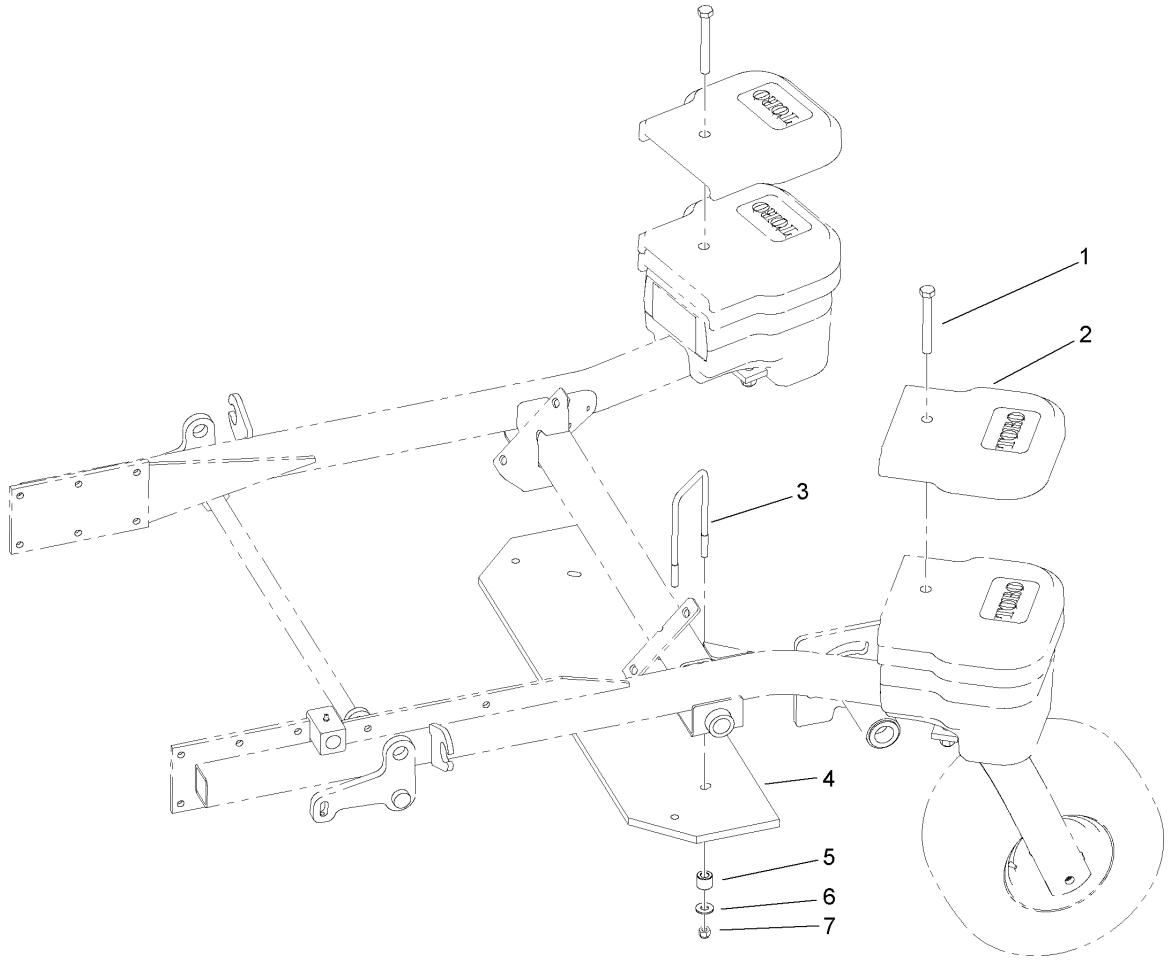

### Weight Assembly No. 107-1760

Ref	Part No.	Qty.	Description				
1	325-17	2	Screw-HH				
2	105-9741	2	Weight-Top				
3	100-2339	2	U-Bolt				
4	107-9854-01	1	Bar-Weight				
5	100-7123	4	Spacer-Bedbar				
6	3256-4	4	Washer-Flat				
7	3296-39	4	Nut-Lock, NI				