



# Drive Bypass Lever Operation for TimeCutter® Riding Mowers

Model No.s 74301, 74330, 74350—Serial No. 240000001 and Up

Form No. 3351-327

## Addendum

**Important** Apply this addendum to machines with the keyhole orientation that match what is depicted below. If the addendum does not depict what is shown on your machine then refer to the “Pushing the Machine by Hand” section in your *Operator’s Manual*.

### Pushing the Machine by Hand

**Important** Always push the machine by hand. Never tow the machine because damage may occur.

#### To Push the Machine

1. Park the machine on a level surface and disengage the blade control (PTO).
2. Move the motion control levers outward to engage the parking brake, stop the engine, remove the key, and wait for all moving parts to stop before leaving the operating position.
3. Move the two bypass levers to the inside and push them in until the washer on the rod passes through the slot (Fig. 1).
4. Push the levers toward the outside to lock them in place (Fig. 1).
5. Move the motion control levers inward to disengage the parking brake.

The machine is now able to be pushed by hand.

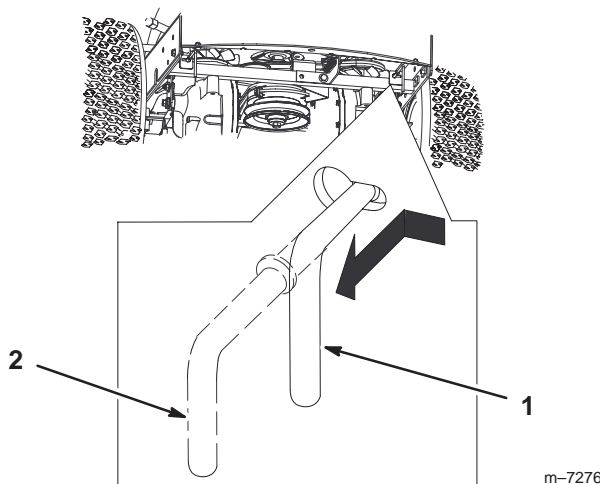

**Figure 1**

1. Lever position for pushing the machine
2. Lever position for operating the machine